

LINDEN STREET KANSAS AVE. TO OTTAWA AVE.	
Drawing No. 474	Sheet No. 1
Plotted	Checked
W.S.M., 10-15-36	R.L. LEMKE, 10-19-36

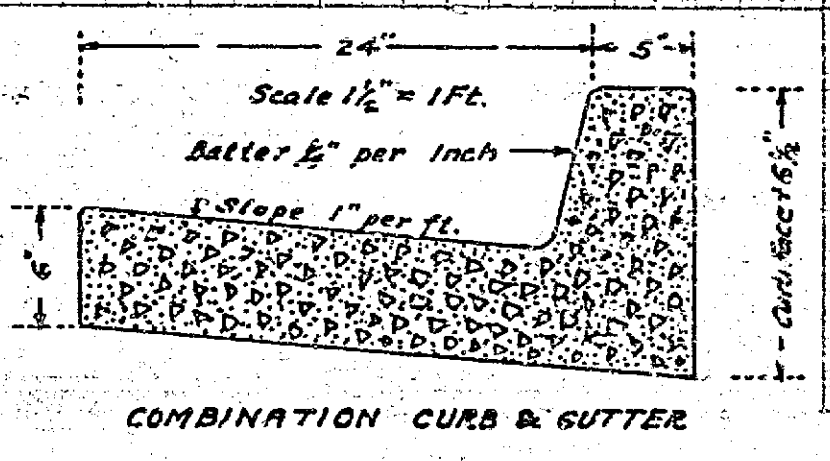
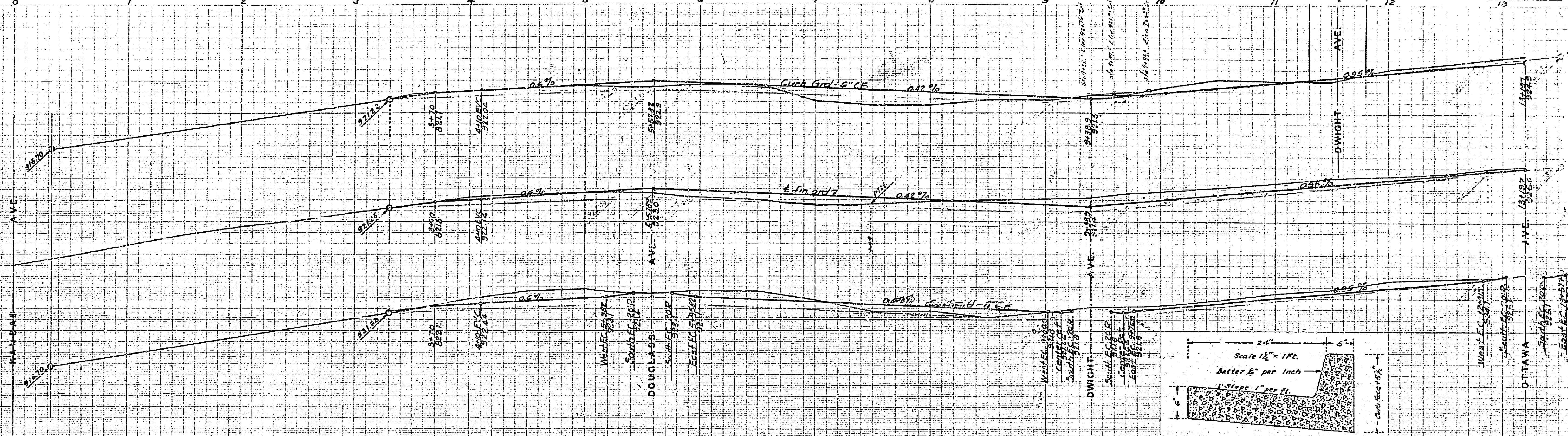

PLAN AND PROFILE OF THE PROPOSED IMPROVEMENT ON LINDEN STREET BETWEEN KANSAS AVE. & OTTAWA AVE.

ENGINEER DEPT. RIVERSIDE CALIF. 1936.
CITY (U.S.G.S.) DATUM PLANE
FIELD BOOK 323 PAGES 39-53

SCALE
HOR. 1" = 40'
VER. 1" = 4'

APPROVED: *[Signature]*
CITY ENGINEER.

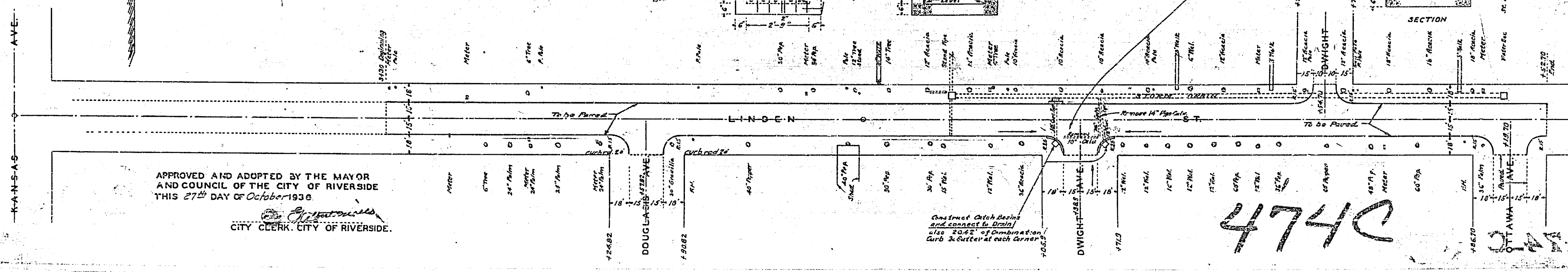
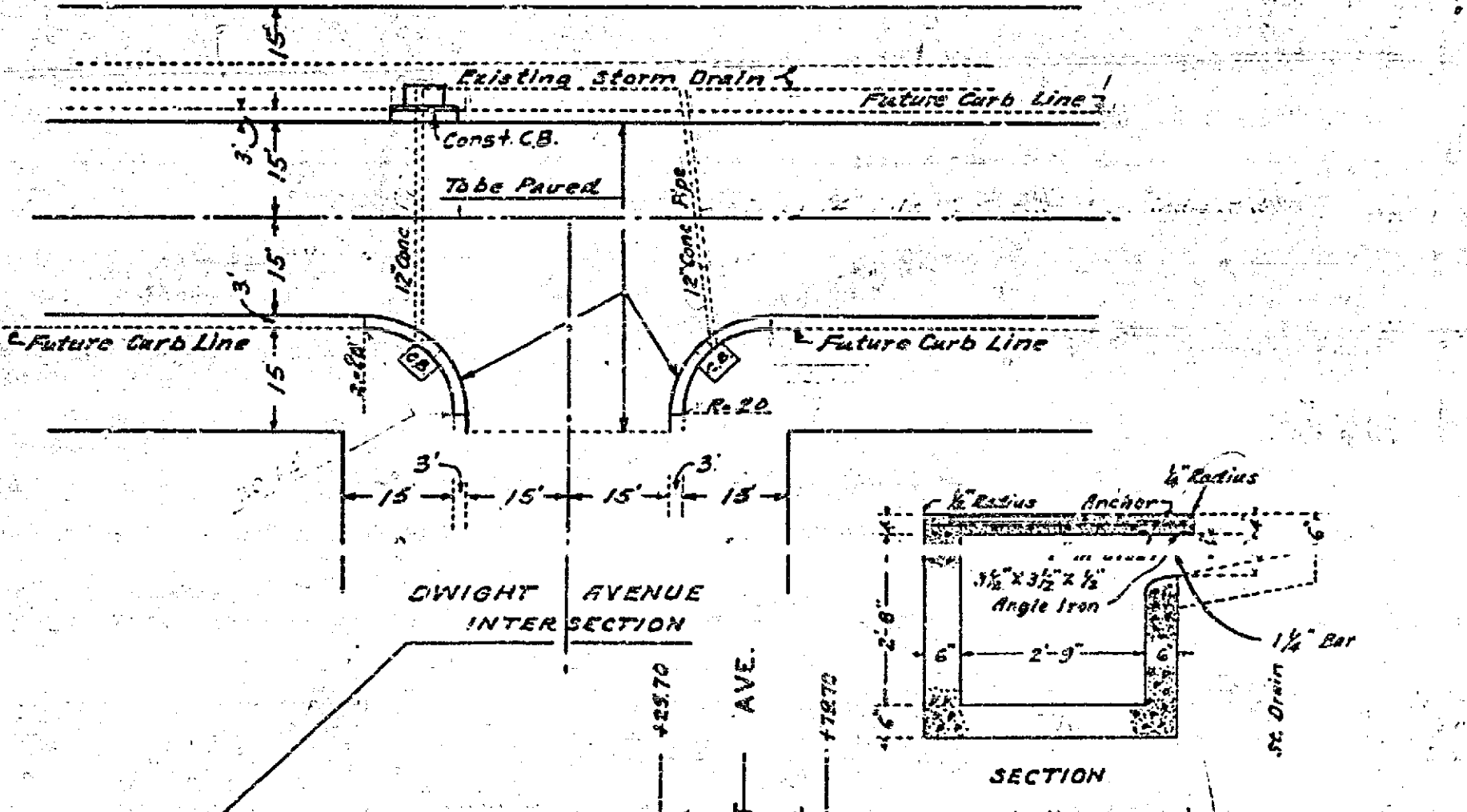
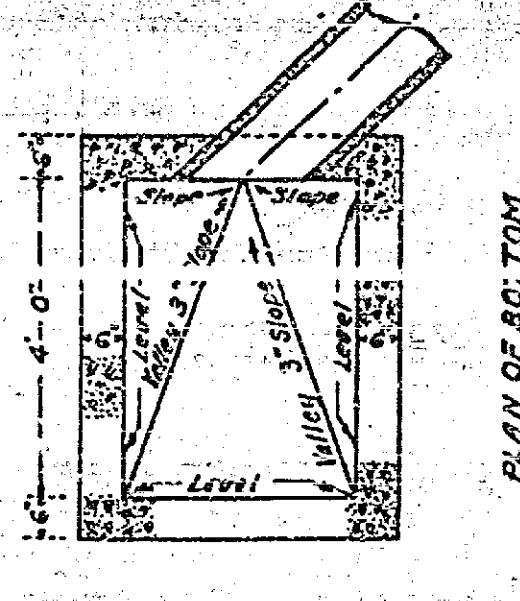
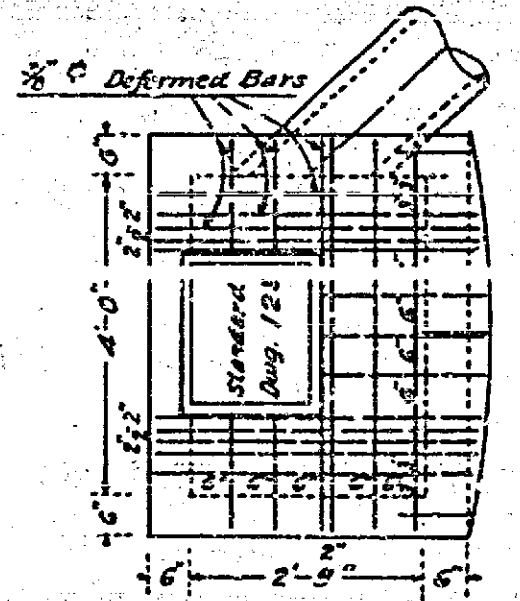
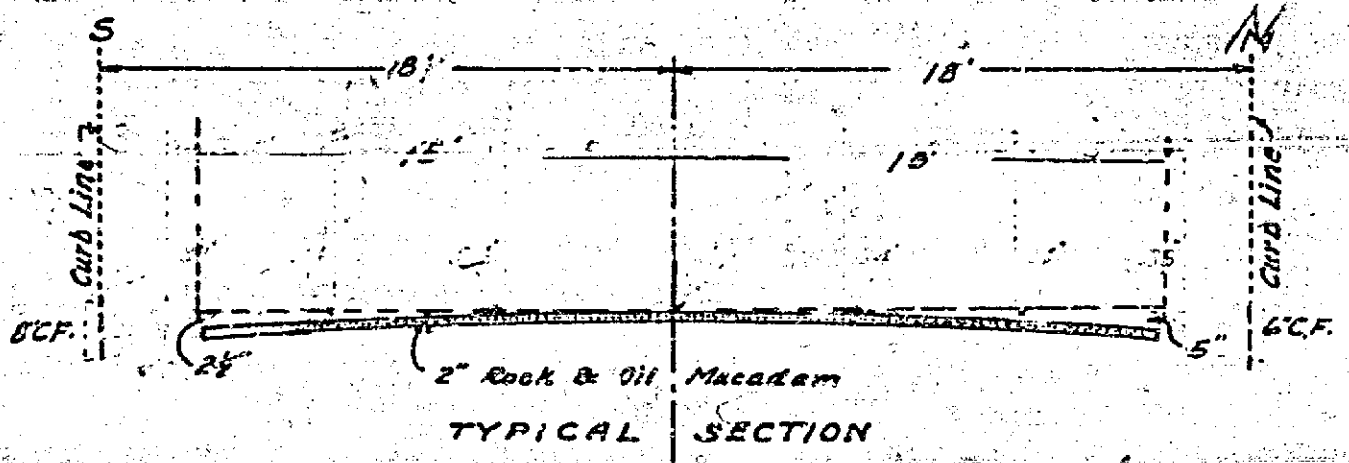

APPROVED AND ADOPTED BY THE MAYOR
AND COUNCIL OF THE CITY OF RIVERSIDE
THIS 27th DAY OF October 1936.

[Signature]
CITY CLERK, CITY OF RIVERSIDE.

4740