

New Deal of the Riverside Land Company

At a meeting of the Board of Directors of the Riverside Land Company, held April 27, 1889, after having looked over the Canal Lines, and the lands carefully, the following proceedings were had:

First—The project officers were authorized to make the proposed advance to the Riverside Water Company in payment of water stock, to enable the Water Company to extend the canal and divert ditches to water the lands.

Second—To let a contract to construct the water main of iron pipe, to be laid in the center of the canal, and to make up and care for one year.

Third—The cost of all blocks fronting on Magnolia Ave. at \$200 per acre. The other half of said blocks fronting on Indiana and California Avenues and cross streets of from \$100 to \$200 per acre, according to situation and condition. Block 14 and the fractional blocks adjoining lying between Indiana and Arizona Avenues at from \$75 to \$200, according to location and condition, on terms similar to that adopted by the Southern Pacific Railway Company, to wit: One-half cash and balance on or before 3 years, at 8 per cent interest, payable annually; the purchaser agreeing to improve in trees or vines within one year.

Fourth—The following prices and terms were established for sale of lands, for the present, until further ordered, for the purpose of encouraging improvement and settlement. The water tank to be attached to and run with the tank.

Fifth—The cost of all blocks fronting on Indiana and California Avenues and cross streets of from \$100 to \$200 per acre, according to situation and condition. Block 14 and the fractional blocks adjoining lying between Indiana and Arizona Avenues at from \$75 to \$200, according to location and condition, on terms similar to that adopted by the Southern Pacific Railway Company, to wit: One-half cash and balance on or before 3 years, at 8 per cent interest, payable annually; the purchaser agreeing to improve in trees or vines within one year.

Sixth—The water supply, as notified expressed in "The articles of life," and as we would say "Life's blood," is scarce and unobtainable, and limited only to the amount necessary. The soil in this very best, and the landowners, California and Arizona Avenues, being situated near the foothills, and strongly inclined with downward gradient, are the best in any country for the production of Grapes, Lemons and Raisins.

JOSEPH J. JARVIS, M. D., S. C. EVANS, President,
D. T. DYER, D. W. McLEOD, Secretary,
A. S. WHITE, Attorney.

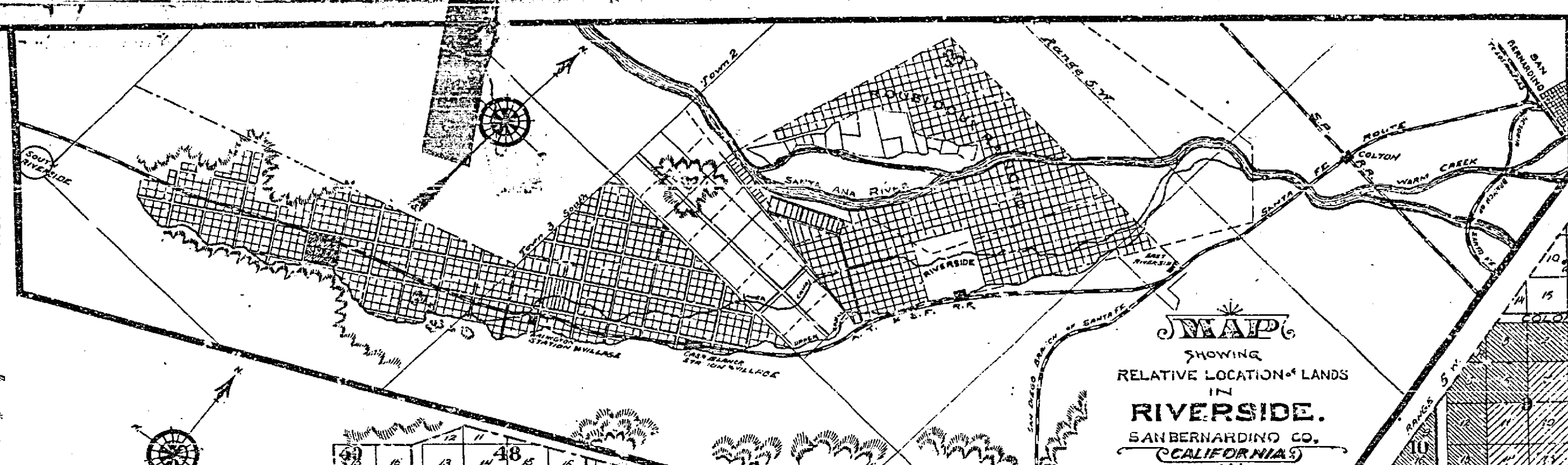

LANDS OF THE
Riverside Land Co.

CITY OF RIVERSIDE
SAN BERNARDINO COUNTY, CALIFORNIA
SCALE: 1800 FT. 1 INCH

S. O. EVANS, PRESIDENT
1889
D. W. McLEOD, SECRETARY

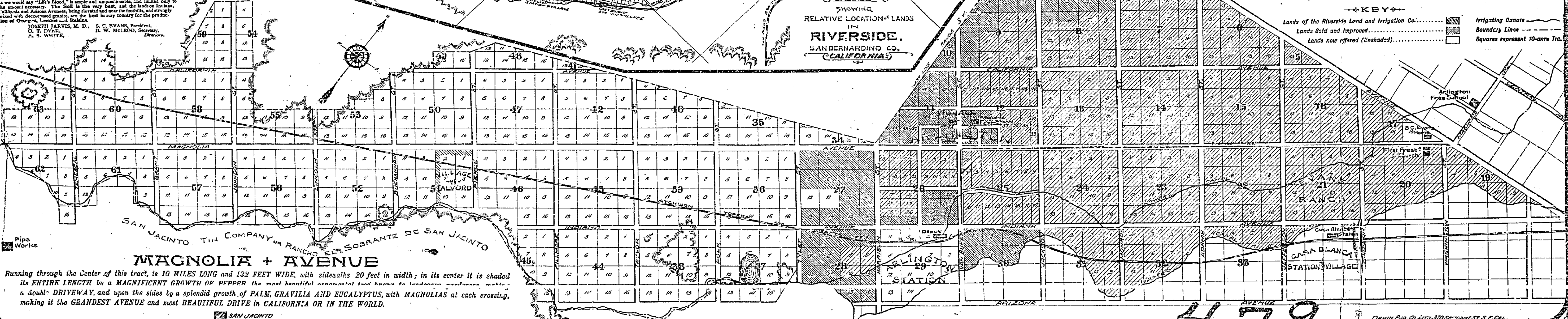

MAGNOLIA + AVENUE

Running through the Center of this tract, is 10 MILES LONG and 132 FEET WIDE, with sidewalks 20 feet in width; in its center it is shaded its ENTIRE LENGTH by a MAGNIFICENT GROWTH OF PEPPER the most beautiful ornamental tree known to landscape gardeners, with a double DRIVEWAY, and upon the sides by a splendid growth of PALM, GRAVILIA AND EUCALYPTUS, with MAGNOLIAS at each crossing, making it the GRANDEST AVENUE and most BEAUTIFUL DRIVE in CALIFORNIA OR IN THE WORLD.

SAN JACINTO
TEN MILES