

CYPRESS AVENUE			
MAGNOLIA AVE. TO EMMA ST.			
Drawing No.	Sheet No.	Total Sheets	Field Book
483	1	1	308
Plotted			Checked
Date, 6-30-36			

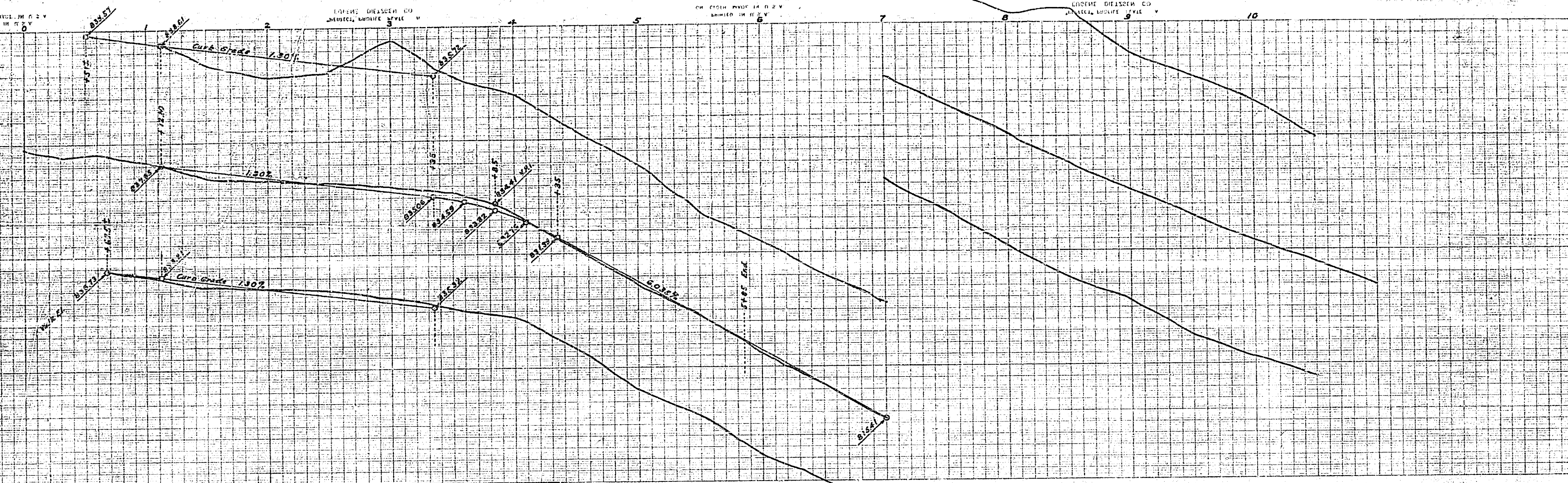

PLAN AND PROFILE

OF THE PROPOSED IMPROVEMENT ON

CYPRESS AVENUE

BETWEEN MAGNOLIA AVE. & EMMA ST.

ENGINEER DEPT. RIVERSIDE CALIF. 1936.
 CITY (U.S.G.S.) DATUM PLANE
 FIELD BOOK 309 PAGES 36-46

Completed by Street Dept. 1936.

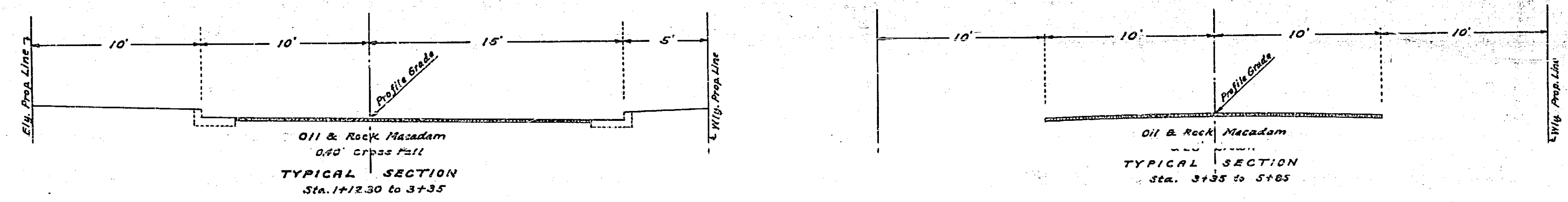

SCALE
 HOR. 1"=40'
 VER. 1"=4'

APPROVED
 CITY ENGINEER.

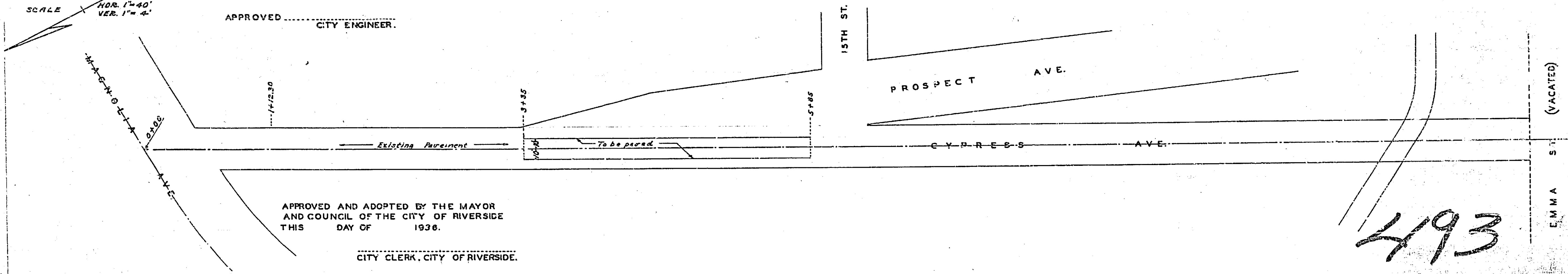

APPROVED AND ADOPTED BY THE MAYOR
 AND COUNCIL OF THE CITY OF RIVERSIDE
 THIS DAY OF 1936.

CITY CLERK, CITY OF RIVERSIDE.

493