

PROPERTY OF
CITY OF RIVERSIDE
CITY ENGINEERING DEPT.

PROPERTY OF
CITY OF RIVERSIDE
CITY ENGINEERING DEPT.

Lot 225
5CCA.

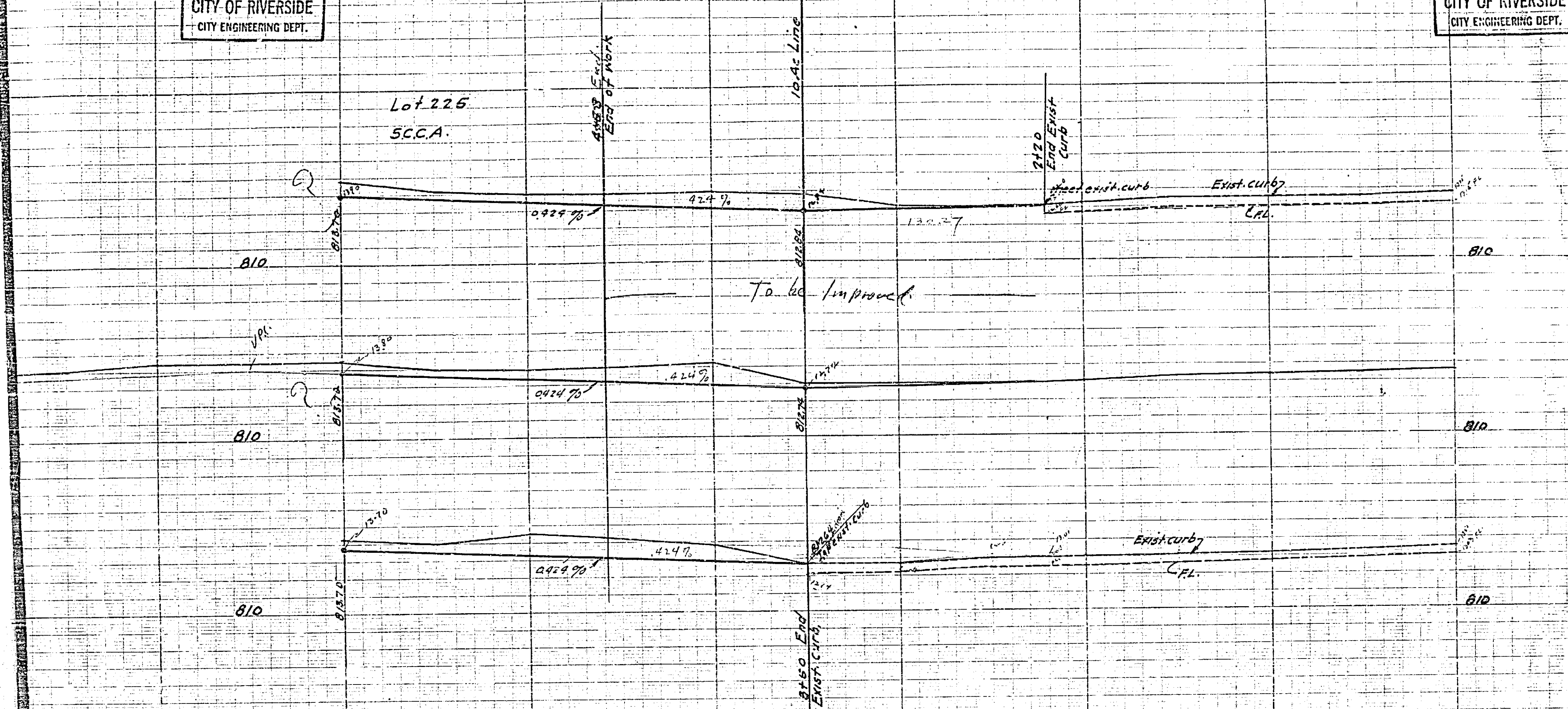

PLAN - PROFILE
LINWOOD PLACE EXTENSION
Scale - 1" = 40' Hor.
1" = 4' Vert.
November - 1949.

140

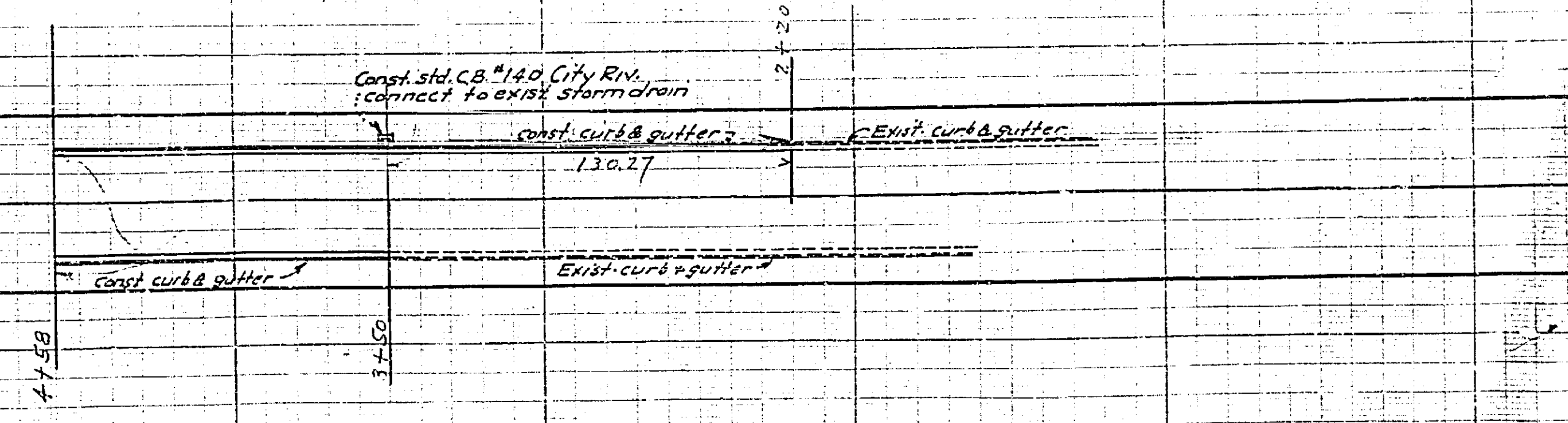

Approved: *M. H. Swaine*
City Engineer
Feb. 10, 1950

PROPERTY OF
CITY OF RIVERSIDE
CITY ENGINEERING DEPT.

PROPERTY OF
CITY OF RIVERSIDE
CITY ENGINEERING DEPT.

511B