

THIRTEENTH ST. - MAIN TO ALMOND ST.			
Drawing Number	Sheet Number	Books	Field Books
51	1	353, 366	
Drawn	Checked	Approved	

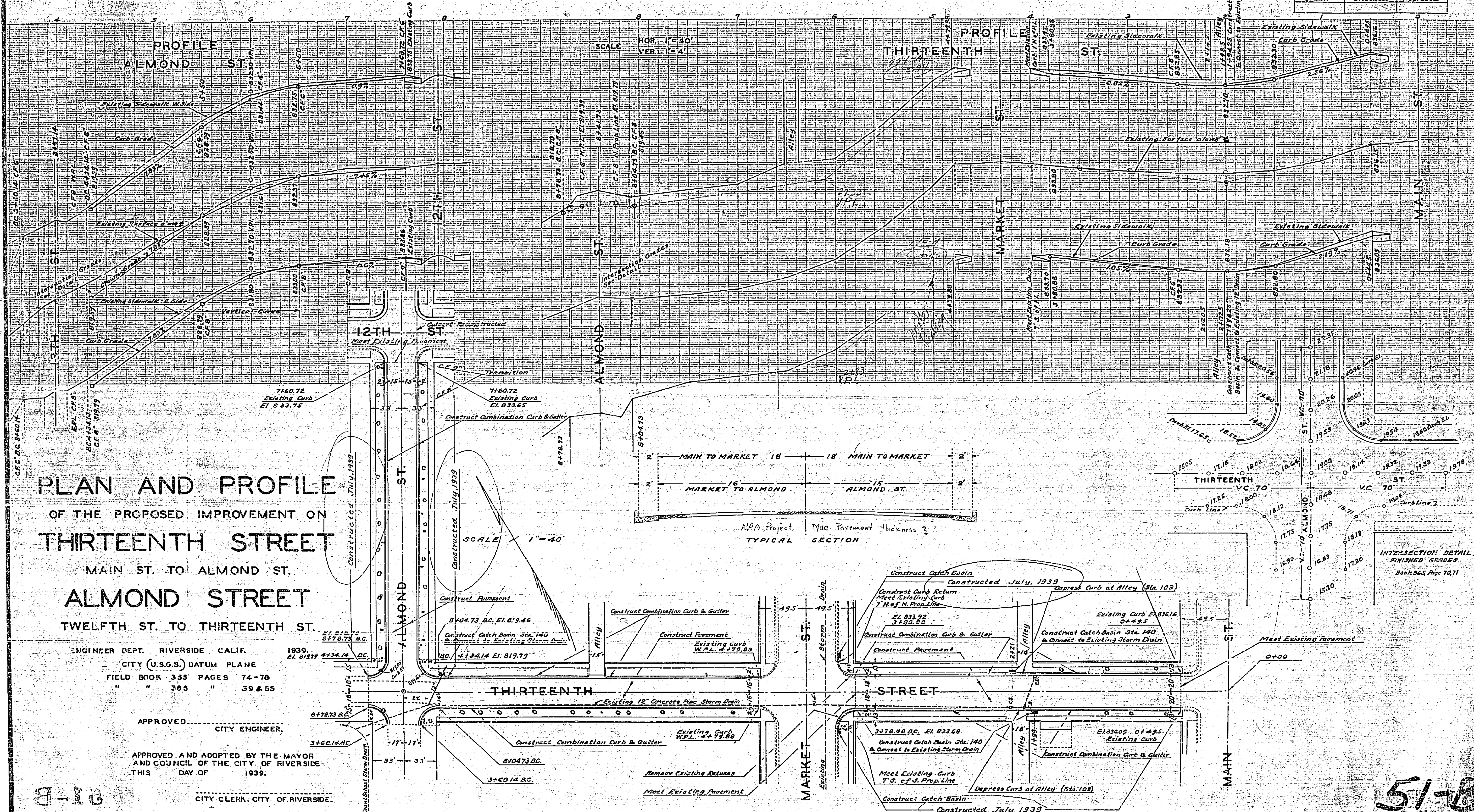

PLAN AND PROFILE
 OF THE PROPOSED IMPROVEMENT ON
THIRTEENTH STREET
 MAIN ST. TO ALMOND ST.
ALMOND STREET
 TWELFTH ST. TO THIRTEENTH ST.

ENGINEER DEPT. RIVERSIDE CALIF. 1939.
 CITY (U.S.G.S.) DATUM PLANE
 FIELD BOOK 355 PAGES 74-78
 " " 365 " 39 & 55

APPROVED _____
 CITY ENGINEER.

APPROVED AND ADOPTED BY THE MAYOR
 AND COUNCIL OF THE CITY OF RIVERSIDE
 THIS _____ DAY OF _____ 1939.

 CITY CLERK, CITY OF RIVERSIDE.

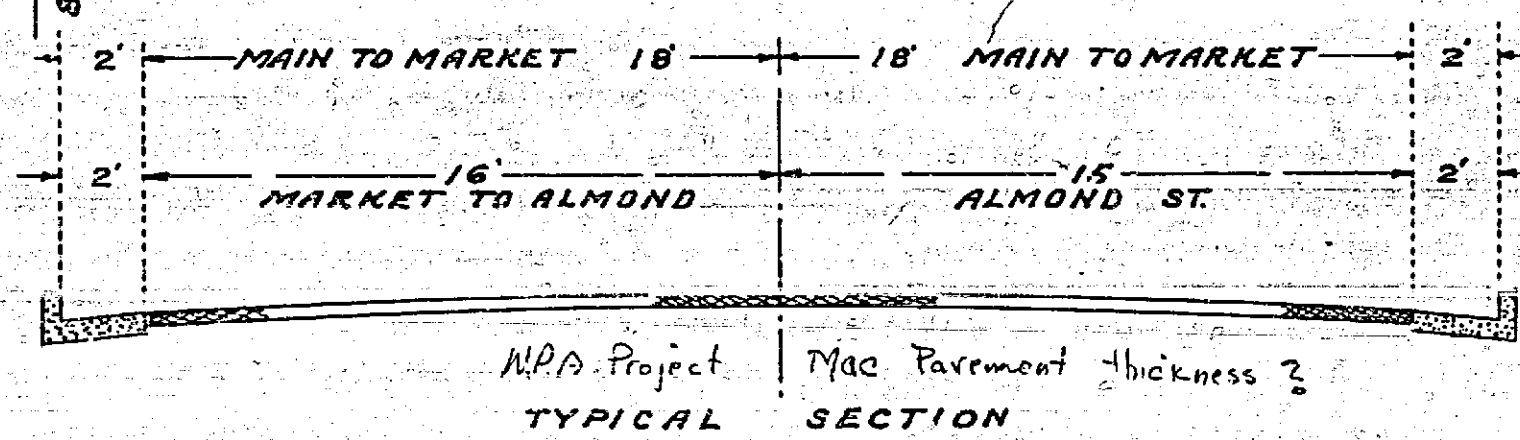

INTERSECTION DETAIL
 FINISHED GRADES
 Book 365, Page 70, 71

51-5