

10
4
05

478/10/1920
14.60
12.15
2.45
005287
4+907
0+273
4763.4

MADISON STREET	
MAGNOLIA AVE. TO ARLINGTON AVE.	
Drawing No. 542	Sheet No. 1
Checked	Checked
G.E.M. 9-14-36	

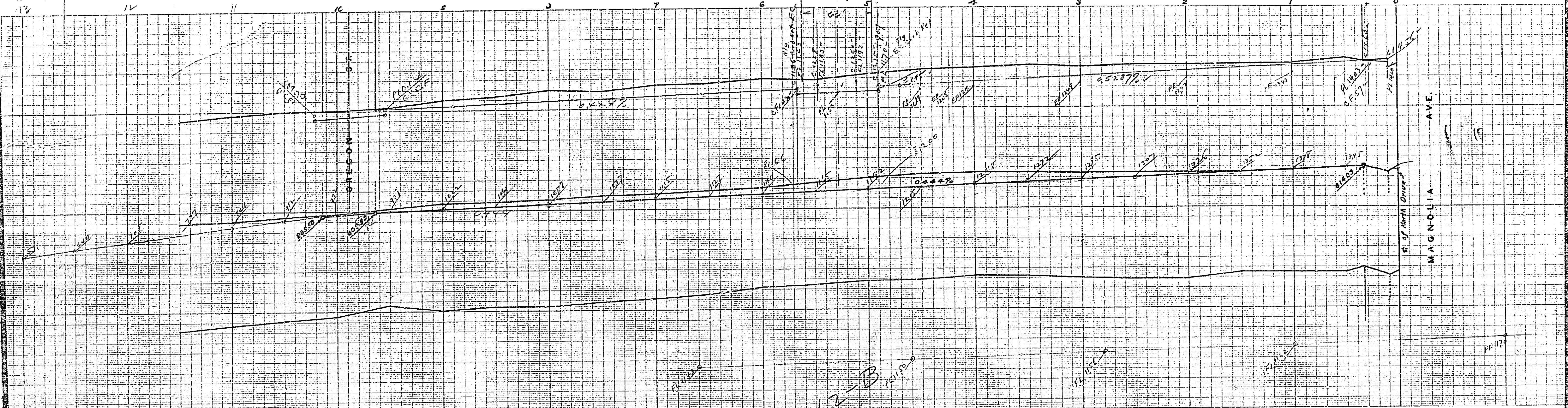

PLANS AND PROFILES

OF THE PROPOSED IMPROVEMENT OF
MADISON STREET
BETWEEN MAGNOLIA AVE. & ARLINGTON AVE.

ENGINEER DEPT. RIVERSIDE CALIF. 1936.
CITY (U.S.G.S.) DATUM PLANE
FIELD BOOK 321 PAGES 20-34

See # 542-B

SCALE
HOR. 1" = 40'
VER. 1" = 2'

APPROVED.....
CITY ENGINEER.

Constructed by Street Dept. 1936.

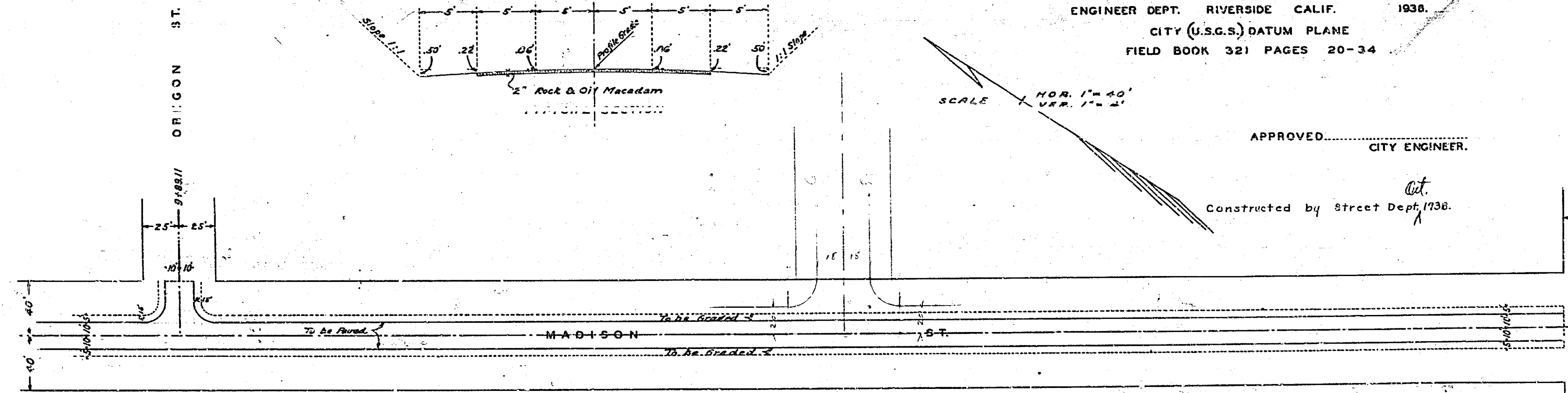

APPROVED AND ADOPTED BY THE MAYOR
AND COUNCIL OF THE CITY OF RIVERSIDE
THIS DAY OF 1936.

CITY CLERK, CITY OF RIVERSIDE.

542

10
4
05

15
14
13

MADISON STREET MADISON AVE. TO ARLING ST.	
Drawing No. 542-2	Sheet No. 2
DATE 7-19-36	CHECKED

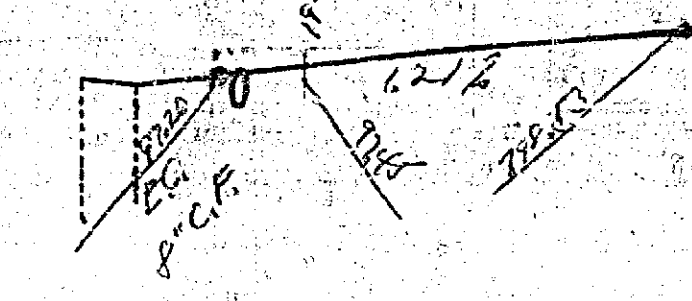
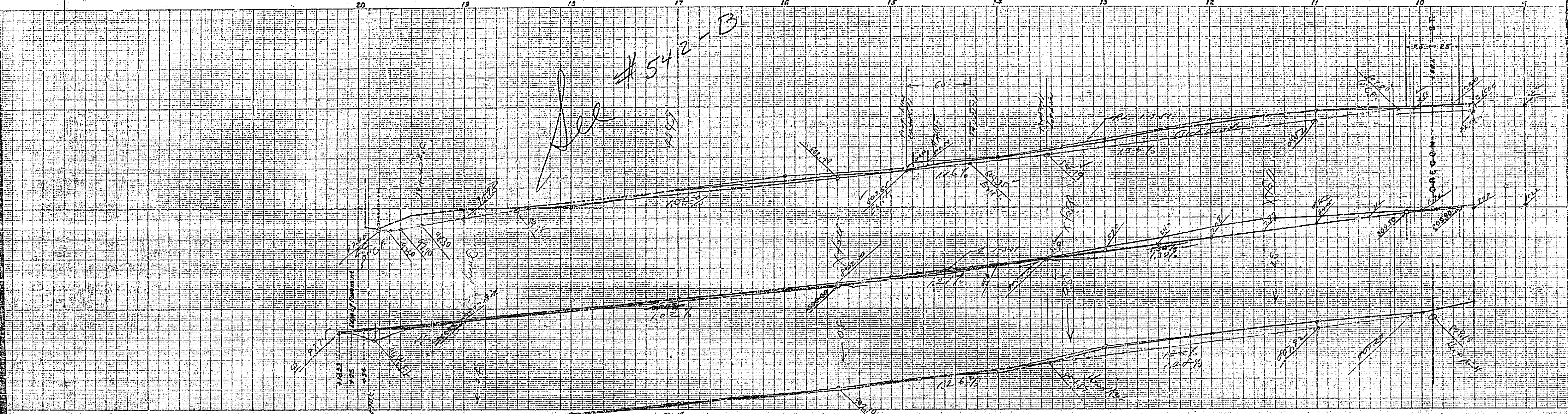

1375.11
1272.11
32.700
10136
44.5
4.8
932

See #542-3

SCALE HOR. 1"=40'
VER. 1"=4'

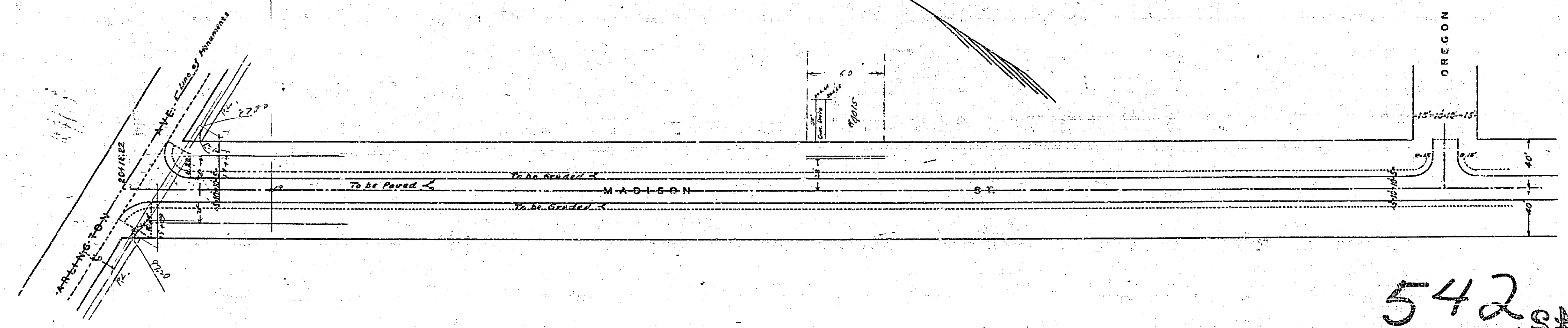

542 ST

15
14
13