

PLAN AND PROFILE
NO. 546
FOR THE IMPROVEMENT OF
MAUDE STREET
FROM LINCOLN AVENUE TO ARLINGTON AVENUE
BEING A
MAJOR CITY STREET
IN THE CITY OF RIVERSIDE
SCALES: HOR. 1 IN. = 50 FT.
VERT. 1 IN. = 5 FT.

APPROVED *M. H. Swain*
RIVERSIDE REG. C.E. 3011
CITY ENGINEER

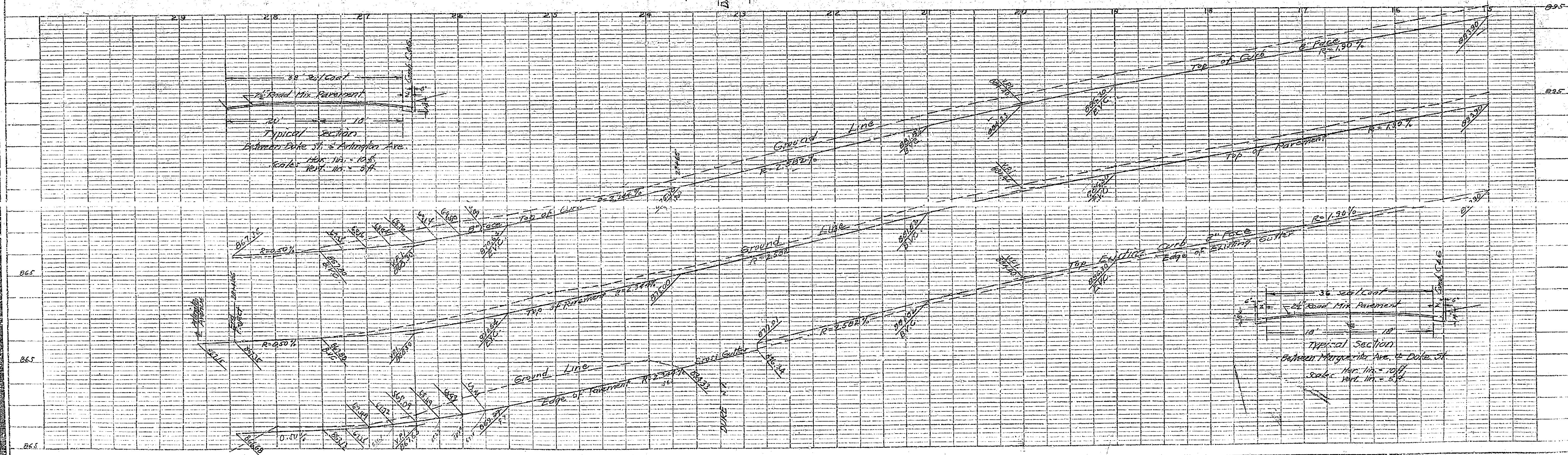
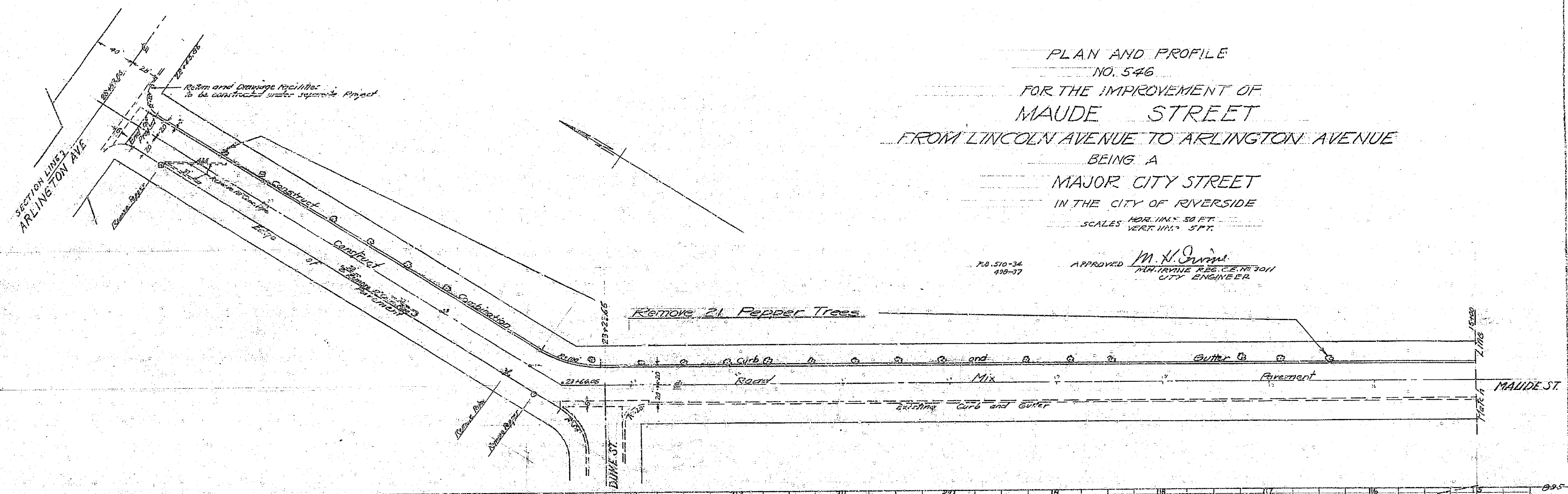

| | | |
|-----|------|-----------|
| NO. | DATE | REVISIONS |
| | | |
| | | |

| | | |
|-----|------|-----------|
| NO. | DATE | REVISIONS |
| | | |
| | | |

546

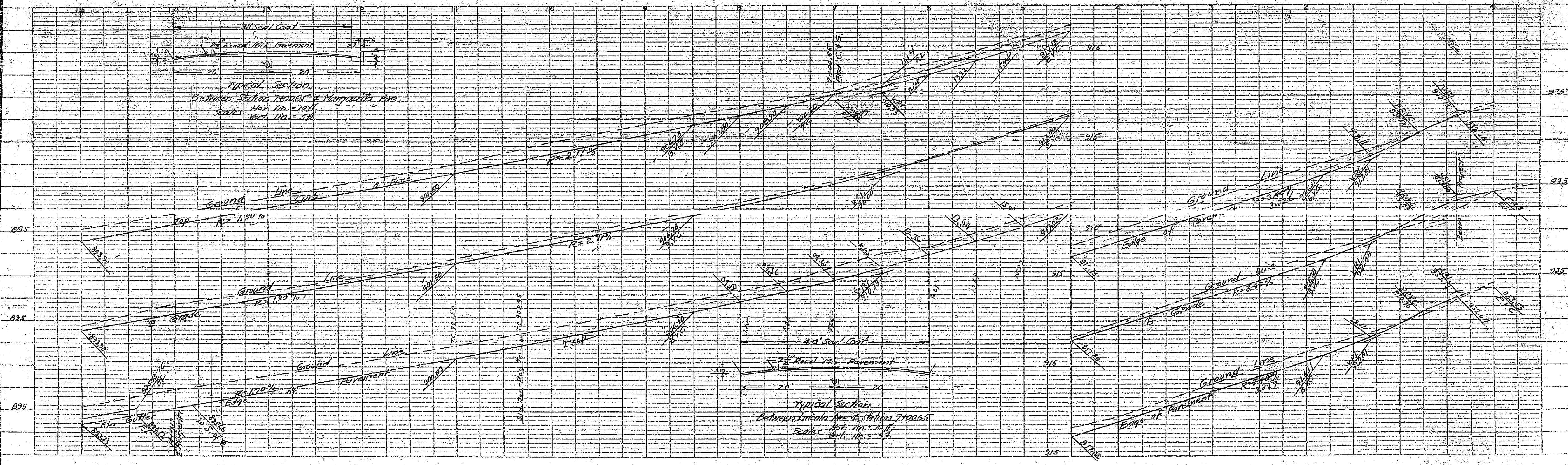
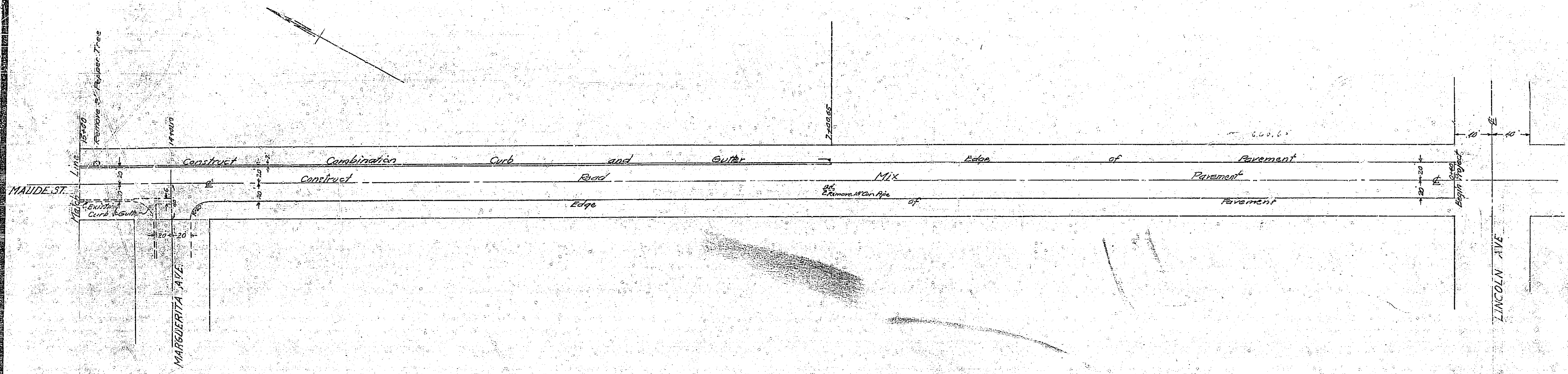

| | |
|----------|--|
| DATE | |
| PROJECT | |
| DESIGNER | |
| CHECKER | |
| APPROVED | |
| SCALE | |

| | |
|----------|--|
| DATE | |
| PROJECT | |
| DESIGNER | |
| CHECKER | |
| APPROVED | |
| SCALE | |

546