

220

PROPERTY OF
CITY OF RIVERSIDE
CITY ENGINEERING DEPT.

PROPERTY OF
CITY OF RIVERSIDE
CITY ENGINEERING DEPT.

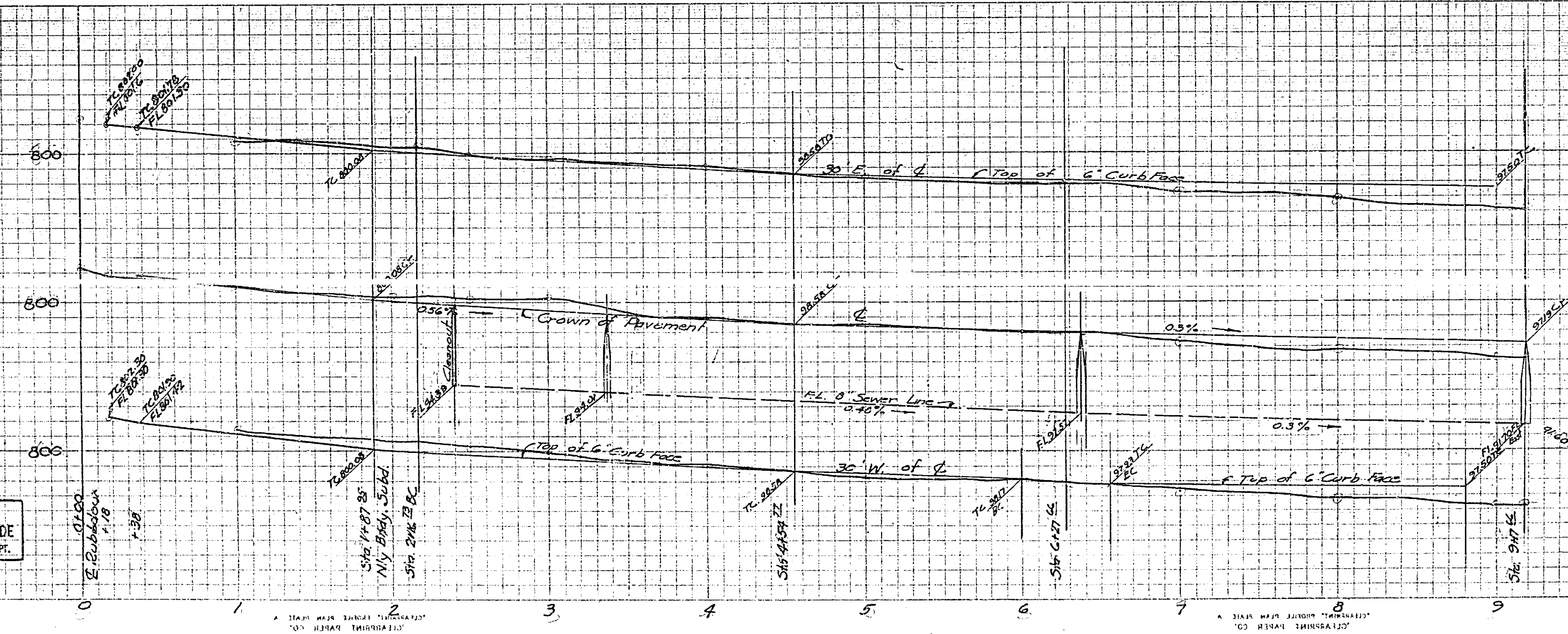
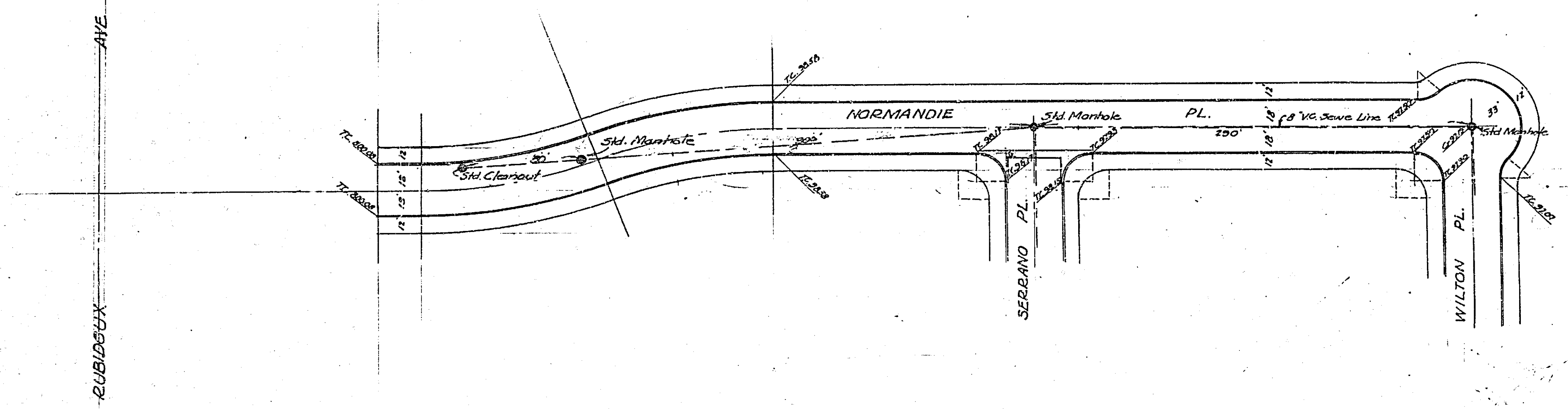

- Note
1. City BM. Jurupa Ave spike in R. Role # 6269 at intersection 750A & B
 2. Tack in Lead NW Corner Weir Box SE Corner Grand & Rubidoux Ave El. 804.56
 3. N. & T. & Grand 27+00 El. 799.23
 4. " " " 34+00 El. 803.15
 5. " " " 37+00 El. 802.12
 6. All Curbs have 6" Face unless otherwise noted

Approved by M. H. Durbin
City Engineer

No 550
Plan & Profile
for
GRAND MANOR

J. F. Davidson, C.E. May 1951
Scale Hor 1"=40'
Vert 1"=4'

PROPERTY OF
CITY OF RIVERSIDE
CITY ENGINEERING DEPT.

PROPERTY OF
CITY OF RIVERSIDE
CITY ENGINEERING DEPT.

550

FB 412-35

PROPERTY OF
CITY OF RIVERSIDE
CITY ENGINEERING DEPT.

Sheet 2 of 3 Streets

PROPERTY OF
CITY OF RIVERSIDE
CITY ENGINEERING DEPT.

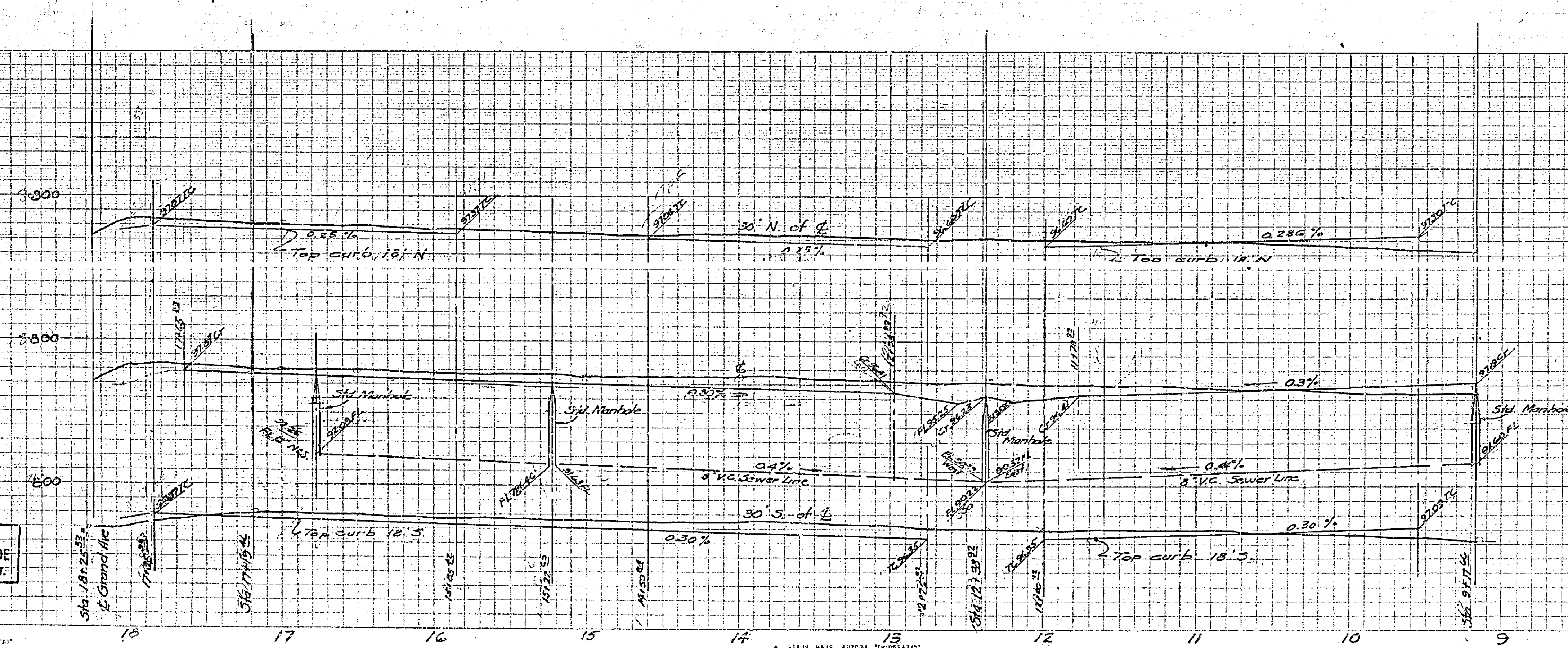
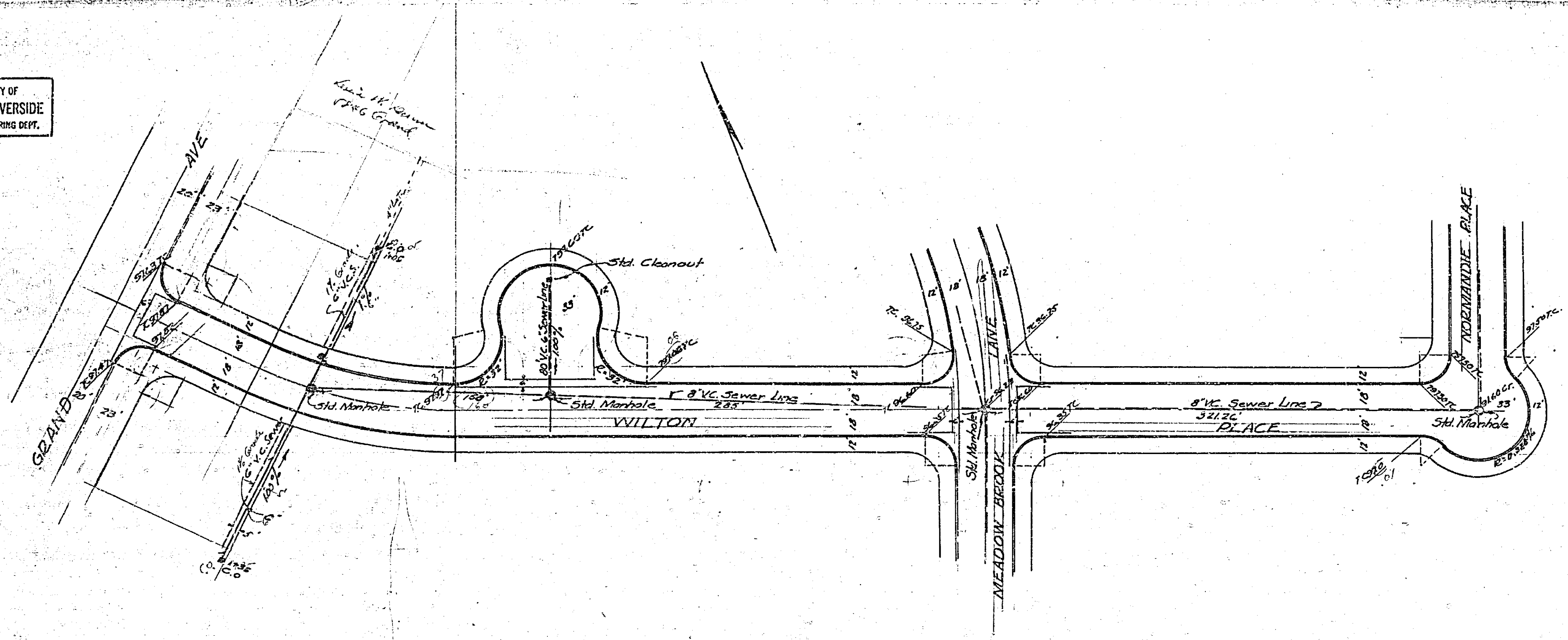

Approved by *M. H. Swaine*
City Engineer

No 550
Plan & Profile
for
GRAND MANOR

J. F. Davidson C.E. May 1951
Scale Horl. = 10'
Vertl. = 4'

PROPERTY OF
CITY OF RIVERSIDE
CITY ENGINEERING DEPT.

PROPERTY OF
CITY OF RIVERSIDE
CITY ENGINEERING DEPT.

550

FB 412-35

PROPERTY OF
CITY OF RIVERSIDE
CITY ENGINEERING DEPT.

Sheet 3 of 3 Sheets

PROPERTY OF
CITY OF RIVERSIDE
CITY ENGINEERING DEPT.

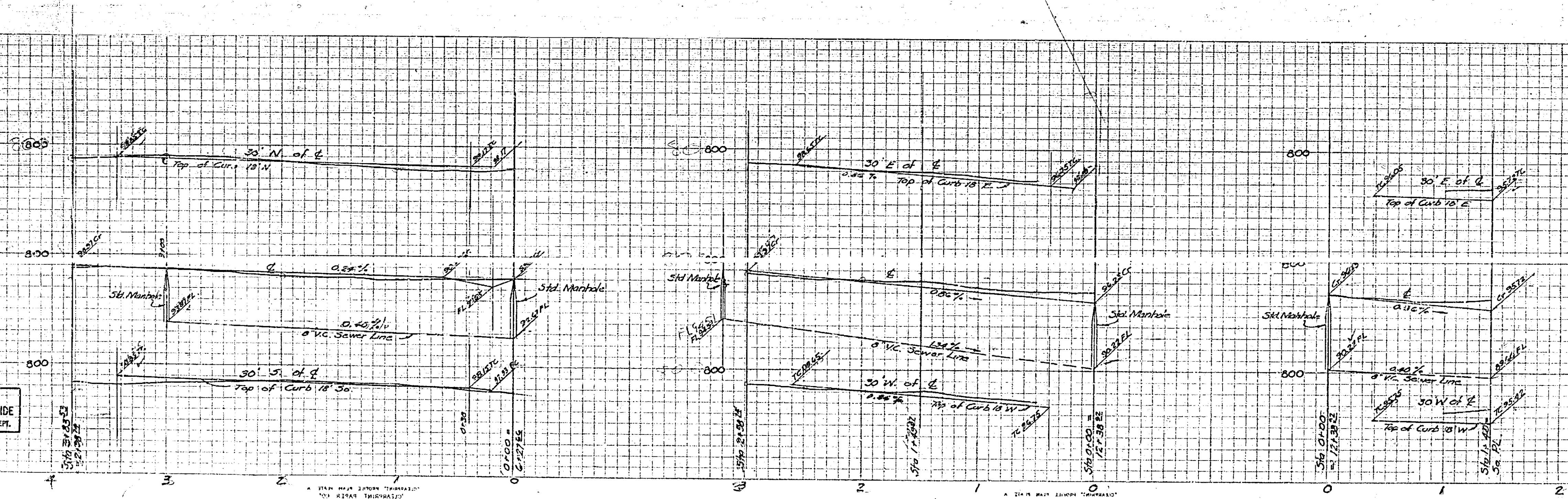
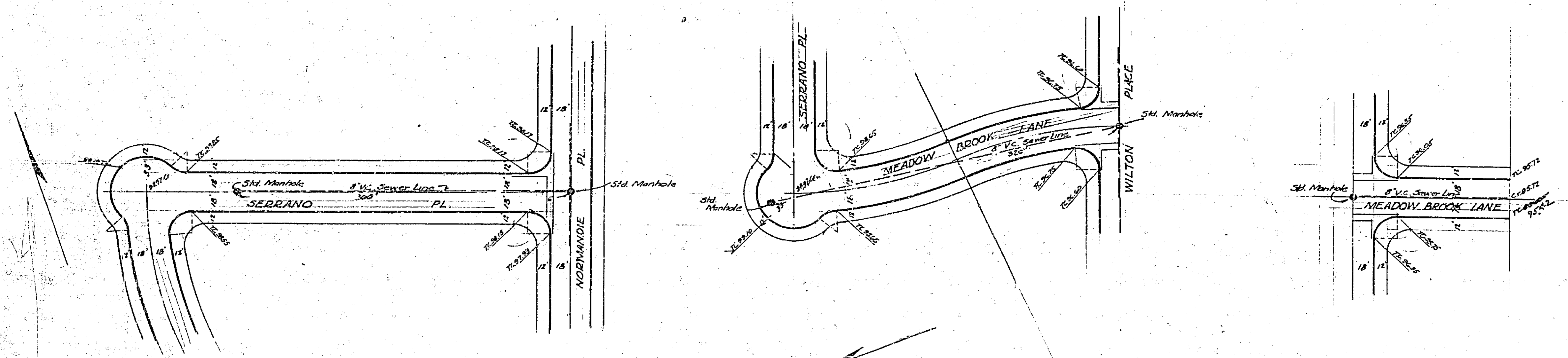

Approved by *M. H. ...*
City Engineer

No. 550
Plan & Profile
for
GRAND MANOR

J.F. Davidson CE May 1951
Scale: Hor. 1" = 40'
Vert. 1" = 4'

PROPERTY OF
CITY OF RIVERSIDE
CITY ENGINEERING DEPT.

PROPERTY OF
CITY OF RIVERSIDE
CITY ENGINEERING DEPT.

550