

EIGHTH STREET KANSAS AVE. TO CHICAGO AVE.		
Drawing No.	Sheet No.	Total Sheets
351-33	1	250, 251
Designed	Checked	
4/20/37	R	

**PLANS AND PROFILES**  
 OF THE PROPOSED IMPROVEMENT OF  
**EIGHTH STREET**  
 BETWEEN KANSAS AVE. & CHICAGO AVE.  
 STATE HIGHWAY ROUTE NO. 19

ENGINEER DEPT. RIVERSIDE, CALIF. 1937.  
 CITY (U.S.G.S.) DATUM PLANE  
 FIELD BOOK 250 PAGES 19-29  
 " 252 " 2-24

CONSTRUCTED BY STREET DEPT. 1937.

APPROVED *[Signature]*  
 CITY ENGINEER.

APPROVED AND ADOPTED BY THE MAYOR  
 AND COUNCIL OF THE CITY OF RIVERSIDE  
 THIS 4<sup>th</sup> DAY OF *May* 1937.

*[Signature]*  
 CITY CLERK, CITY OF RIVERSIDE.

351A

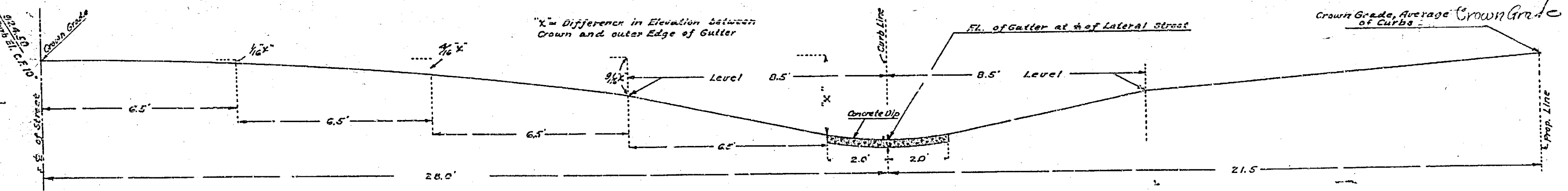
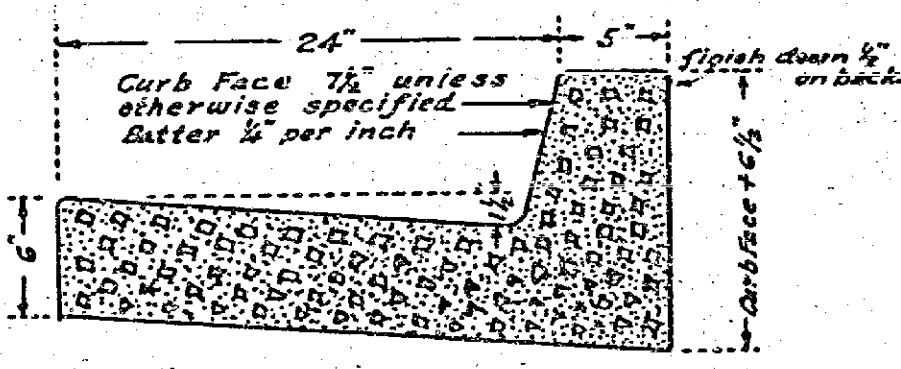
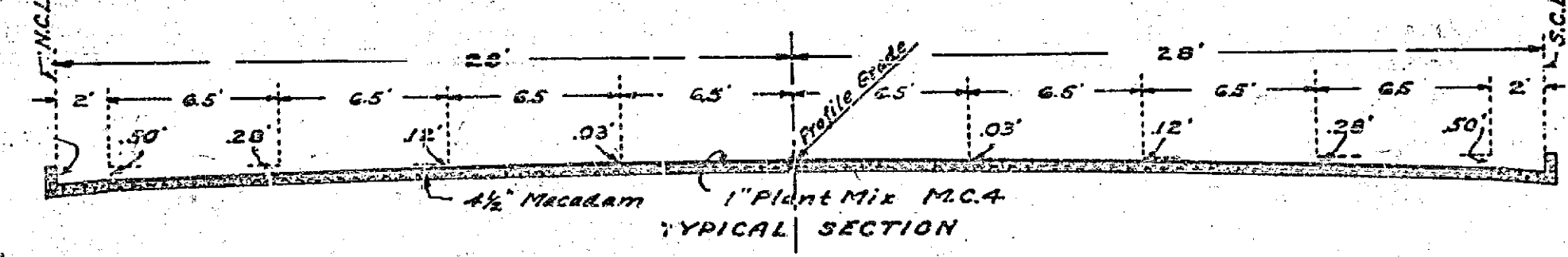
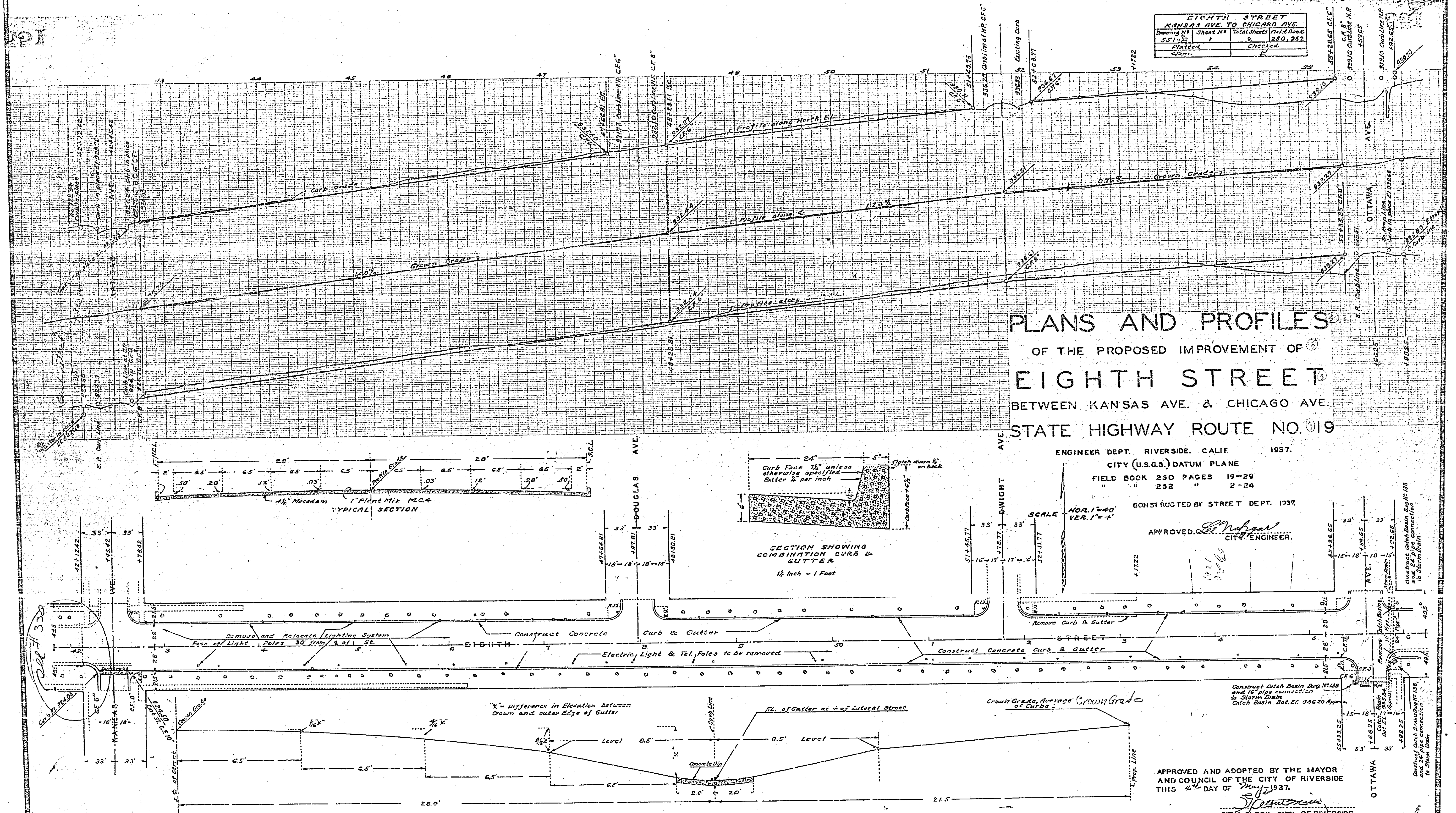

351A

351A



EIGHTH STREET KANSAS AVE. TO CHICAGO AVE.			
Drawing No.	Sheet No.	Total Sheets	Field Book
551A	2	250	250
Checked	Checked		
adm.			

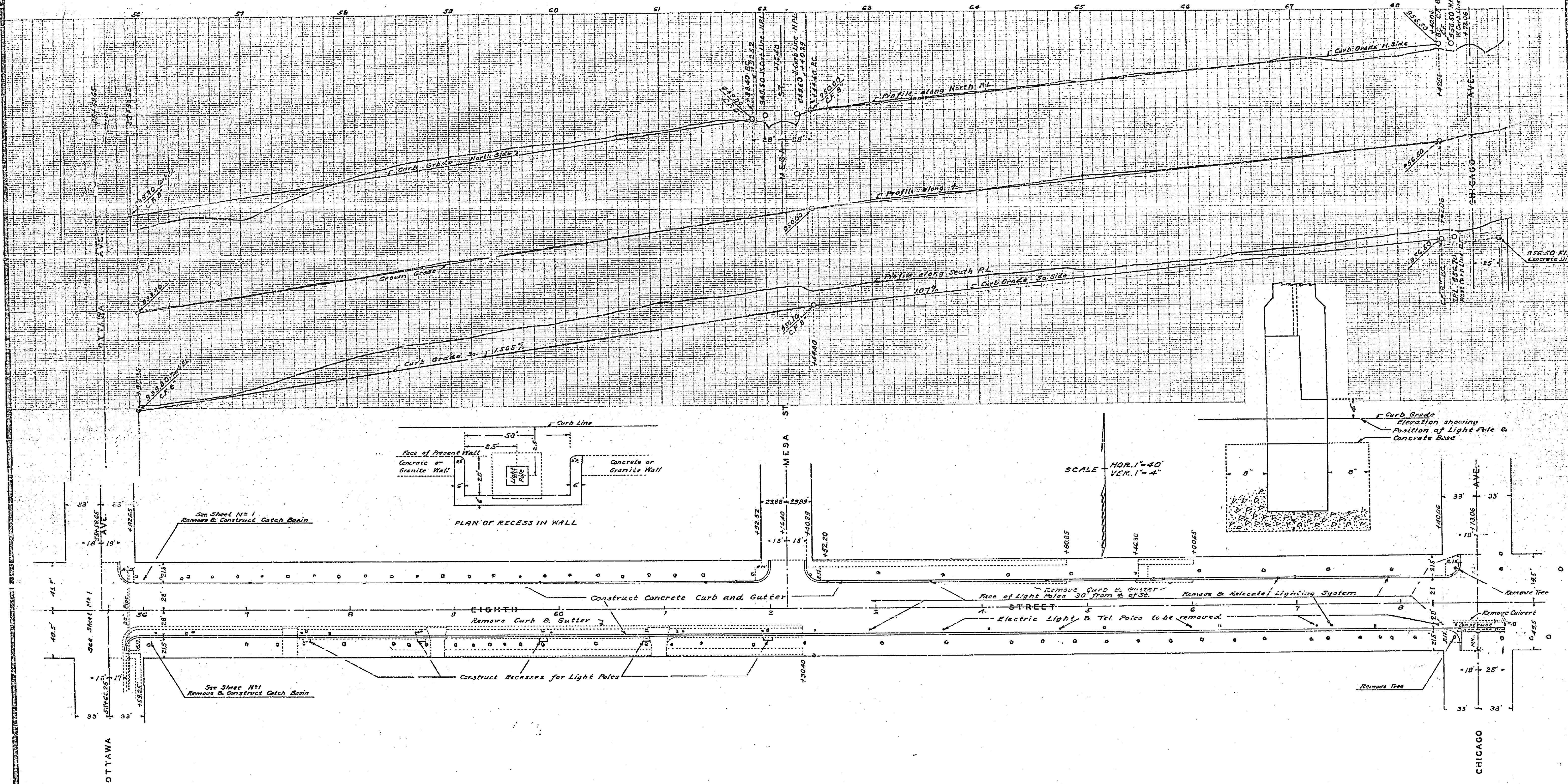

551A

166