

PLAN AND PROFILE  
 NO. 554-B  
 FOR THE CONSTRUCTION OF CURBS AND GUTTERS ON  
**KANSAS AVENUE**  
 BETWEEN MASSACHUSETTS AVE. AND INDIANAPOLIS AVE.  
 RIVERSIDE, CALIFORNIA

SCALES: HORIZ. 1" = 40'  
 VERT. 1" = 4'  
 March, 1947

F.B. 430/2  
 F.B. 396/17  
 F.B. 424/2

APPROVED: M.H. IRVING, REG. CIVIL ENGR. 901  
 CITY ENGINEER

21+44.40  
 Does not check  
 Show

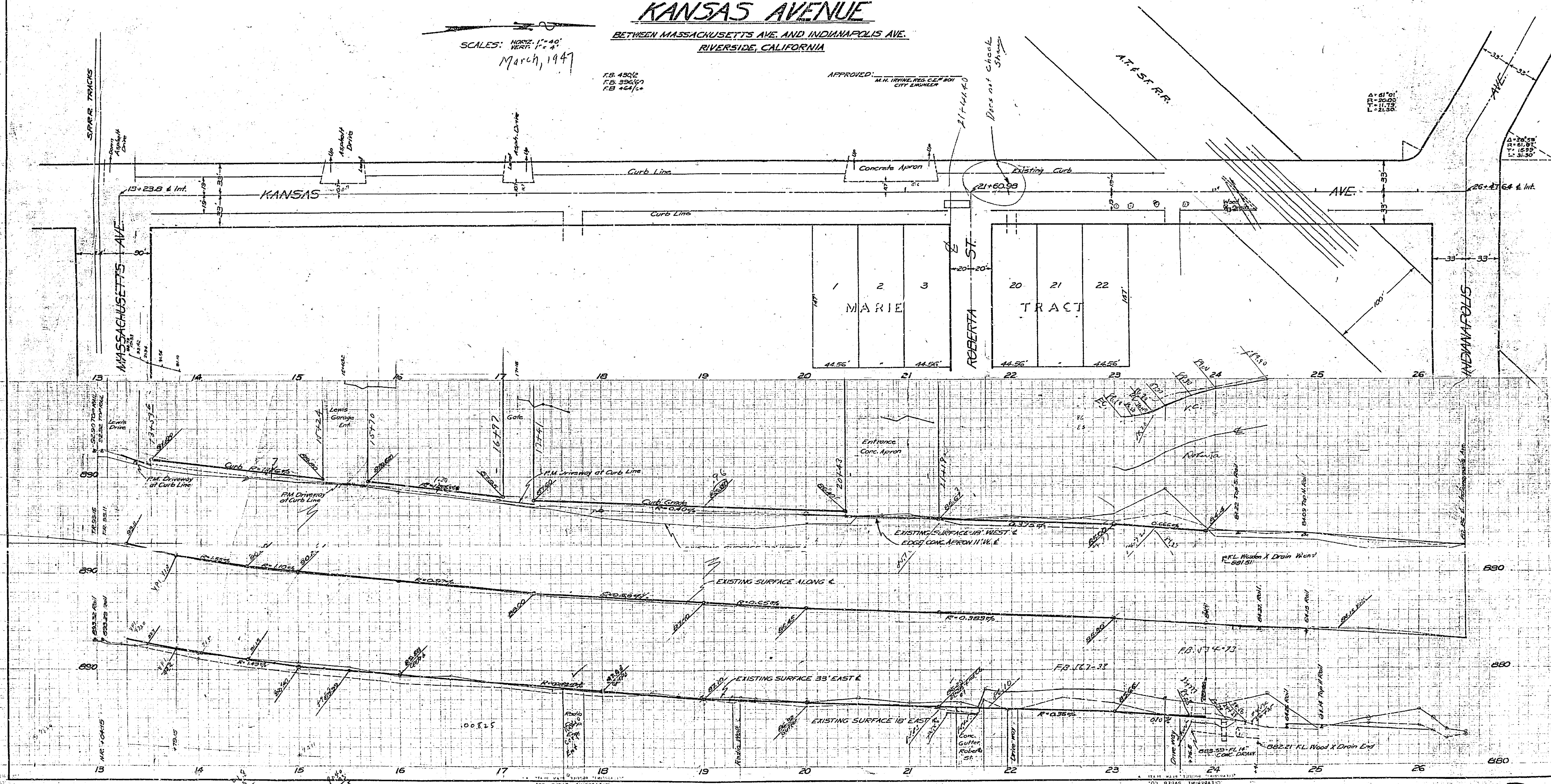

554B

F.B. 534-73