

Cridge St. Victoria to Somerset			
Drawing Number	Sheet Number	Total Sheets	Plan
570	1	317	
Drawn	Checked	Approved	
Arthur H. Nelson	AB	L	
Aug. 6-1938			

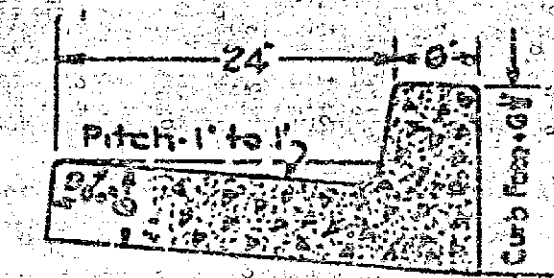

PLAN
SCALE ~ 1" = 20'

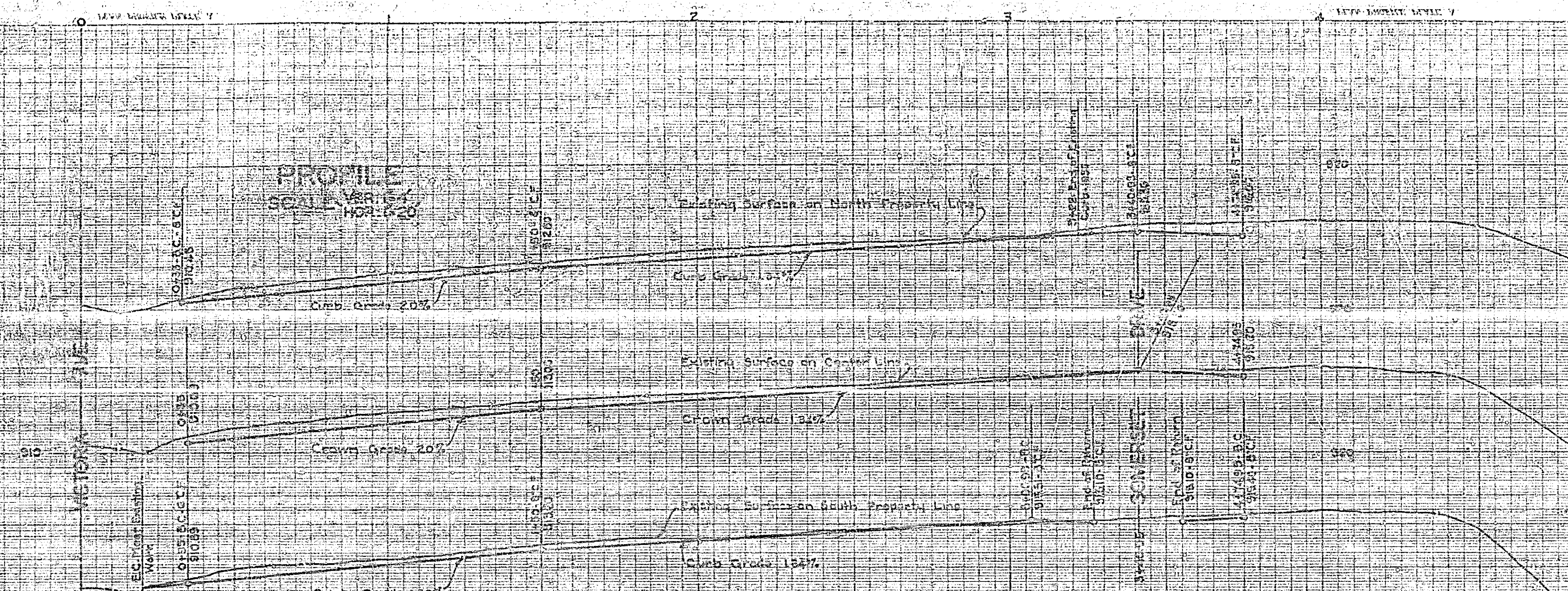
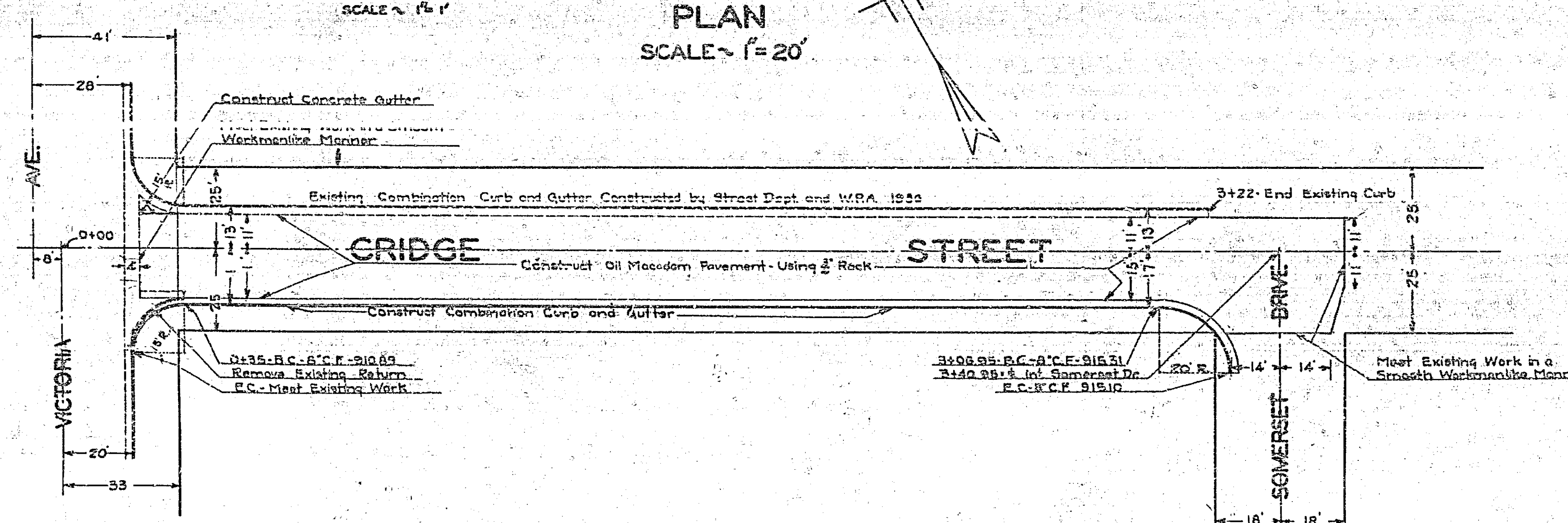

PLAN AND PROFILE
OF THE PROPOSED IMPROVEMENT OF
CRIDGE STREET
FROM
VICTORIA AVENUE
TO
SOMERSET DRIVE

ENGINEERING DEPT. CITY OF RIVERSIDE 1938
APPROVED *Arthur H. Nelson*
CITY ENGINEER

570