

PLAN AND PROFILE
NO. 578-B
TO ESTABLISH GRADES ON
ARCH WAY
BETWEEN MARMIAN WAY AND CENTRAL AVE.
RIVERSIDE, CALIFORNIA

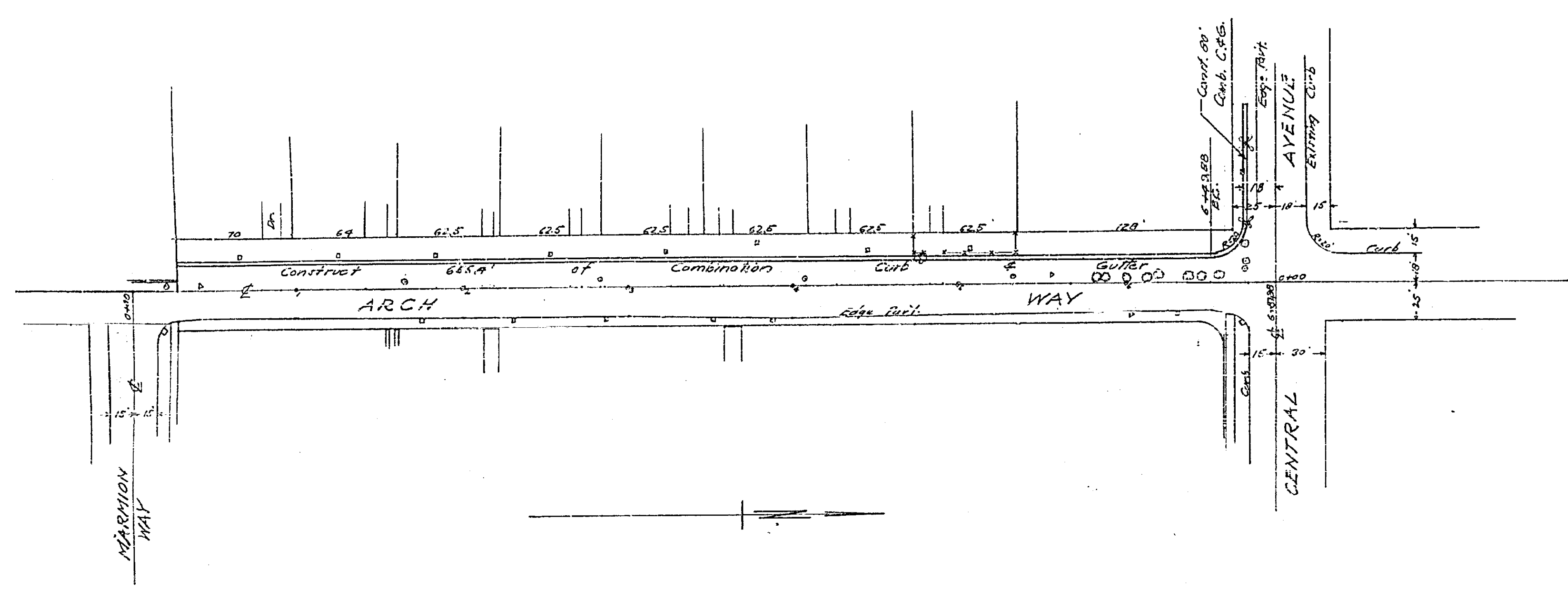

F.B. 386/47

SCALES: HORIZ. 1"=50'
VERT. 1"=5'

APPROVED: M. H. Irvine.
M. H. IRVINE, REG. C.E. NO. 3011
CITY ENGINEER

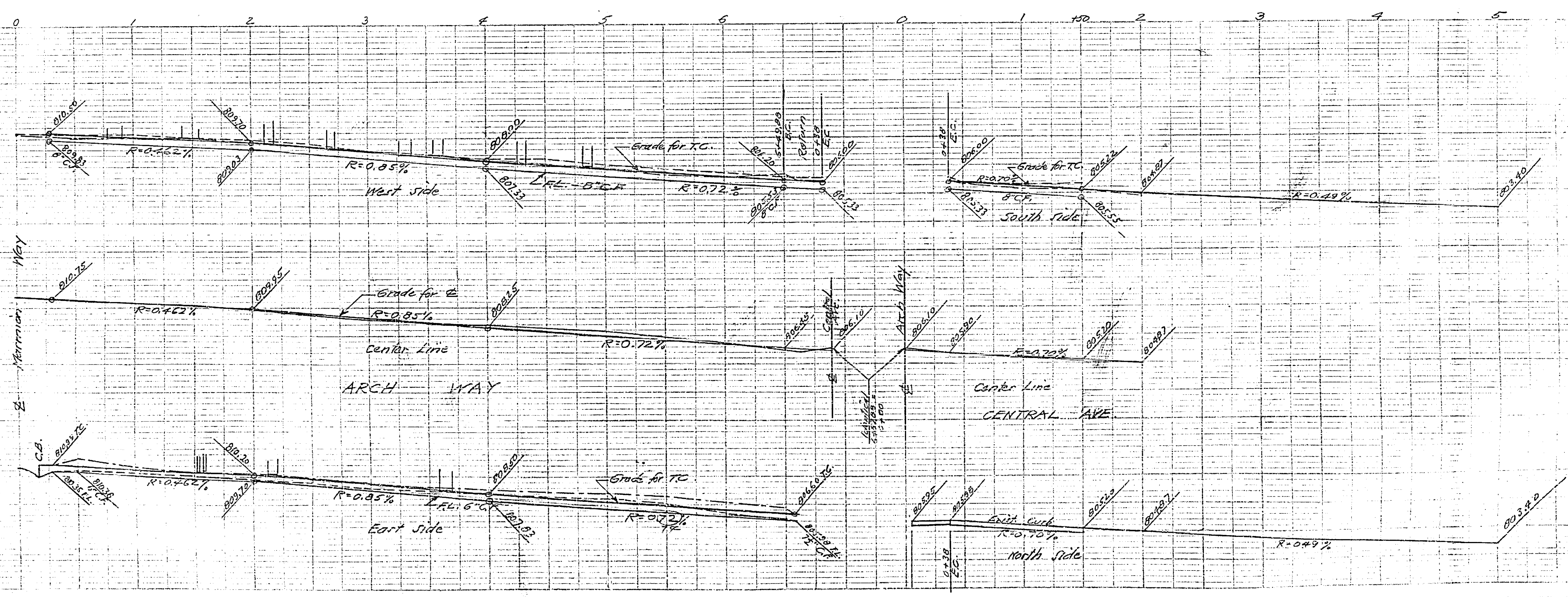

578 B