

PROFILE
 Scale
 Horz. 1" = 40'
 Vert. 1" = 4'
 U. S. G. S.

PLAN

GARDENA DRIVE
 ENGINEERING DEPT. RIVERSIDE CALIF.
 FIELD BOOK 279 PAGES 7-18
 APRIL 1934

Scale - 1" = 40'

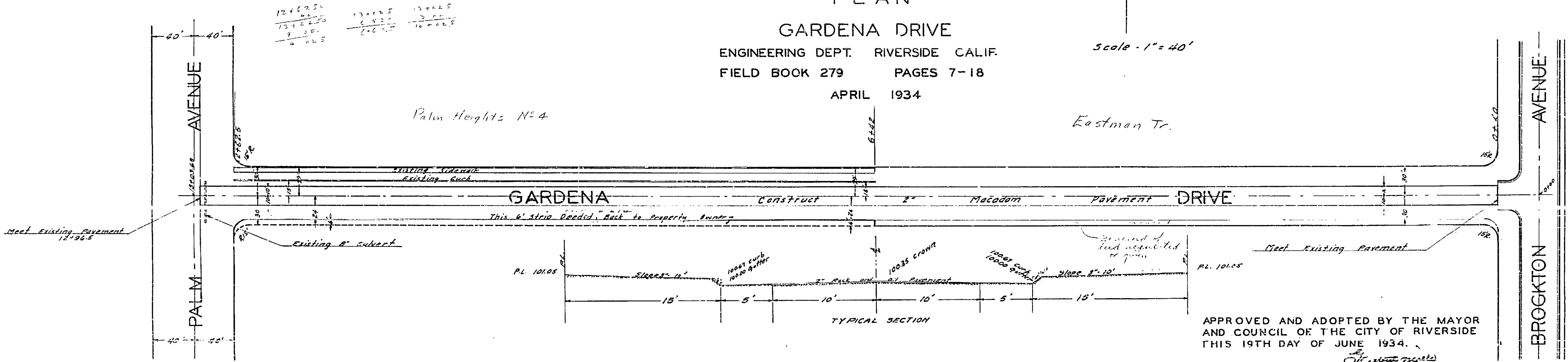

APPROVED AND ADOPTED BY THE MAYOR
 AND COUNCIL OF THE CITY OF RIVERSIDE
 THIS 19TH DAY OF JUNE 1934.
 City Clerk, City of Riverside.

593