

9TH STREET

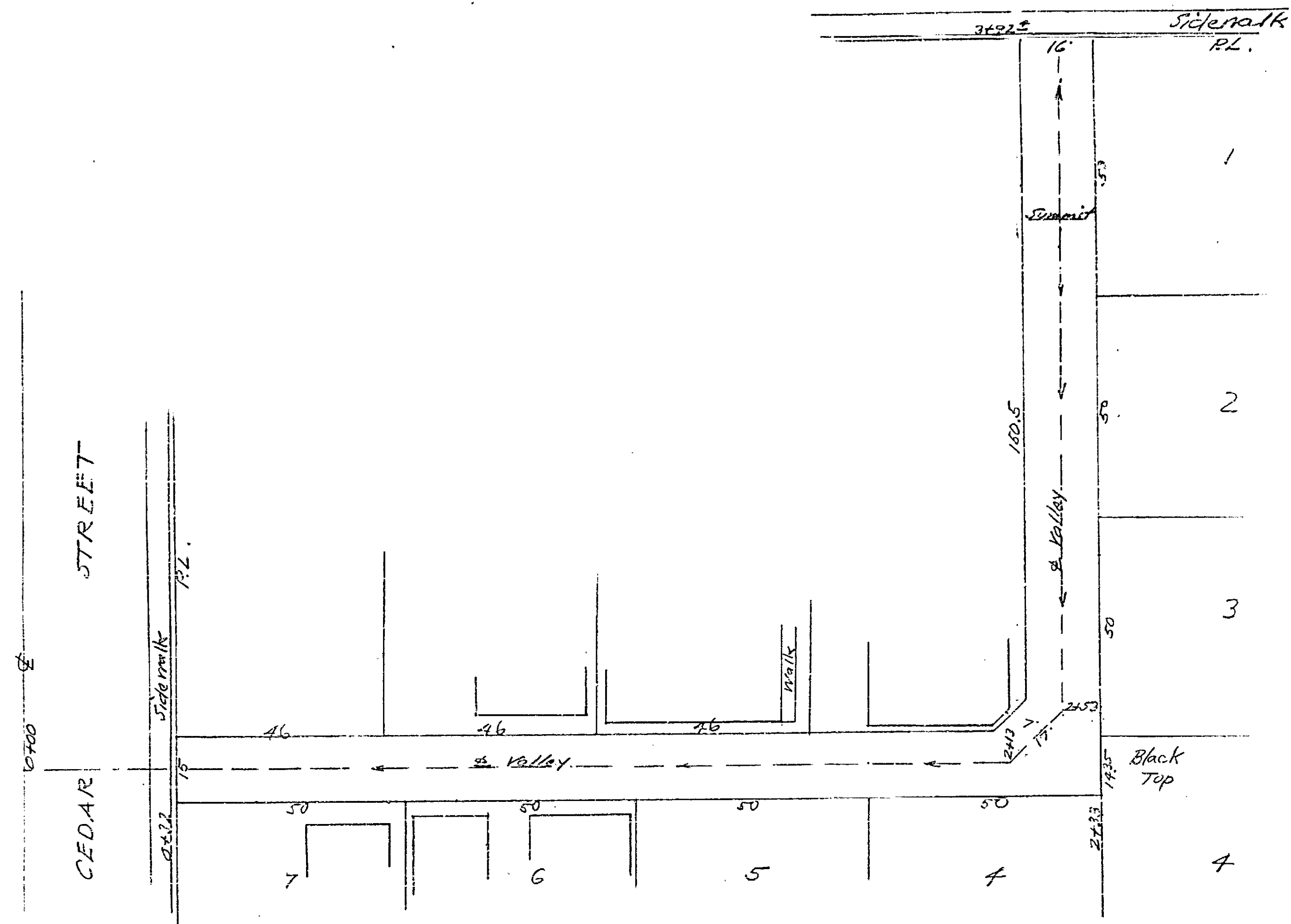

PLAN AND PROFILE No. 599
 SHOWING PROPOSED IMPROVEMENT OF
 THE ALLYS IN THE BLOCK BOUNDED BY
 Block 9 Range 12
 9TH-10TH-LOCUST AND CEDAR STREETS.

CITY OF RIVERSIDE - CALIFORNIA
 P.B. 508-63 APRIL 1952

SCALE: HOR. 1" = 20 FT.
 VERT. 1" = 2 FT.

APPROVED: PHILIP WHITE, CITY ENGINEER

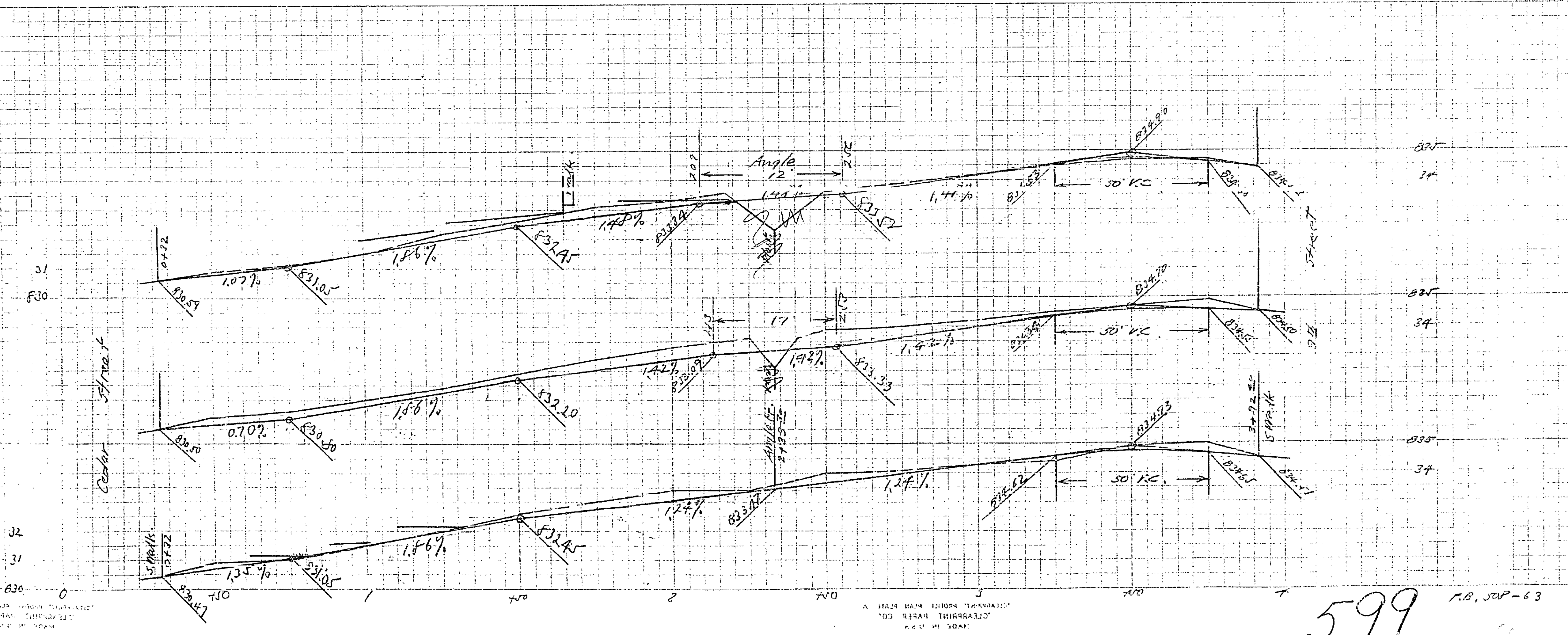

599 P.B. 508-63

MADE IN U.S.A.
 CLEARPRINT PAPER CO.
 100 ALBANY, N.Y.

MADE IN U.S.A.
 CLEARPRINT PAPER CO.
 100 ALBANY, N.Y.