

PROPERTY OF
CITY OF RIVERSIDE
CITY ENGINEERING DEPT.

PROPERTY OF
CITY OF RIVERSIDE
CITY ENGINEERING DEPT.

PLAN AND PROFILE
NO. 601-C
FOR THE CONSTRUCTION OF
CURBS AND GUTTERS
ON NELSON STREET
BETWEEN MAGNOLIA & BROCKTON AVENUES

SCALE: HORIZ. 1" = 40 FT.
VERT. 1" = 4 FT.

APR 20 1953

APPROVED *M. H. Irvine*
CITY ENGINEER

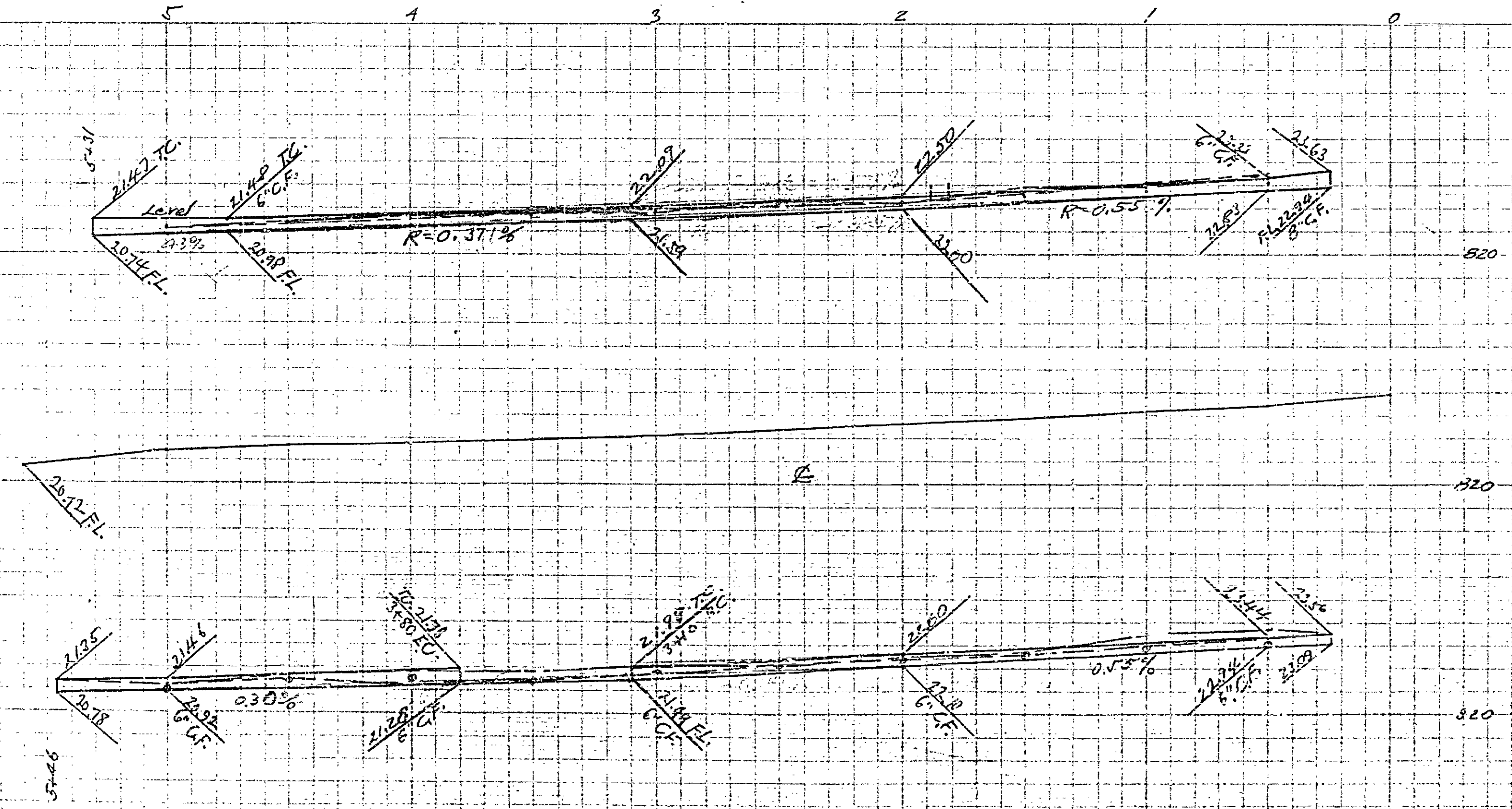
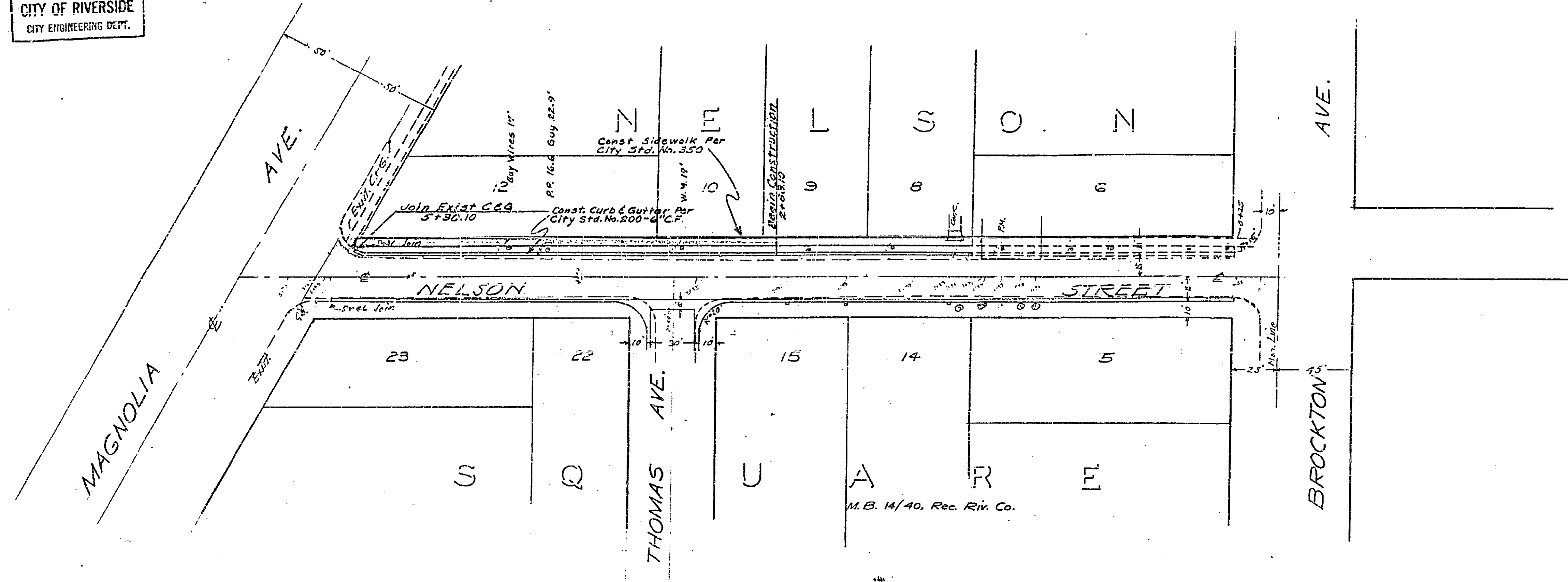

PROPERTY OF
CITY OF RIVERSIDE
CITY ENGINEERING DEPT.

PROPERTY OF
CITY OF RIVERSIDE
CITY ENGINEERING DEPT.

MADE IN U.S.A.
CITY ENGINEERING DEPT.
CITY OF RIVERSIDE

MADE IN U.S.A.
CITY ENGINEERING DEPT.
CITY OF RIVERSIDE

601-C