

PROFILE

SCALE - HOR. 1" = 40'
VER. 1" = 4'

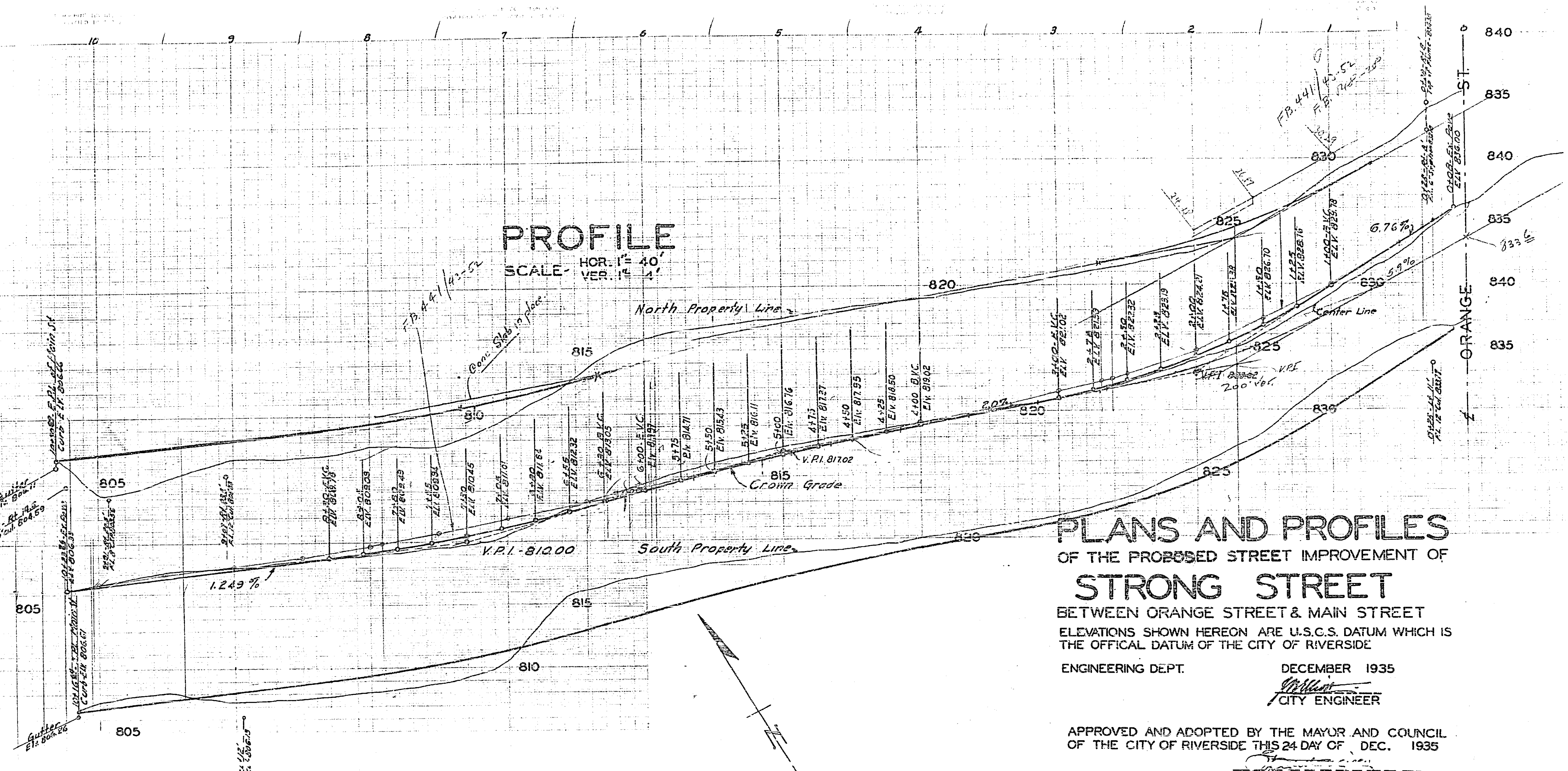

PLANS AND PROFILES OF THE PROPOSED STREET IMPROVEMENT OF STRONG STREET

BETWEEN ORANGE STREET & MAIN STREET
ELEVATIONS SHOWN HEREON ARE U.S.C.S. DATUM WHICH IS
THE OFFICIAL DATUM OF THE CITY OF RIVERSIDE

ENGINEERING DEPT. DECEMBER 1935
William
CITY ENGINEER

APPROVED AND ADOPTED BY THE MAYOR AND COUNCIL
OF THE CITY OF RIVERSIDE THIS 24 DAY OF DEC. 1935

CITY CLERK, CITY OF RIVERSIDE:

PLAN

SCALE - 1" = 40'

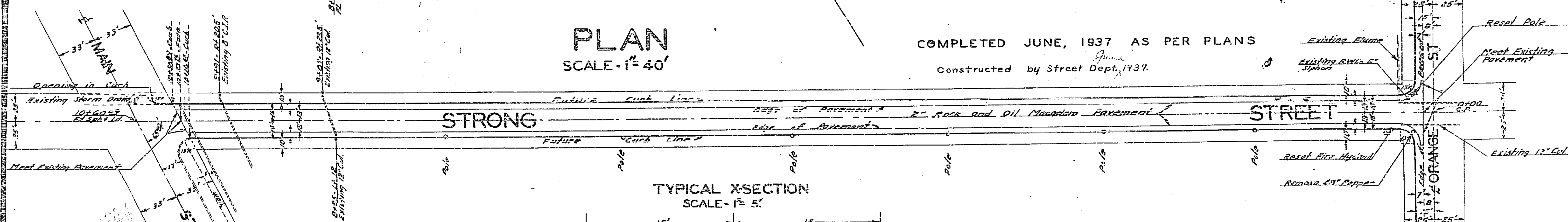

TYPICAL X-SECTION

SCALE - 1" = 5'

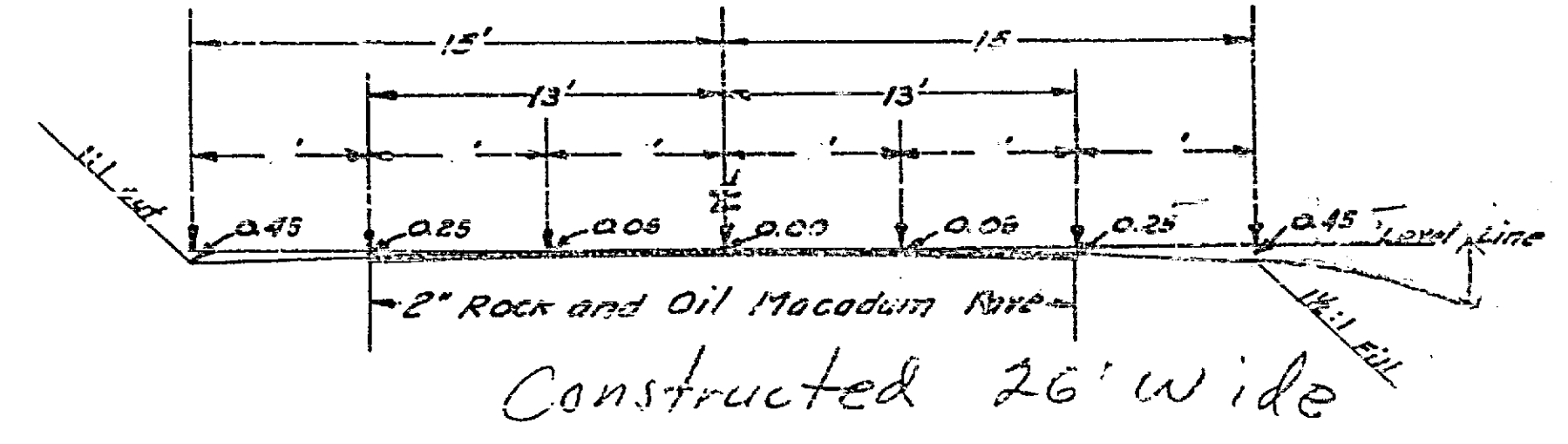

DRWG NO.	SHEET NO.	TOTAL SHEETS	FIELD BOOK
602	1	1	325
PLATTED	CHECKED	APPROVED	
			1936

602