

Drawing No.	Sheet No.	Total Sheets	Drawn By
612	1	1	317
Checked by		Approved by	
W. H. Kelly		J. H. Kelly	
7-3-36			

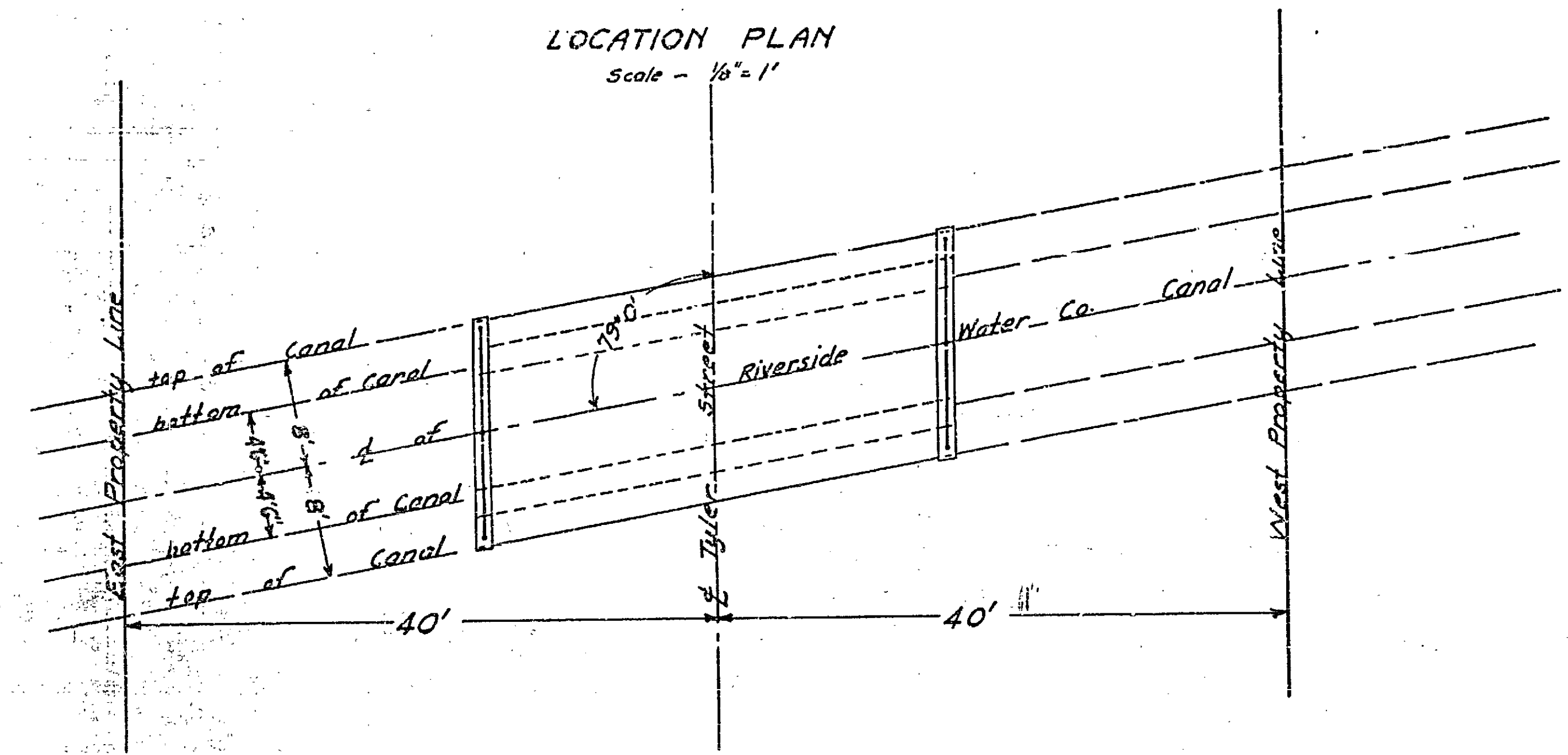

PLAN
OF PROPOSED
BRIDGE
ACROSS
RIVERSIDE WATER CO. CANAL
AT
TYLER STREET
CITY (U.S.G.S.) DATUM

ENGINEERING DEPT.

JANUARY 1936

APPROVED *[Signature]*
CITY ENGINEER

APPROVED AND ADOPTED BY THE MAYOR AND COUNCIL
OF THE CITY OF RIVERSIDE THIS 28 DAY OF JAN. 1936
[Signature]
CITY CLERK, CITY OF RIVERSIDE.

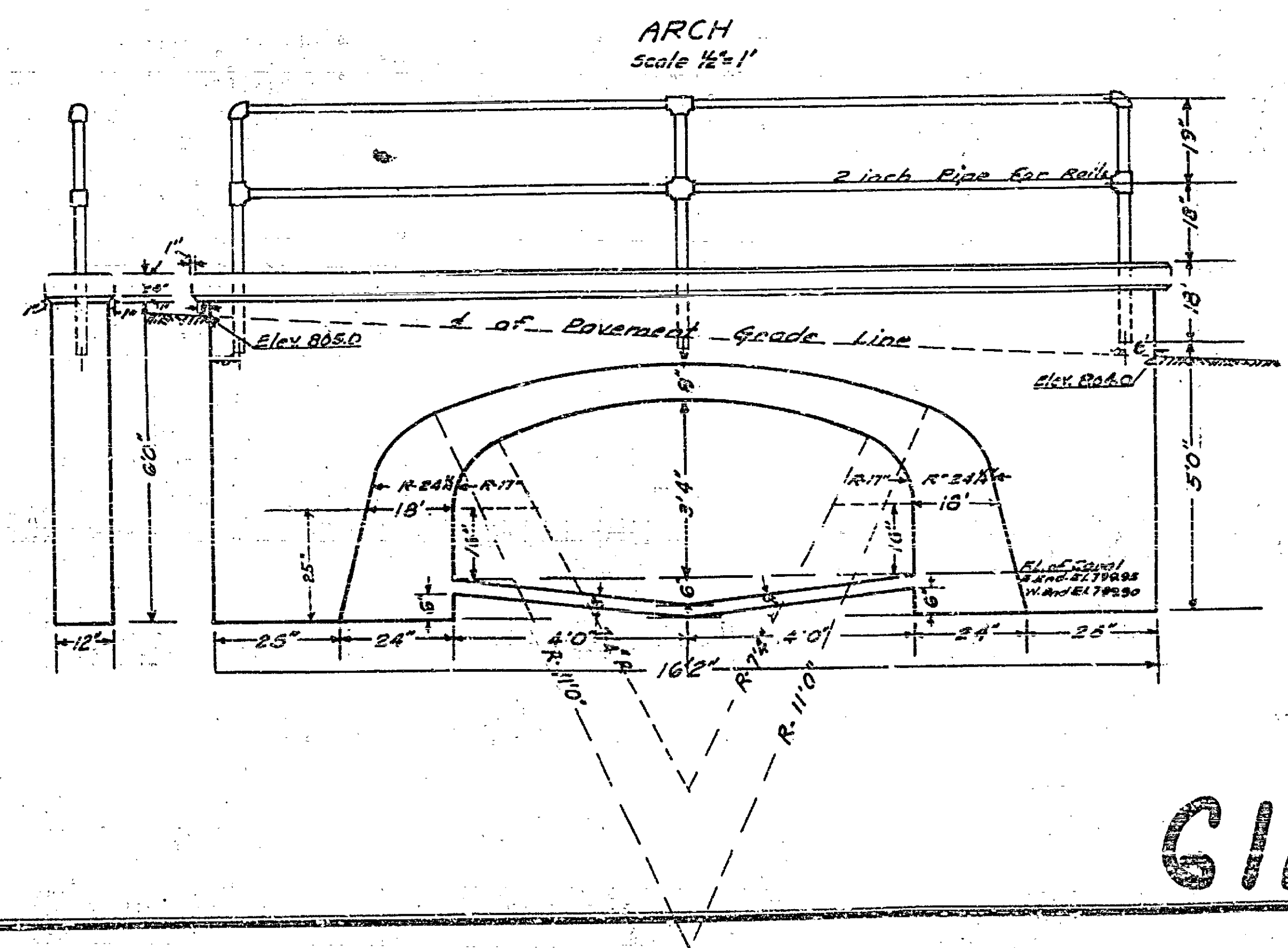
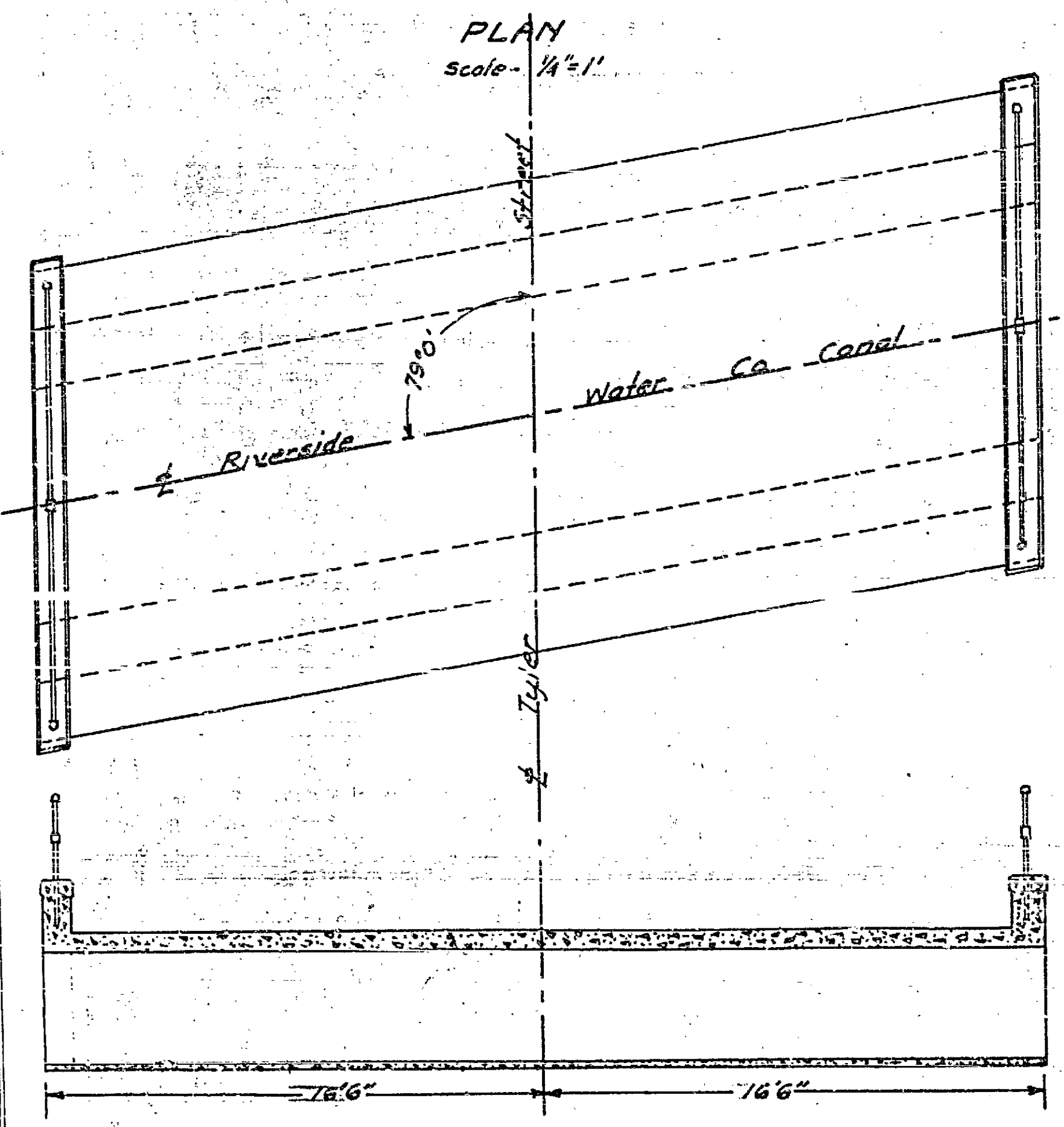

612