

ARROYO DRIVE
 RINCON ST. & BONNIE BRAE
 Drawing No. Sheet No. Total Sheets, Field Book
 219 1 1 101 1000 1308
 Plotted. Checked.
 1936. 1-23-36 1-27-36

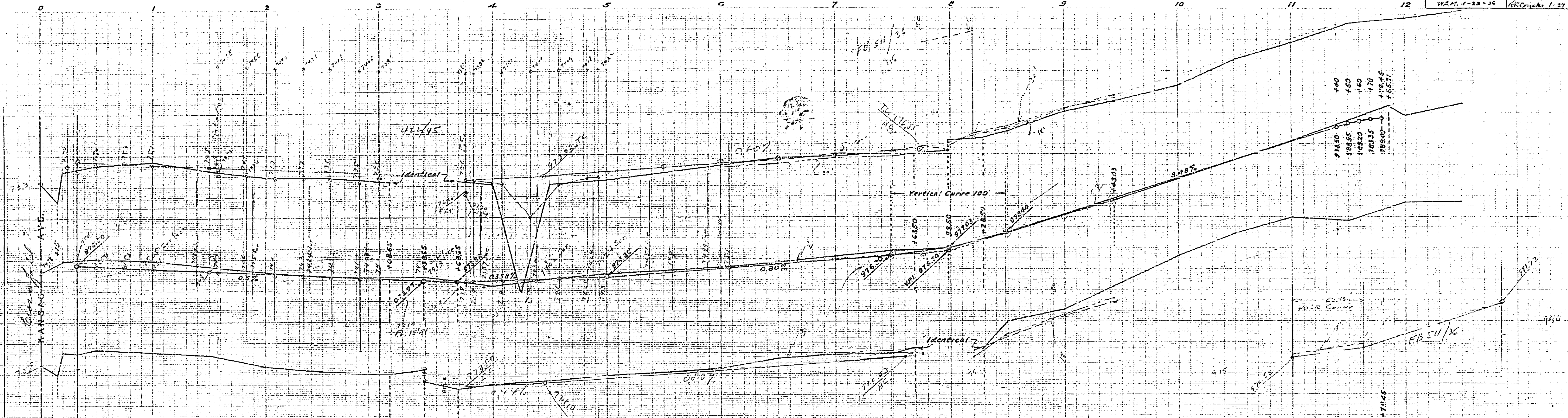

PLANS AND PROFILES
 OF THE PROPOSED IMPROVEMENT OF
ARROYO DRIVE
RINCON STREET
BONNIE BRAE
 EASTERLY FROM KANSAS AVE.

ENGINEER DEPT. RIVERSIDE CALIF. 1936.
 CITY (U.S.G.S.) DATUM PLANE
 FIELD BOOK 300 PAGES 44-76
 " " 302 " 33-47
 " " 212 " 45-47
 " " 212 " 47-50
 Constructed by Street Dept. 1936

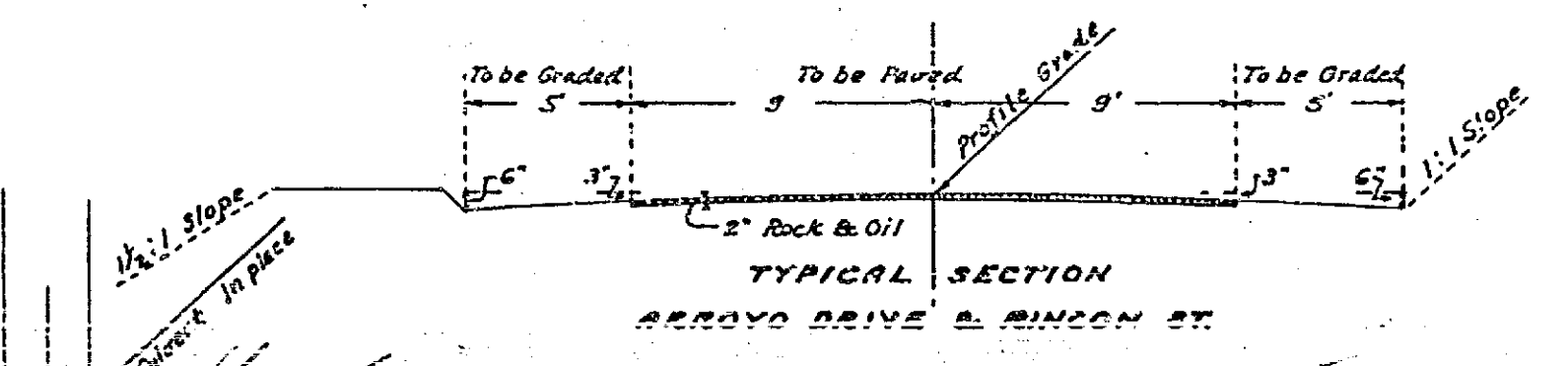
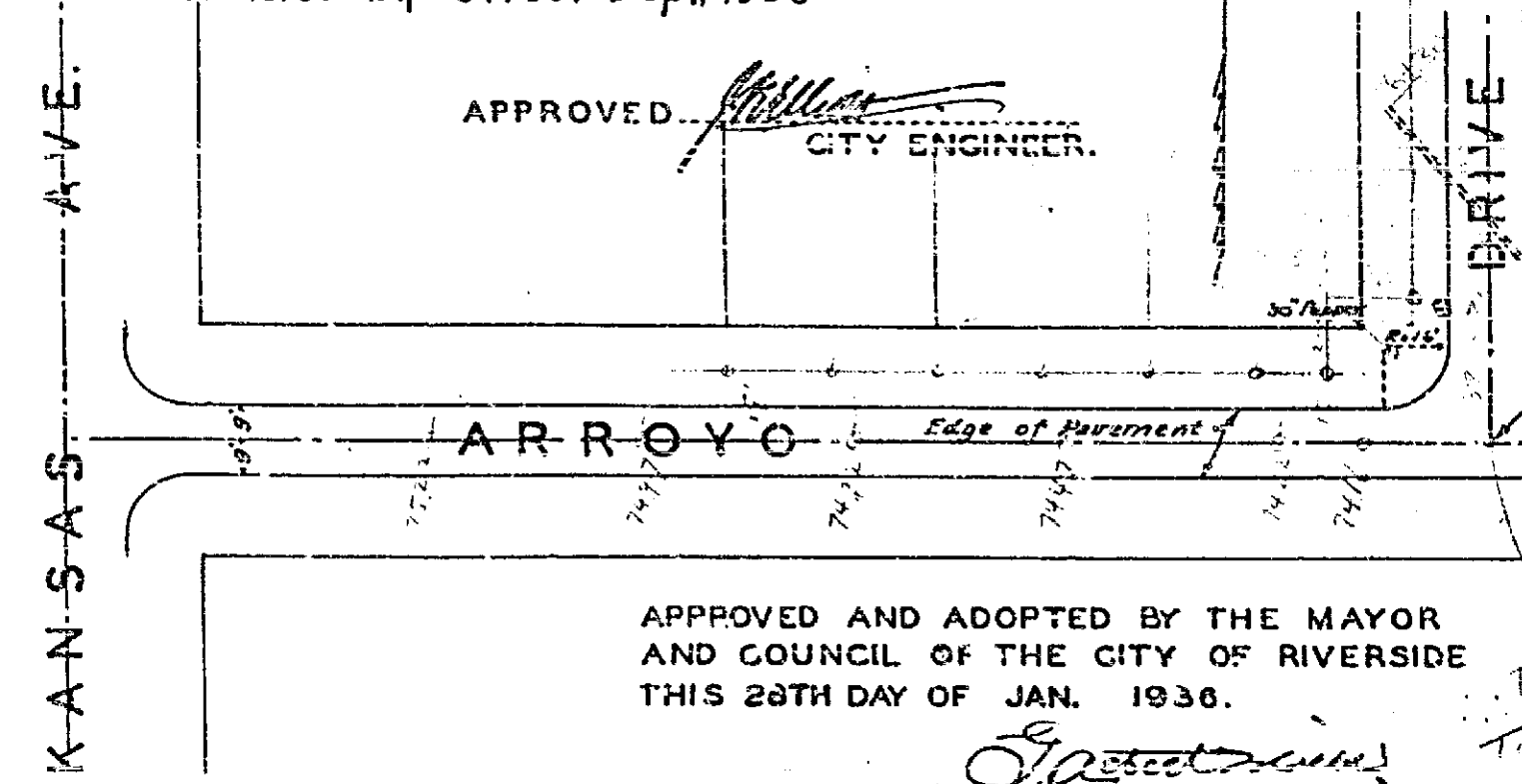

APPROVED: *[Signature]*
 CITY ENGINEER.

APPROVED AND ADOPTED BY THE MAYOR
 AND COUNCIL OF THE CITY OF RIVERSIDE
 THIS 28TH DAY OF JAN. 1936.
[Signature] T.P. McMan
 CITY CLERK CITY OF RIVERSIDE. EL. 373.97

613

ARROYO DRIVE		BONNIE BRAE	
RINCON ST.	Sheet 10	Total Sheets	Field No.
613	3	300	30
DATE		DRAWN BY	
12/15/10		J. J. ...	

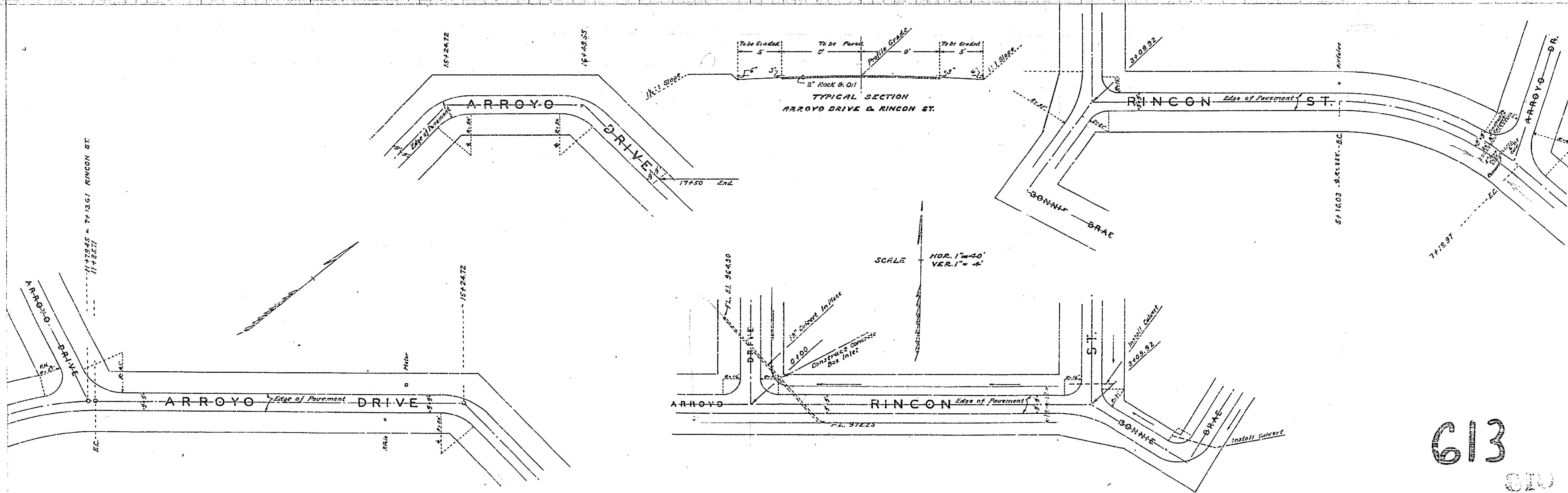
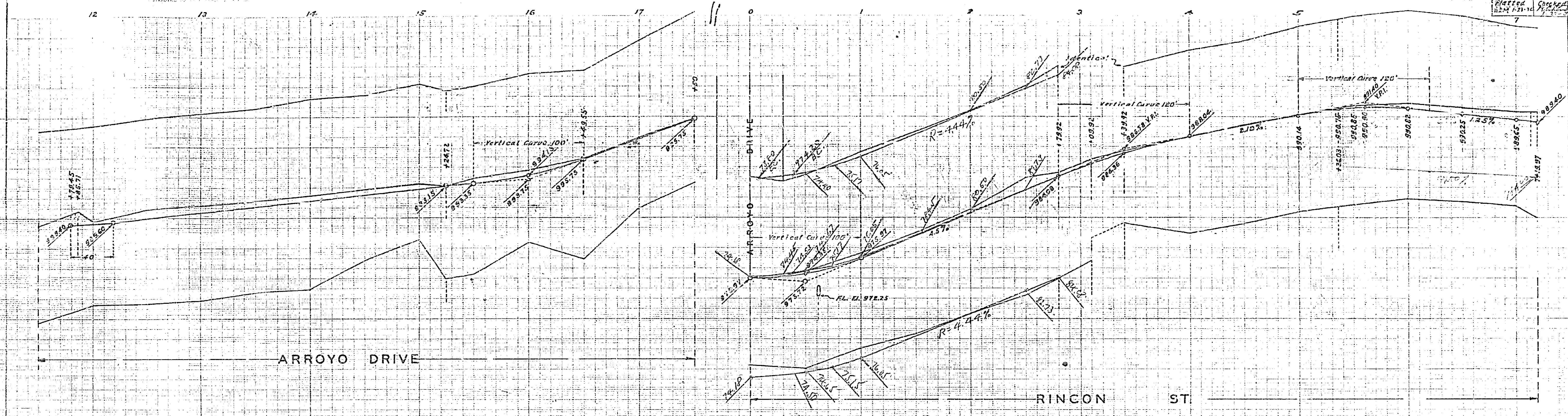

613
810

