

PINE STREET	
EIGHTH ST. TO FOURTH ST.	
Drawing No.	Total Sheets
326	318, 322
Sheet	Checked
W.E.H. 7-20-38	Checked

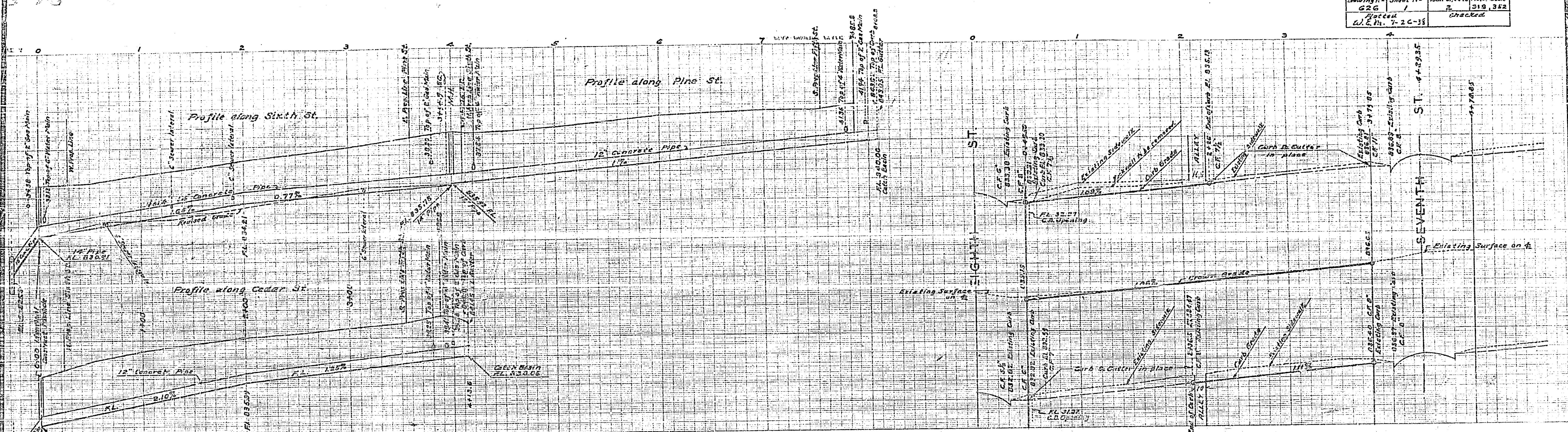

PLANS AND PROFILES

OF THE PROPOSED IMPROVEMENT OF
PINE STREET
 BETWEEN EIGHTH ST. & FOURTH ST.

ENGINEER DEPT. RIVERSIDE CALIF. 1938.
 CITY (U.S.G.S.) DATUM PLANE
 FIELD BOOK 318 PAGES 25 & 37
 352 " 37 - 40

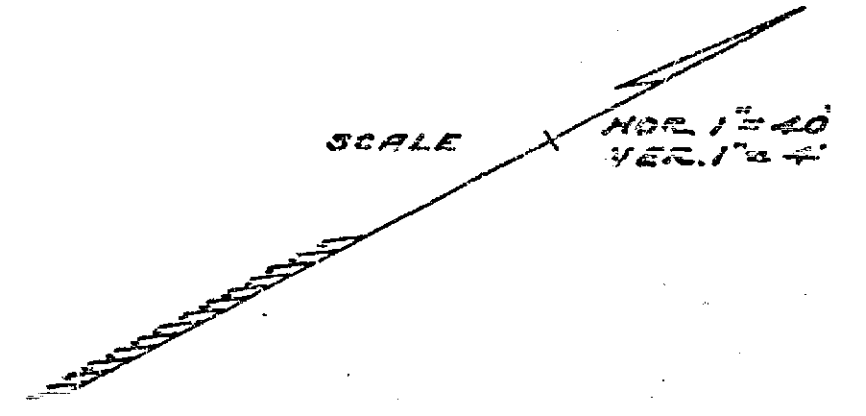

APPROVED *E. H. Hagan*
 CITY ENGINEER.

APPROVED AND ADOPTED BY THE MAYOR
 AND COUNCIL OF THE CITY OF RIVERSIDE
 THIS DAY OF 1938.

CITY CLERK, CITY OF RIVERSIDE.

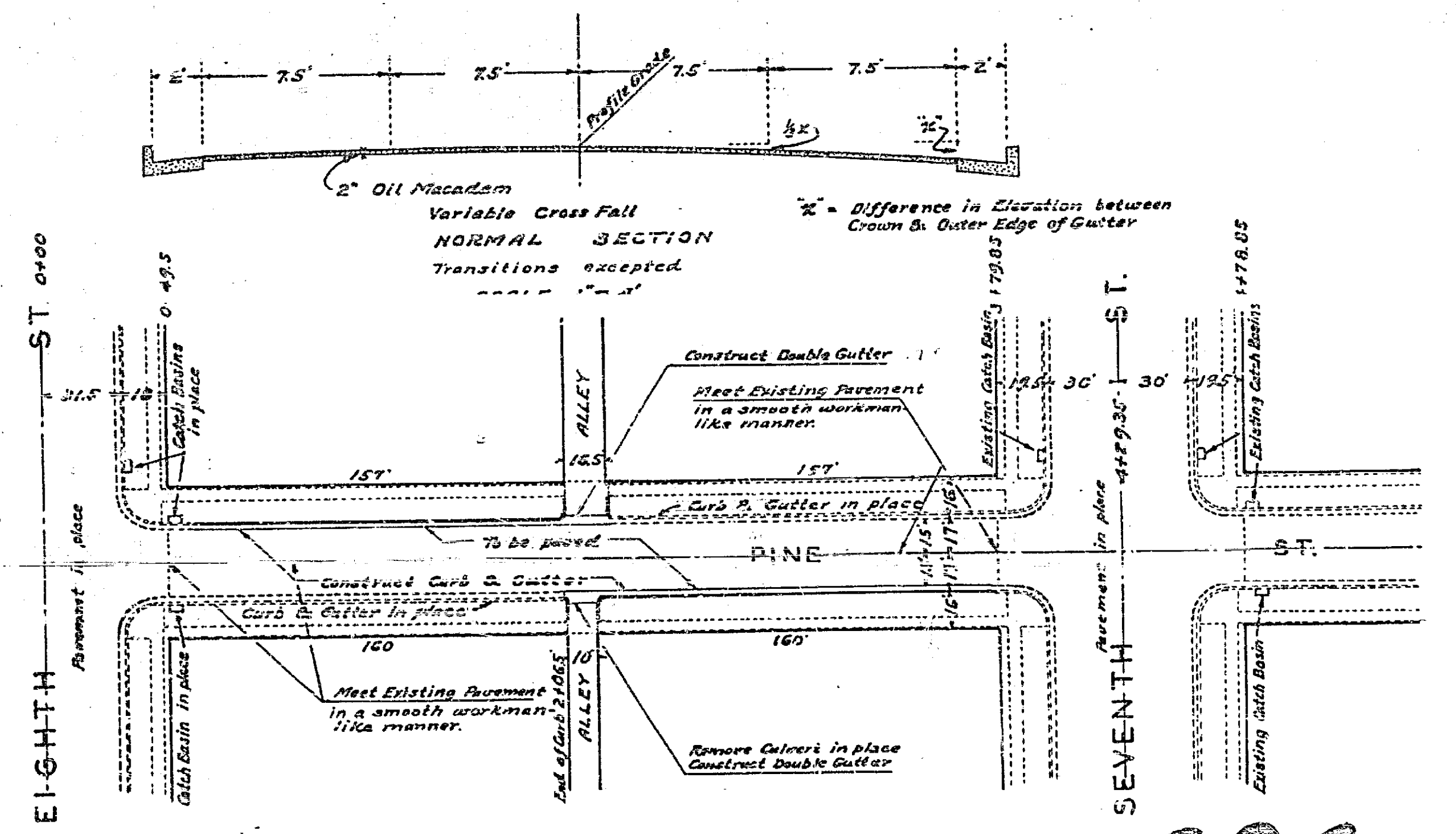
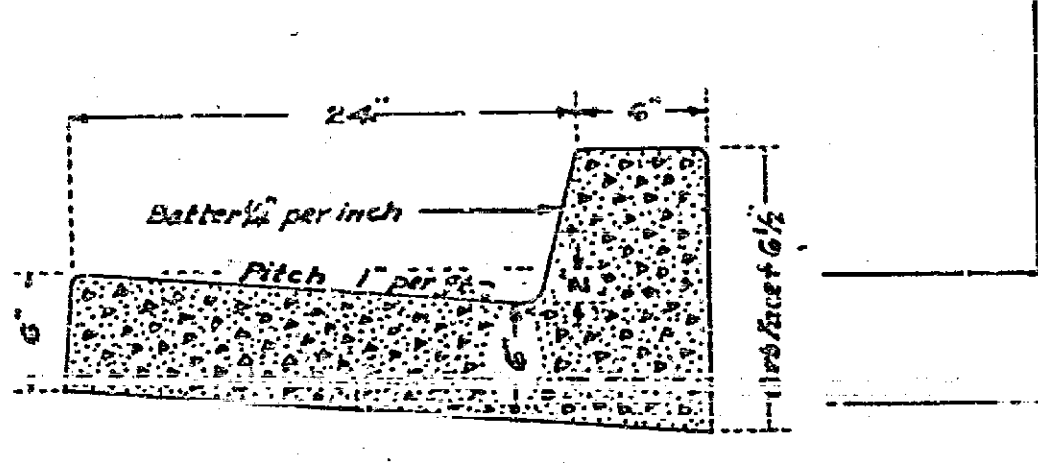
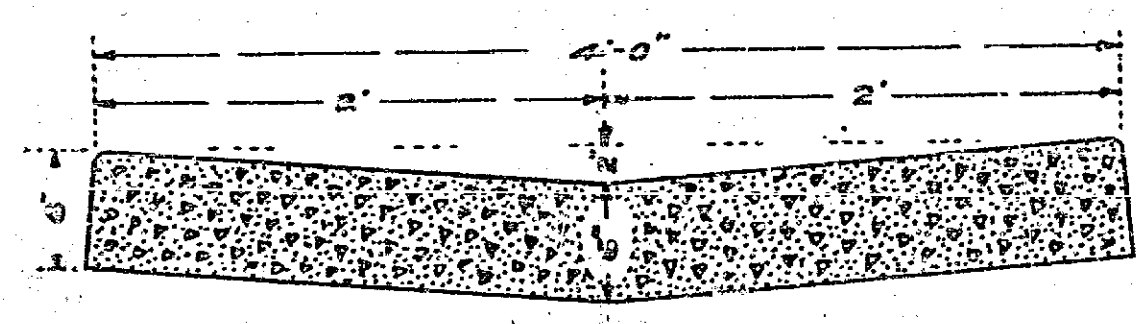

626

PINE STREET			
EIGHTH ST TO FOURTH ST			
Drawing No	Sheet No	Total Sheets	Field Book
626	2	2	318, 322
Checked		Checked	
W. E. M. 7-26-38			

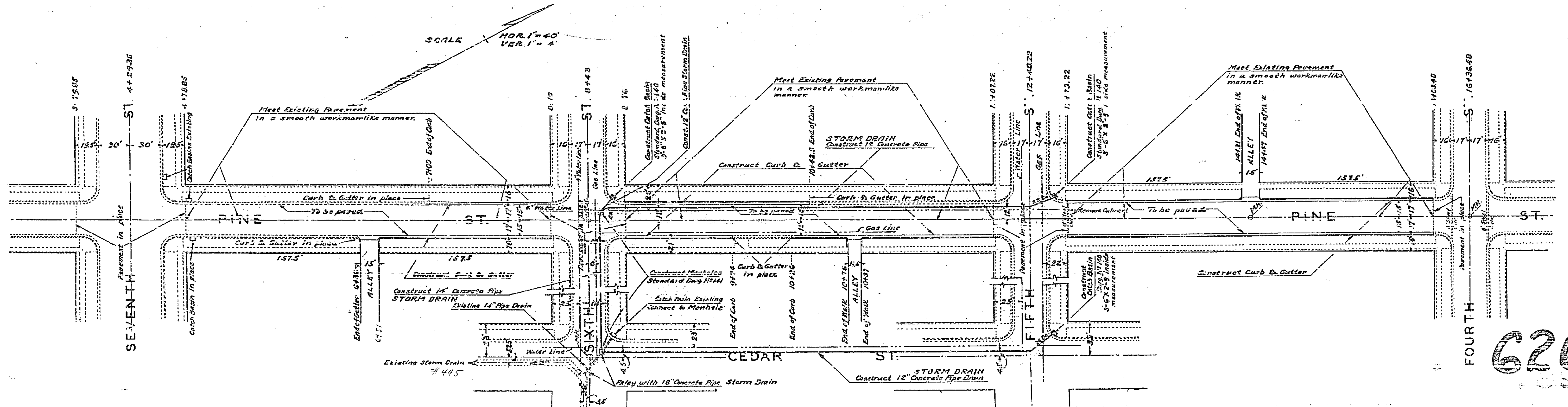
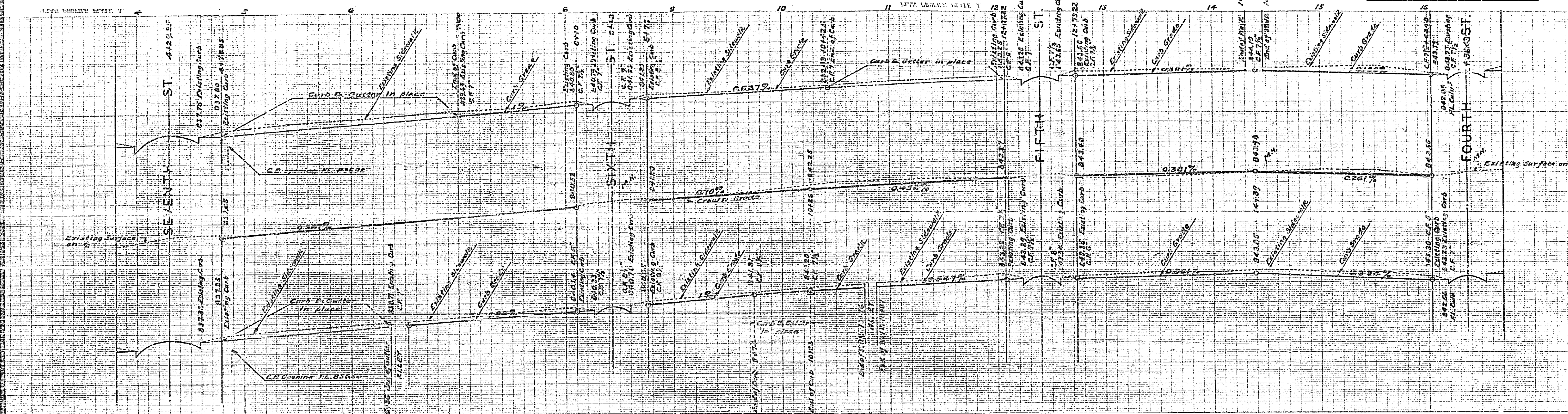

626