

Ext. Red. Central Sewer in Moo. Gordon			
DRAWING NUMBER	SHEET NUMBER	SCALE	FIELD
	1	1" = 10'	398-35
DRAWN BY	CHECKED BY	APPROVED BY	
D.J.M.		MAY 8-42	



Scale - 1" = 10'
~~Excavate 1100 cu yd~~
~~Remove 12" pipe 1500 ft~~
~~Remove 6" pipe 1500 ft~~
~~12" Manhole 5~~
~~6" Manhole 15~~
~~6" Vitr. Sewer Pipe 300 Lin. ft.~~

This includes 60' lateral South to 2103 Constructed by Street Dept. June, 1942

Revised Est. of Materials
 For W.K. Rankin - 6-7-42

429' 1" vit pipe @ 3.51	13.170
3 Manholes @ 11.50	49.500
3000 Brick @ 14.25	42.750
Steps	9.000
Cement & Con. Lin.	29.000
Tequil & D. Pipe	16.000
	<hr/> 271.30

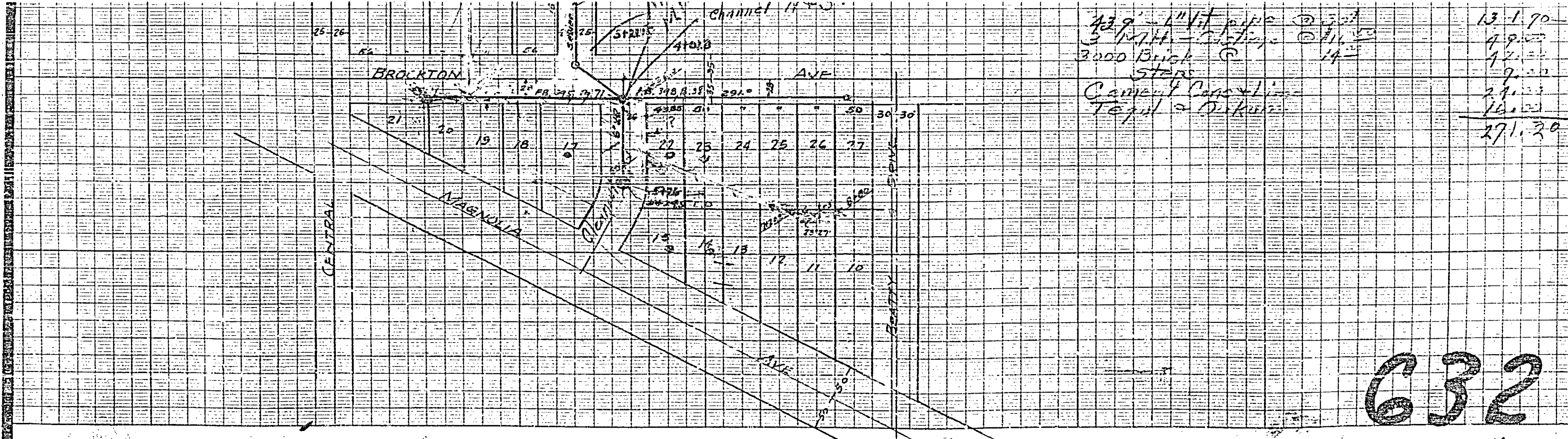

632

8172
5153