

Hoover St Bridge across R. W. Co. Canal			
Drawing Number	Sheet Number	Total Sheets	Field Book
634A	1	1	324
Drawn By	Checked By	Approved By	
Arthur N. Riddle	M. J. Kautsky	October 6, 1936	
		10-7-36	

**PLAN
OF PROPOSED
BRIDGE
ACROSS
RIVERSIDE WATER CO. CANAL
AT
HOOVER STREET**

*Not constructed
in 1937*

CITY (U.S.G.S) DATUM

ENGINEERING DEPT.

OCTOBER 1936

APPROVED *[Signature]*
CITY ENGINEER

APPROVED AND ADOPTED BY THE MAYOR AND COUNCIL
OF THE CITY OF RIVERSIDE THIS 4 DAY OF OCT. 1936
[Signature]
CITY CLERK CITY OF RIVERSIDE

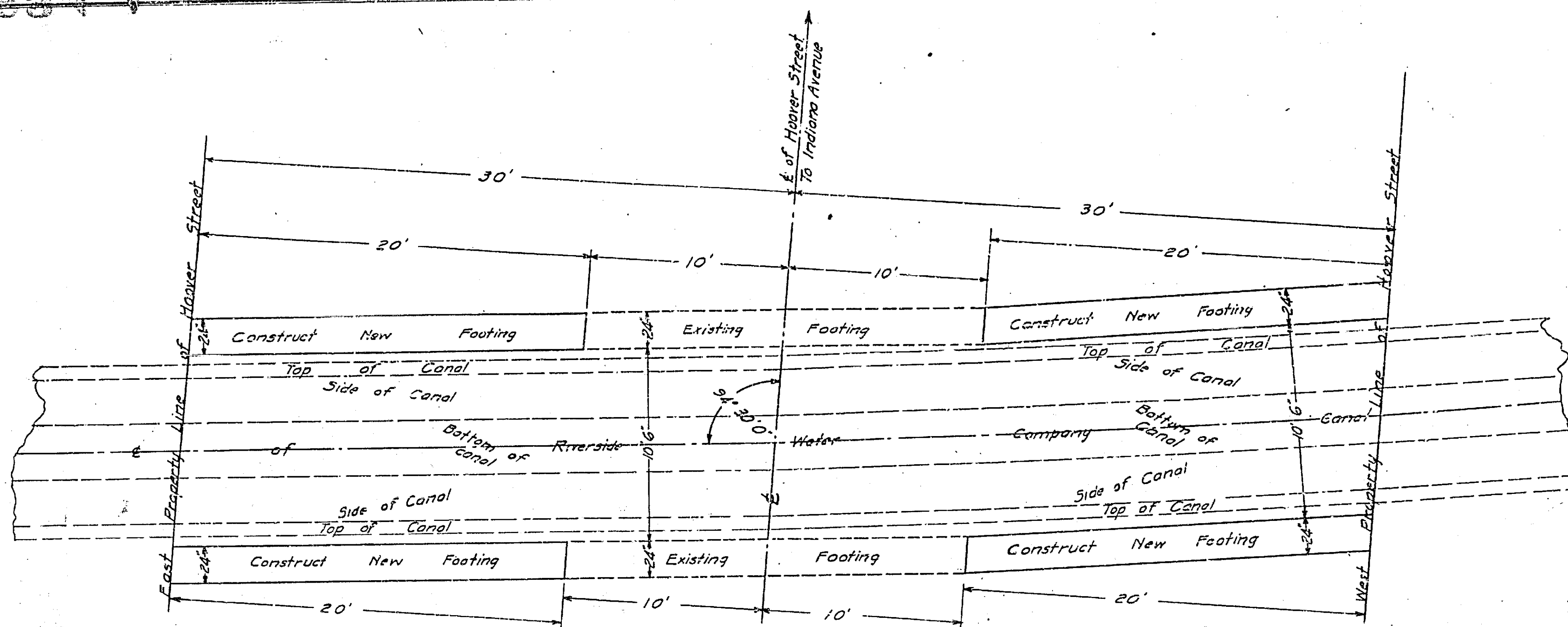

Plan of Footings
Scale - 1/4 in = 1 ft

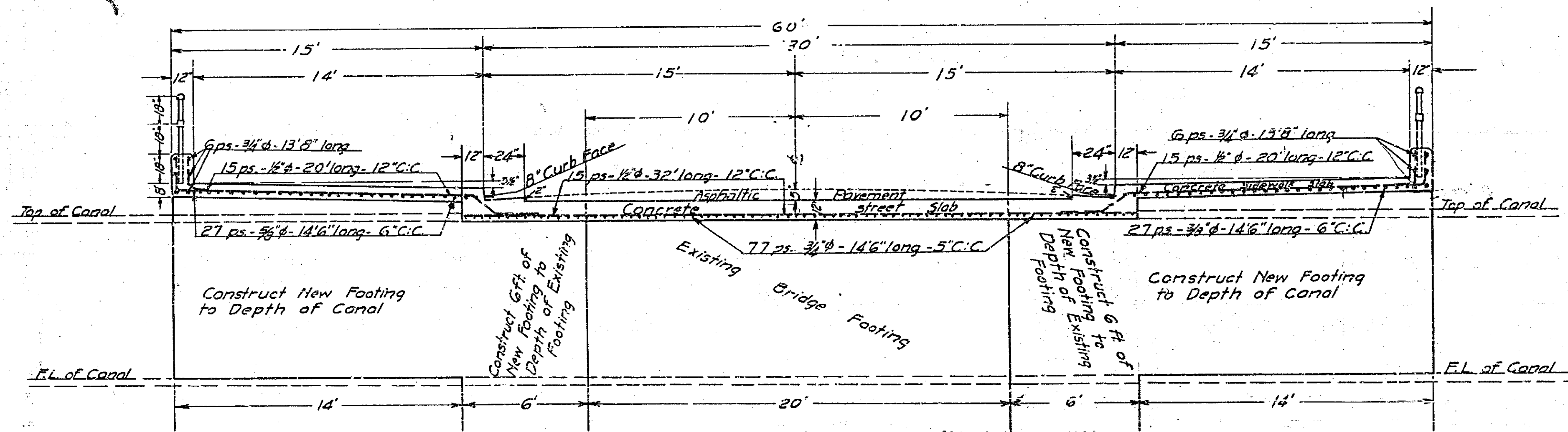

Longitudinal Section
Scale - 1/4 in = 1 ft

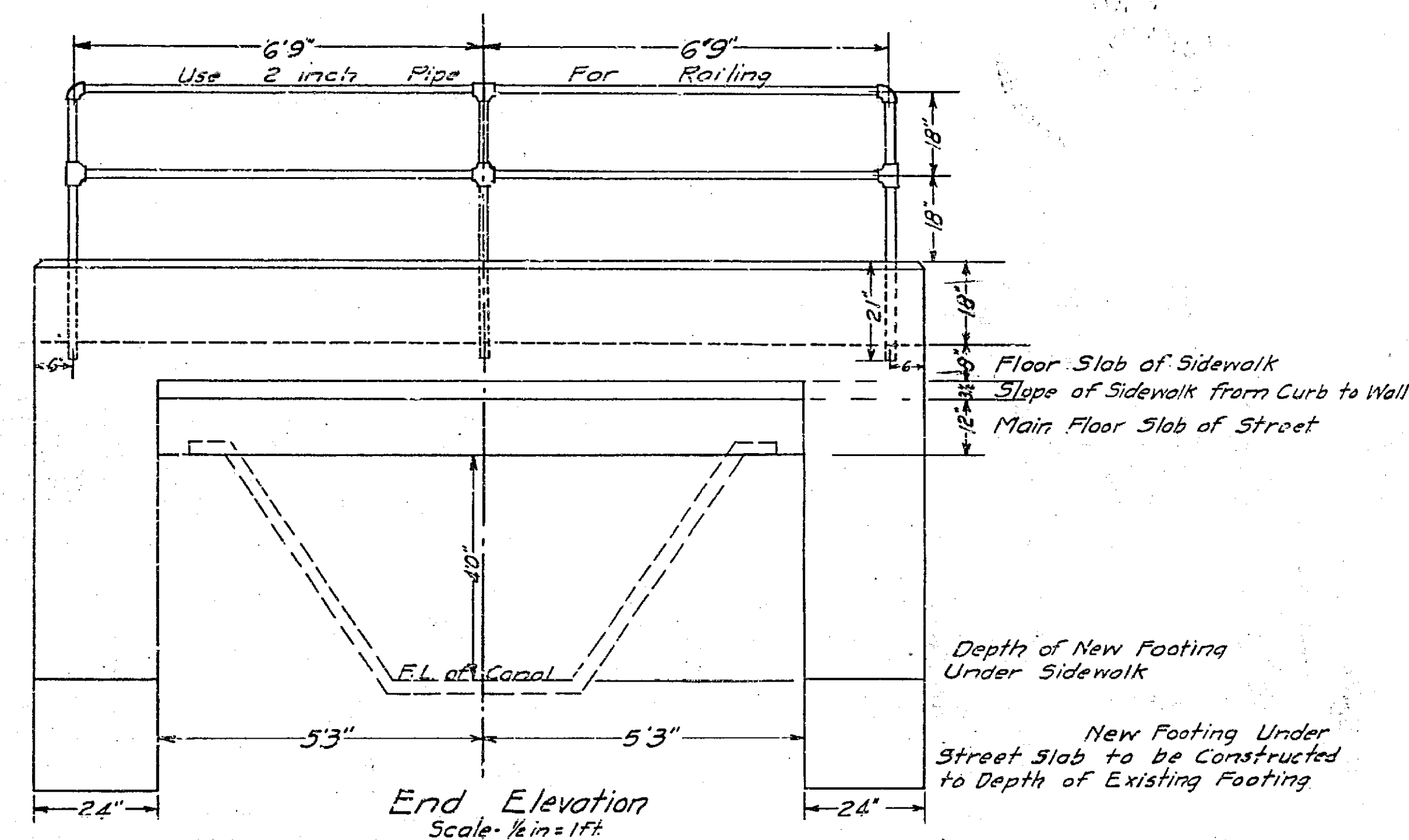

End Elevation
Scale - 1/2 in = 1 ft

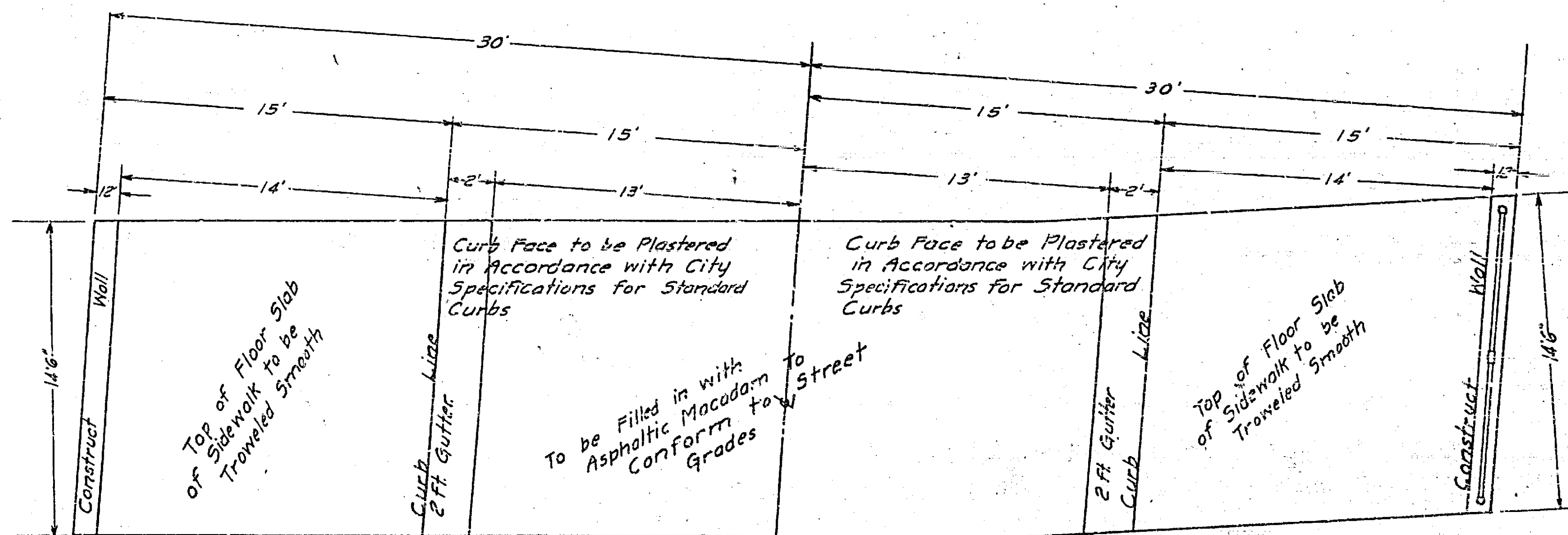

Plan
Scale - 1/4 in = 1 ft

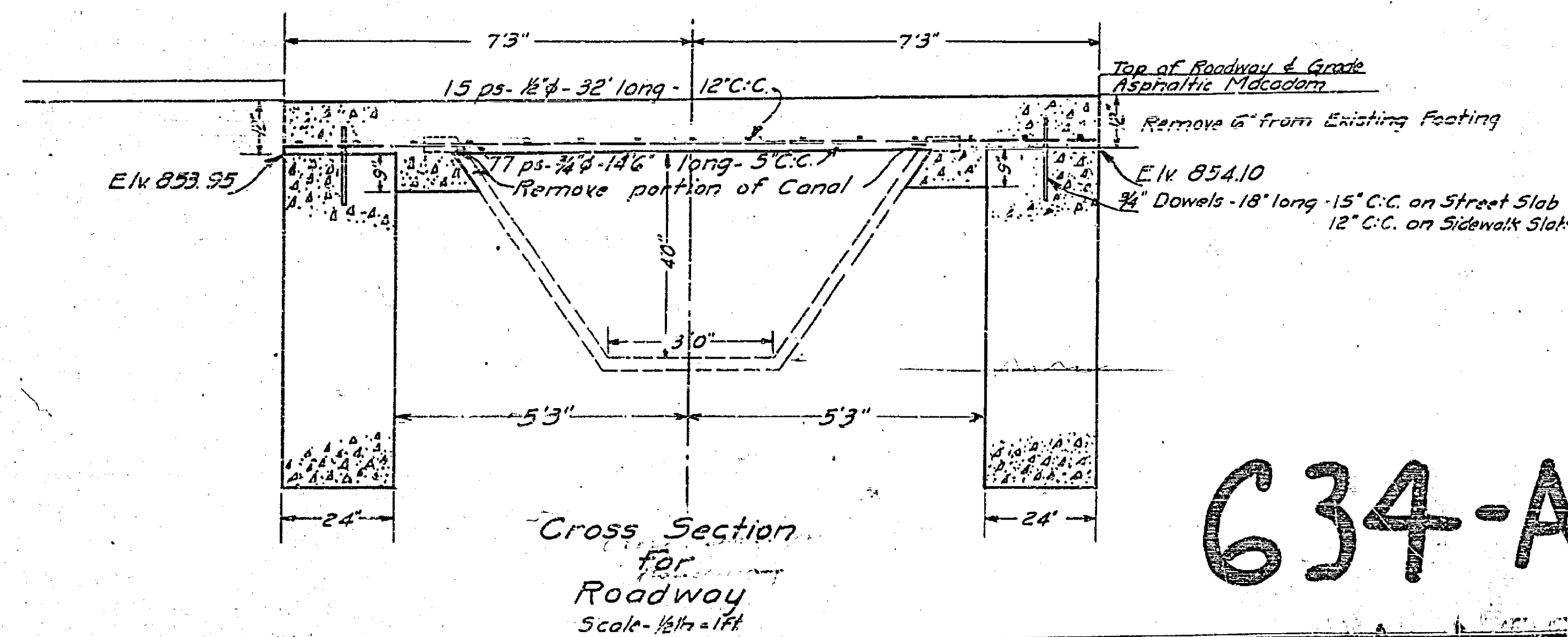

Cross Section
for
Roadway
Scale - 1/2 in = 1 ft

634-A