

453/81

PROPERTY OF
CITY OF RIVERSIDE
CITY ENGINEERING DEPT.

PROPERTY OF
CITY OF RIVERSIDE
CITY ENGINEERING DEPT.

PROPERTY OF
CITY OF RIVERSIDE
CITY ENGINEERING DEPT.

Approved: *M. H. Irvine*
CITY ENGINEER
Revised: April 24, 1952.

Marguerita Ave.
June St. to Maude St.

630

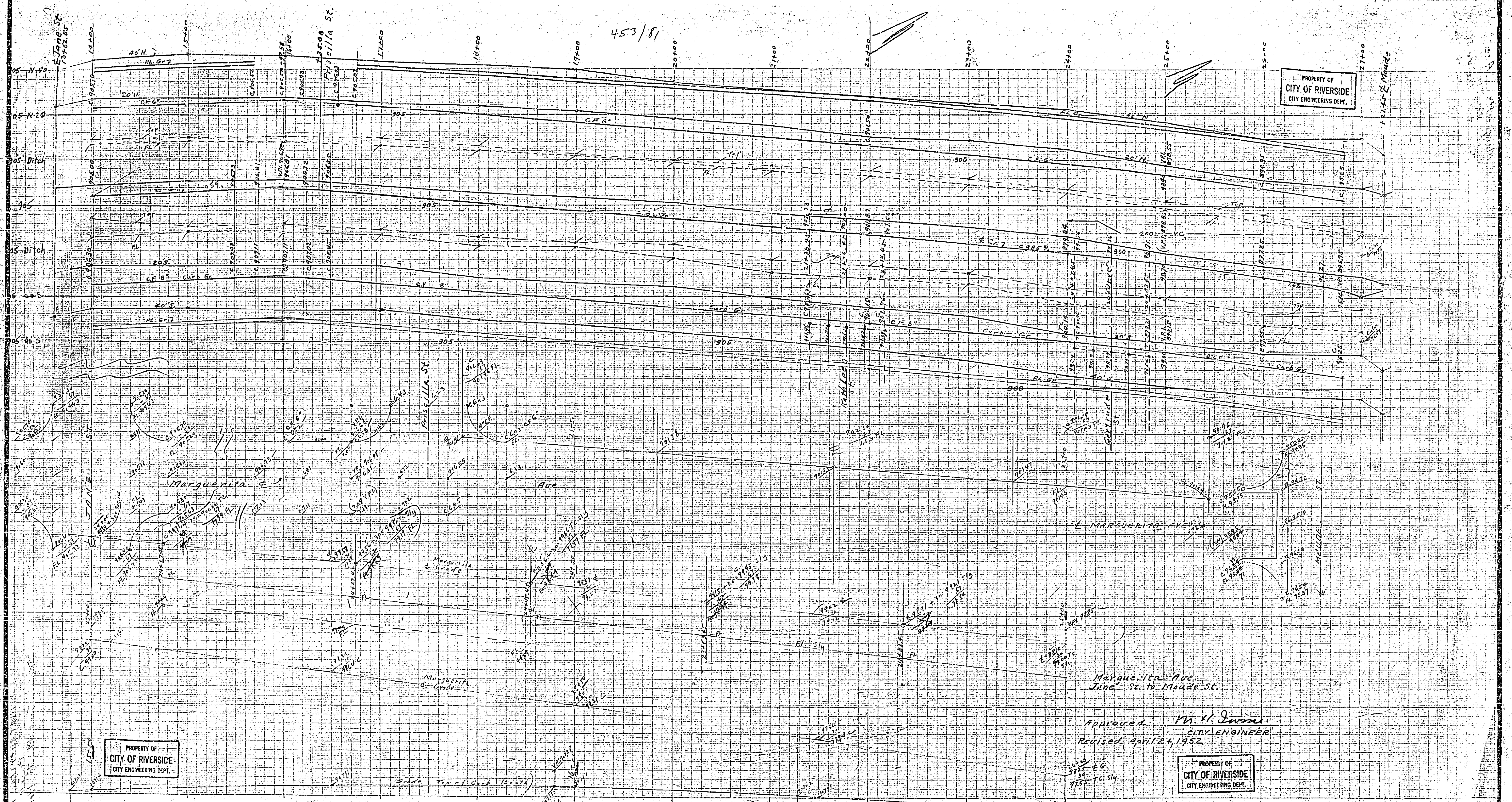

2448143
 3162
 2445267