

TENTH STREET	
PINE ST. TO PEPPER ST.	
Drawing No. 648	Sheet No. 1
Plotted	Checked
W.E.M. 7-25-36	R.C. 7-28-36

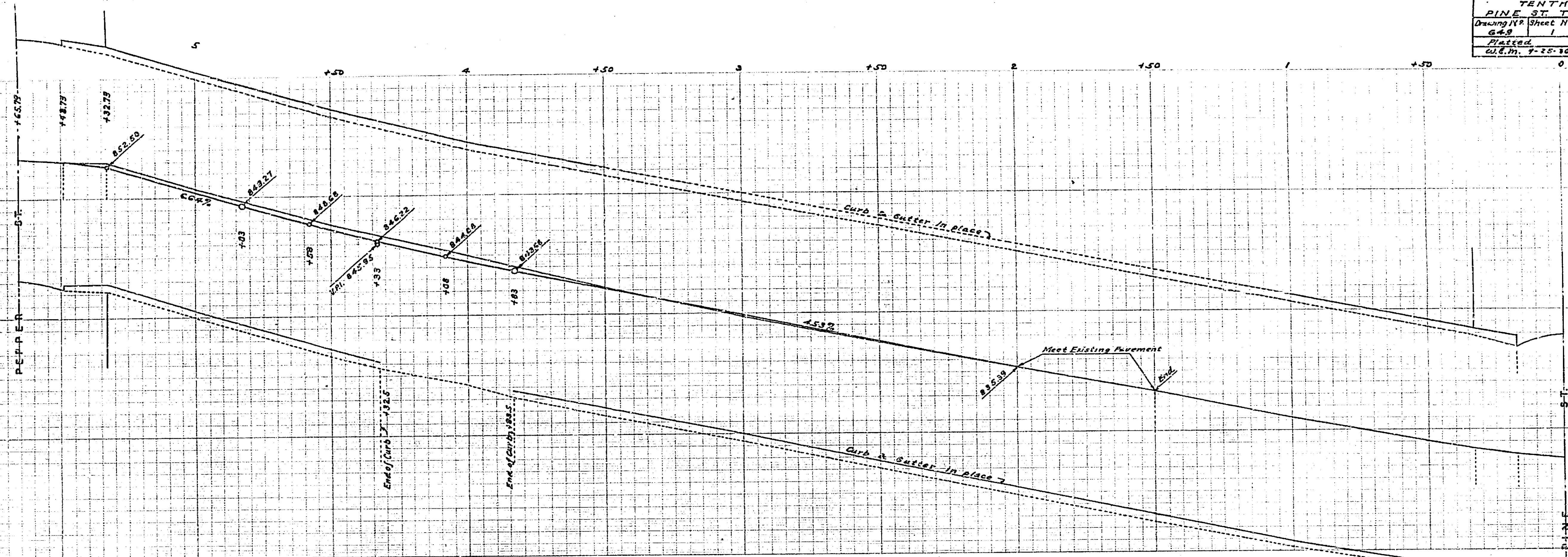

PLAN AND PROFILE OF THE PROPOSED IMPROVEMENT ON TENTH STREET BETWEEN PINE ST. & PEPPER ST.

ENGINEER DEPT. RIVERSIDE CALIF. 1936.
CITY (U.S.G.S.) DATUM PLANE
FIELD BOOK 342 PAGES 62-67

APPROVED AND ADOPTED BY THE MAYOR
AND COUNCIL OF THE CITY OF RIVERSIDE
THIS 29th DAY OF Sept. 1936.

[Signature]
CITY CLERK, CITY OF RIVERSIDE

SCALE HOR. 1" = 20'
VER. 1" = 4' Constructed by Street Dept 1936. WPA Labor. ?

APPROVED *[Signature]*
CITY ENGINEER.

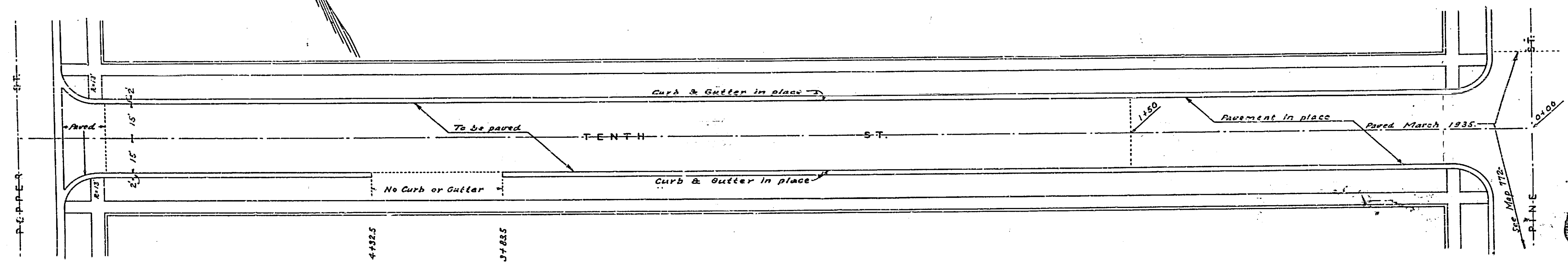
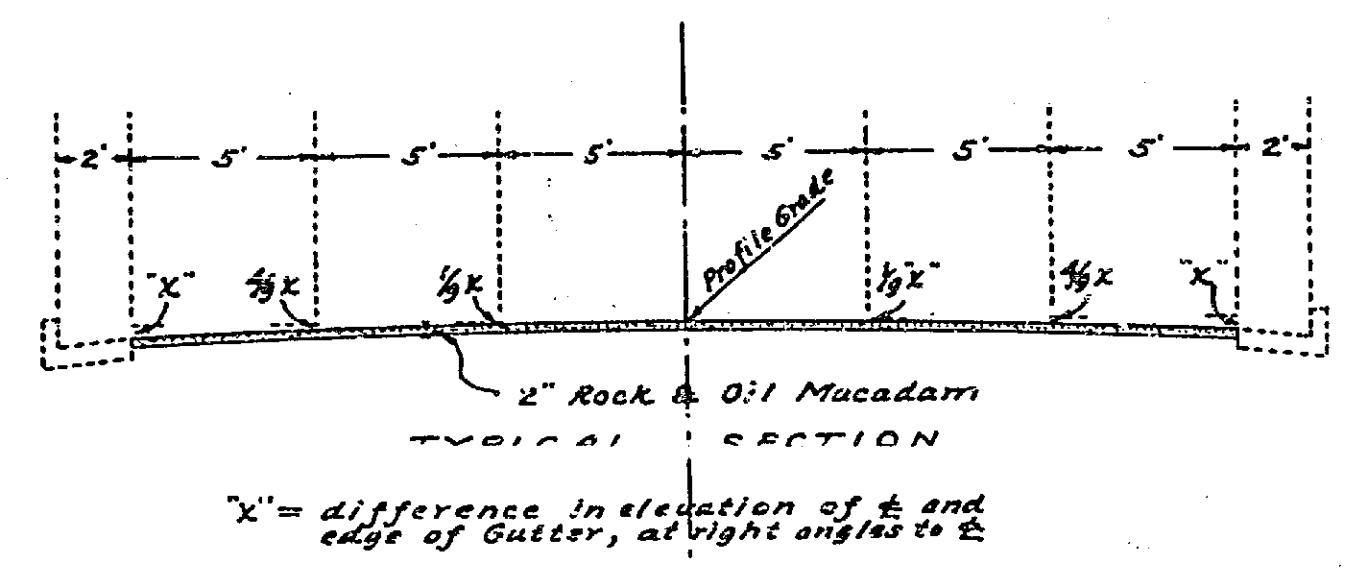

649