

PLAN NO 651-C
 PROPOSED DRAINAGE LAYOUT
 RIVERSIDE COLLEGE EXPANSION
 SCALE 1" = 50'
 CITY OF RIVERSIDE - CALIFORNIA
 P.B. 517/47&70 - 53/28

APPROVED *M. J. Irvine*
 M. J. IRVINE, ASSESSOR
 CITY ENGINEER

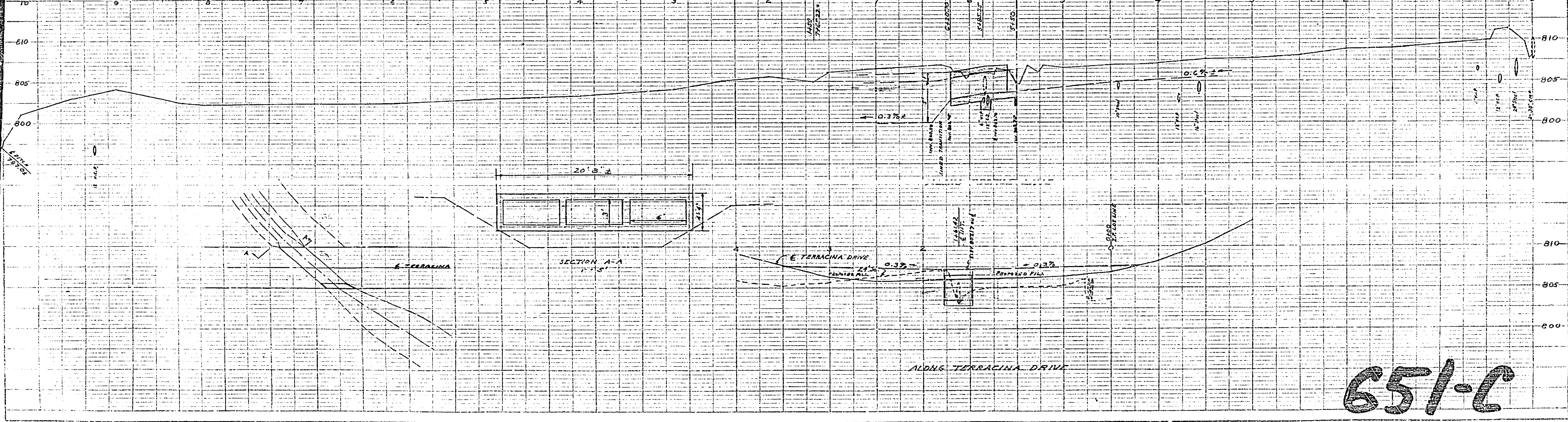
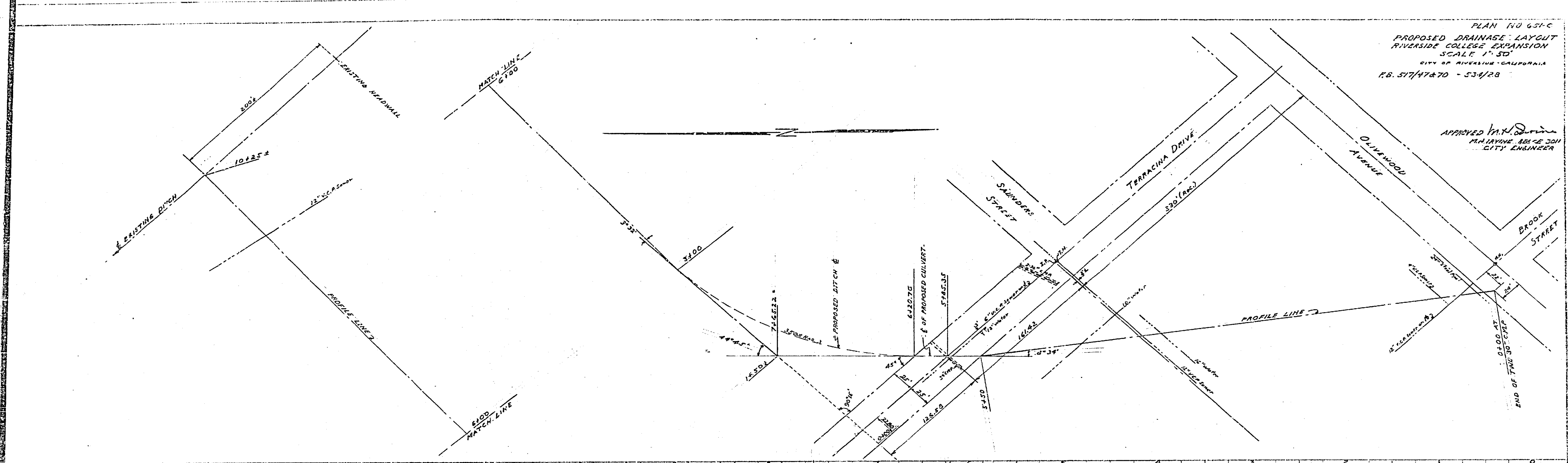

651-C

DATE	DESCRIPTION

DATE	DESCRIPTION