

*Huntington Park Clear  
by Timberline  
S. J. Morrison Dec.*

*Ch. has to be  
over 100'*

*Over 100'*

*ROSEWOOD ROAD*

*Stanton*

*Note - not  
exceed 500' in area*

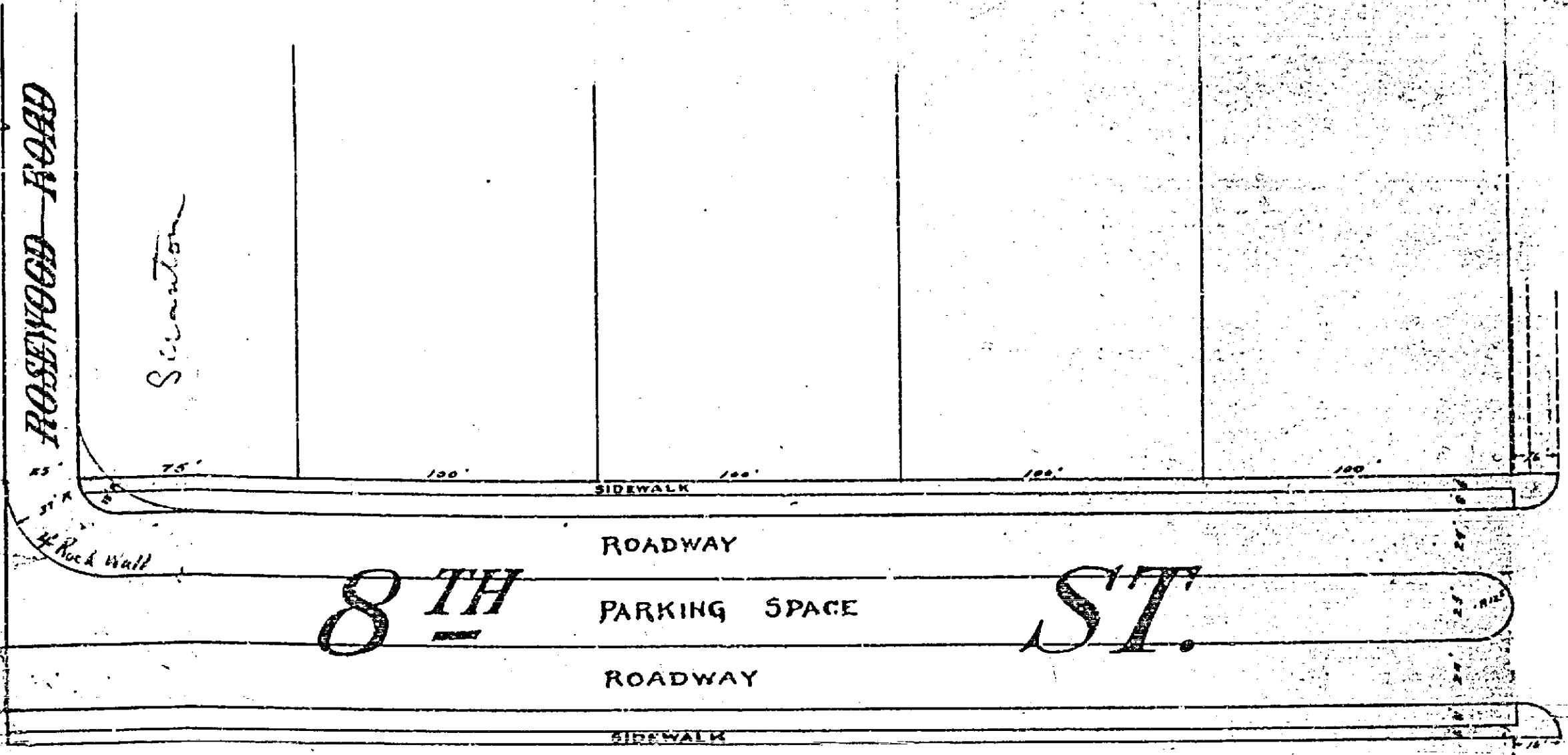
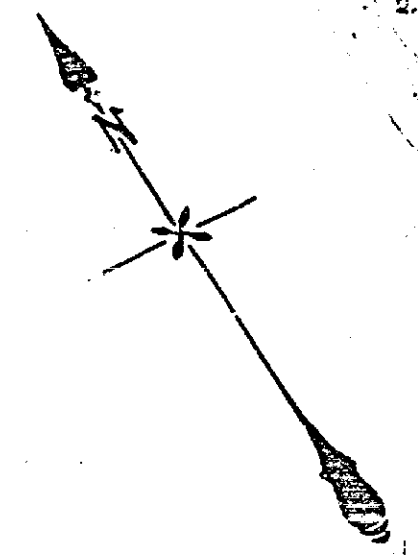

*ST.*

**8<sup>TH</sup>**

**ST.**

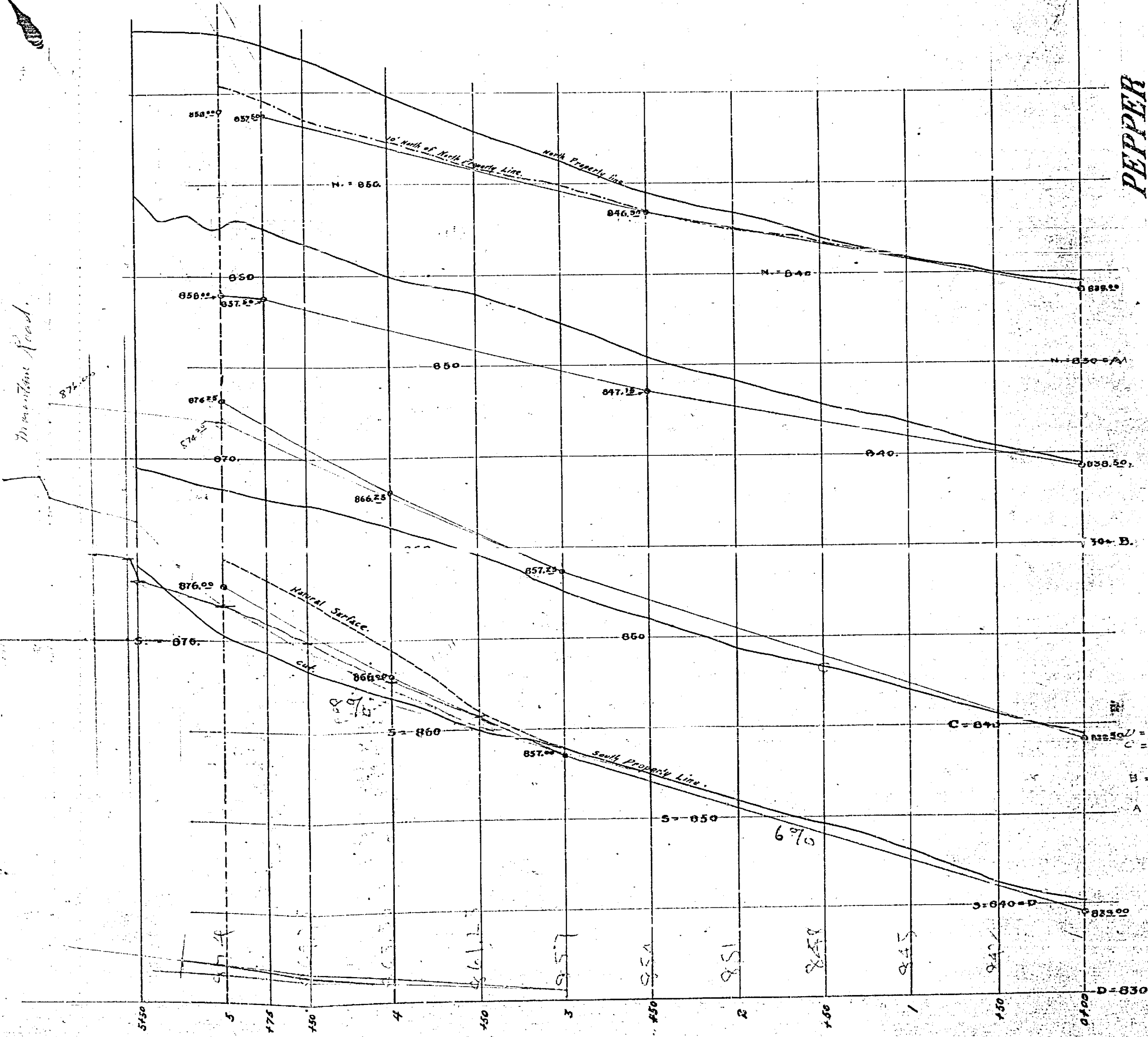

**PEPPER**

Scale -  
1" HOR. = 60'  
1" VER. = 10'

*I see no objections to a two foot gutter  
on south side of high roadway instead of  
customary three foot, as grade is enough  
to carry water. S. J. Morrison, Mayor  
Dec. 19, 1906*

*Proposed Road*

*87.25*

*87.00*

*86.25*

*85.50*

*85.00*

*84.25*

*83.50*

*83.00*

*82.25*

*81.50*

*81.00*

*80.25*

*80.00*

*79.25*

*78.50*

*78.00*

*77.25*

*76.50*

*76.00*

*75.25*

*74.50*

BASE ELEVATION  
 A = SOUTH LINE OF PARKING SPACE = 830  
 B = SOUTH LINE OF PARKING SPACE = 810  
 C = NORTH LINE OF PARKING SPACE = 780  
 D = NORTH LINE OF PARKING SPACE = 760  
 THE LINE SHOWN THIS  
 10 FT. NORTH OF THE  
 PROPERTY LINE OF 80

**657-A**

D=830-South Side