

# PLAN AND PROFILE OF THE PROPOSED IMPROVEMENT ON DWIGHT AVENUE BETWEEN SEVENTH ST. & EIGHTH ST.

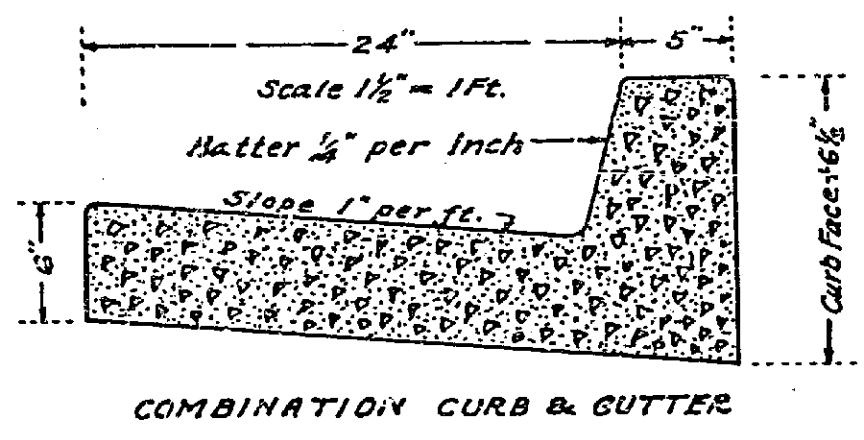
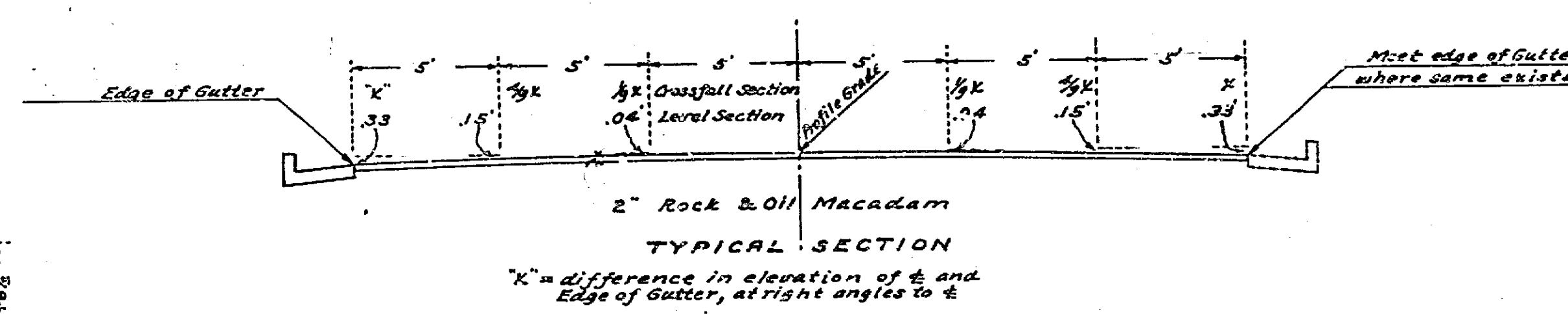

ENGINEER DEPT. RIVERSIDE CALIF. 1936.  
 CITY (U.S.G.S.) DATUM PLANE  
 FIELD BOOK 323 PAGES 22-36

Constructed by Street Dept. Dec 1935  
 W.P.A. Labor.  
 APPROVED: [Signature] CITY ENGINEER.

APPROVED AND ADOPTED BY THE MAYOR  
 AND COUNCIL OF THE CITY OF RIVERSIDE  
 THIS 27th DAY OF October 1936.  
 [Signature]  
 CITY CLERK, CITY OF RIVERSIDE.

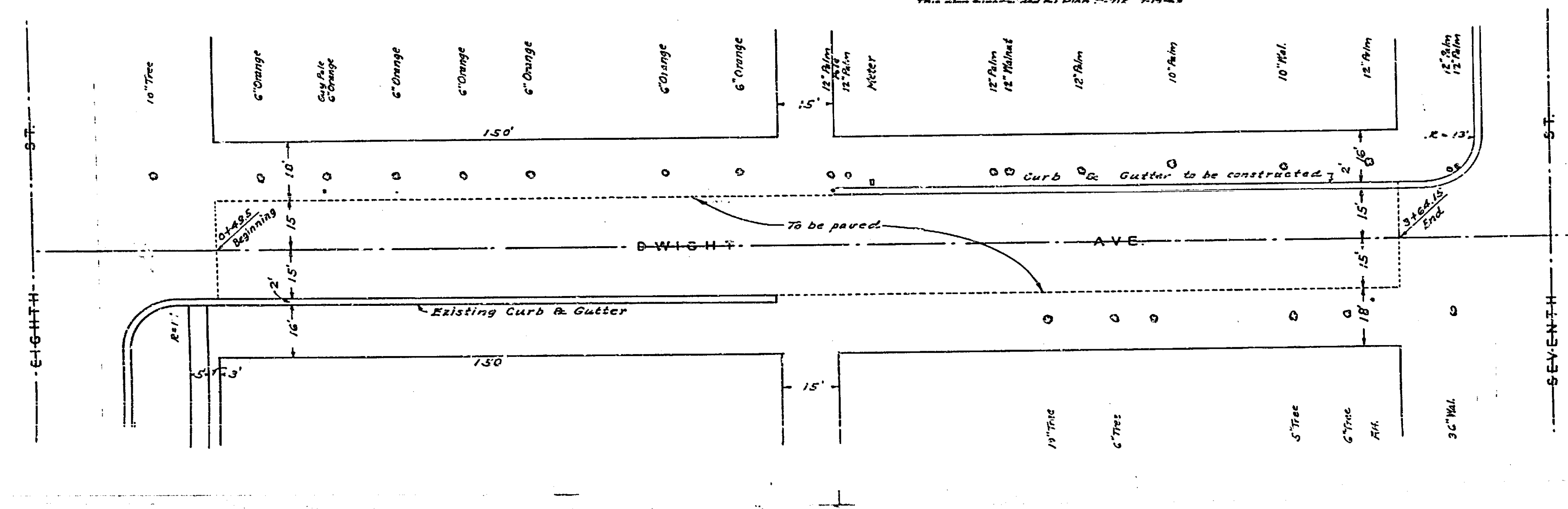

680  
 083