

SCALE: 1"=40'

PLAN & PROFILE
 NO. 684-C
 FOR THE CONSTRUCTION OF CURBS
 AND GUTTERS ON
VIRGINIA PLACE
 BETWEEN RUBIDOUX AVE. & NORTH LINE, ELMQUIST TRACT
 RIVERSIDE, CALIFORNIA

APPROVED *M. H. Swine*
 CITY ENGINEER
 A CIVIL ENGINEER REGISTERED UNDER
 THE LAWS OF THE STATE OF CALIFORNIA
 REG. C.E. NO. 3011

THESE PLANS APPROVED AND ACCEPTED BY THE
 COUNCIL OF THE CITY OF RIVERSIDE STATE OF
 ON THIS _____ DAY OF _____
 CITY CLERK

F. B. 409, PG. 19

SCALE: 1"=40' HORIZ
 1"=4' VERT

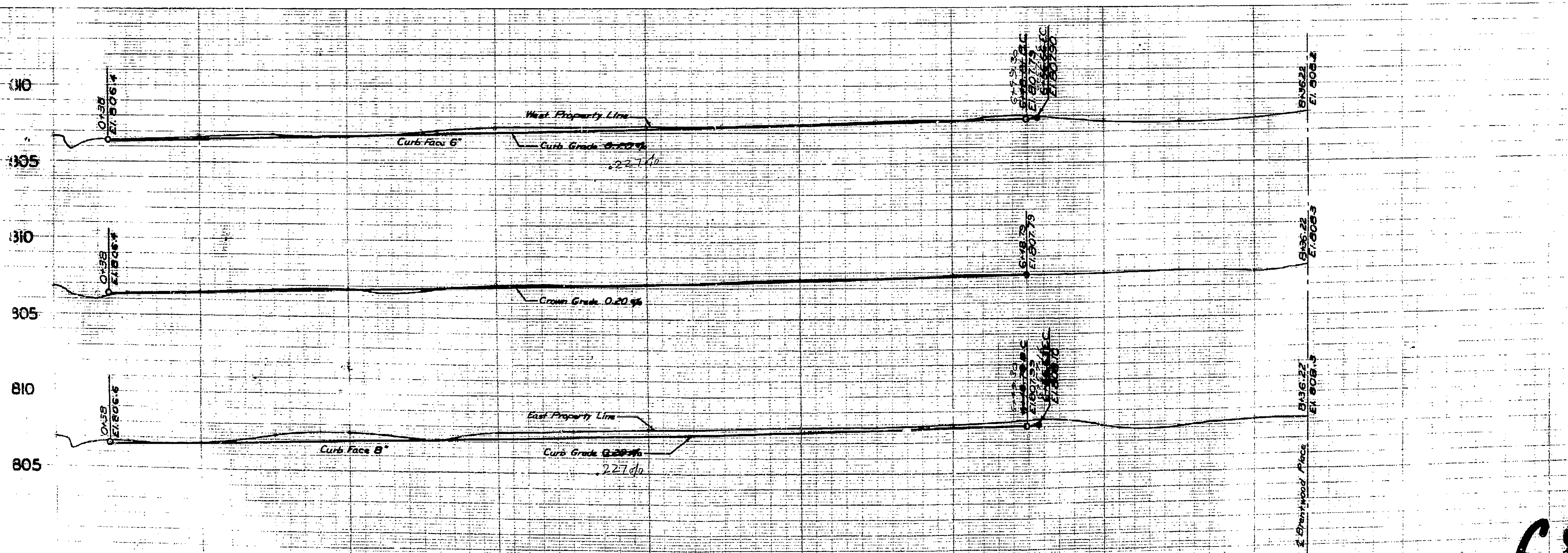

084