

PROPERTY OF
CITY OF RIVERSIDE
CITY ENGINEERING DEPT.

PROPERTY OF
CITY OF RIVERSIDE
CITY ENGINEERING DEPT.

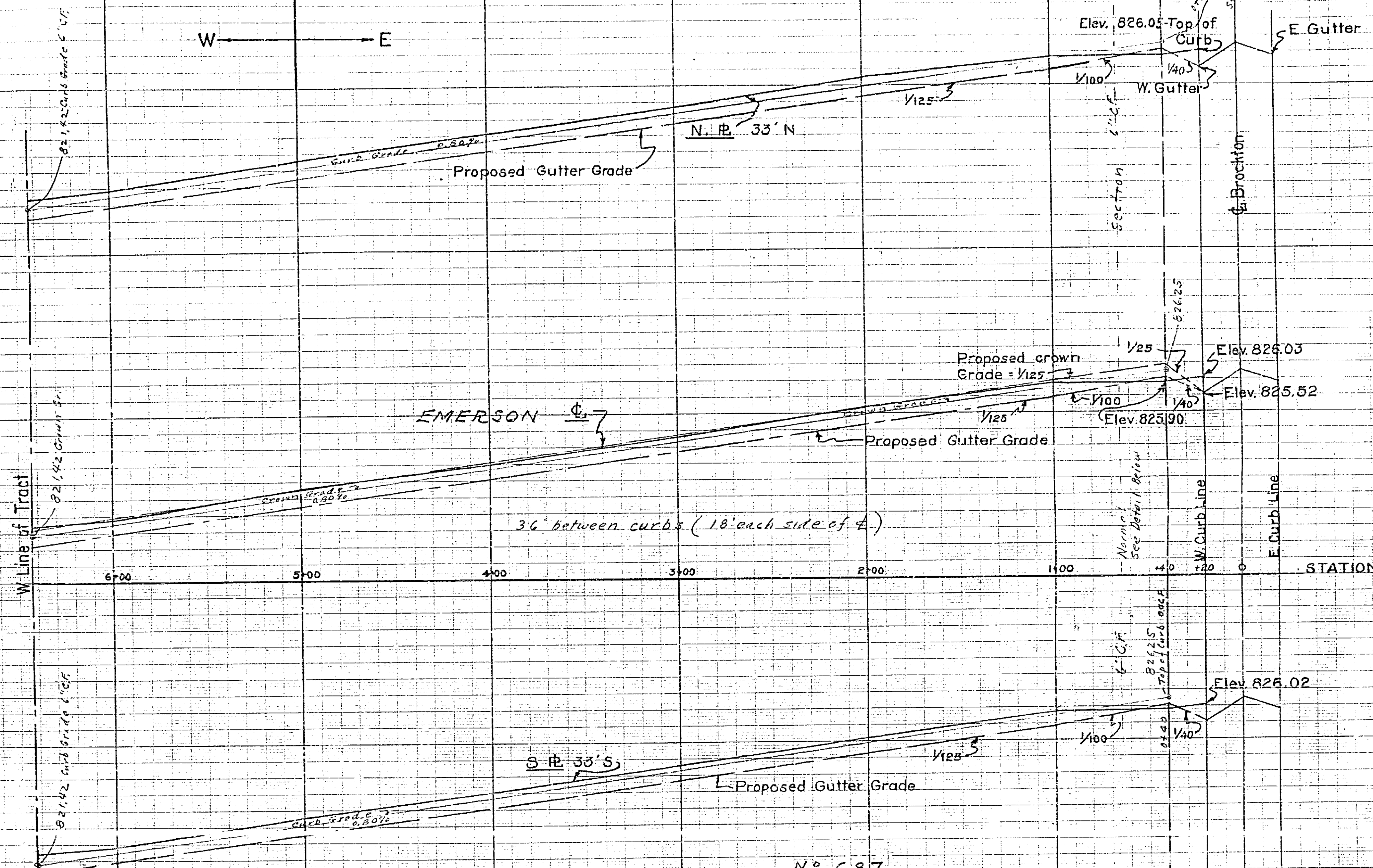

No. 687
PROFILE OF STREET
 SMITH-McMAHAN SUB.
 RIVERSIDE ENGINEERING
 Co.
 Dec. 1946.

Note: Elev. based on B.M. on E. curb of
 Brockton 15' S. of S.B. of Jurupa
 Ave. Elev. = 826.19!

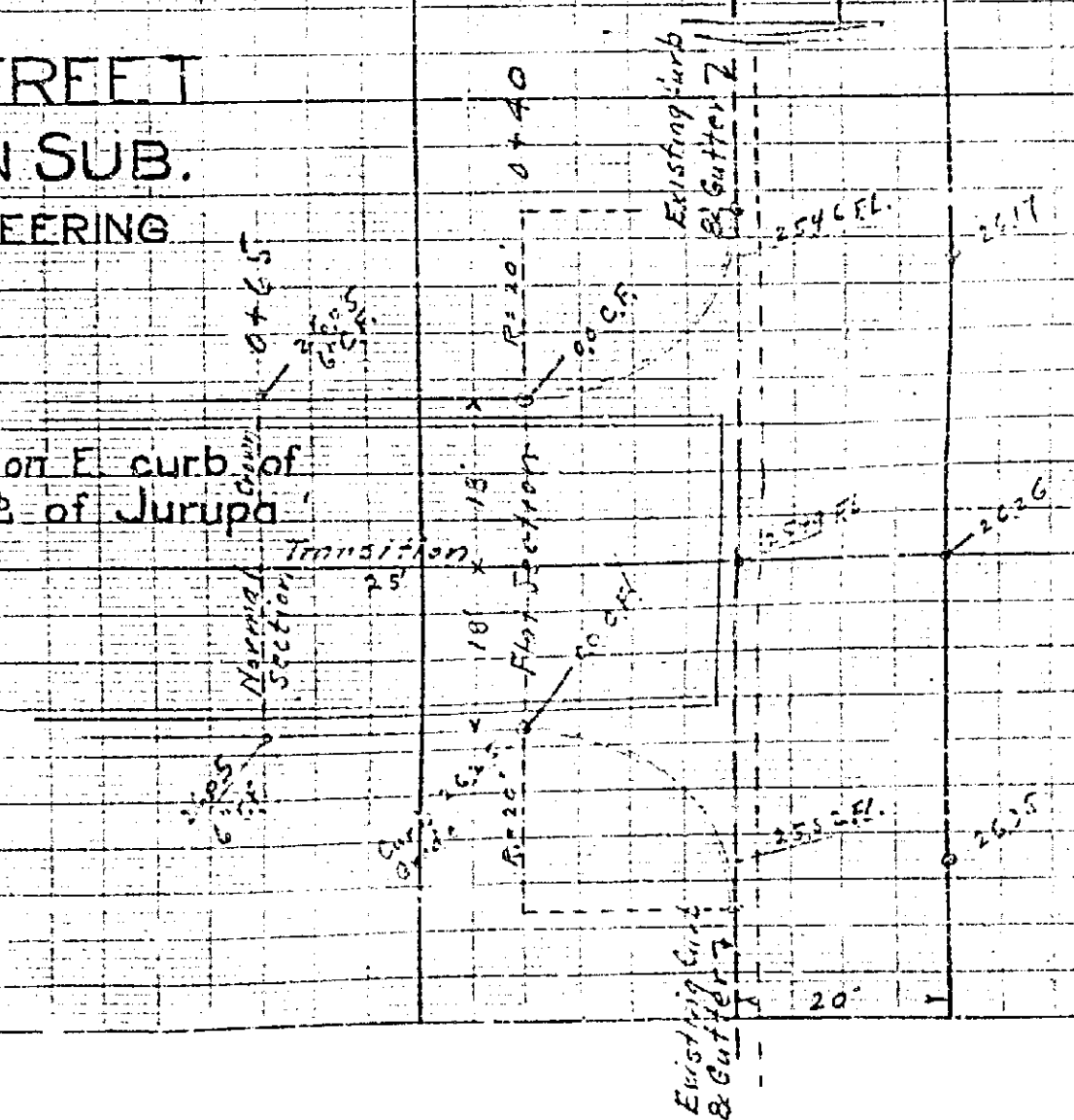

687

PROPERTY OF
CITY OF RIVERSIDE
CITY ENGINEERING DEPT.

c-12-7