

PLANS AND PROFILE
GARFIELD STREET
BETWEEN HARRISON AND VAN BUREN STREETS
STATIONS AND GRADES

SCALE: HORIZ. 1" = 40'
VERT. 1" = 2'

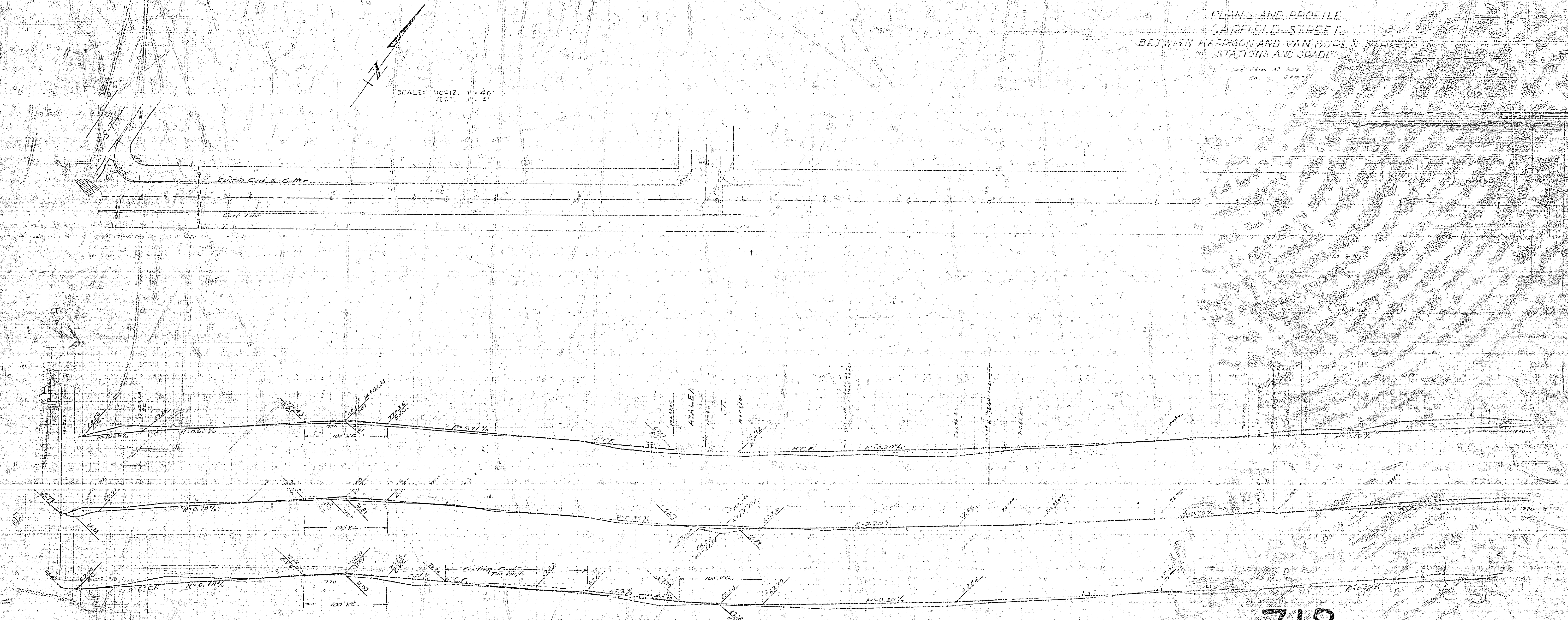

718

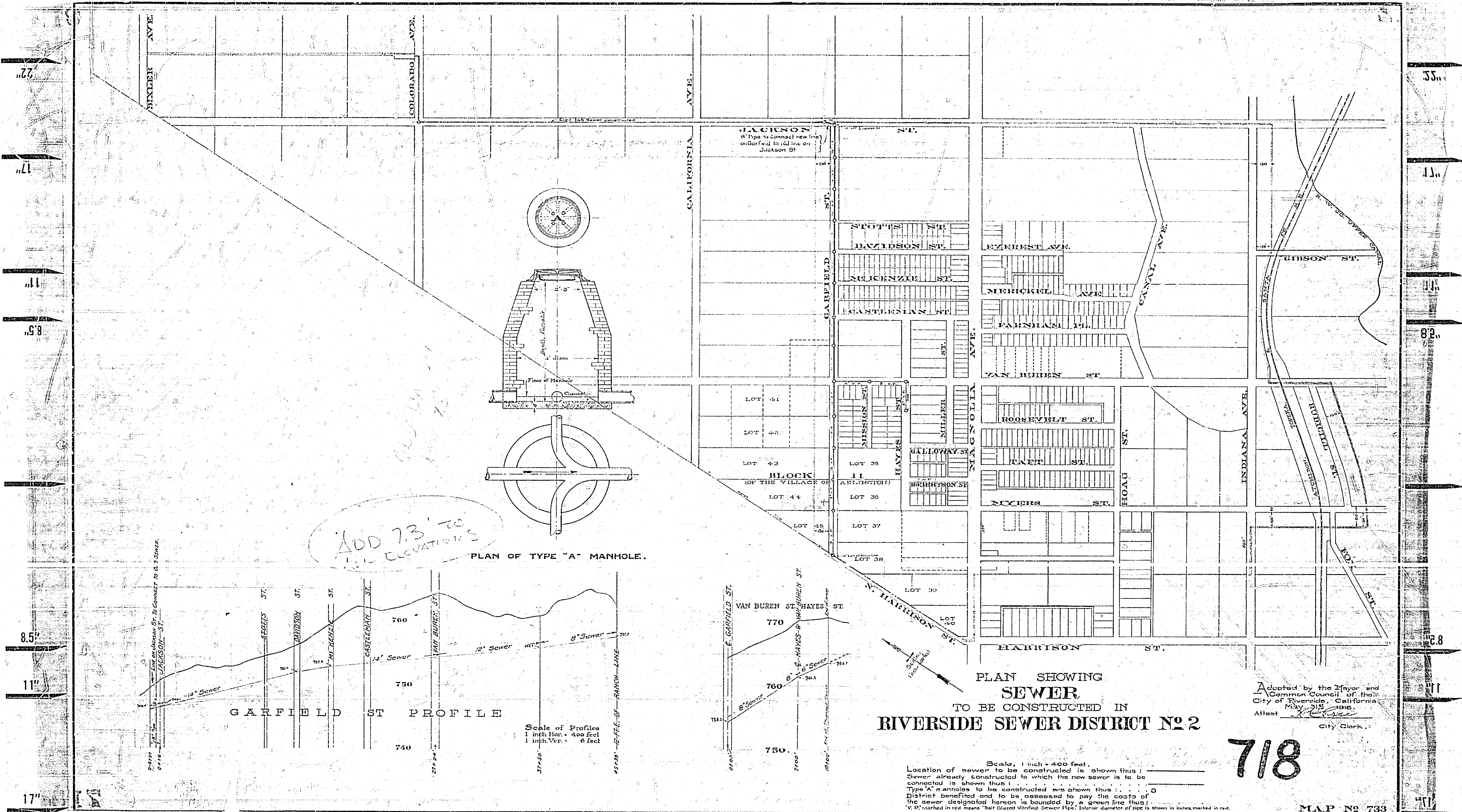

ADD 7.3' TO
ALL ELEVATIONS

PLAN OF TYPE "A" MANHOLE.

GARFIELD ST PROFILE

Scale of Profiles
1 inch Hor. = 400 feet
1 inch Ver. = 6 feet

PLAN SHOWING
SEWER
TO BE CONSTRUCTED IN
RIVERSIDE SEWER DISTRICT NO 2

Scale, 1 inch = 400 feet.
Location of sewer to be constructed is shown thus: _____
Sewer already constructed to which the new sewer is to be
connected is shown thus: _____
Type 'A' manholes to be constructed are shown thus: _____
District benefited and to be assessed to pay the costs of
the sewer designated herein is bounded by a green line thus: _____
V.P. marked in red means "Set Glassed Vitrofer Sewer Pipe." Interior diameter of pipe is shown in inches, marked in red.

Adopted by the Mayor and
Common Council of this
City of Riverside, California
May 31st 1916.
Attest _____
City Clerk.

718

MAP No 733

77'

71'

71'

69'

85'

71'

77'

72'

55'

41'

41'

82'

82.8'

81'

81'

55'

STREET

VAN BUREN

VAN BUREN

GARFIELD

AVENUE

CASTLEMAN STREET



718