

MAP SHOWING SEWER
TO BE CONSTRUCTED IN
JACKSON ST.
RIVERSIDE CALIF.
A. BRAUNSCHWEIGER, CITY ENGR.
SCALE OF MAP, 1 IN. = 400 FT.

718A

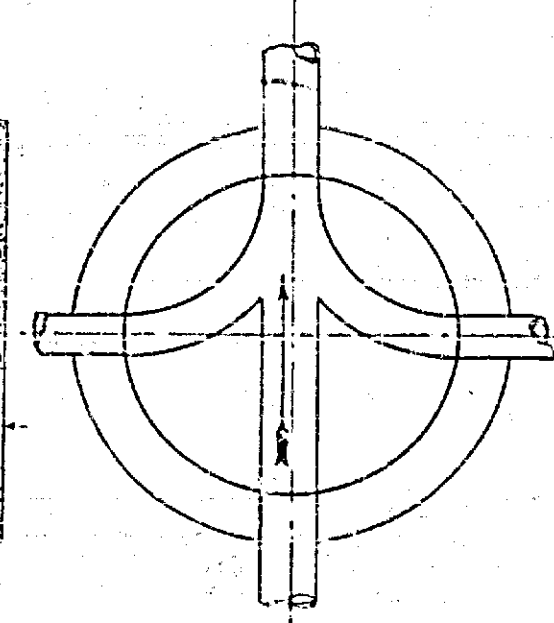
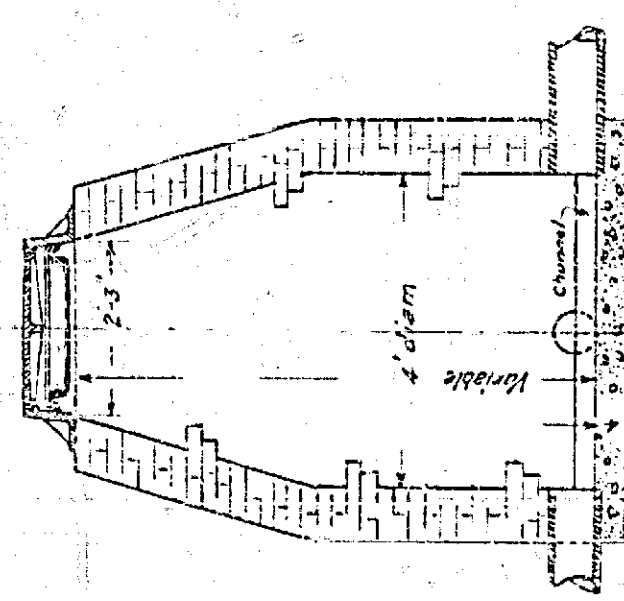
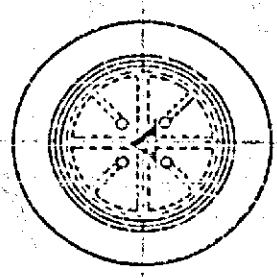
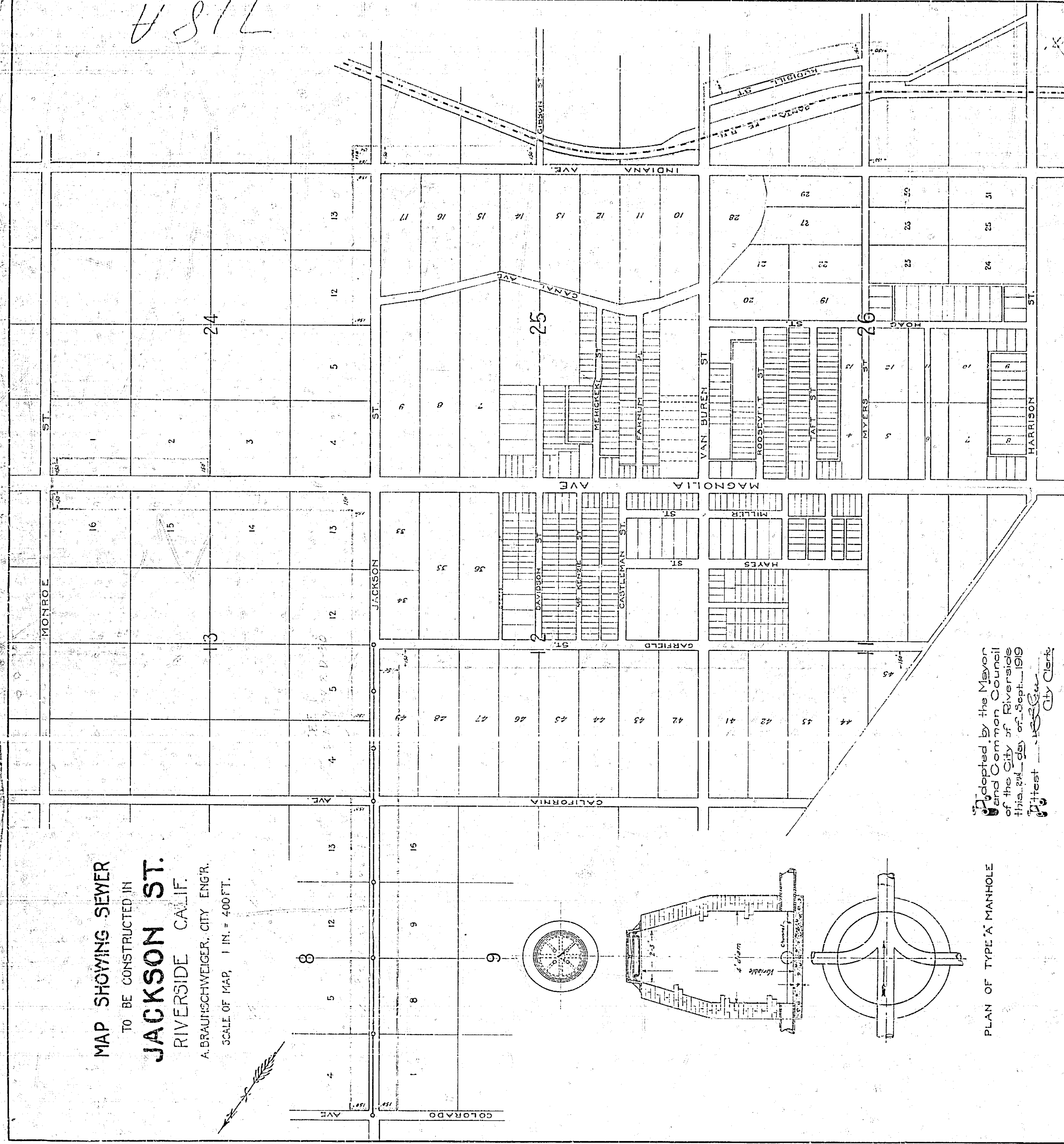

PLAN OF TYPE 'A' MANHOLE

Adopted by the Mayor
and Common Council
of the City of Riverside
this 21st day of Sept. 1919
Attest: *[Signature]* City Clerk

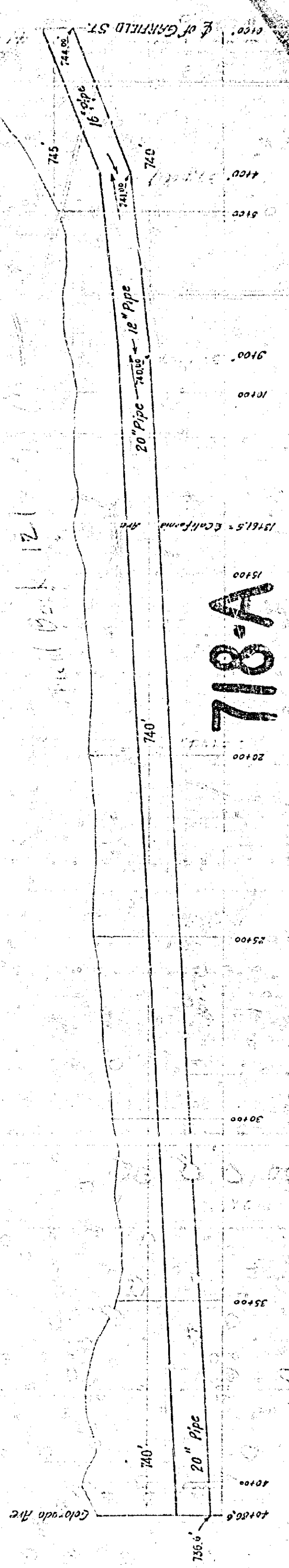

718A