

MAP SHOWING SEWER TO BE CONSTRUCTED IN
ARLINGTON

MILLER ST.
A. BRAUNSCHWEIGER, CITY ENGINEER.

Adopted by the Mayor and Common Council of the City of Riverside this 10th day of May, 1918.
Attest: *[Signature]* City Clerk

EXPLANATORY NOTES.
Sewer to be constructed is shown thus: ————
4" x 6" Y-branches are shown thus: ————
Type A Manhole is shown thus: ————
Cleanouts are shown thus: ————
Disturbed to be identified and proposed is denoted by a green line thus: ————

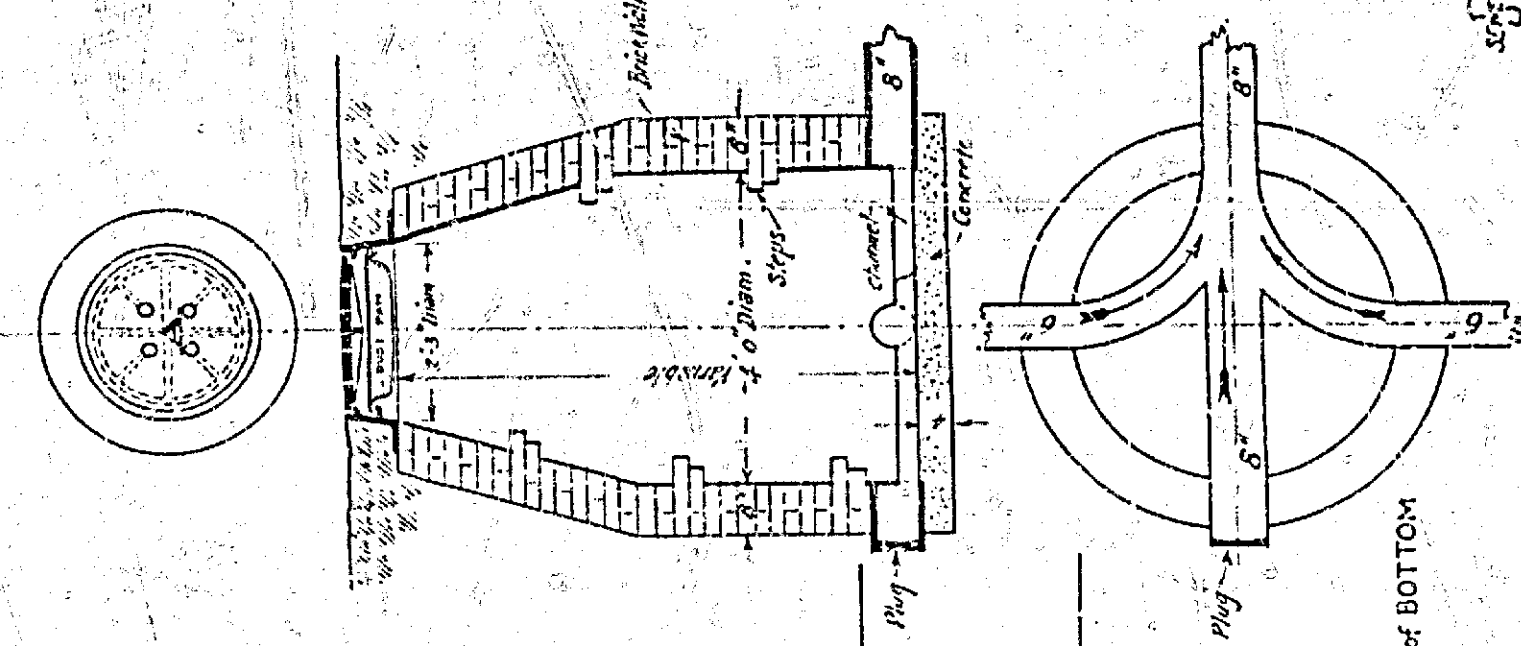
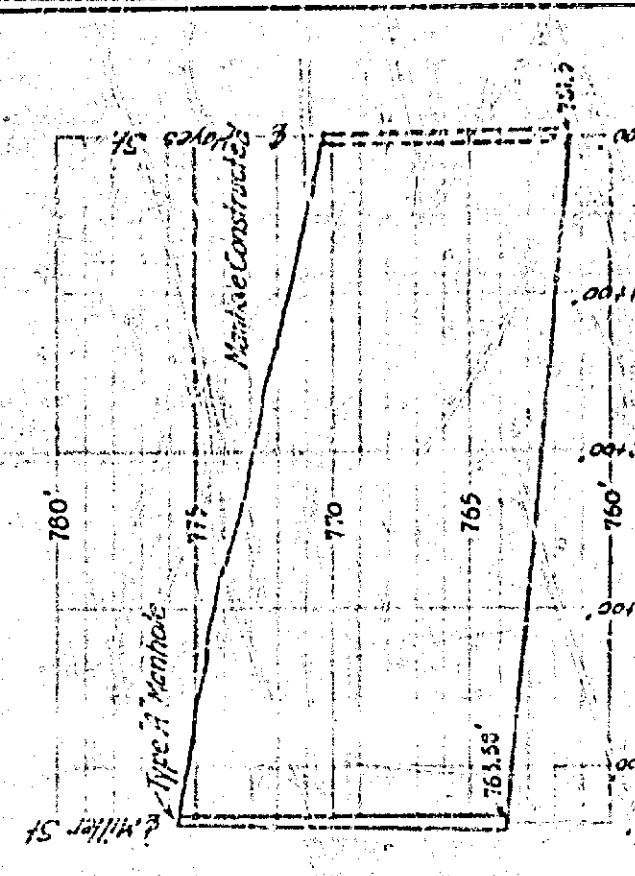
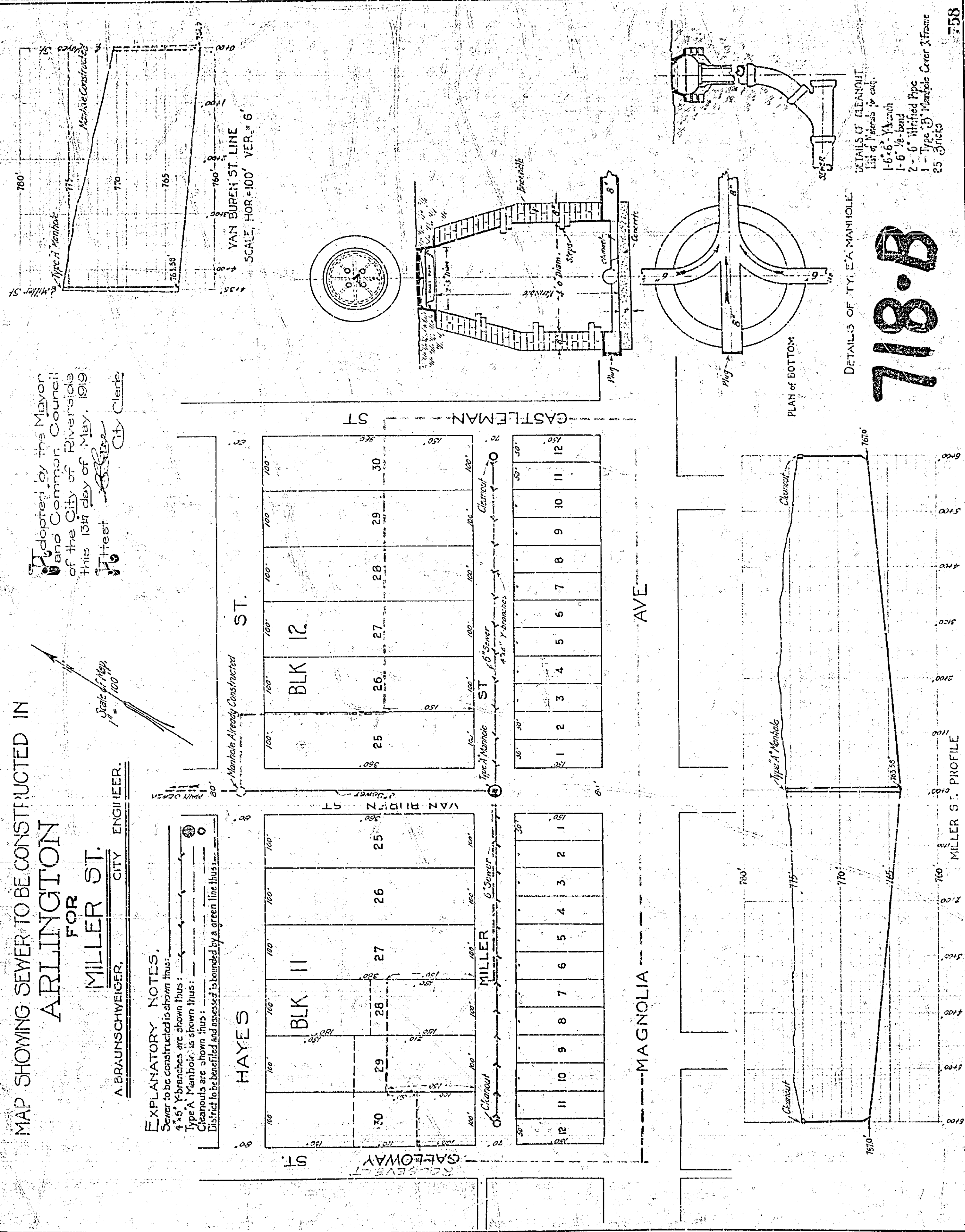

DETAILS OF TYPE A MANHOLE.
List of Materials for each:
1-6" x 6" Y-branch
1-6" 1/2" dia. pipe
1-6" vitrified pipe
1-Type A Manhole Cover & Frame
25 Bricks

718-B

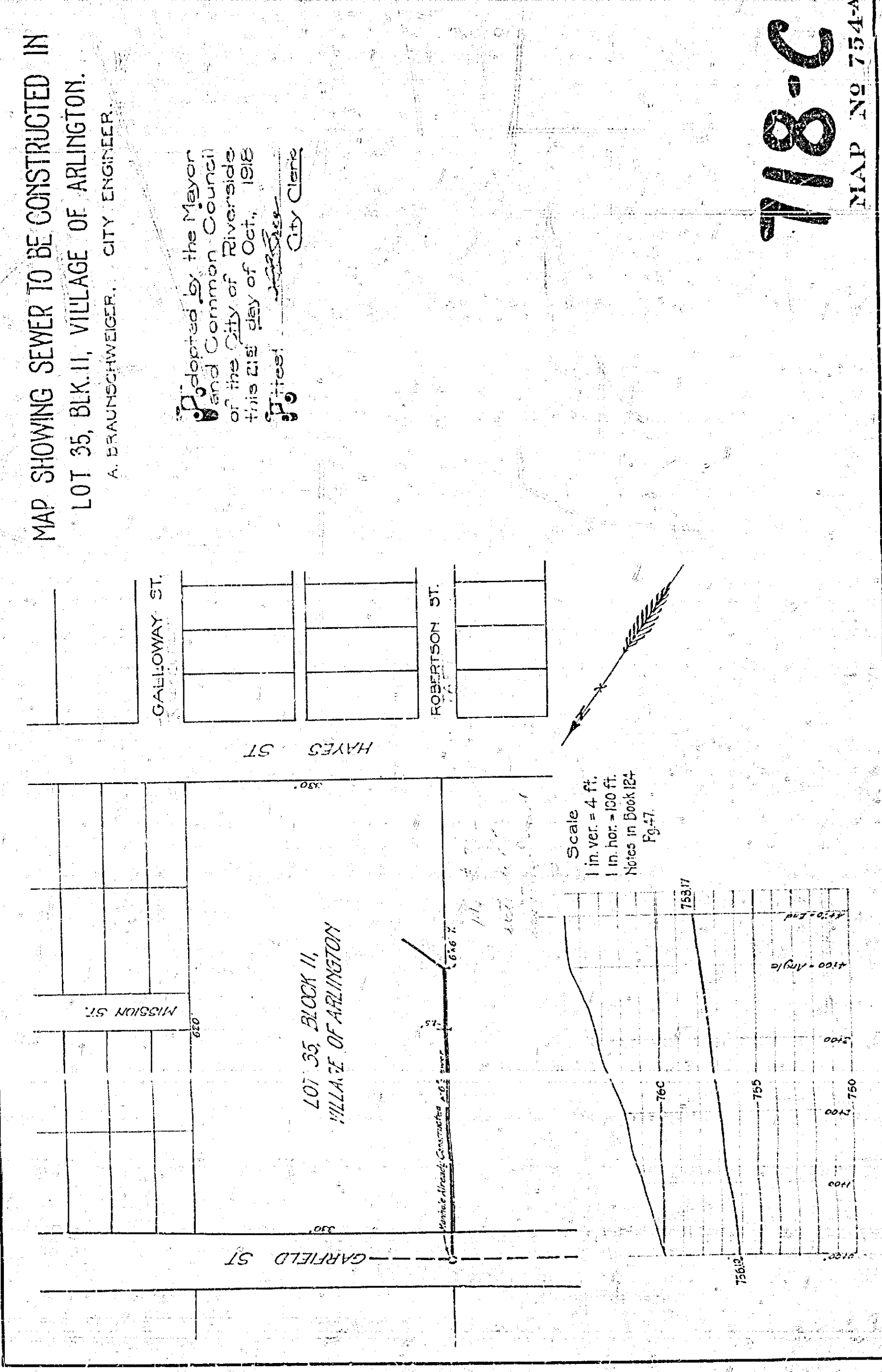

MAP SHOWING SEWER TO BE CONSTRUCTED IN
LOT 35, BLK. 11, VILLAGE OF ARLINGTON.
A. BRAUNSCHWEIGER, CITY ENGINEER.

Adopted by the Mayor and Common Council of the City of Riverside this 21st day of Oct., 1918.
Attest: *[Signature]* City Clerk

Scale
1 in. ver. = 4 ft.
1 in. hor. = 100 ft.
Notes in Booklet
Pg. 47.

718-C
MAP NO. 754-A