

MARKET ST

ST.

BLOCK 9,

ST

RANGE 7

TENTH

Edge of Depression for gutter

MAIN ST.

NINTH

MAP OF PROPOSED IMPROVEMENTS
FOR THE ALLEY IN
BLOCK 9, RANGE 7,
RIVERSIDE CALIF.

THE 4 INCH CONCRETE ROADWAY WITH OILED
SURFACE TO BE CONSTRUCTED WHERE
IS SHOWN THUS : 

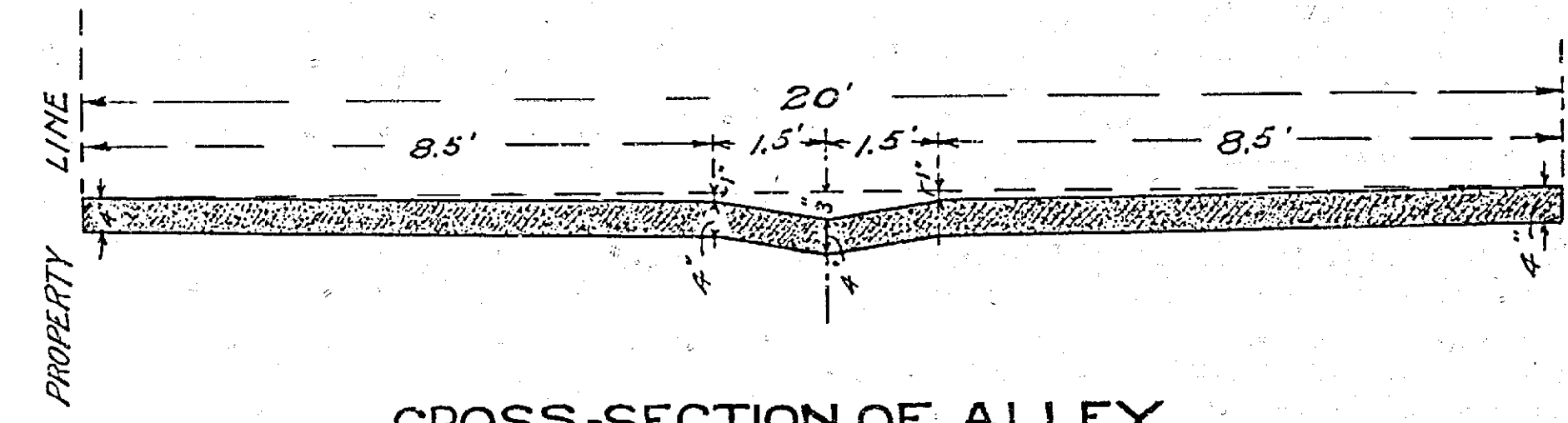

CROSS-SECTION OF ALLEY

The concrete shall be 1 bag of cement to 2½ cu. ft of sand and 5 cu. ft. of broken rock. The amount of broken rock shall be diminished or increased so as to leave the mortar a mix of 1 to 2½ and make a concrete free of voids, homogeneous, and free mortar appearing on the surface under the tamp. The surface shall be covered with oil, ¼ gallon per sq. yd., being 90% asphalt, and then covered with screenings that will pass through a ¼" mesh sieve.

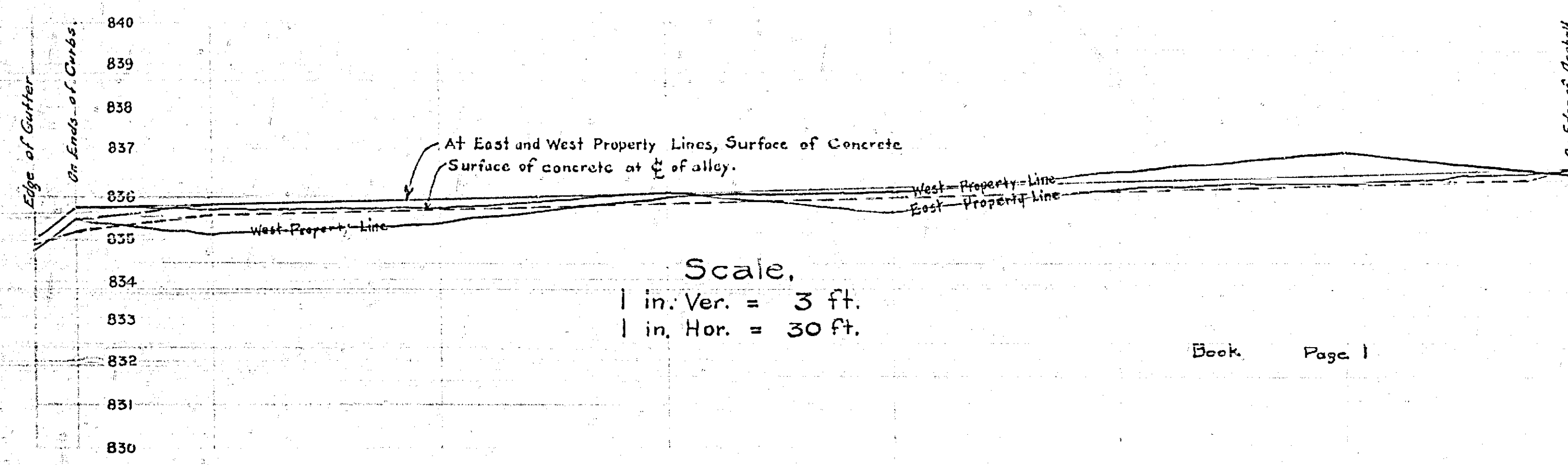
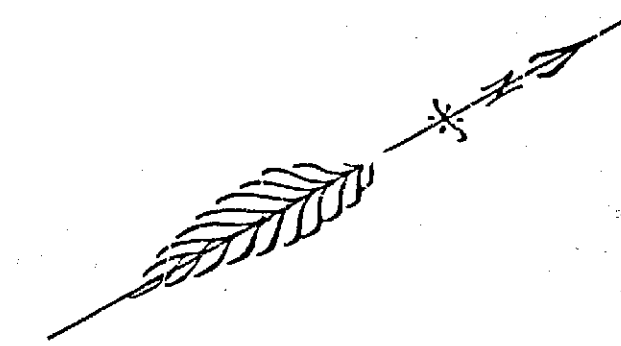

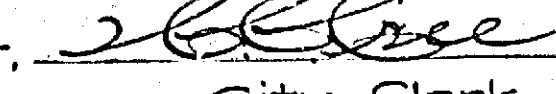
Adopted by the Mayor and Common Council
of the City of Riverside Calif., July 13, 1915.
Attest, 
City Clerk.

721