

OAKWOOD PL. BROCKTON - PALM	
DWG NO 72	SHEET SHEETS F. B. 353-362
DRAWN BY DJM.	CHECKED APPROVED

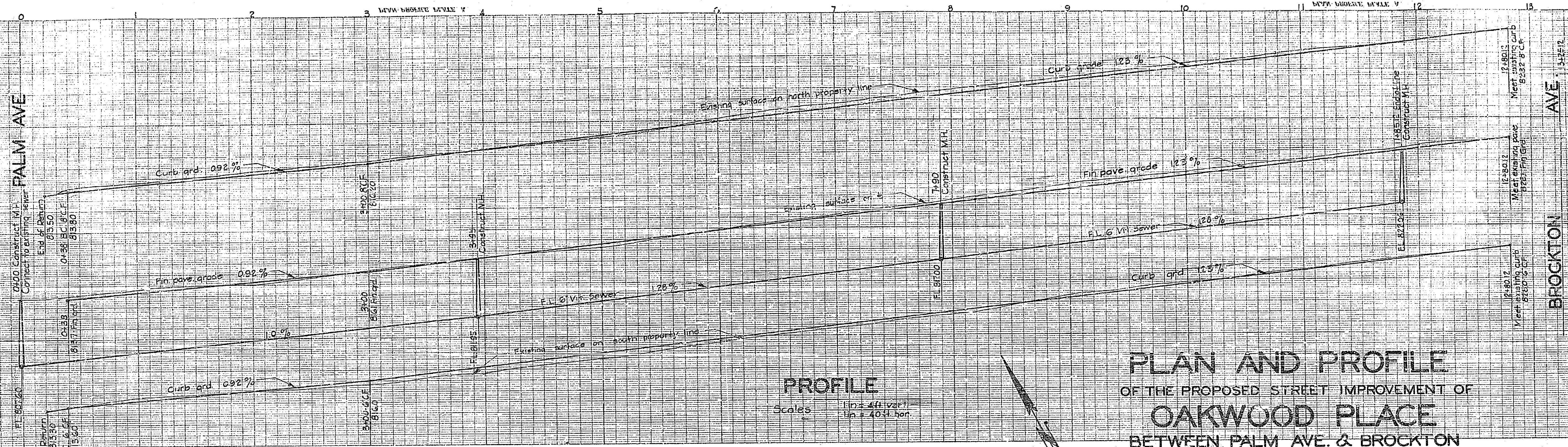

PROFILE
 Scales: 1 in = 4 ft vert.
 1 in = 40 ft hor.

PLAN AND PROFILE
 OF THE PROPOSED STREET IMPROVEMENT OF
OAKWOOD PLACE
 BETWEEN PALM AVE. & BROCKTON AVENUE

ENGINEERING DEPT. CITY OF RIVERSIDE
 DEC. 1938 APPROVED CITY ENGINEER

362/1
 353/72 "Y" Locations

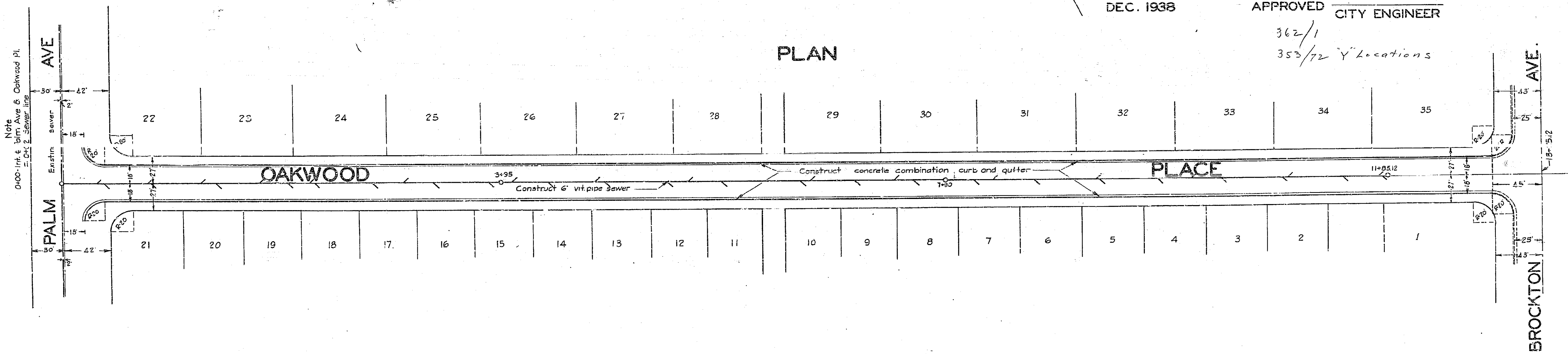

Note
 0'-00" Int. & 2'-00" Elev. of Oakwood Pl.
 = C+1 2' Sewer line

72-1