

11.0  
 11.0  
 8.2  
 8.2  
 11.1

NORTH MAIN STREET

STREET

HENDRY STREET

PLAN AND PROFILE  
 NO. 740-R  
 SHOWING PROPOSED SANITARY SEWER IN  
 NORTH MAIN STREET  
 SOUTH FROM HENDRY STREET  
 IN THE CITY OF RIVERSIDE

SCALE: HOR. 1" = 20 FT.  
 VERT. 1" = 4 FT.  
 RE. 3-11-28 PLAN 11  
 APPROVED M. H. Brown  
 CITY ENGINEER

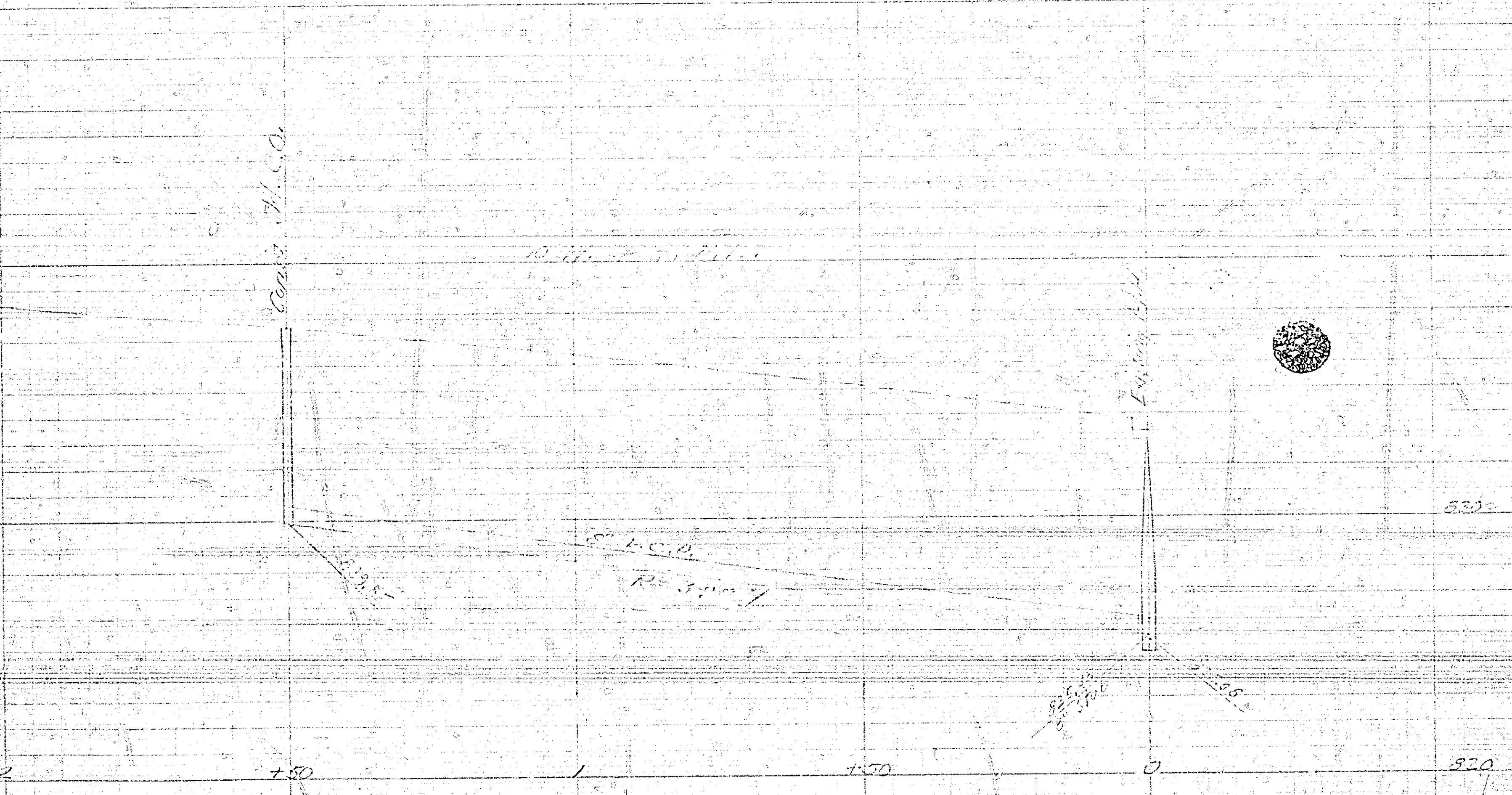

740-R