

22"
17"
11"
58"
95"
11"
17"
22"

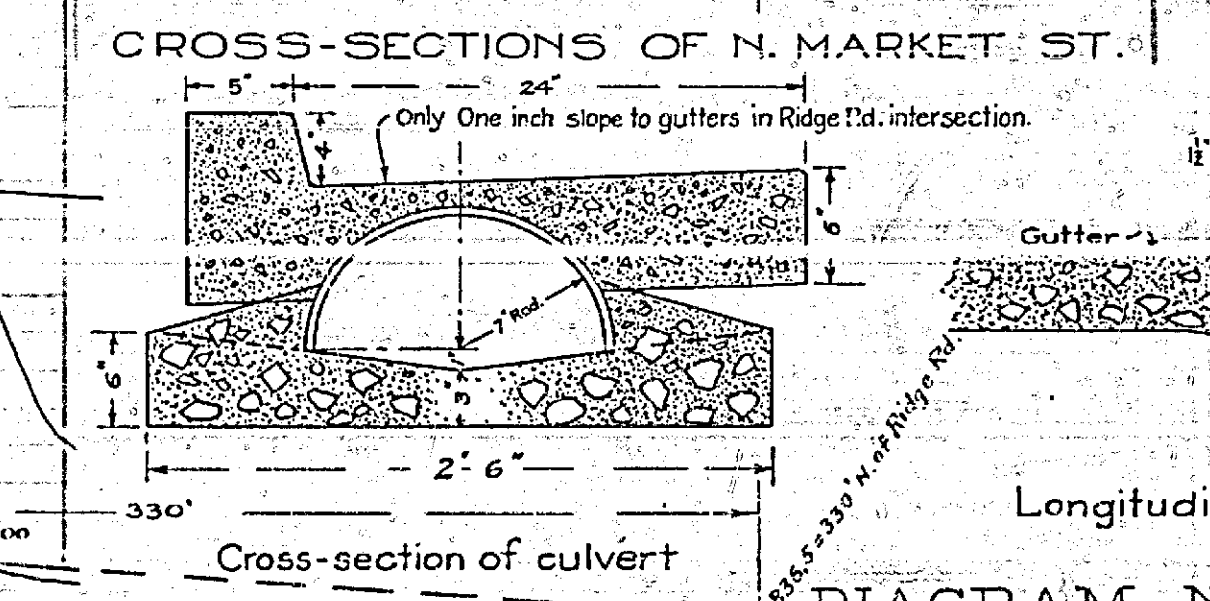

FIELD BOOK 119 PG. 57.
SCALE,
1 IN. VER. = 4 FT. 1 IN. HOR. = 40 FT.

DIAGRAM NO. 1
Showing details of Corrugated Gutter and Concrete Culvert. Concrete 1 bag of cement to 3 cubic feet and 5 cubic feet of rock.

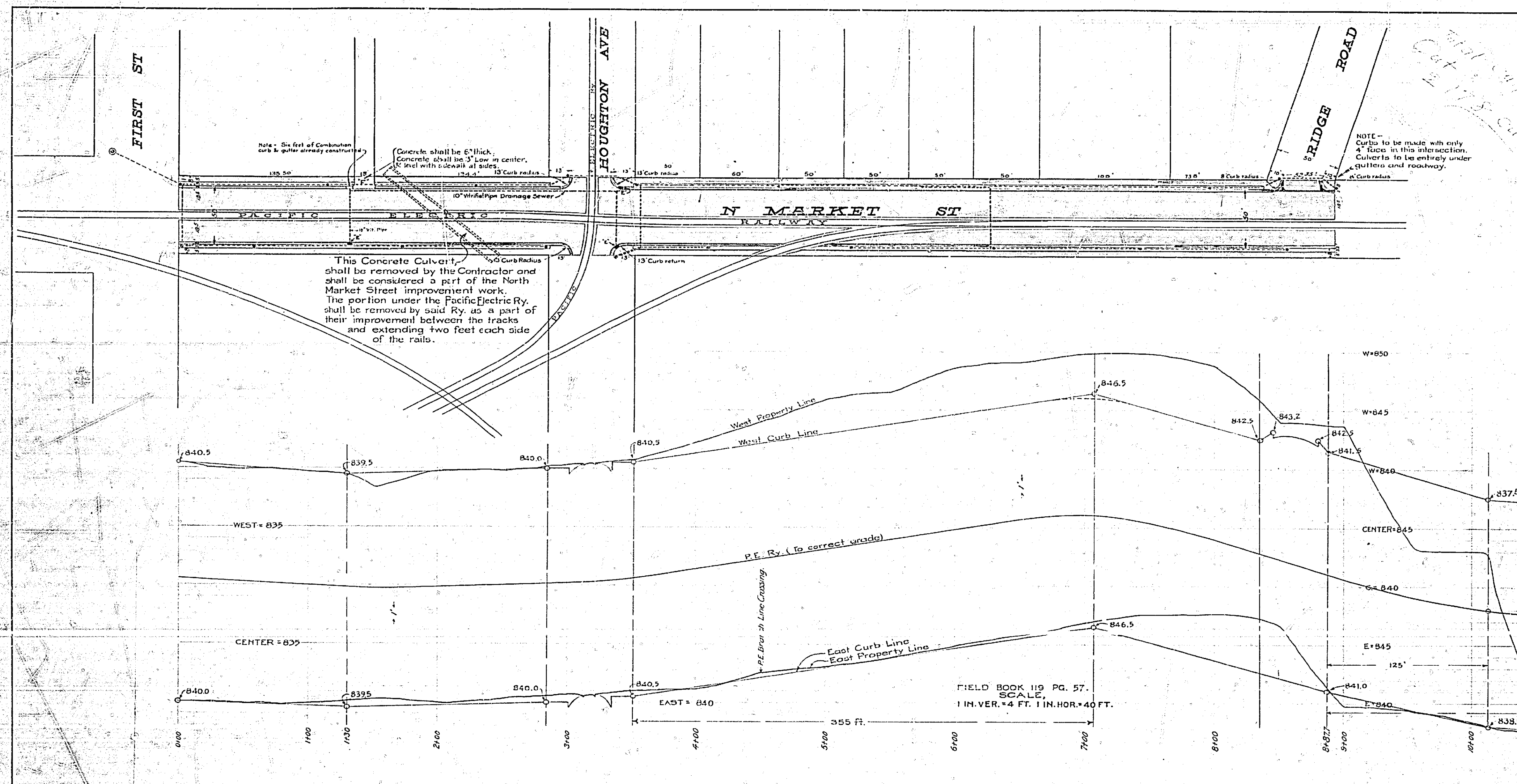
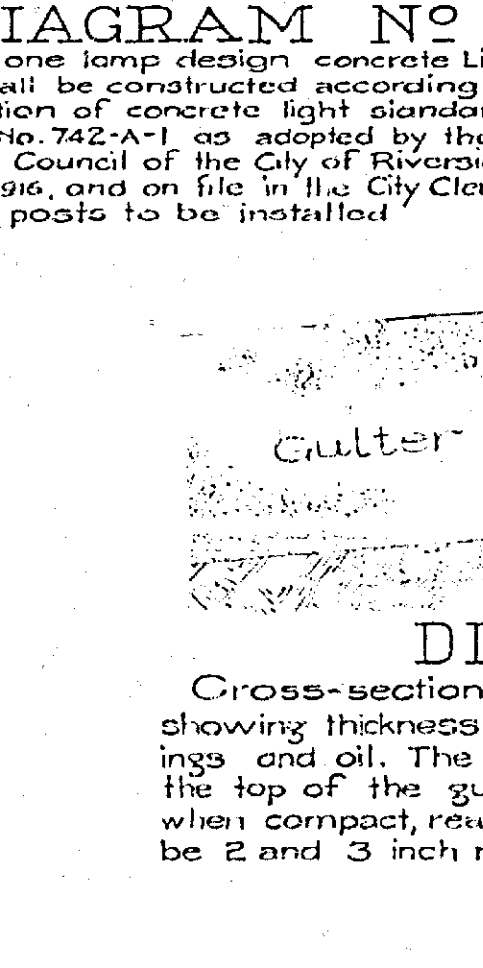
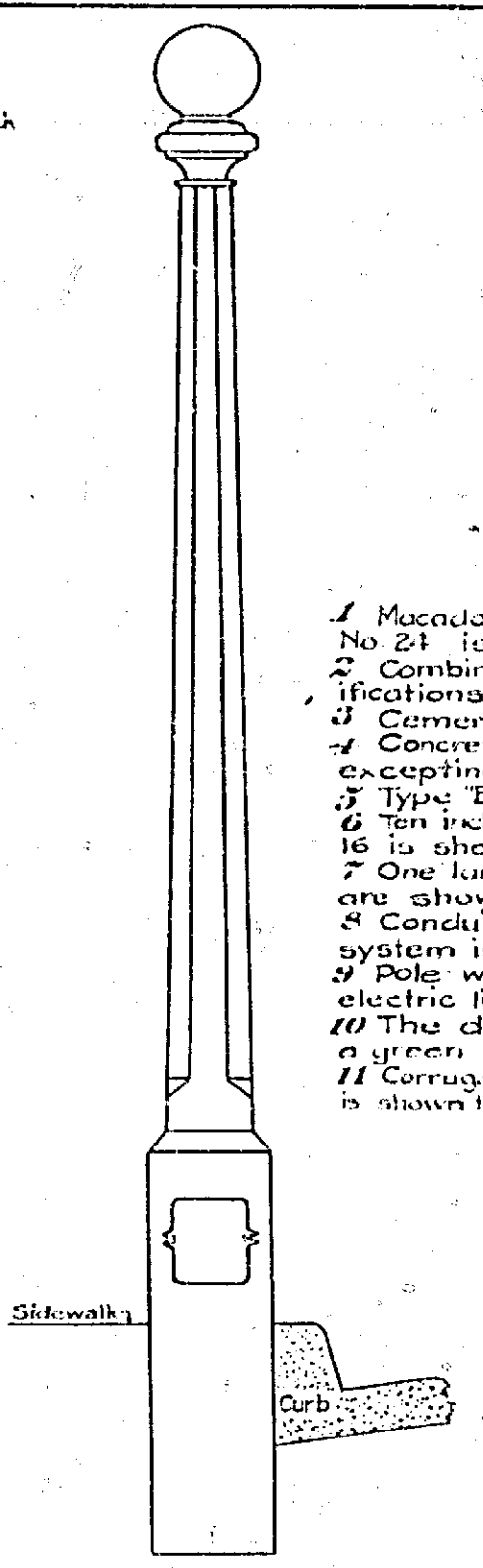
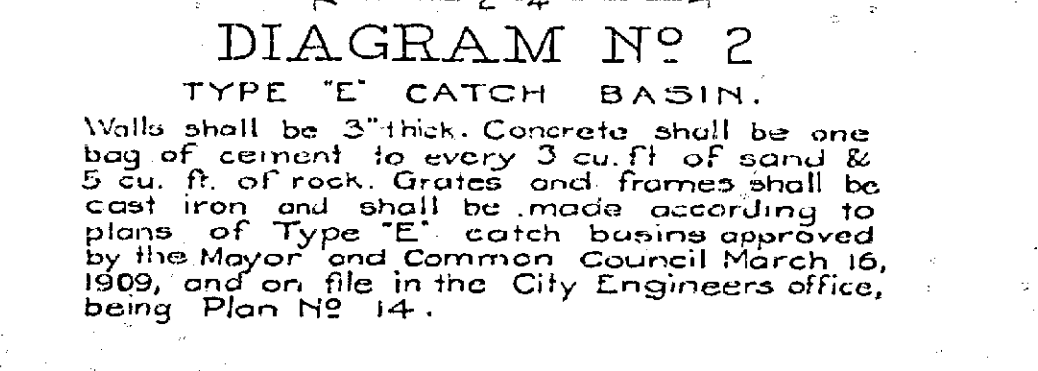
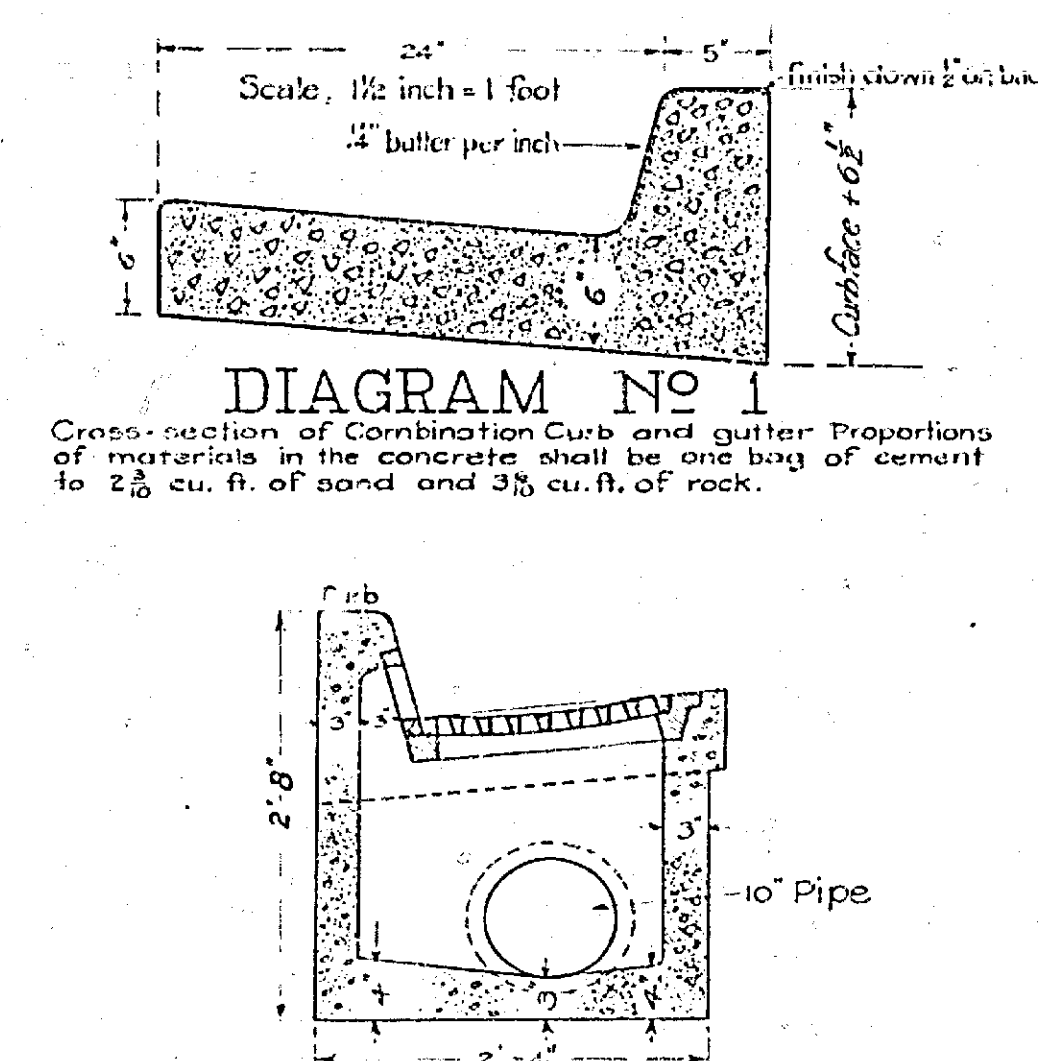
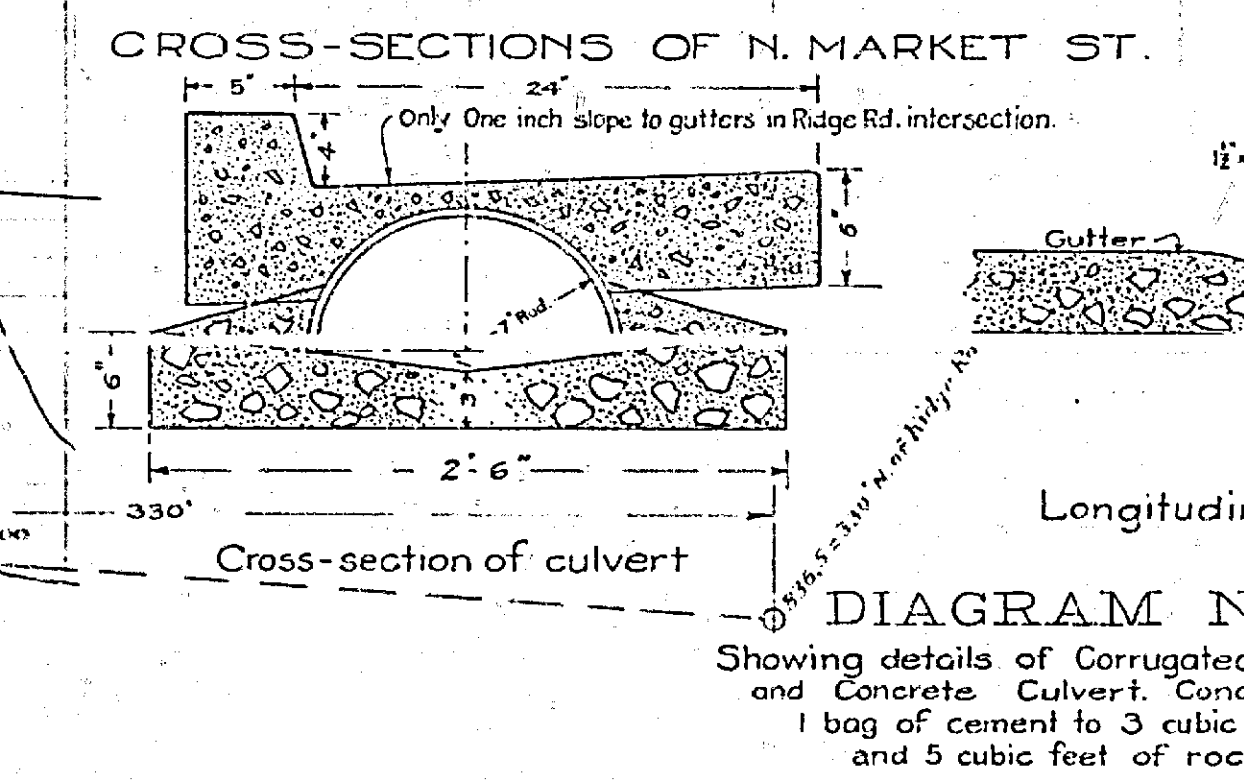
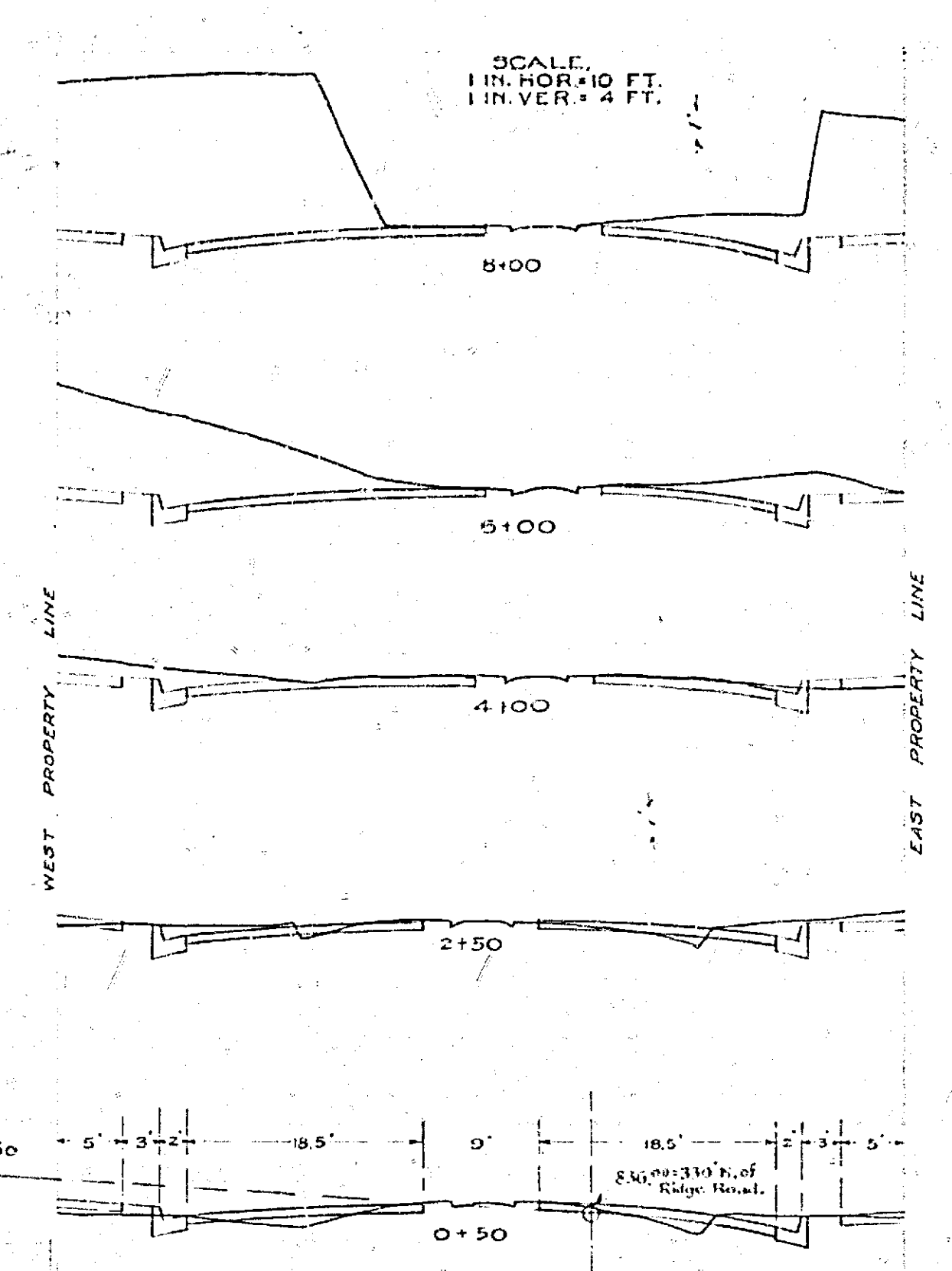
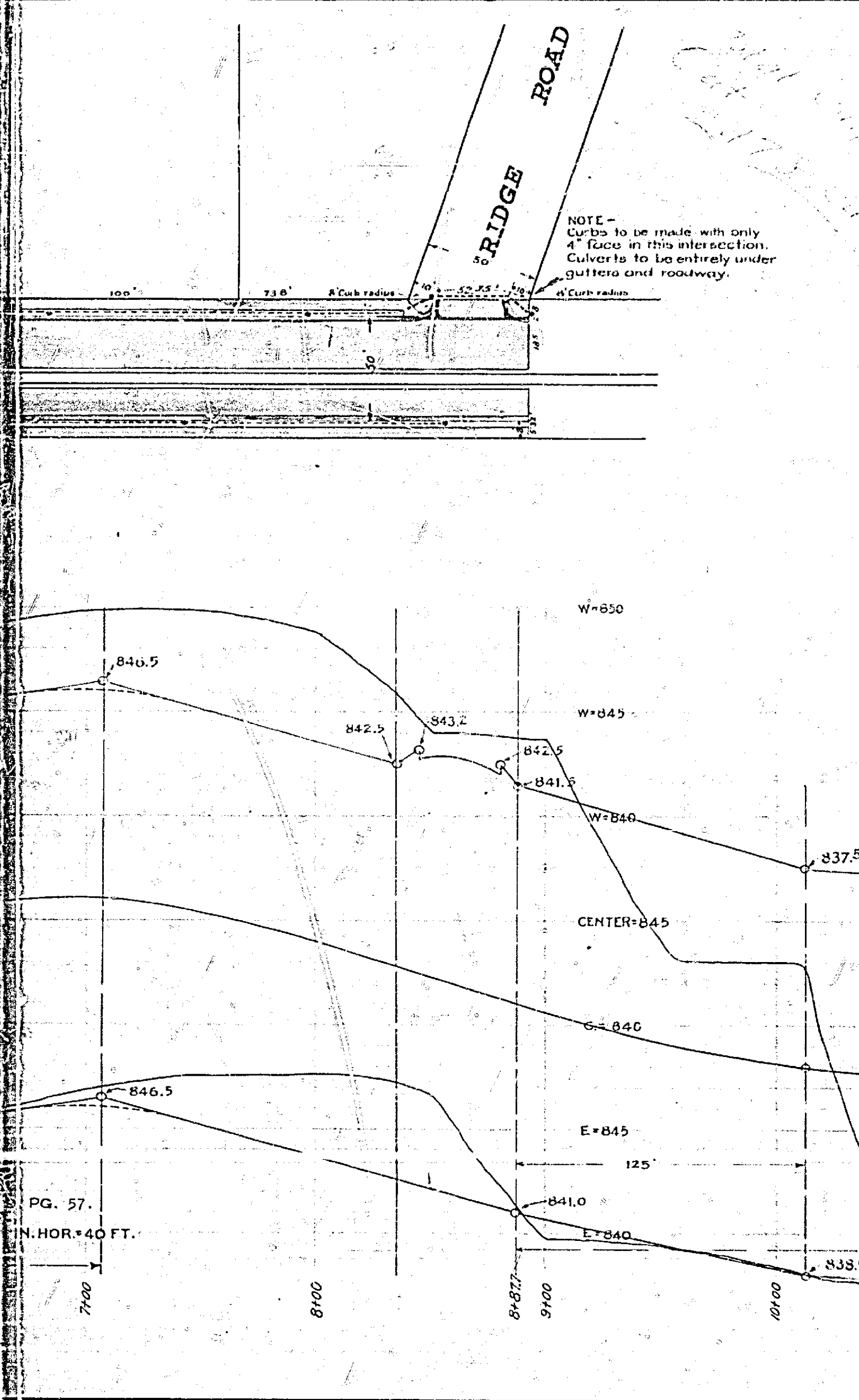

MAP SHOWING IMPROVEMENTS TO BE MADE ON NORTH MARKET STREET FROM FIRST ST TO RIDGE ROAD

A. P. CAMPBELL, CITY ENGINEER.
SCALE OF MAP, 1 INCH = 40 FEET.

EXPLANATORY NOTES OF WORK TO BE DONE

- 1 Macadam roadway to be constructed according to Diagram No. 4 and Specifications No. 21 as shown thus: _____
- 2 Combination curb and gutter to be constructed according to Diagram No. 1 and Specifications No. 22 for the curb portion and No. 23 for the gutter portion as shown thus: _____
- 3 Cement sidewalks to be constructed according to Specifications No. 21 as shown thus: _____
- 4 Concrete alley entrances to be constructed according to gutter Specifications No. 23, excepting therefrom paragraphs 2 and 3, as shown thus: _____
- 5 Type 'E' catch basins to be constructed according to Diagram No. 2 as shown thus: _____
- 6 Ten inch vitrified pipe drainage sewer to be constructed according to Specifications No. 16 as shown thus: _____
- 7 One lump concrete light standards to be constructed according to Diagram No. 5 as shown thus: _____
- 8 Conduit wires to be laid to connect the light standards to the City electric light system as shown thus: _____
- 9 Pole where transformer shall be located, connecting this lighting system to the electric lighting system of the City, is shown thus: _____
- 10 The district to be assessed to pay the costs of this improvement is bounded by a green line thus: _____
- 11 Corrugated galvanized iron & concrete culvert to be constructed is shown thus: _____

Adopted by the Mayor and Common Council of the City of Riverside this 19th day of Sept 1910.
Attest _____ City Clerk

MAP No 743

743