

CROSS-SECTION ON LINE F-F OF SPECIAL CURB AND GUTTER.

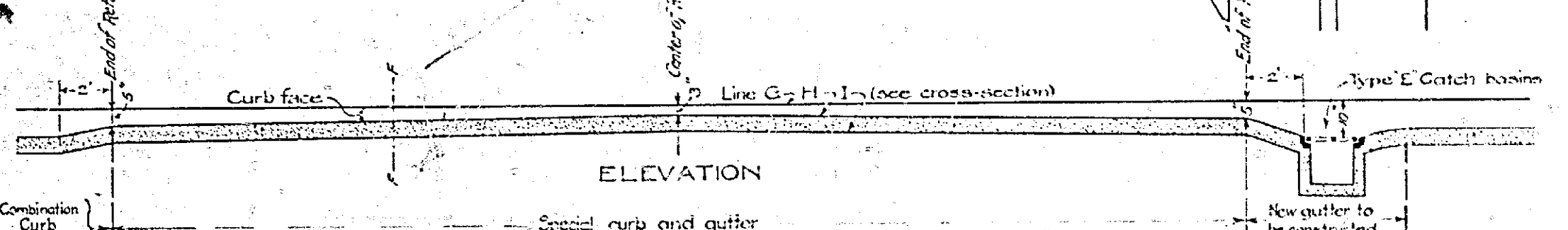

DIAGRAM NO 1 SPECIAL CURB AND GUTTER.

For returns at intersections, to be considered the same as the combination curb and gutter except where shown otherwise on this diagram.

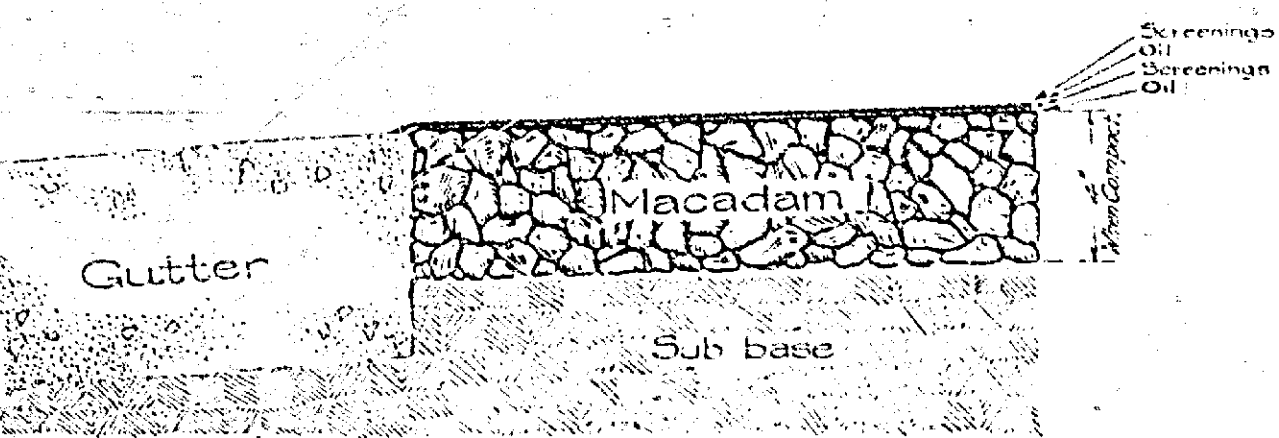
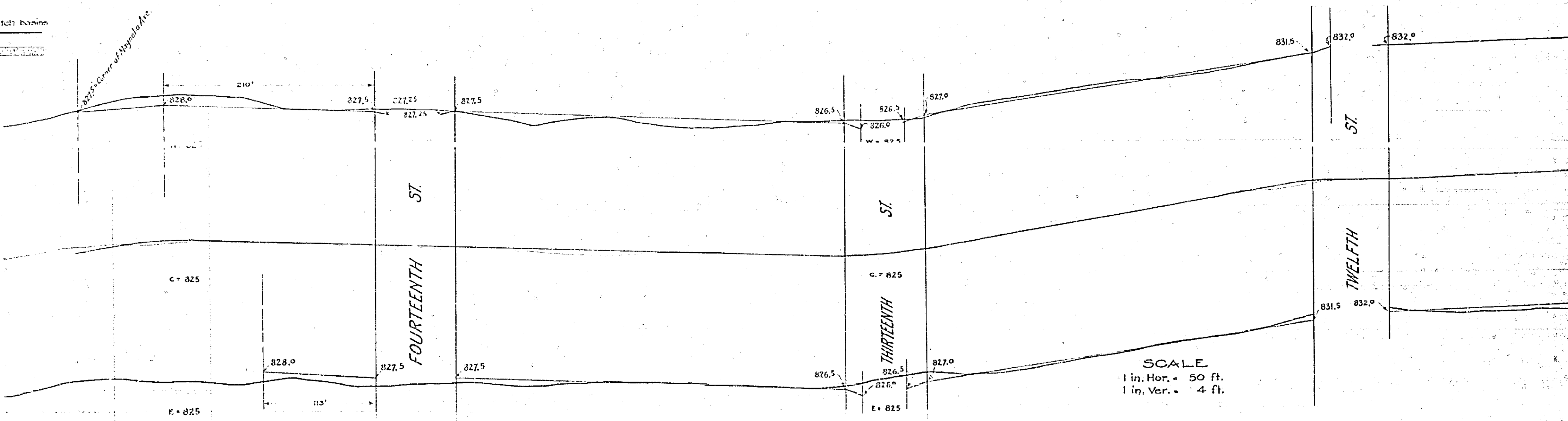
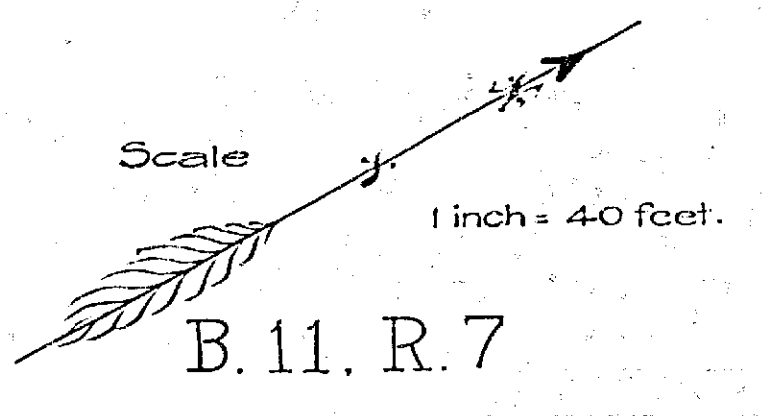

DIAGRAM NO 2 CROSS-SECTION OF A PORTION OF MACADAM ROADWAY showing thickness of macadam and order of applying screenings and oil. The surface of the macadam shall be level with the top of the gutter edge and the finished grade stakes when compact, ready for the oil and screenings. Rock shall be 2 and 3 inch rock. One quarter inch screenings shall be used.



SCALE 1 in. Hor. = 50 ft. 1 in. Ver. = 4 ft.



Frame 2 of 2

MAP SHOWING IMPROVEMENTS
TO BE MADE ON
MARKET ST.
TENTH ST TO MAGNOLIA AVE.
A.P. CAMPBELL, CITY ENGINEER.

EXPLANATORY NOTES OF WORK TO BE DONE

1. Macadam roadway to be constructed according to Diagram No 2 and Specifications No 24 is shown thus:
2. Cement sidewalk to be constructed according to Specifications No 21 is shown thus:
3. Combination curb & gutter to be constructed according to Diagram No 3 and Specifications No 22 and 23 is shown thus:
4. Special combination curb and gutter to be constructed according to Diagram No 1 and Specifications No 22 and 23 is shown thus:
5. Type "I" catch basins to be constructed according to Diagram No 4 and plans for Type "I" catch basins are shown thus:
6. Ten inch vitrified pipe drainage sewers to be constructed according to Specifications No 16, are shown thus:
7. Concrete alley entrances to be constructed according to Diagram No 5 and Specifications No 23 (excepting paragraphs 2 & 3) are shown thus:
8. District benefited is bounded by a green line thus:

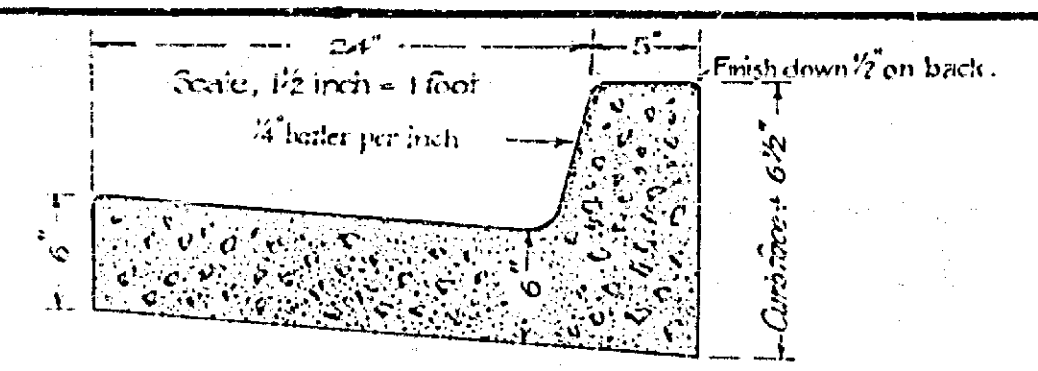

DIAGRAM No 3
Cross-section of Combination Curb & Gutter. Proportions of materials in the concrete shall be one bag of cement, 2 1/2 cu. ft. of sand and 3/8 cu. ft. of rock.

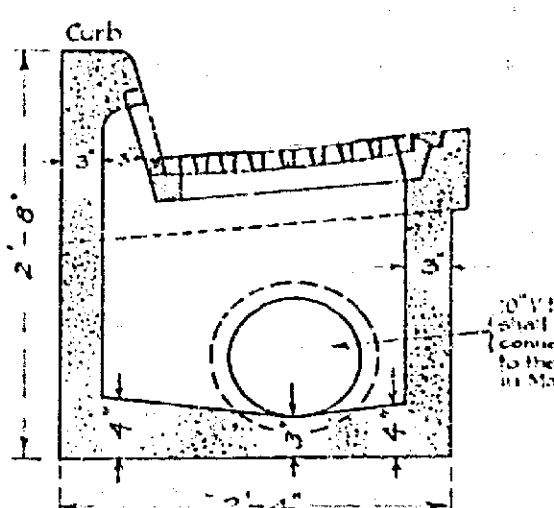
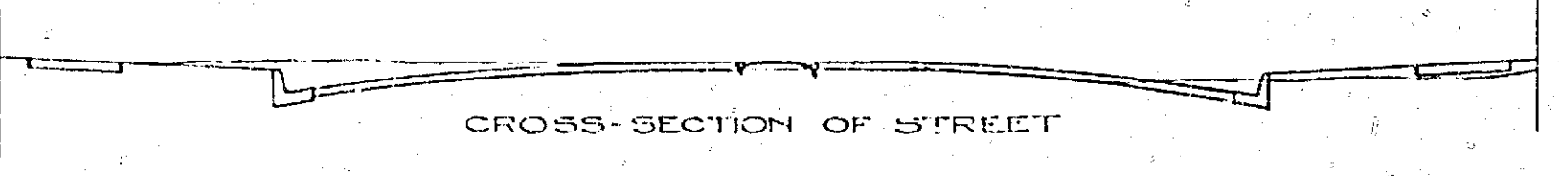

DIAGRAM No 4
Type "I" Catch Basin. Walls shall be 3" thick. Concrete shall be one bag of cement, 3 cu. ft. of sand and 5 cu. ft. of rock. Grates and frames shall be cast iron and shall be made according to plans of Type "I" catch basins approved by the Mayor and Common Council of Riverside, March 10, 1909 and on file in the City Engineer's office (Map No 14). Brick walls and floors may be made instead of concrete by making 7" walls & floor, cement plastered on inside, cement mortar to be one part cement to two parts sand.



CROSS-SECTION OF STREET

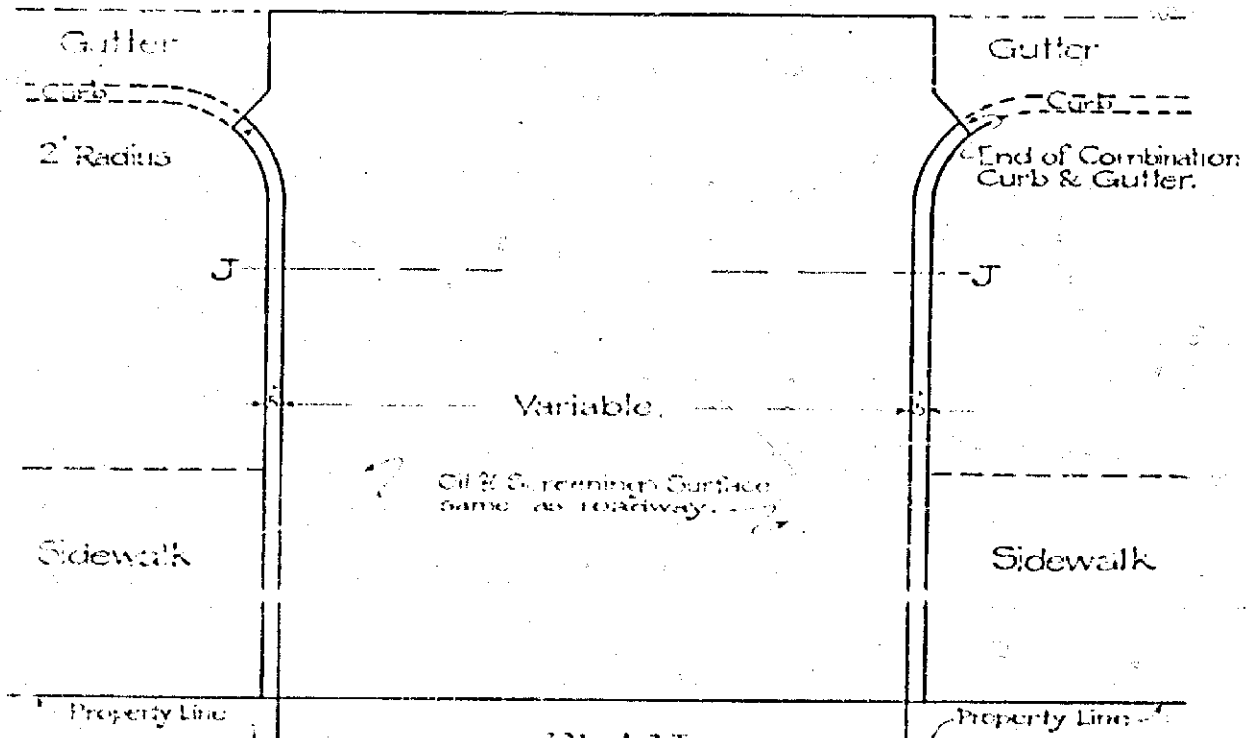
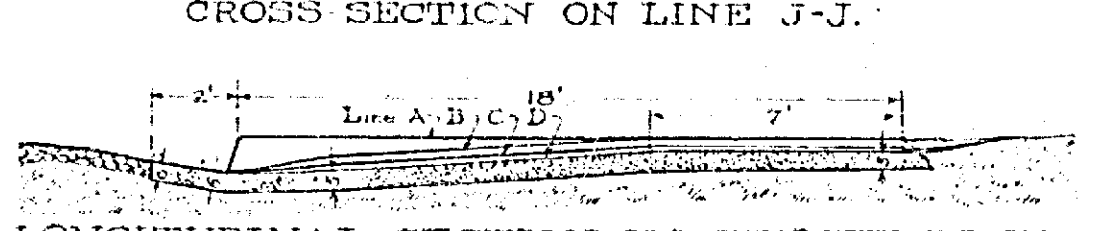
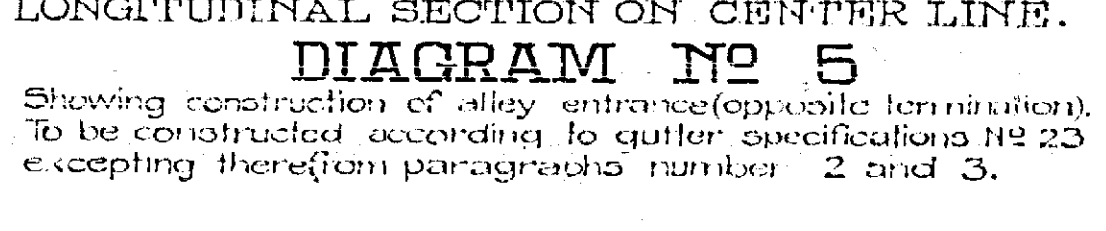

DIAGRAM No 5
Longitudinal Section on Center Line. Showing construction of alley entrance (opposite ten foot) to be constructed according to gutter specifications No 23 excepting therefrom paragraphs number 2 and 3.



CROSS SECTION ON LINE J-J.



LONGITUDINAL SECTION ON CENTER LINE.

Adopted by the Mayor and Common Council of the City of Riverside this 24th day of Oct. 1916.
Attest: *[Signature]*
City Clerk.

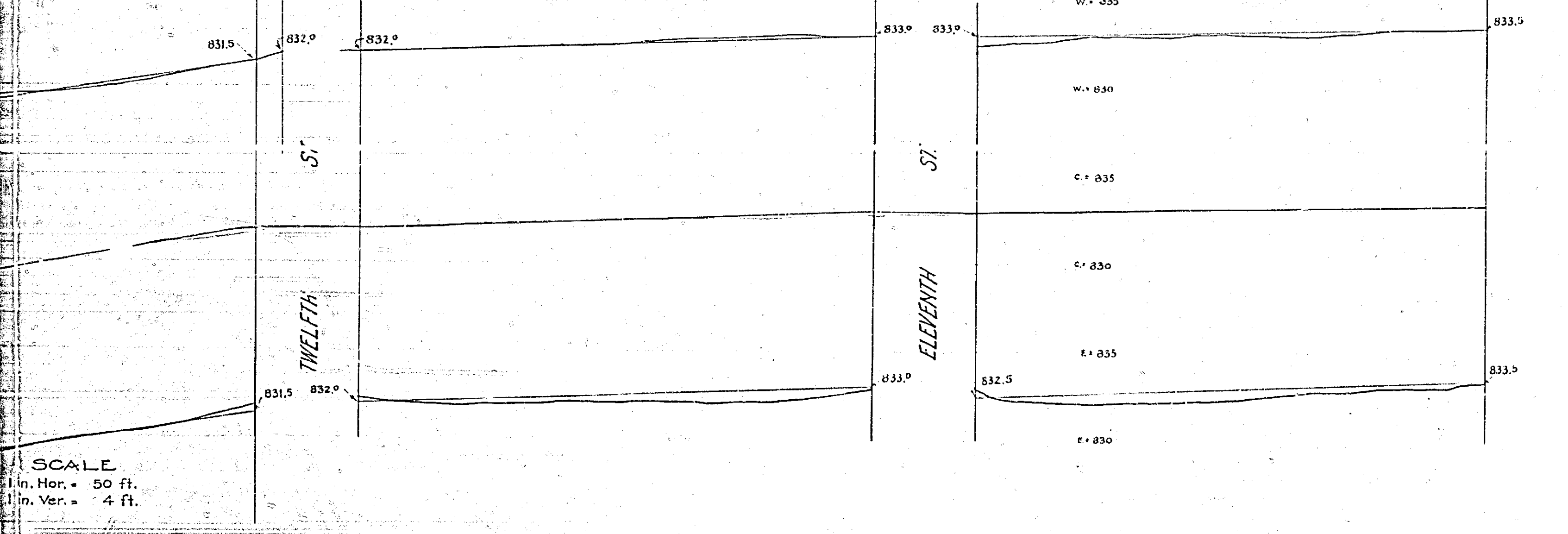
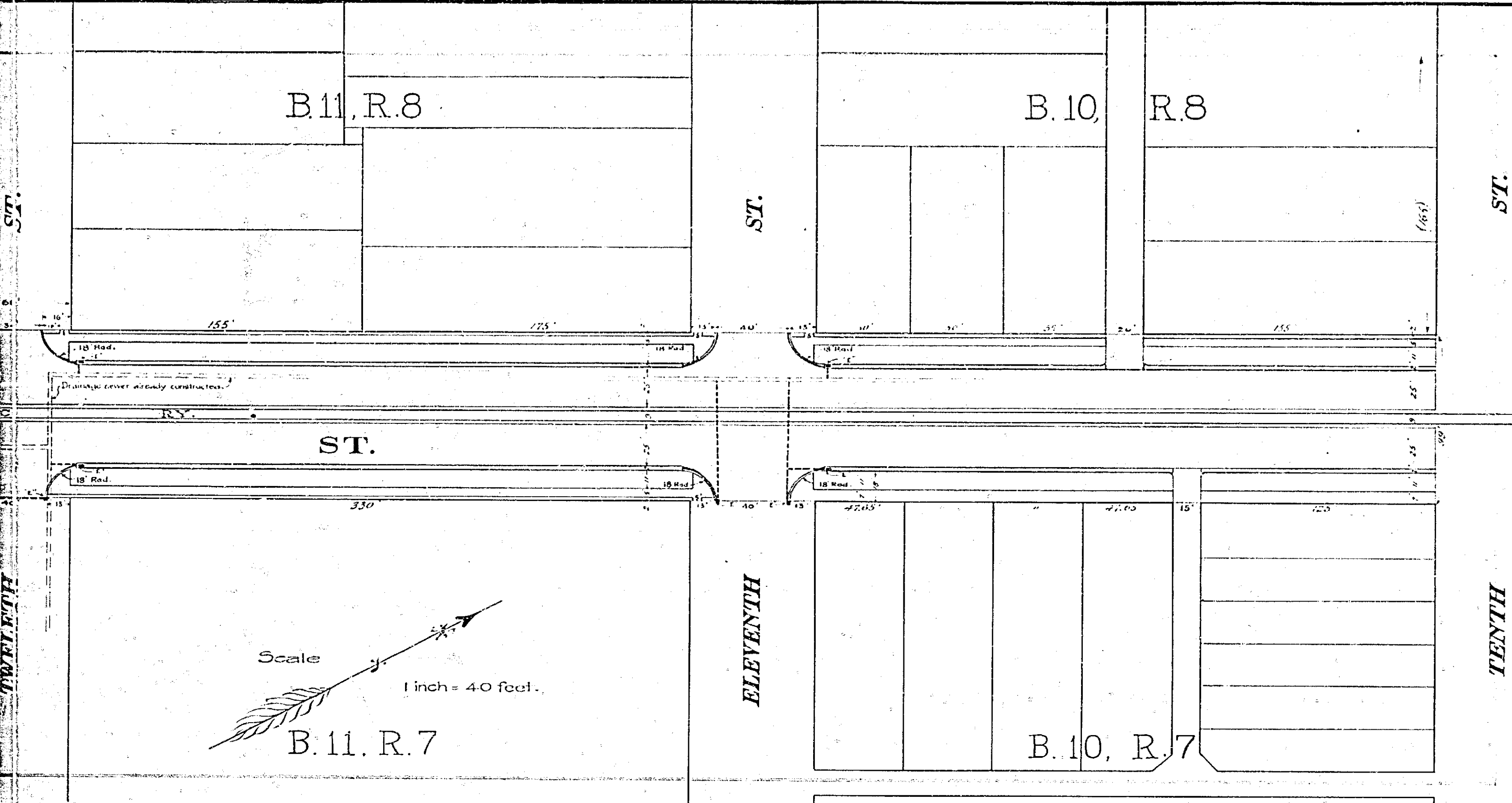

SCALE
In. Hor. = 50 ft.
In. Ver. = 4 ft.