

8.5"

1"

1"

12"

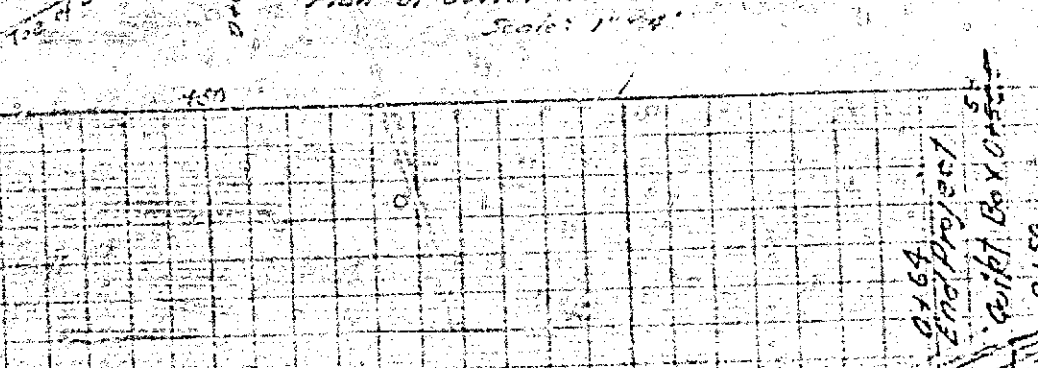
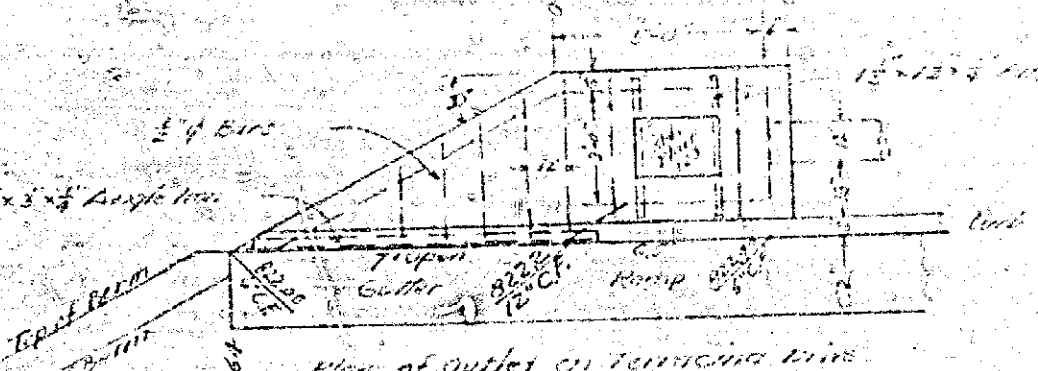
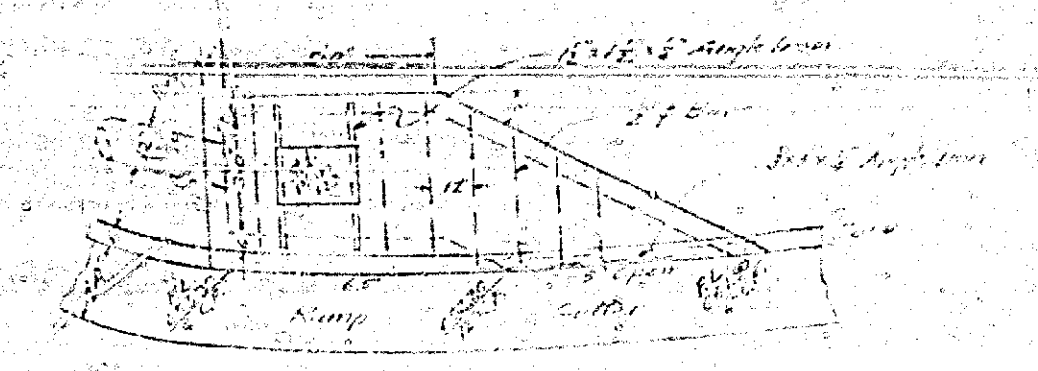

AT STANFORD ENGINEERING
CLARENCE W. THORNTON
1200 UNIVERSITY AVENUE
BERKELEY, CALIF.

CLARENCE W. THORNTON
1200 UNIVERSITY AVENUE
BERKELEY, CALIF.

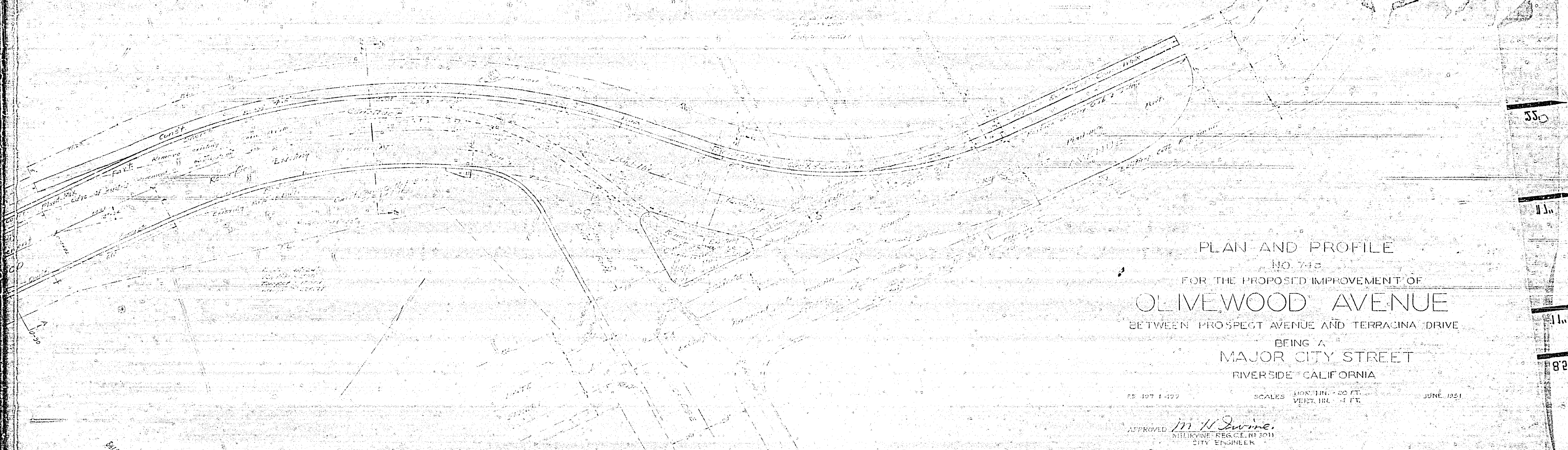

PLAN AND PROFILE
 NO. 748
 FOR THE PROPOSED IMPROVEMENT OF
OLIVEWOOD AVENUE
 BETWEEN PROSPECT AVENUE AND TERRACINA DRIVE
 BEING A
 MAJOR CITY STREET
 RIVERSIDE, CALIFORNIA

SCALE: HOR. 1" = 20 FT. VERT. 1" = 4 FT. JUN 1951

APPROVED *M. H. Swine*
 RIVERSIDE REG. CE. NO. 2011
 CITY ENGINEER

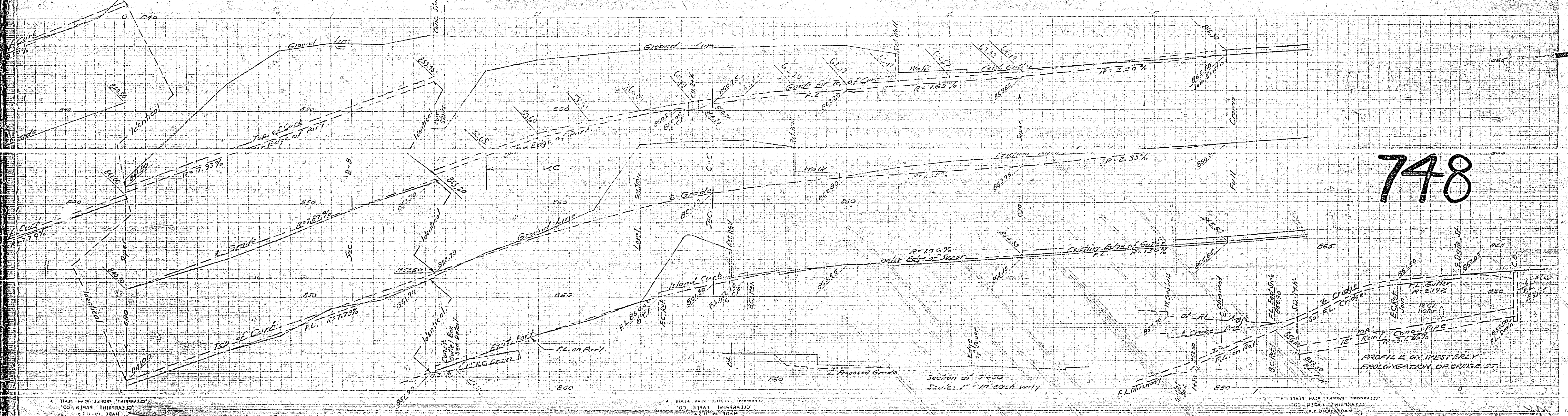

748

SECTION OF 7+50 SCALE: 1" = 10' EACH WAY

550

11.1

11.1

82.1

82.1

82.1

82.8

11.1

11.1

55

22"

17"

11"

8.5"

8.5"

11"

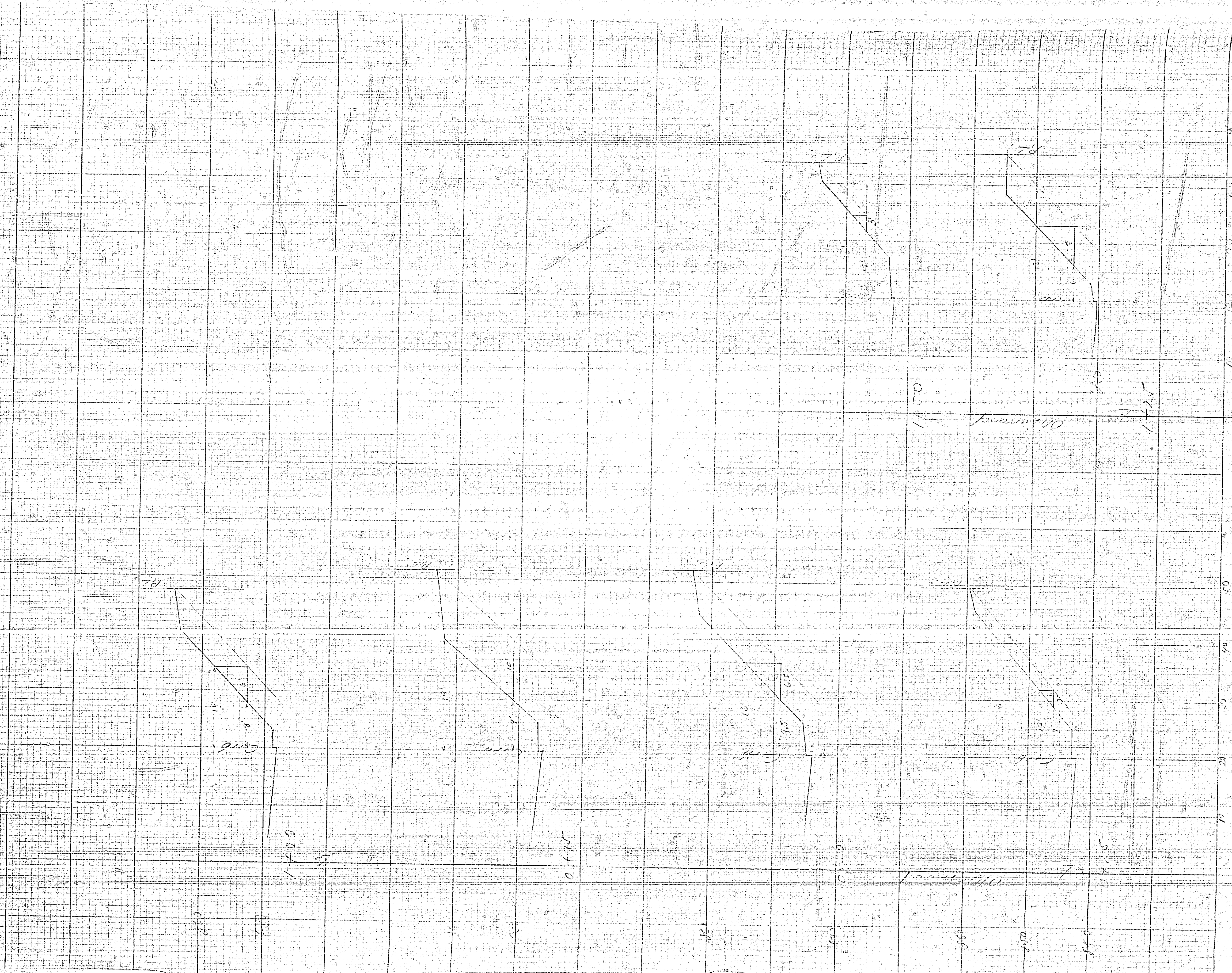

748

Michigan Ave. East side - So. of Bridge

Scale: 1" = 10' E & W

N.B. 511-53

55"

11"

11"

8.2"