

34"

22"

17"

11"

8.5"

8.5"

11"

17"

22"

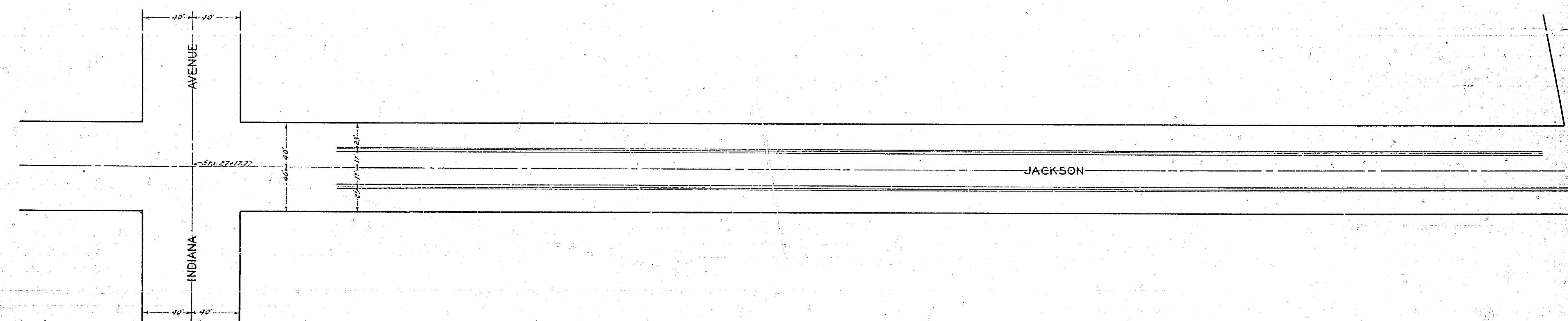
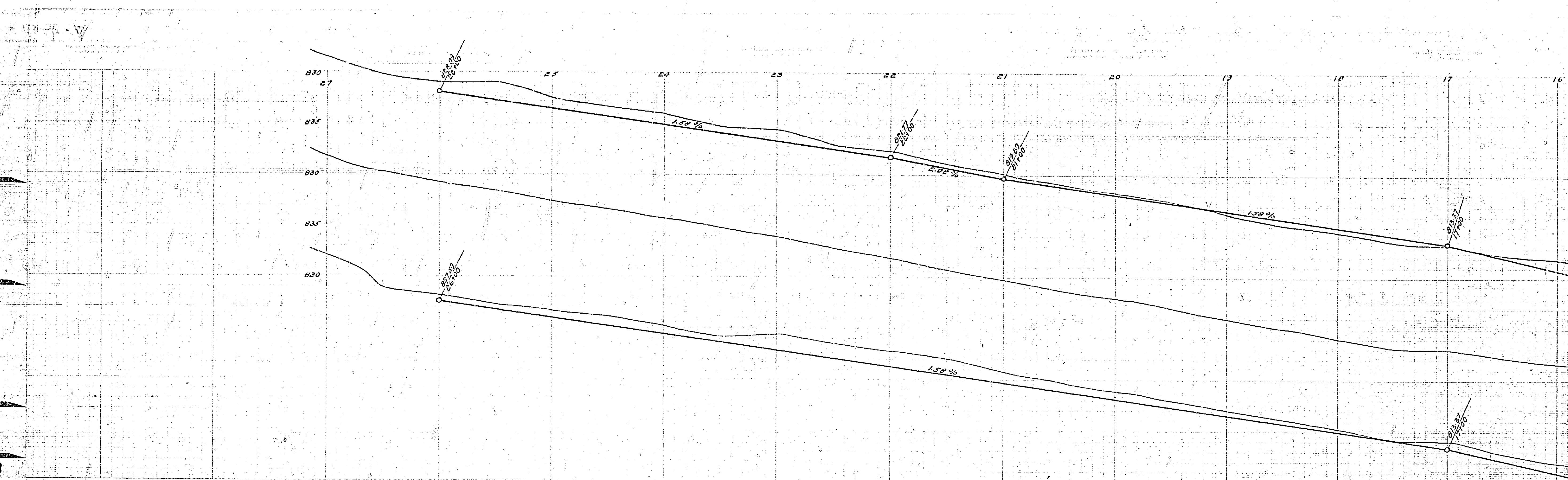

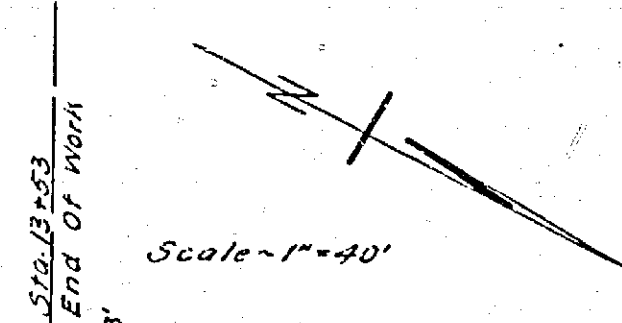
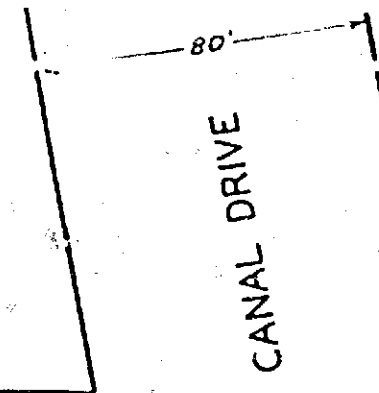
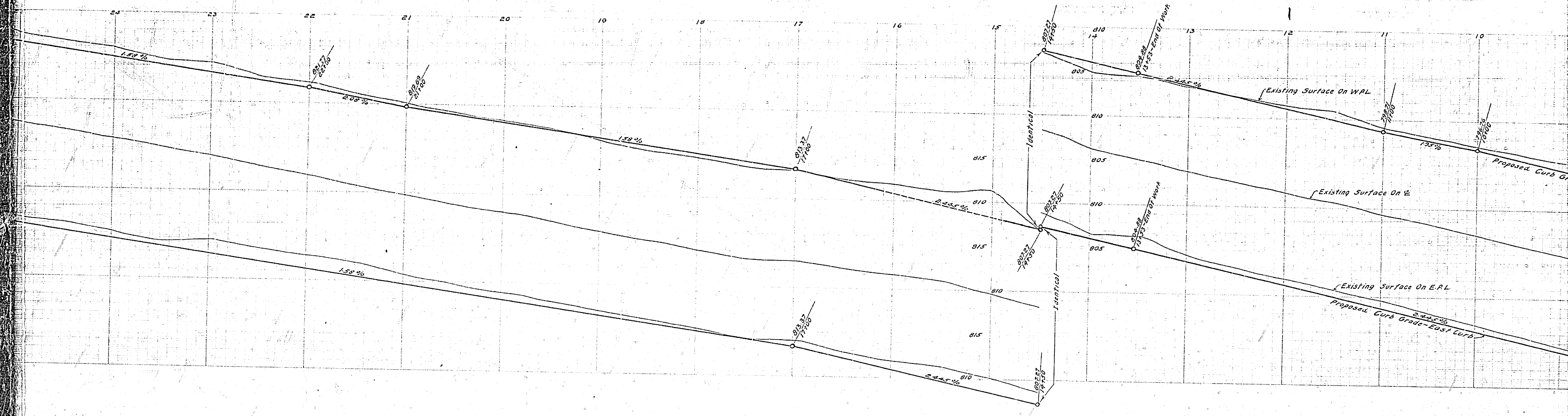

JACKSON

End of Work
E.P.L.

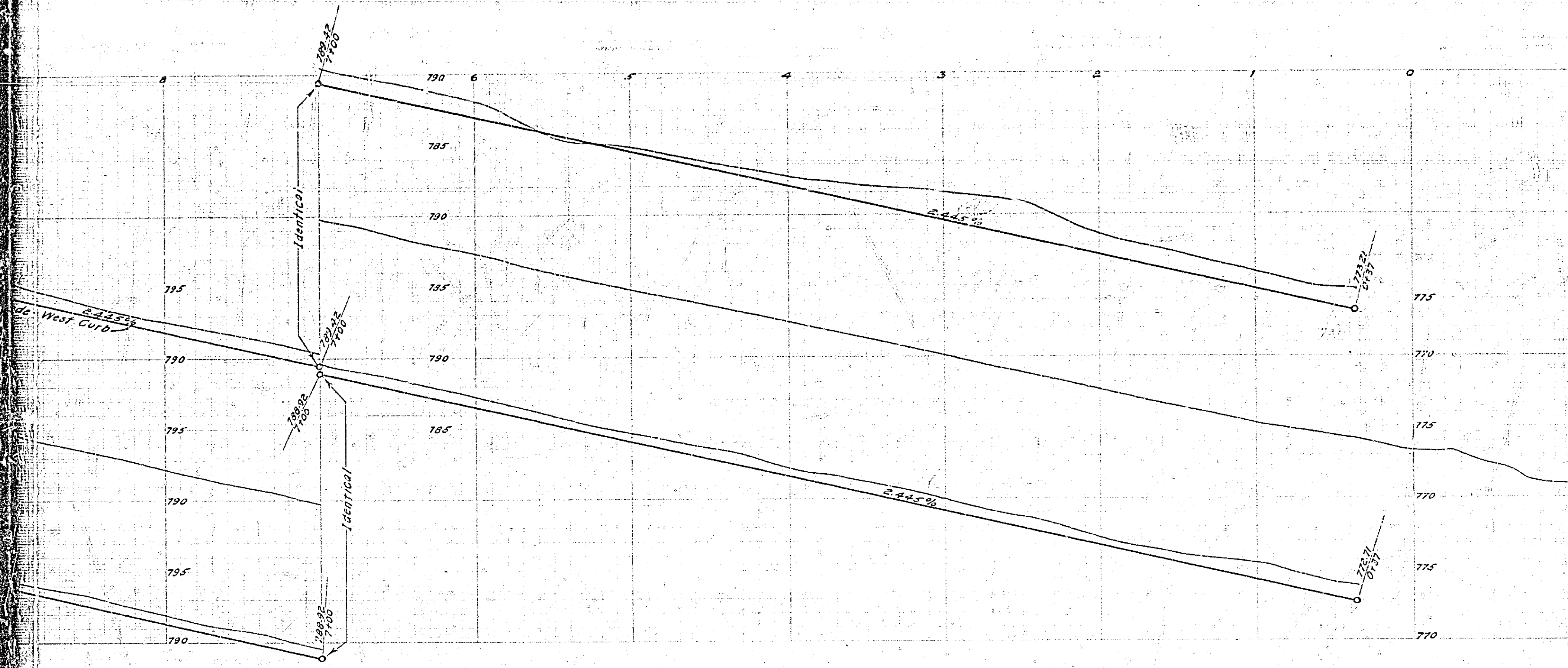

PLAN AND PROFILE
 OF
JACKSON STREET
 BETWEEN
 MAGNOLIA AVENUE AND INDIANA AVENUE
 SHOWING
 CURB GRADES AND DRAINAGE STRUCTURES
 ENGINEERING DEP'T. CITY OF RIVERSIDE
 FIELD BOOKS
 SURVEY BOOK 232
 TOPOGRAPHY BOOK 232
 LEVELS BOOK 241
 MAY 1931

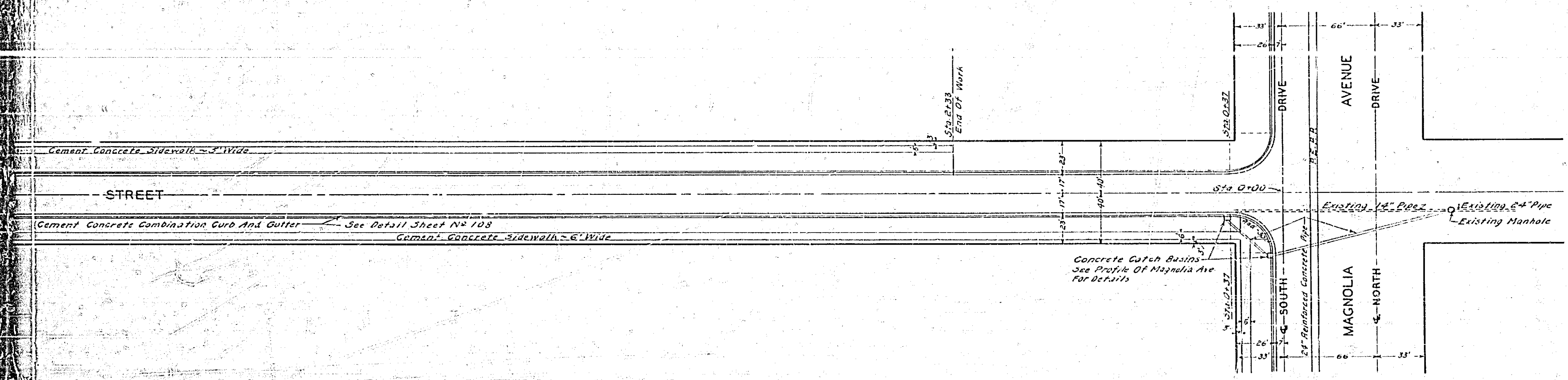

754-A