

# PLANS AND PROFILES OF THE PROPOSED STREET IMPROVEMENT OF TAFT STREET

ENGINEERING DEPT. - CITY OF RIVERSIDE JUNE 1934

FIELD BOOK 290 PG. 17

ELEVATIONS SHOWN HEREON ARE U.S.G.S.  
DATUM WHICH IS THE OFFICIAL CITY DATUM  
PLANE AS ESTABLISHED BY ORD. NO. 551 N.S.

Constructed by Street Dept. <sup>Amir</sup> 1934. WPA. Labor.

ADOPTED AND APPROVED BY THE MAYOR  
AND COUNCIL OF THE CITY OF RIVERSIDE  
THIS 24TH DAY OF JULY 1934

*Robert Graves*  
CITY CLERK - CITY OF RIVERSIDE

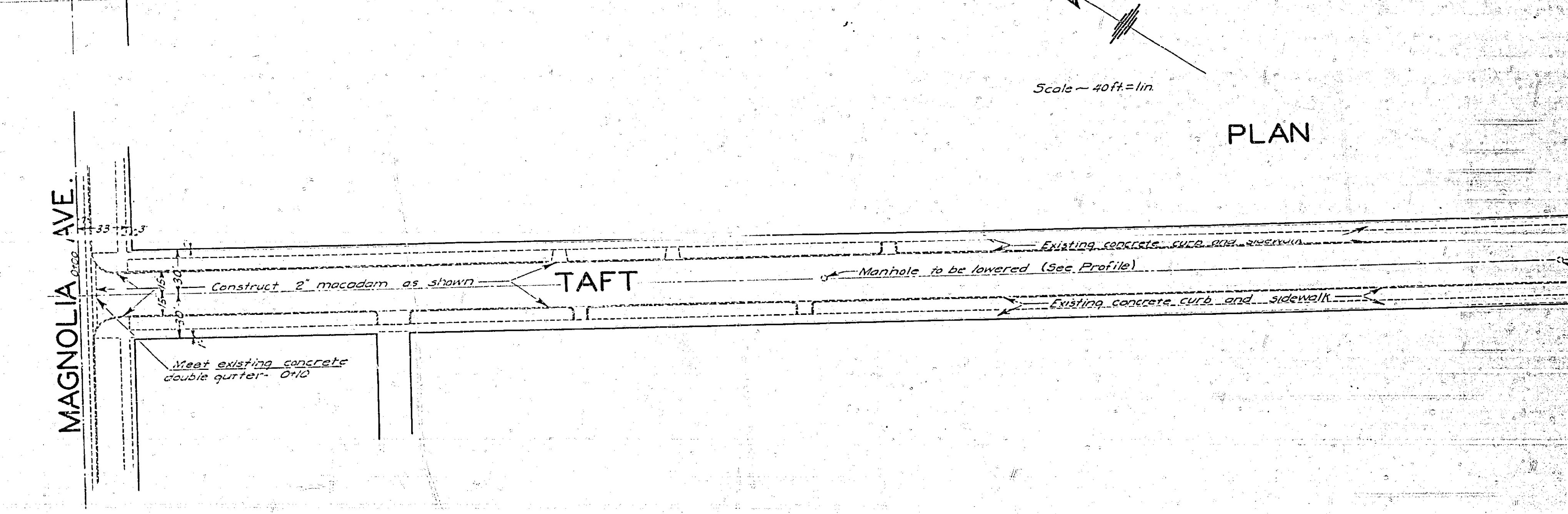
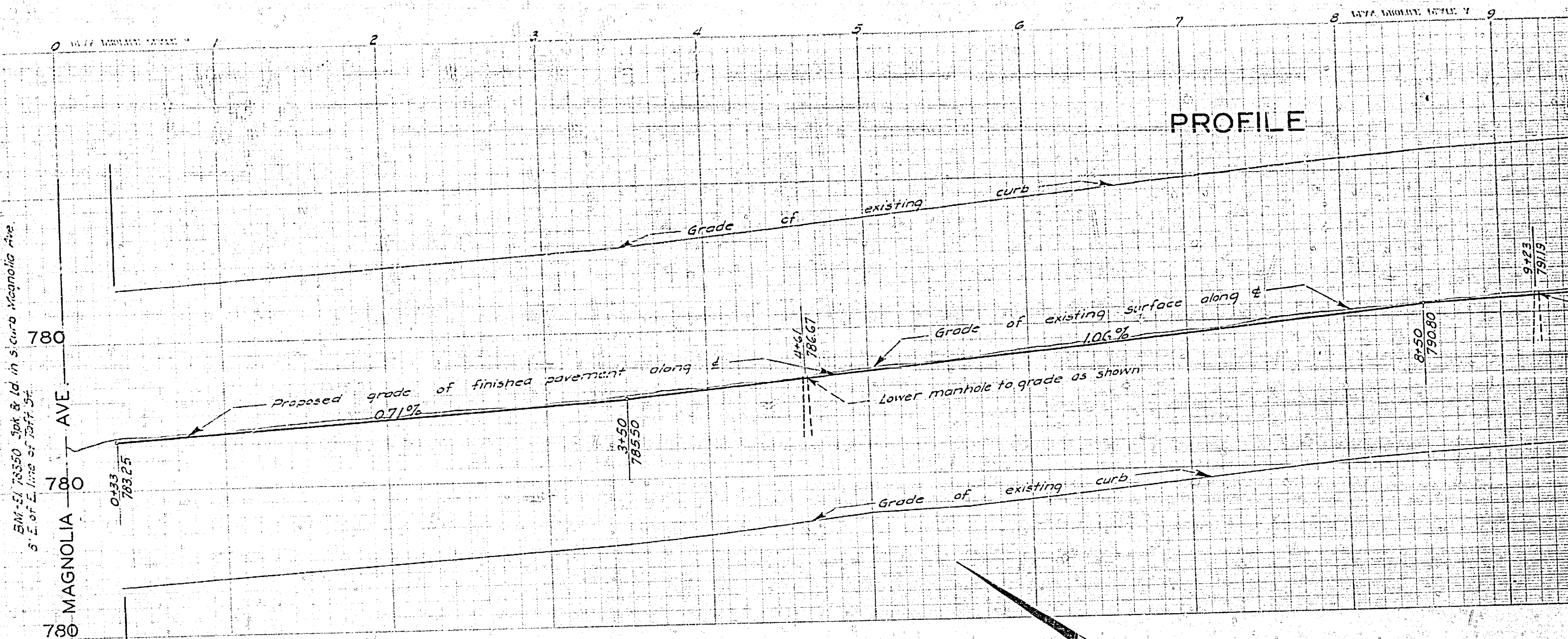

B.M. 51 78550 Spot & Id in Sierra Magnolia Ave  
S.E. of E. Line of 134th St

MAGNOLIA AVE.

TAFT

PROFILE

PLAN

Scale - 40ft = 1in

55

11

11

82

28

11

21

55

607

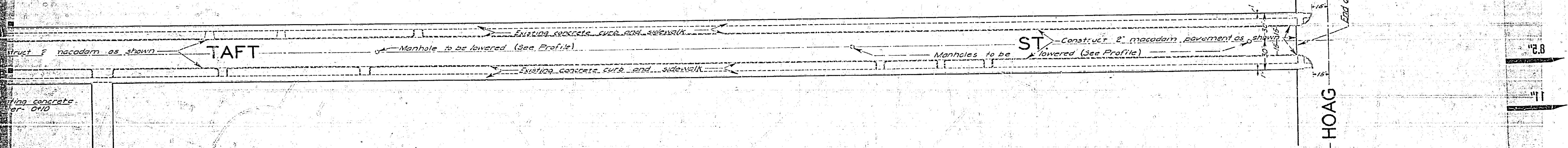
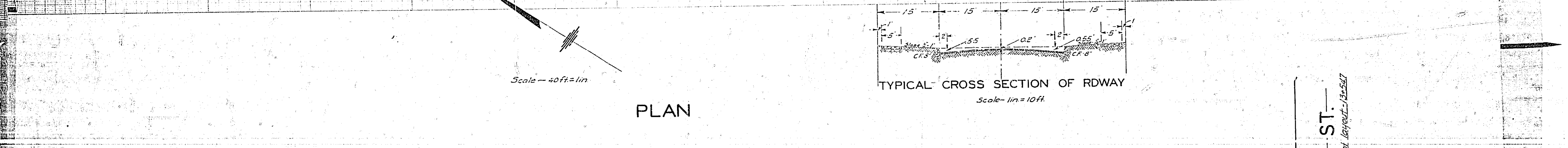
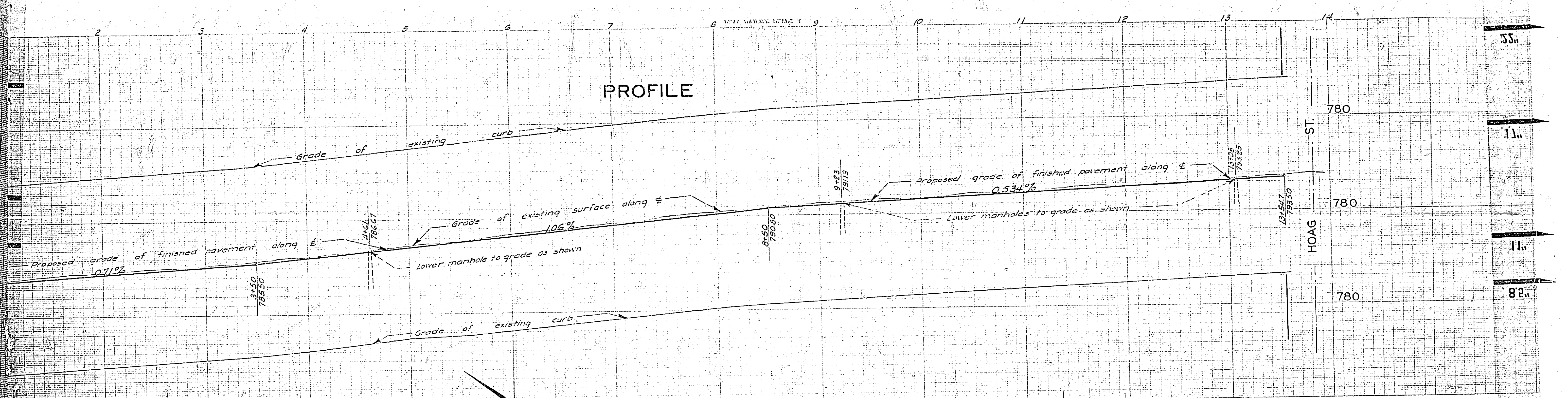

755

55.0  
11.0  
11.0  
82.0  
8.8  
11.0  
11.0  
55.0