

PLAN NO. 757
FOR THE PROPOSED IMPROVEMENT OF
VAN BUREN STREET
BETWEEN HAYES STREET & WESTERLY CITY LIMITS
BEING A
MAJOR CITY STREET
RIVERSIDE, CALIFORNIA

APPROVED *M. H. Irvine*
M.H. IRVINE REG. CE. NO. 3011
CITY ENGINEER

F.B. 388/12-28 TOPO.

757

2/15/52

VAN BUREN ST.
 EAST SIDE DRIVE TO CITY LIGHTS
 SHOWING LOCATION OF STABLES
 P & BBE/16-28
 SCALE 1"=50'

NOTE IN THIS STRETCH OFFSET PAVING THIS

LEAVE EVERYTHING THIS SIDE
 ON THIS SIDE RELOCATE 10 POLES NOT FURTHER THAN 8 FEET FROM 12
 AND REMOVE ONE TREE AS NOTED

PROPOSED EDGE
 OF NEW PAVING
 SEE NOTE ABOVE

NOTE IN THIS STRETCH OFFSET PAVING THIS

LEAVE EVERYTHING THIS SIDE
 ON THIS SIDE RELOCATE ALL POLES (11)
 NOT FURTHER THAN 8 FEET FROM 12
 AND REMOVE ALL TREES (10)

757

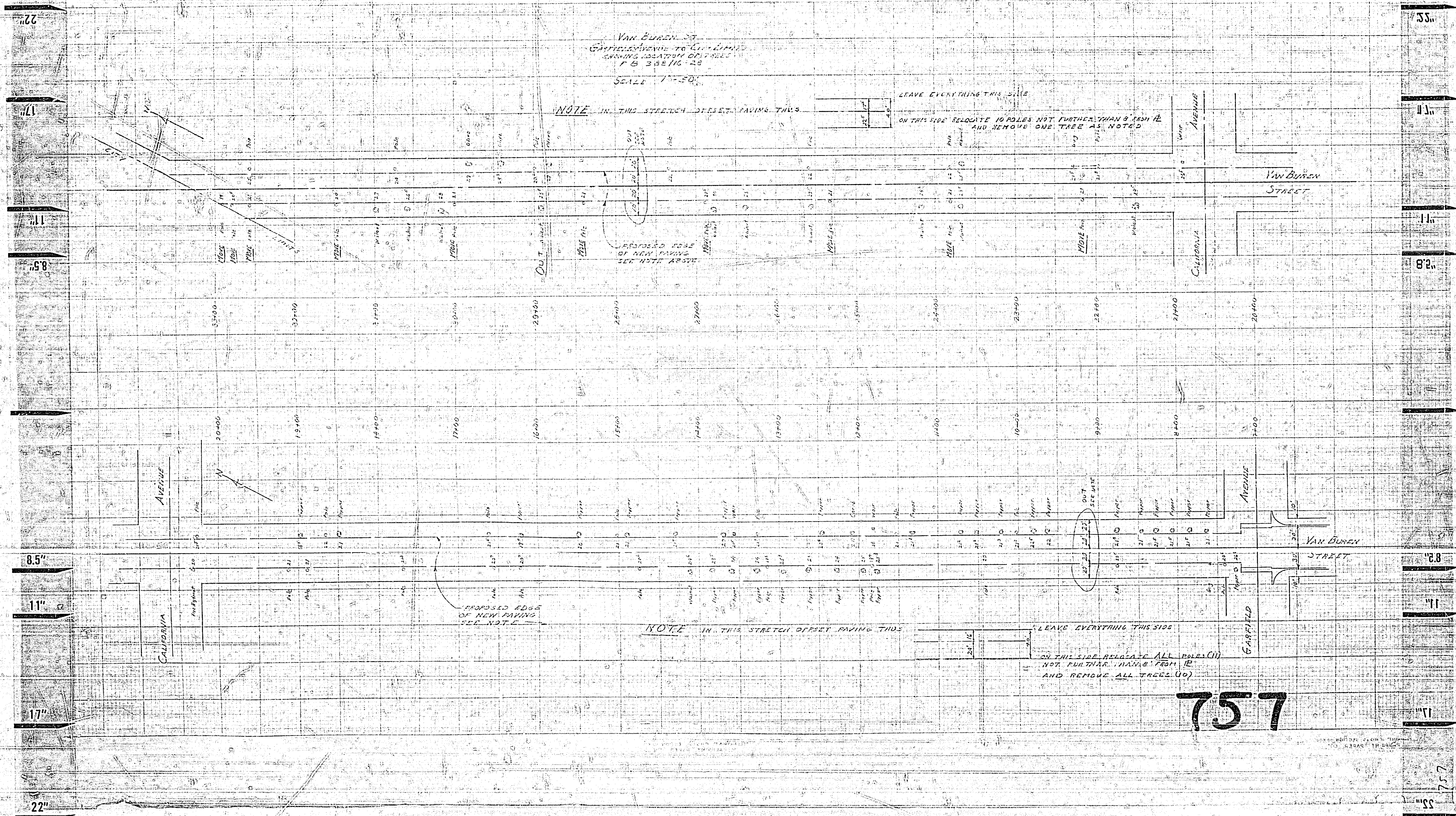

757

757

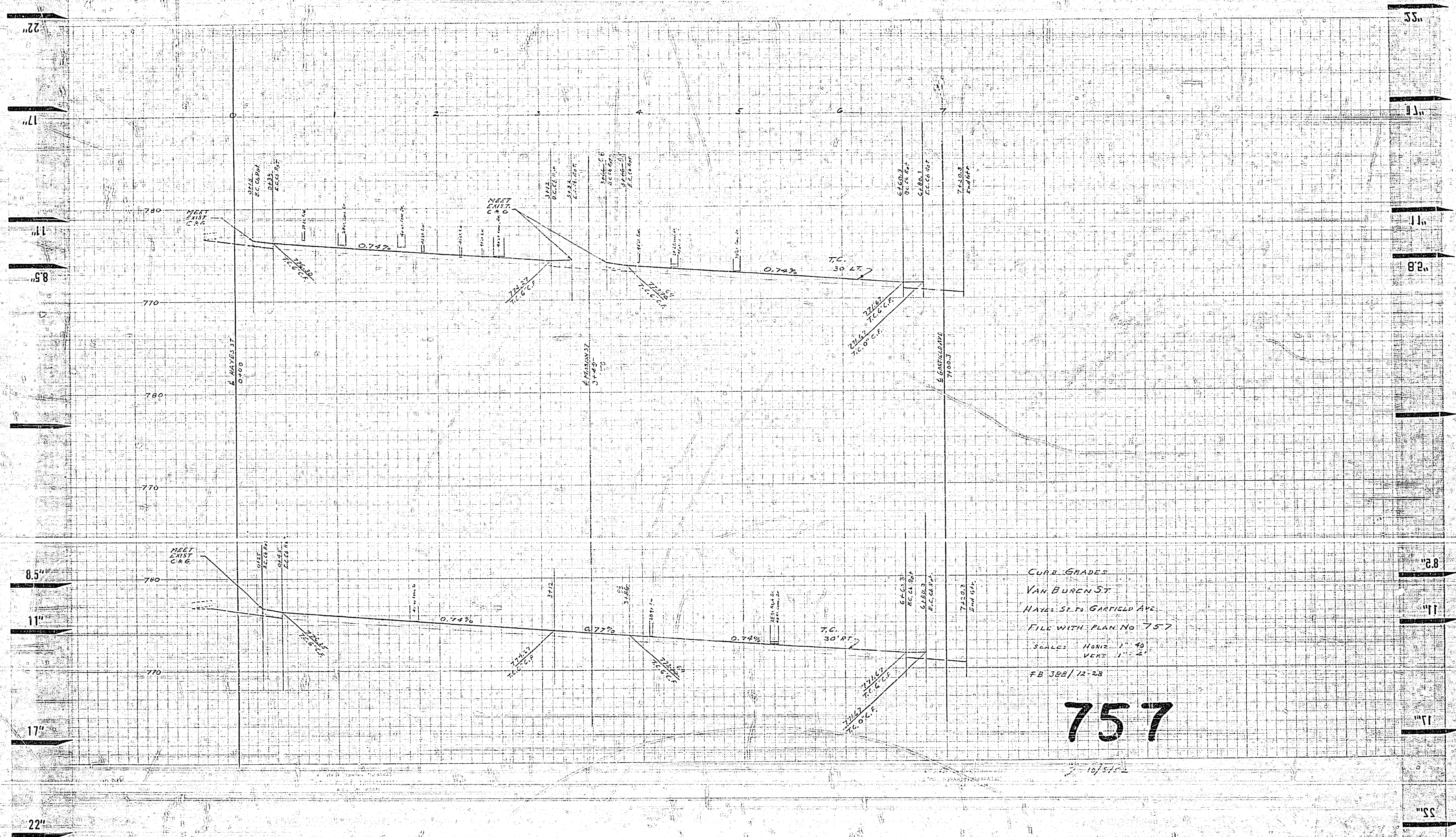

CURB GRADES
 VAN BUREN ST
 HAYES ST. TO GARFIELD AVE.
 FILE WITH PLAN NO 757
 SCALES HORIZ. 1" = 40'
 VERT. 1" = 2'
 FB 388/12-28

757

10/5/52