

SCENIC

HOME

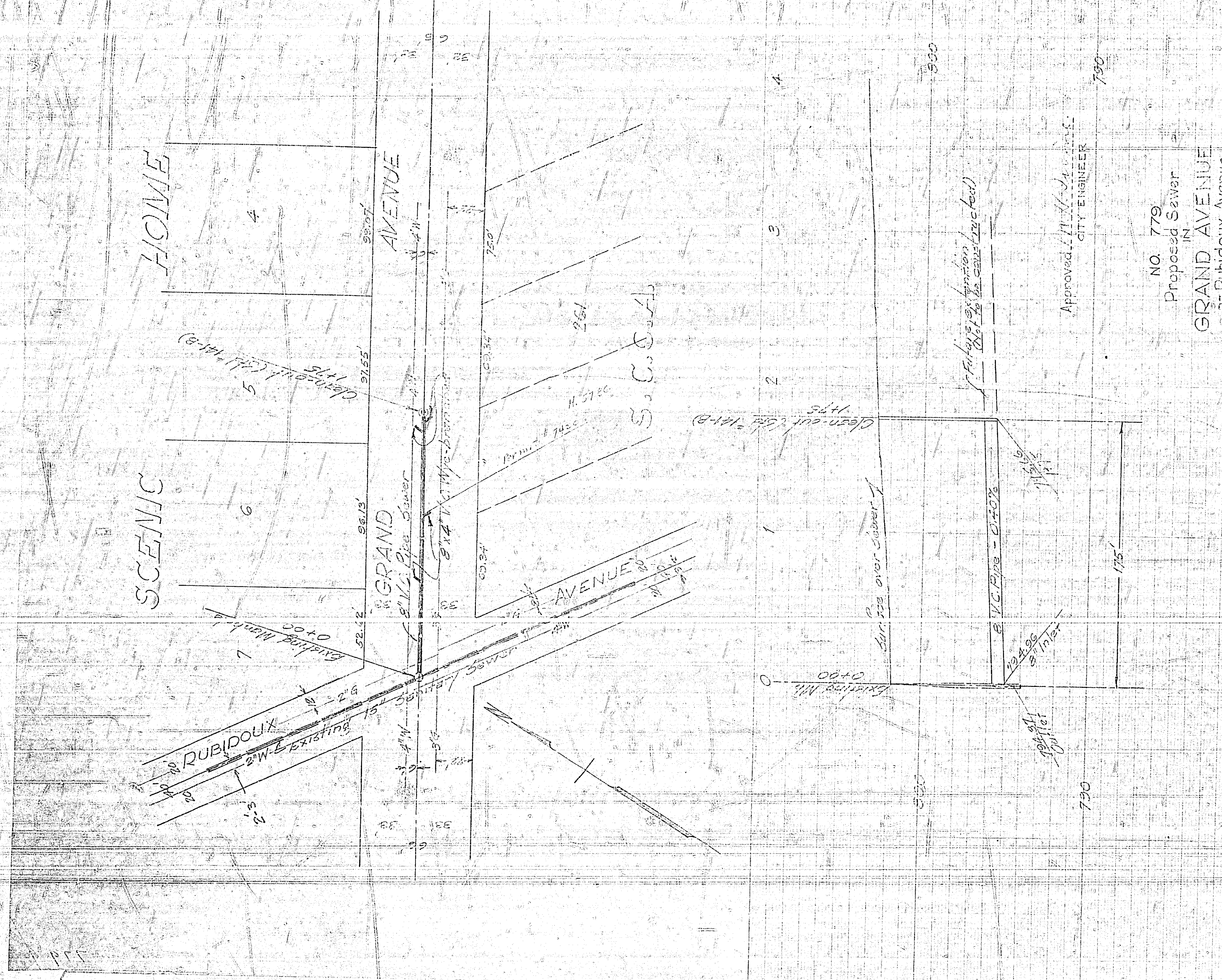

- 175 - 8" V.C. Pipe
- 4 - 8x4" V.C. Wye-branched
- 1 - C.I. Cleanout frame & cover

NO. 779
 Proposed Sewer
 IN
 GRAND AVENUE
 at Rubidoux Avenue

(To be constructed as a part
 of a future line serving Grand
 Ave., Charlotte Way & Bandini
 Ave.)

Approved: *W. W. Sullivan*
 CITY ENGINEER

Scale: 1" = 40'

779