

**PROFILE**

**PLAN AND PROFILE**  
 OF THE PROPOSED STREET IMPROVEMENT OF  
**ORANGE STREET**  
 BETWEEN FIRST ST. AND RUSSELL ST.

FIELD BOOK 248 PAGES 34-48  
 CITY (U. S. G. S.) DATUM PLANE  
 ENG. DEPT. RIVERSIDE CALIF. 1934.  
 Constructed by Street Dept. WPA Labor

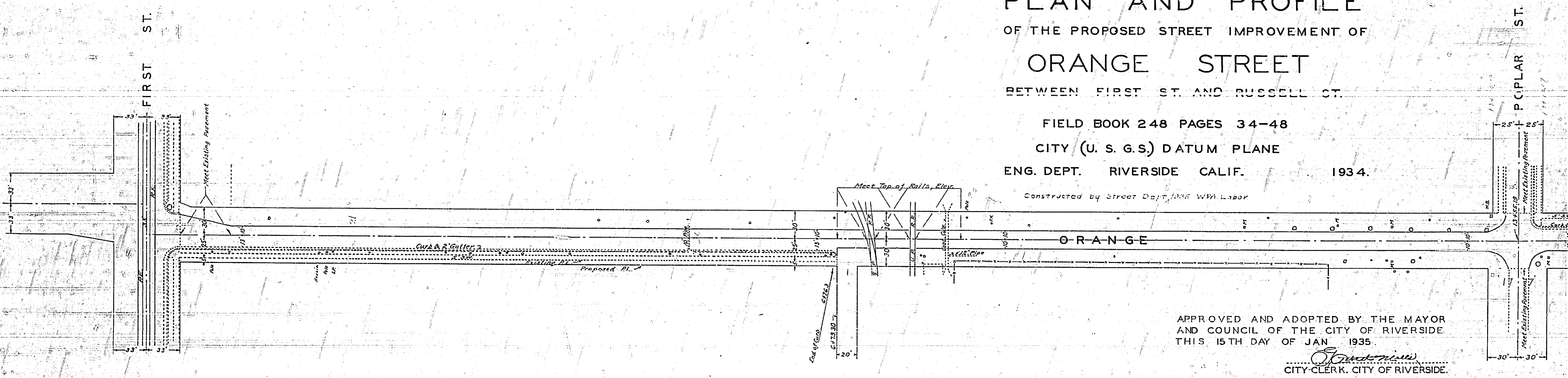

APPROVED AND ADOPTED BY THE MAYOR  
 AND COUNCIL OF THE CITY OF RIVERSIDE  
 THIS 15TH DAY OF JAN 1935.  
 [Signature]  
 CITY CLERK, CITY OF RIVERSIDE.



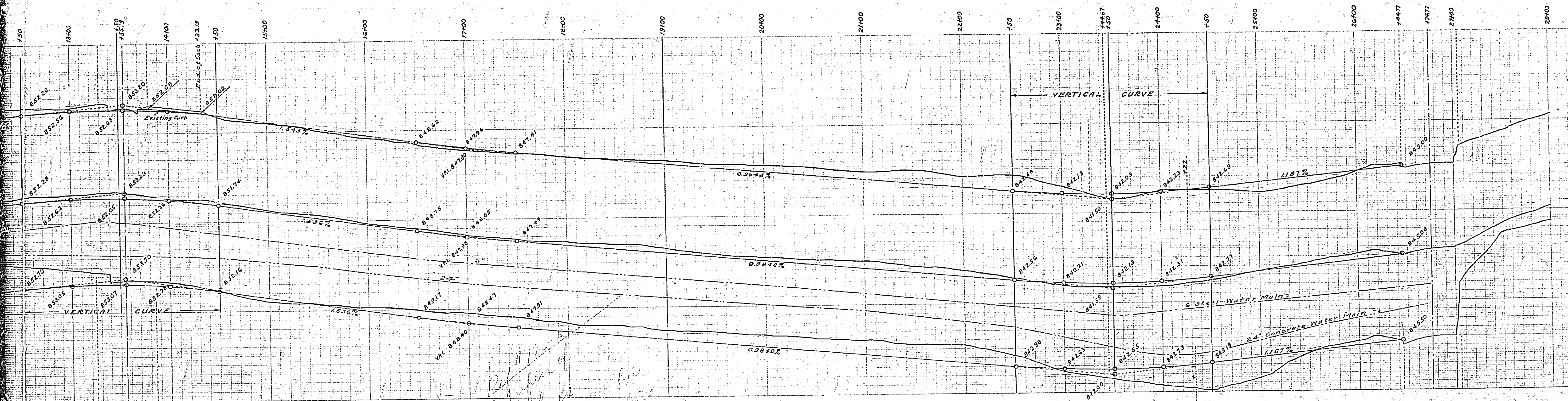

PLAN

SCALE: HOR. 1" = 40'  
VER. 1" = 4'

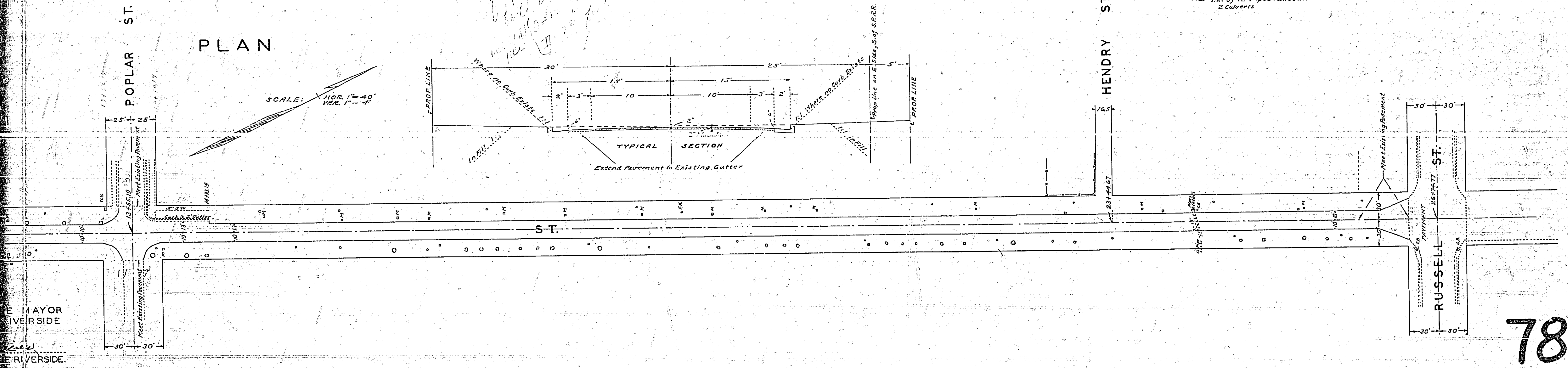
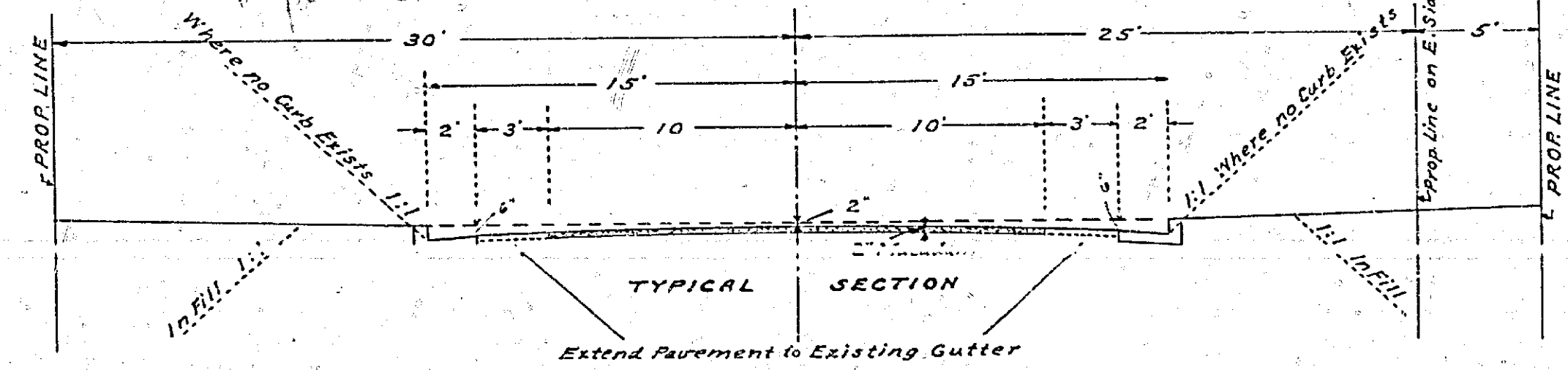

783