

Adopted by the Mayor and Common Council of the City of Riverside, this 11th day of September, 1923.
Attest, *W. J. Curry*
City Clerk

PROFILE OF ALLEY LINE NORTH OF EAST SIXTH ST.
NORTH OF EAST SIXTH ST.

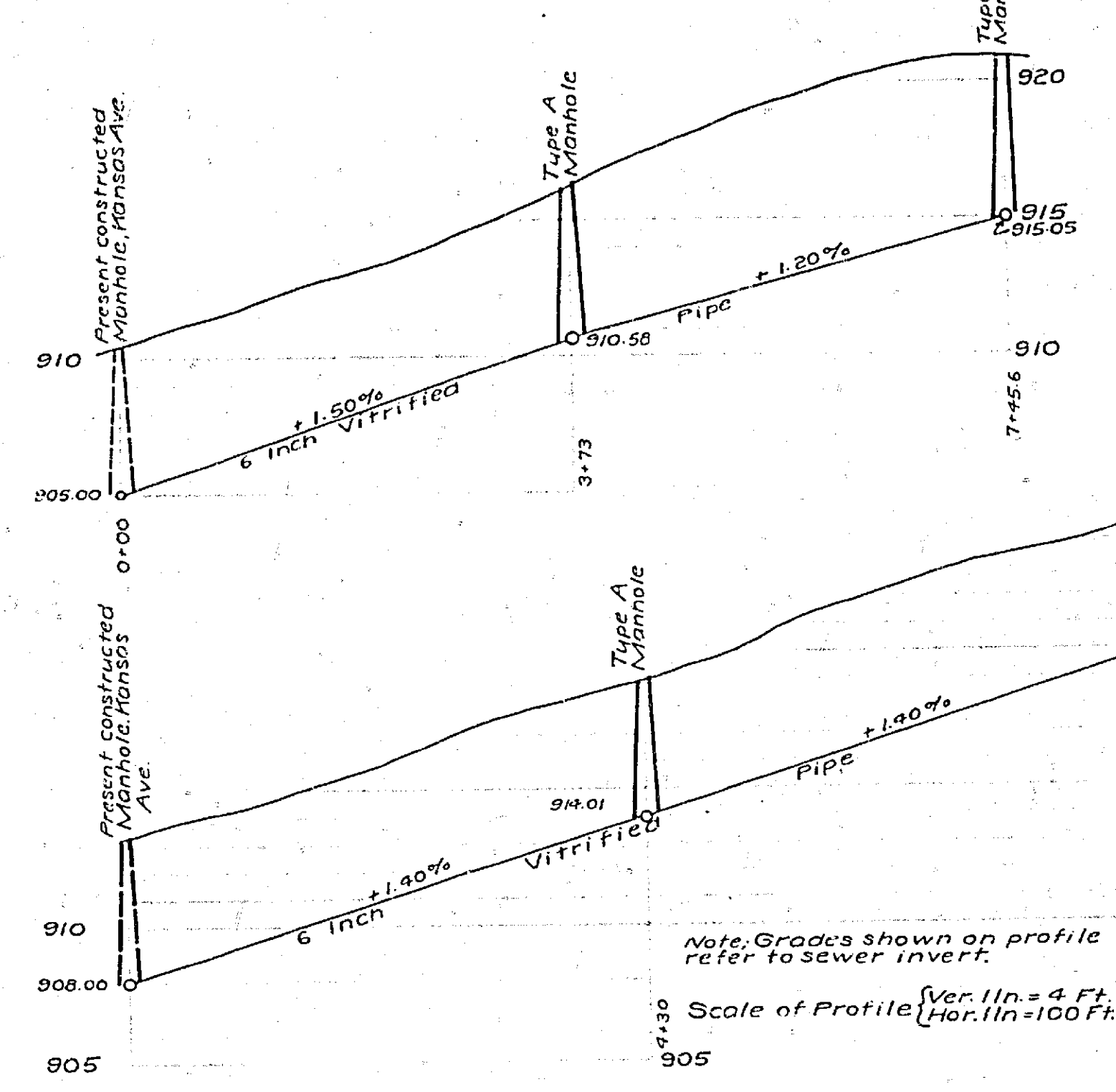

PROFILE OF ALLEY LINE SOUTH OF EAST SIXTH ST.



Note: Grades shown on profile refer to sewer invert.
Scale of Profile Ver. 1 in. = 4 Ft. Hor. 1 in. = 100 Ft.

MAP SHOWING SEWER TO BE CONSTRUCTED IN A PORTION OF MADISON SQUARE
LEE NAFZGAR, CITY ENGINEER
SEPTEMBER, 1923.

LEGEND
6 inch Vitrified sewer to be laid shown thus
4x6 Y-Branches shown thus
Type A Manholes shown thus
Sewer already constructed shown thus
Cleanouts shown thus
District benefited bounded by a yellow line, thus

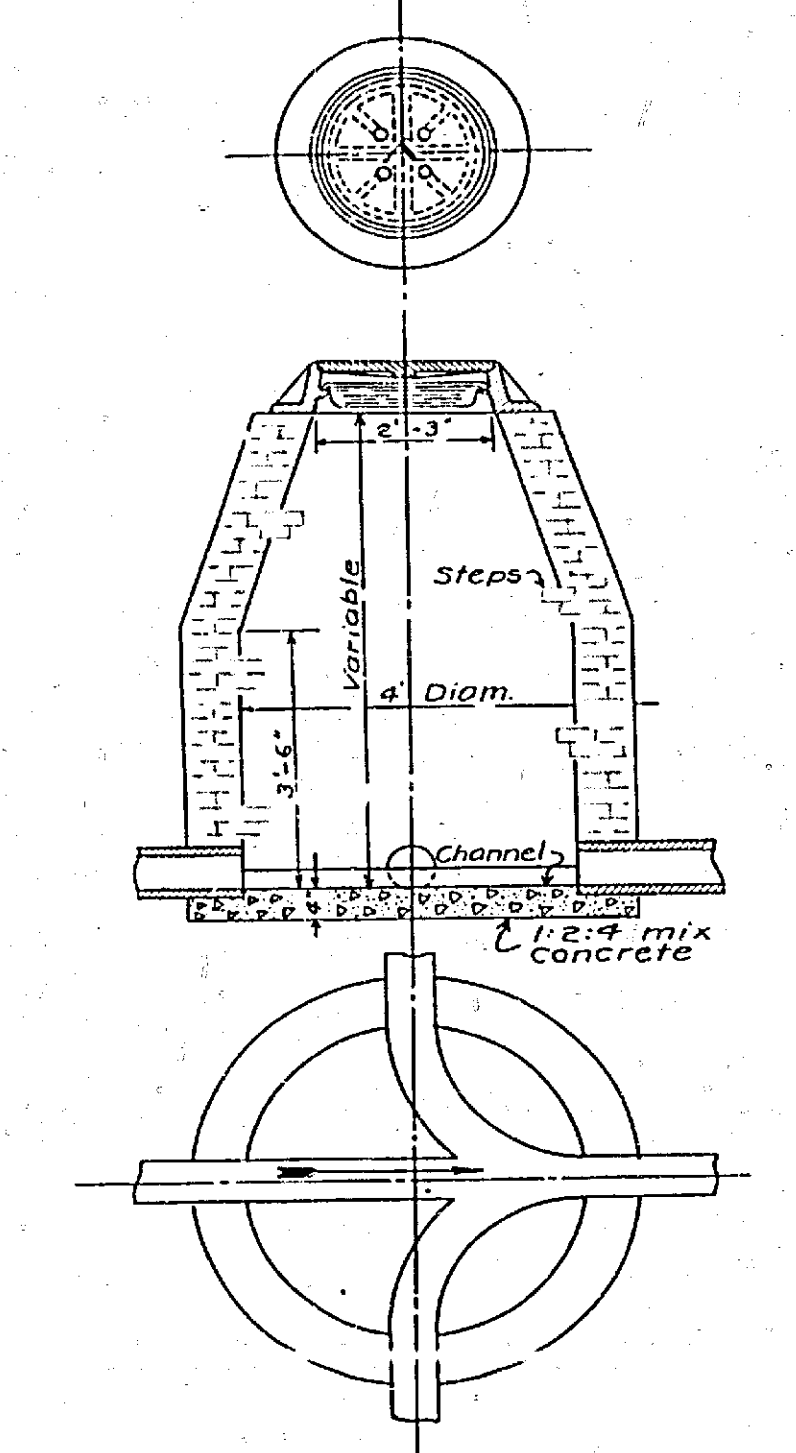
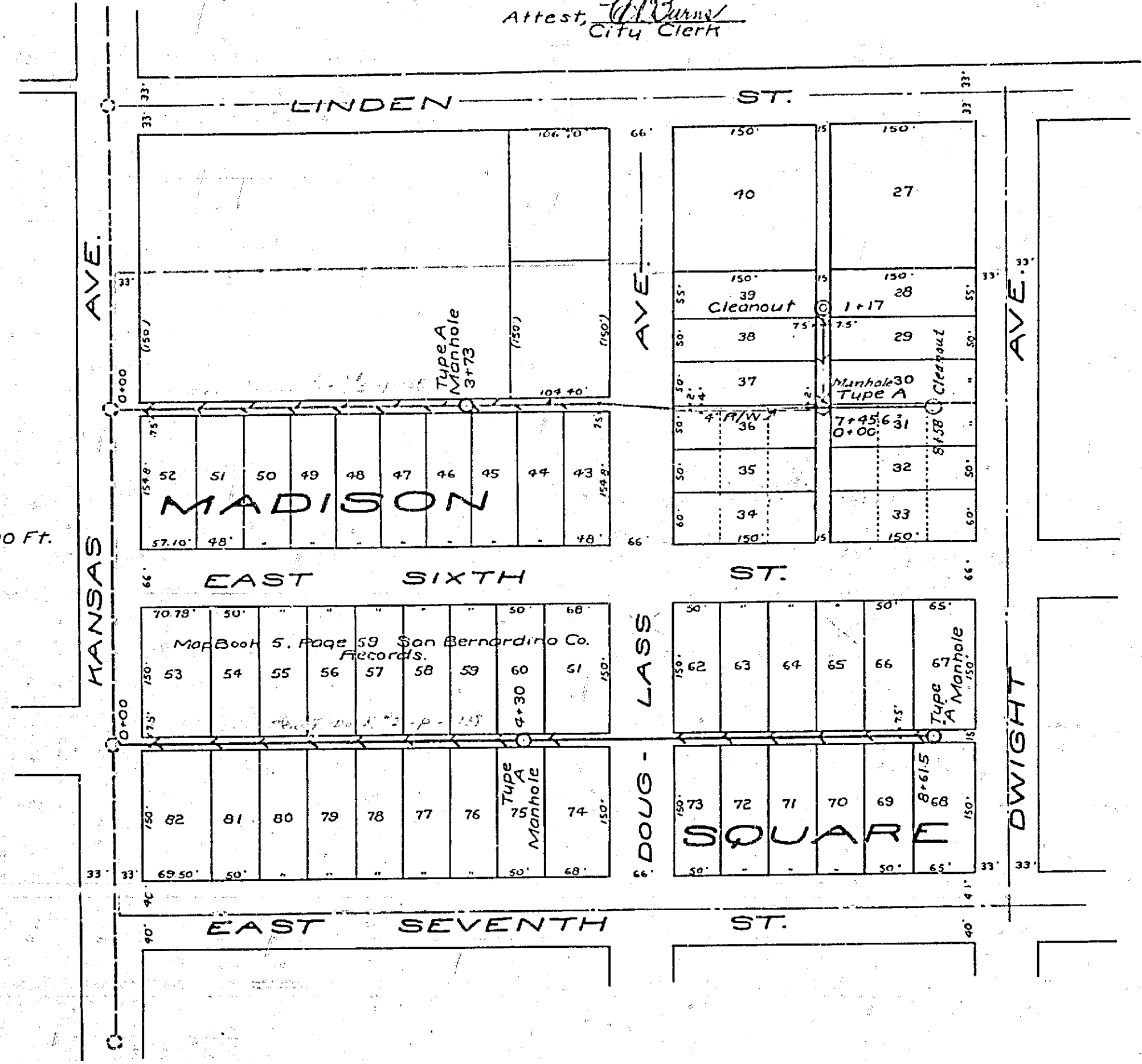

PLAN & SECTION OF TYPE A MANHOLE
Scale 1/2 in. = 1 Ft.

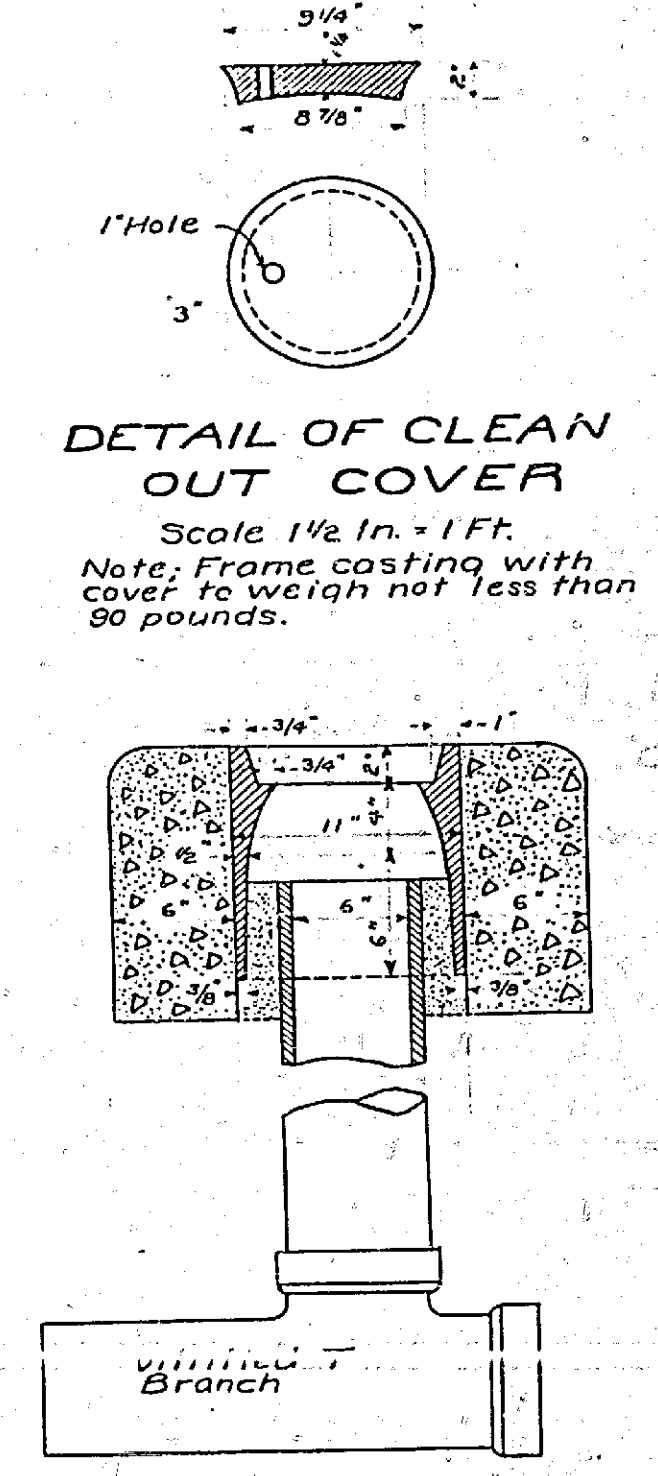

DETAIL OF CLEAN OUT COVER
Scale 1 1/2 in. = 1 Ft.
Note: Frame casting with cover to weigh not less than 50 pounds.

DETAIL OF CLEANOUT
Scale 1 1/2 in. = 1 Ft.

788