

MAP SHOWING IMPROVEMENTS TO BE MADE ON
TENTH STREET
 FROM VINE ST TO PARK AVE.
 LEE NATZGER CITY ENGINEER

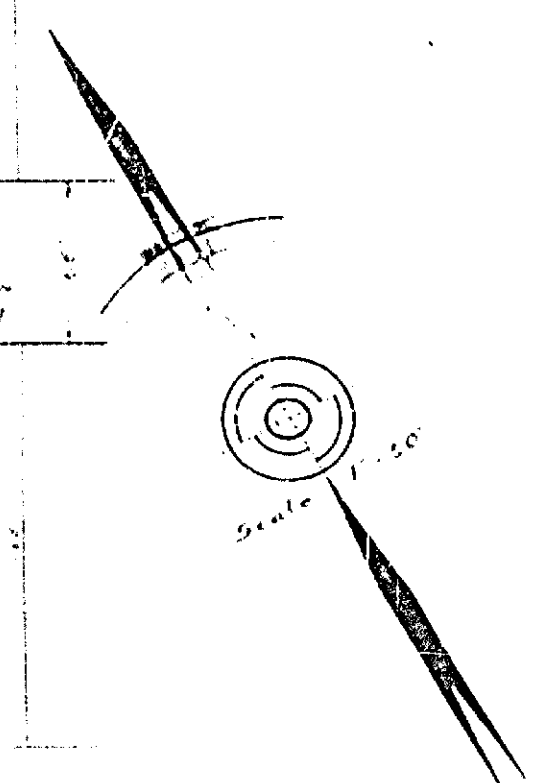
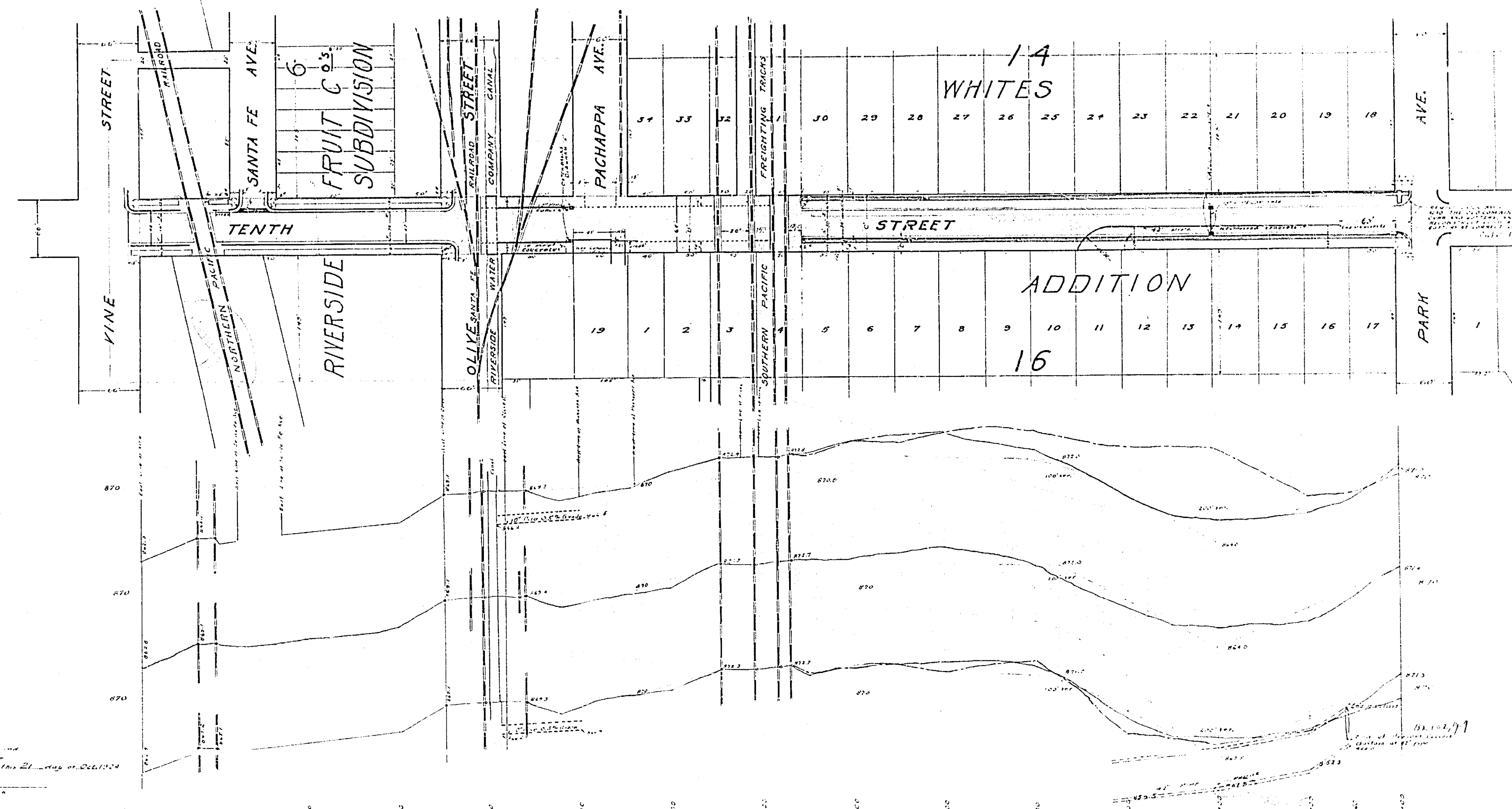

Attest to the above and
 Common Council of the
 City of Eugene on this 21 day of October
 1911
 City Clerk

PROFILE OF TENTH ST. FROM VINE TO PARK
 SCALE 1" = 10'

LEGEND
 Shows to be constructed upon this
 Computation Curve and gutter to be constructed upon this
 Curve to be constructed upon this
 Minimum Flap to be constructed upon this
 Catch Basin to be constructed upon this
 Drain Pipe to be constructed upon this
 Deflect to be from 3 feet down to where the
 Surface then constructed upon this
 Computation Curve and gutter then constructed upon this

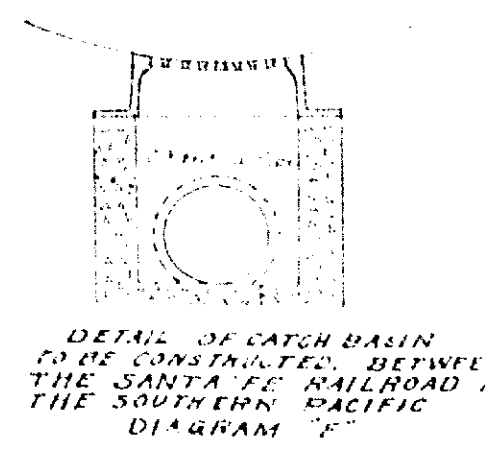
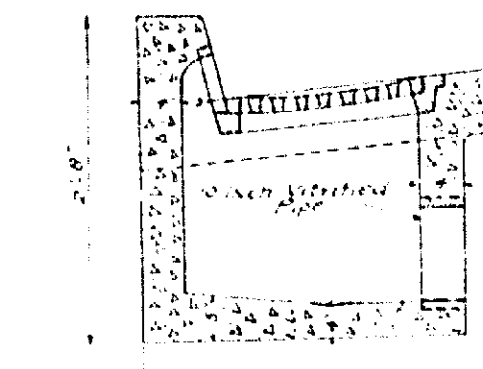

DIAGRAM "D"
 CROSS-SECTION OF CURB GUTTER & SIDEWALK ALONG SOUTHERLY SIDE BETWEEN PARK AVE. AND WEST LINE OF LOT 5, BLOCK 16, WHITES ADDITION.

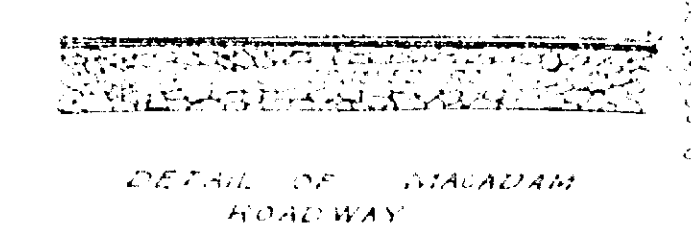

DIAGRAM "A"
 CROSS-SECTION OF GUTTER TO BE CONSTRUCTED ON TENTH STREET ACROSS SANTA FE AVENUE. CONCRETE TO BE OF THE SAME PROPORTION AS IN THE COMBINATION CURB AND GUTTER.



DIAGRAM "B"
 CROSS-SECTION OF ROAD TO BE CONSTRUCTED FROM OLIVE TO THE EAST SIDE OF LOT 4 BLOCK 16 WHITES ADDITION.

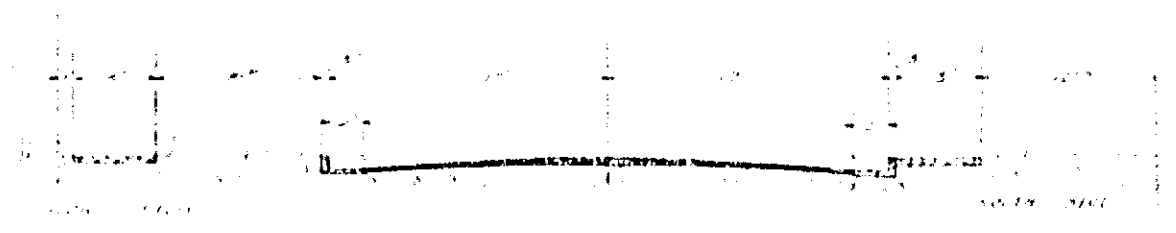

DIAGRAM "C"
 CROSS-SECTION OF ROAD TO BE CONSTRUCTED FROM WEST END OF LOT 5 BLOCK 16 WHITES ADDITION



809