

MAP SHOWING IMPROVEMENTS TO BE MADE ON ELMWOOD COURT

LEE NAFZAAR CITY ENGINEER

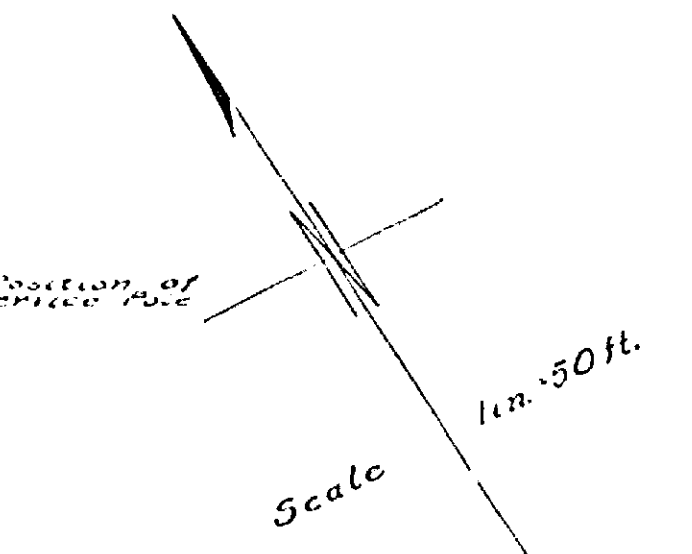
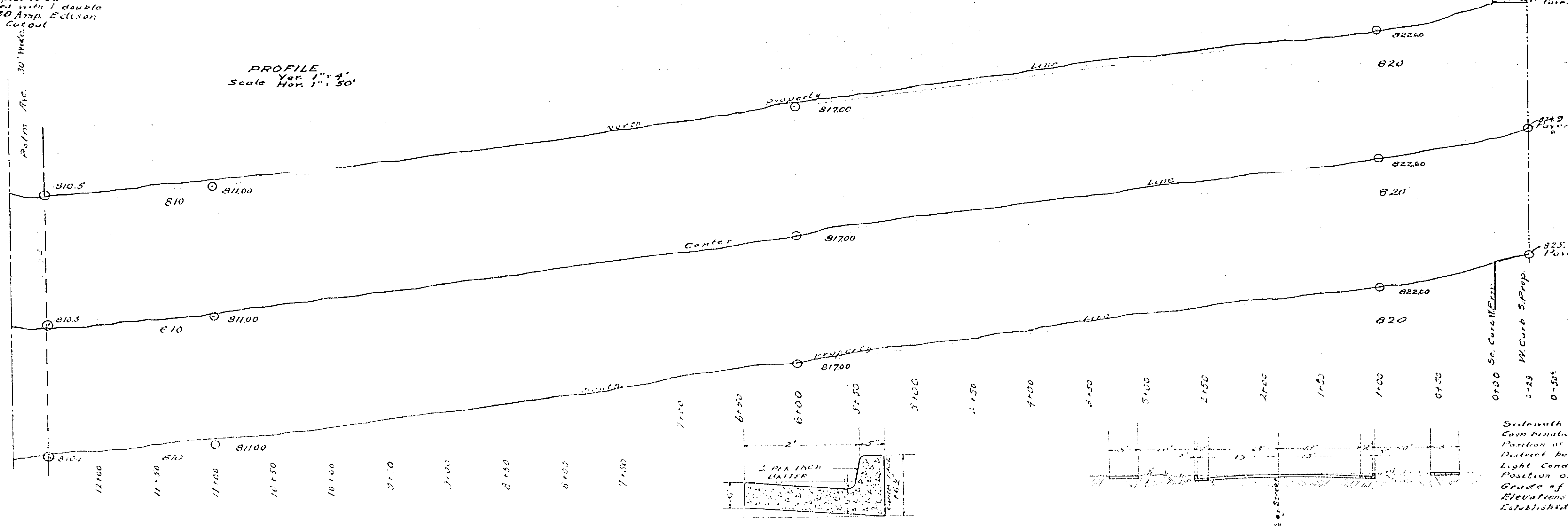
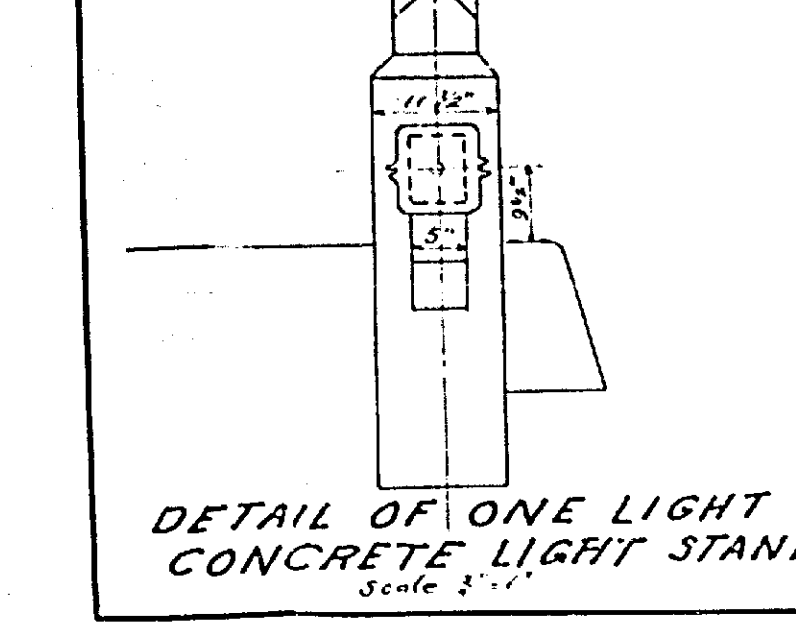
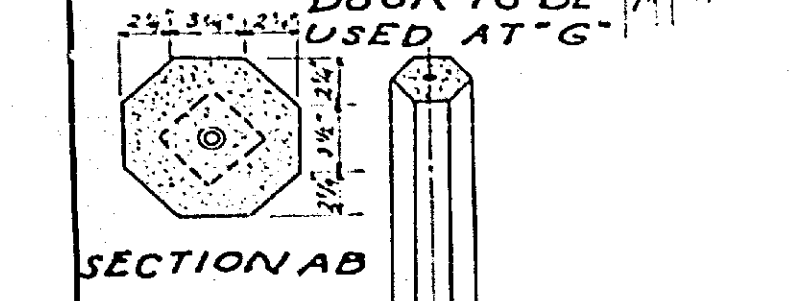
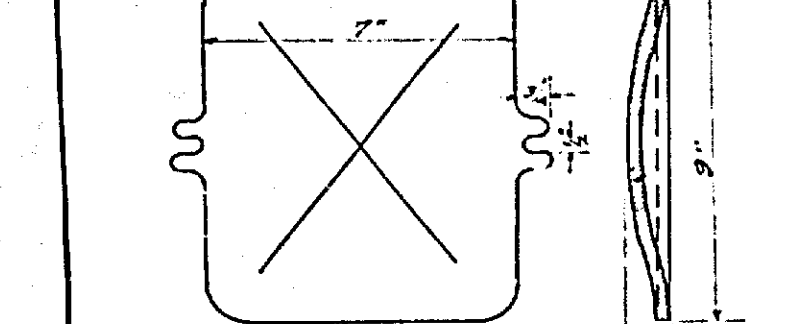
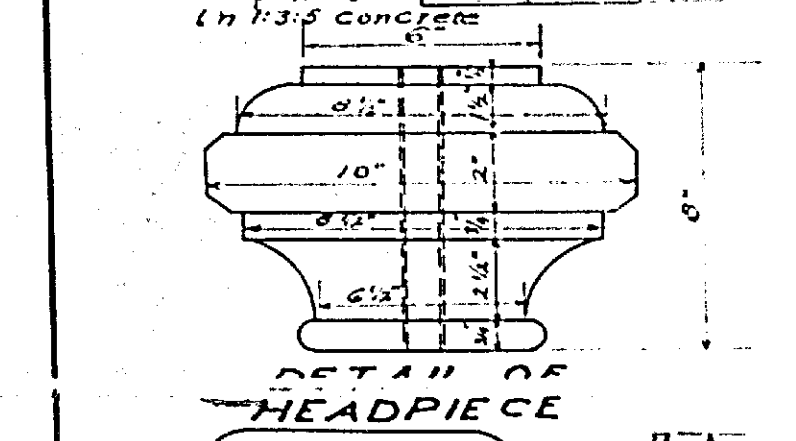
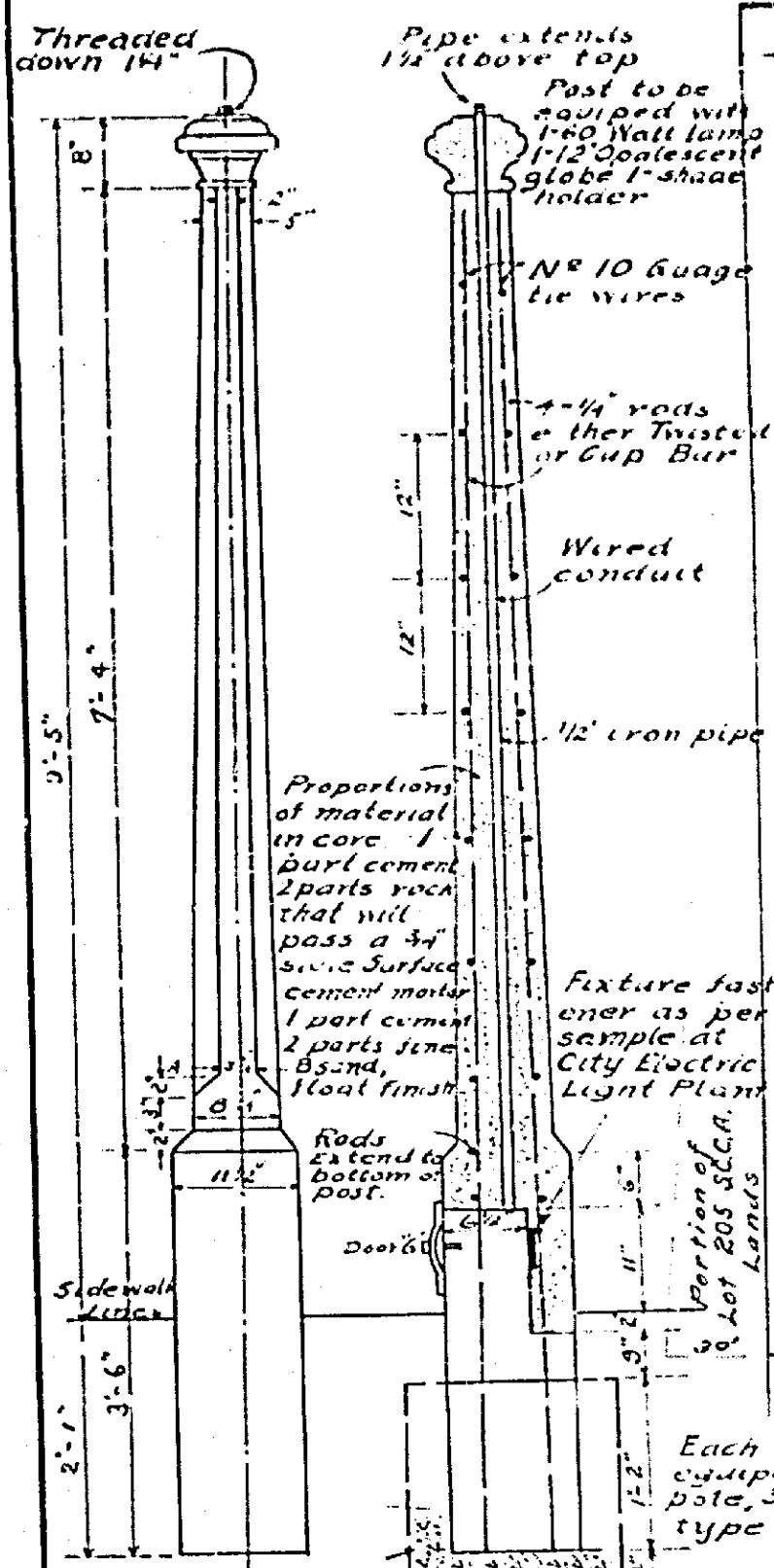
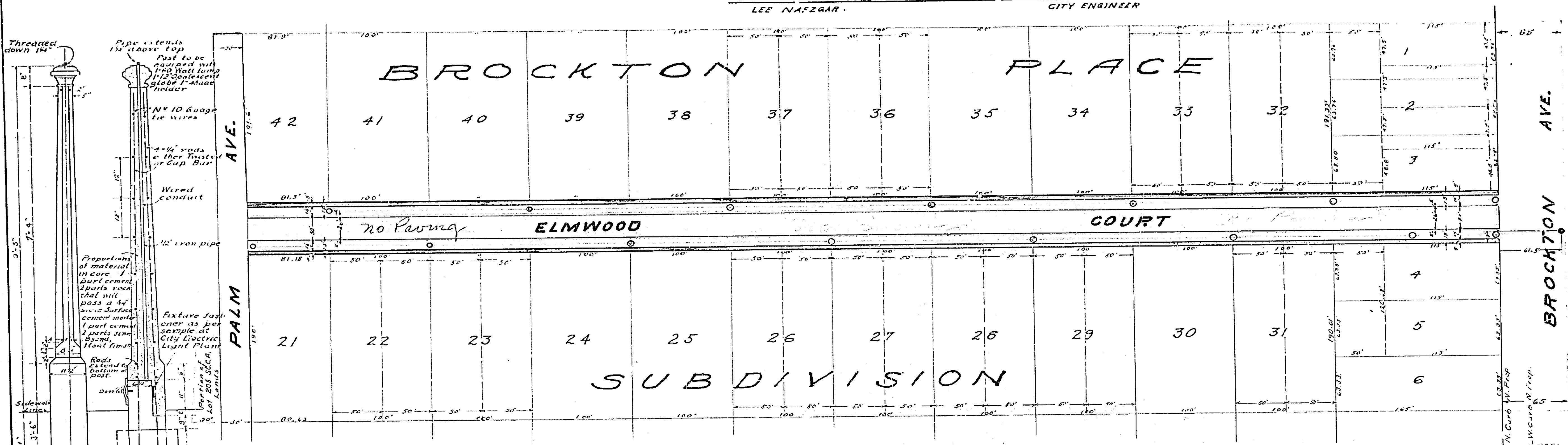

Adopted by the Mayor and Common Council of the City of Riverside on this 4th day, MAR. 1925.

Attest: *[Signature]* City Clerk

LEGEND
 Sidewalk to be constructed shall thus
 Combination Curb & Gutter to be constructed shown thus
 Position of Light Poles shown thus
 District permitted bounded by section line
 Light conduits to be laid, shown thus
 Position of Survey Pole for lights shown thus
 Grade of Curb shown on profile thus
 Elevations shown on profile are referenced to City Datum Established by Ordinance No. 105 Approved Dec. 2, 1920.

RACHAPPA AVE.

BLK 14

31 30 29 28 27 26 25 24 23

E. TENTH ST

Prop. Line not recognized
Recognized Property Line WHITE'S ADDITION MAP Rec. May 1886 Book 6, Page 48 S.B. County

MAP OF PROPOSED SEWER IN EAST TENTH ST.

Scale
1 in. Hor. = 40 ft.
1 in. Ver. = 4 ft.

Adopted by the Mayor and Common Council of the City of Riverside the 13th day of March, 1917.
Attest: *[Signature]*
City Clerk

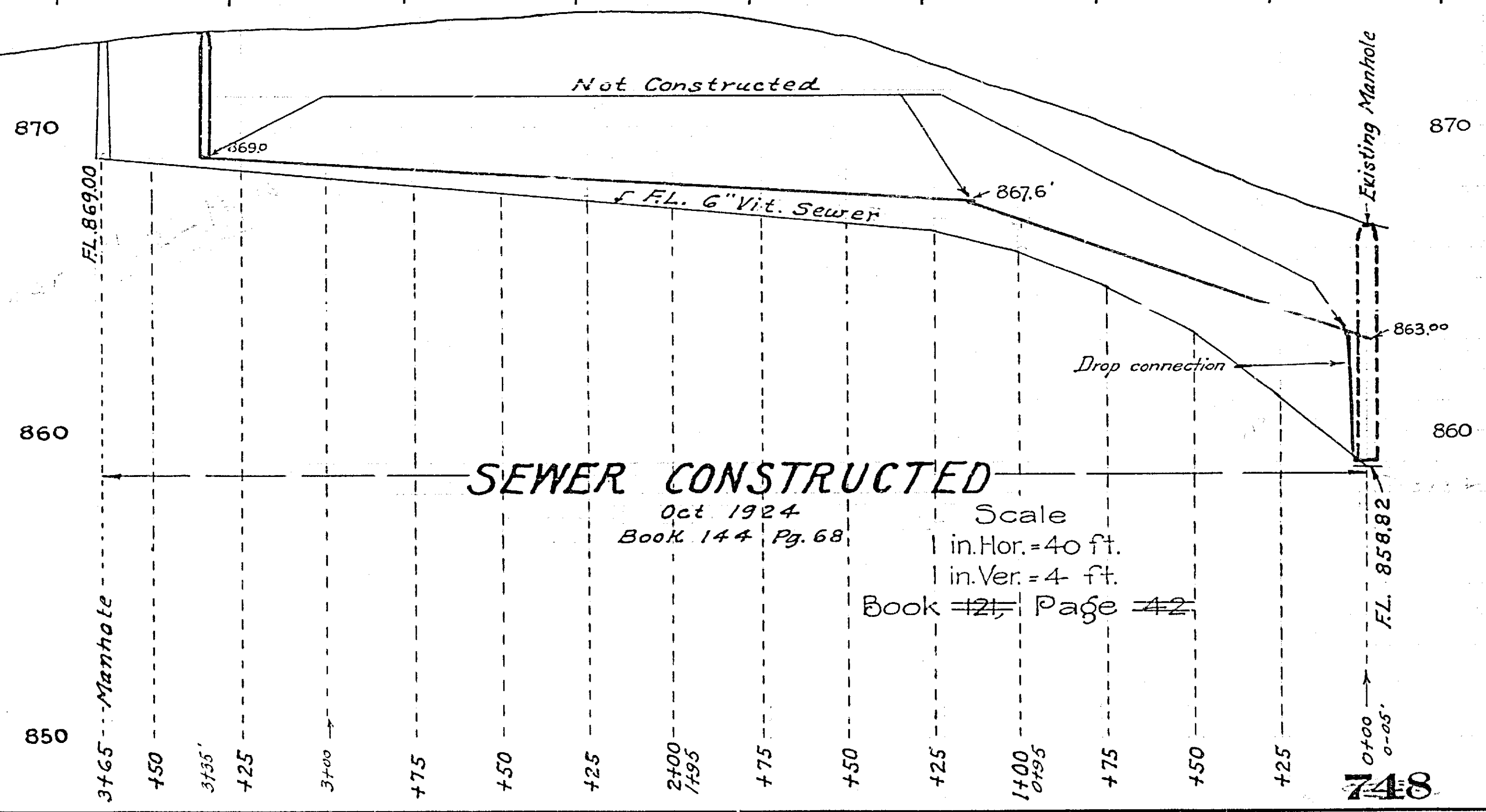

SEWER CONSTRUCTED
Oct 1924
Book 144 Pg. 68
Scale
1 in. Hor. = 40 ft.
1 in. Ver. = 4 ft.
Book 42 Page 42

809-A