

34.0

55.0

11.0

11.0

8.2.0

8.8

11.0

11.0

CITY OF BOSTON
ENGINEERING DEPARTMENT

PROFILES OF EAST SIDE OF BROCKTON AVE.

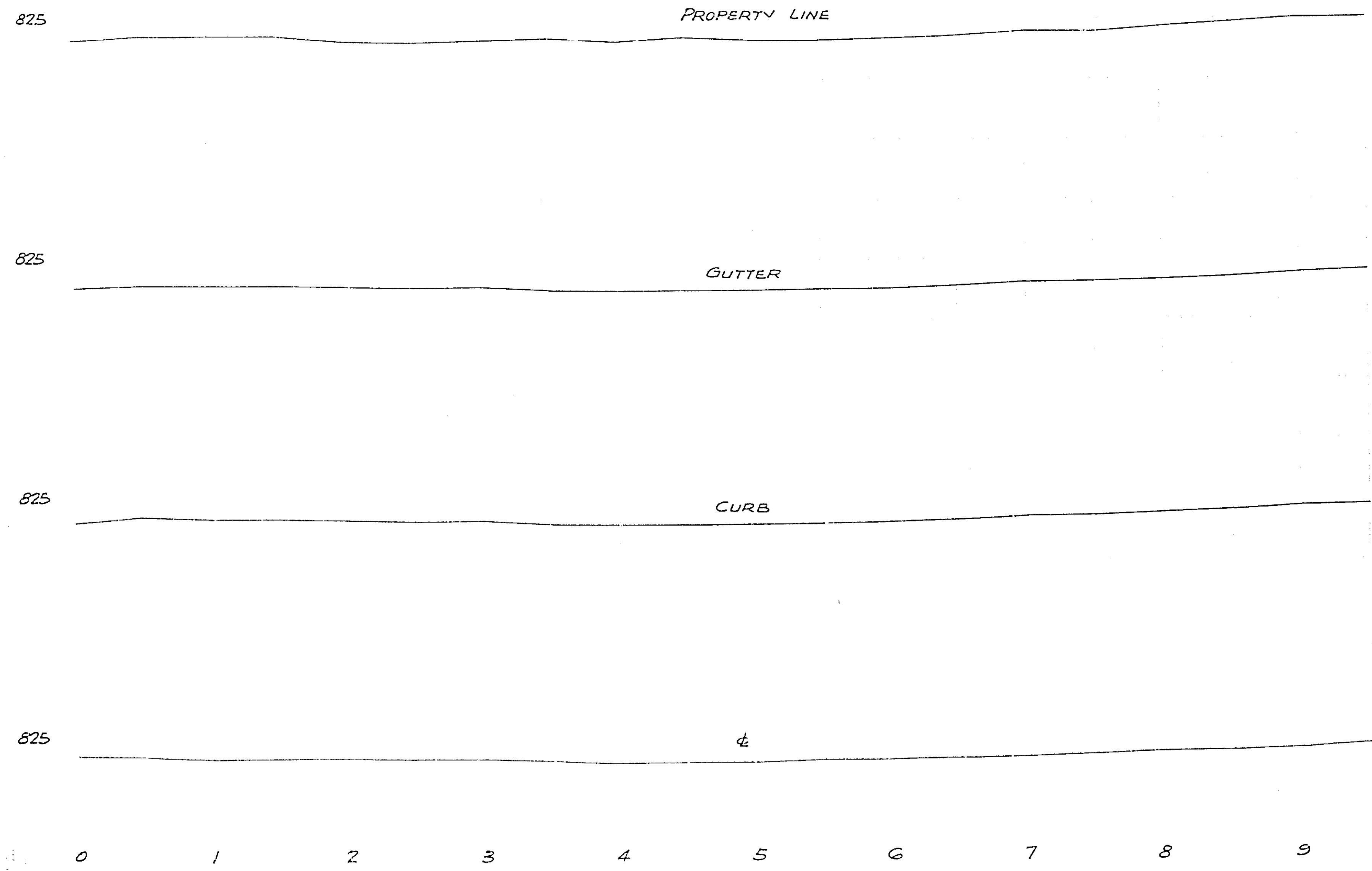

CITY OF BOSTON
ENGINEERING DEPARTMENT

70

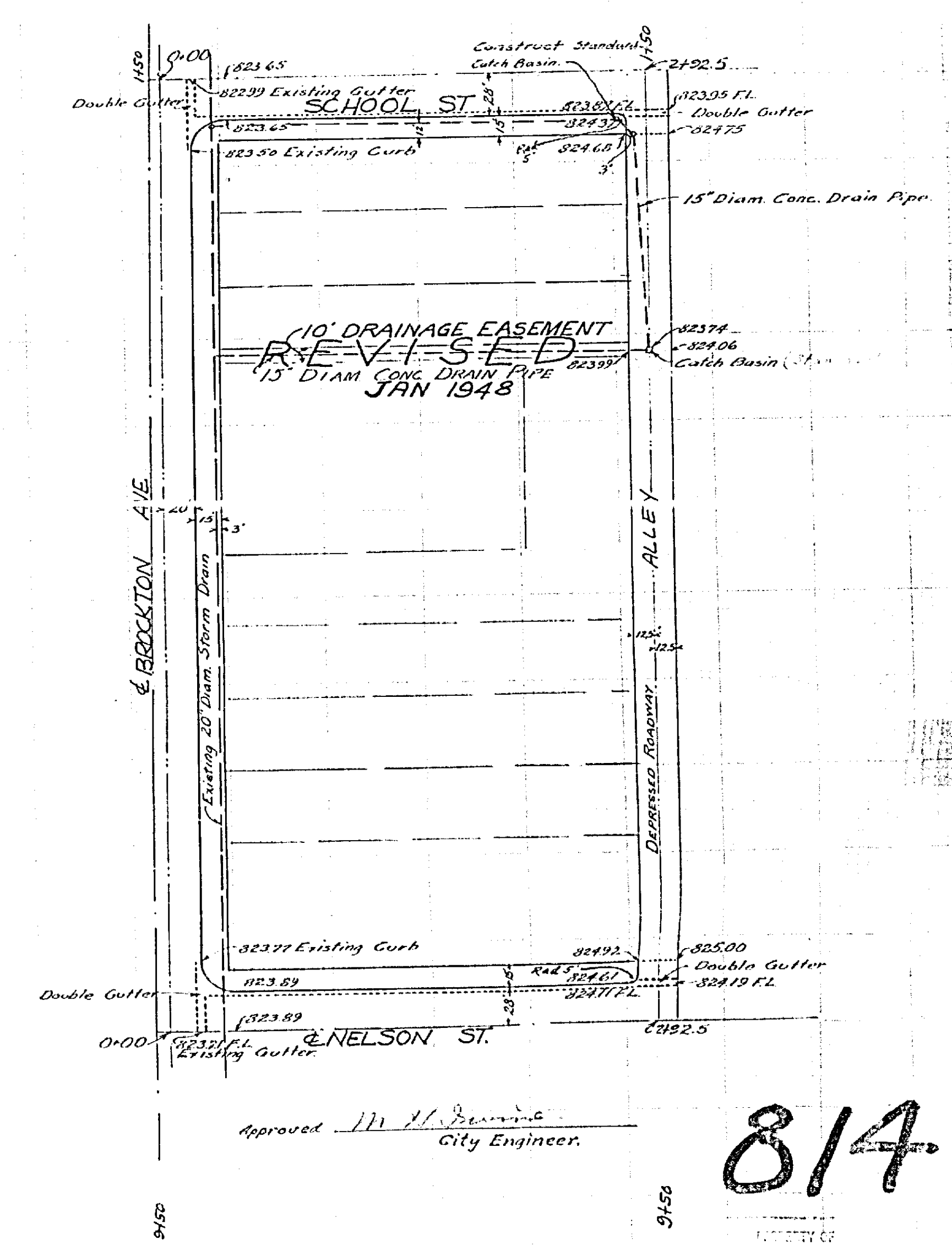
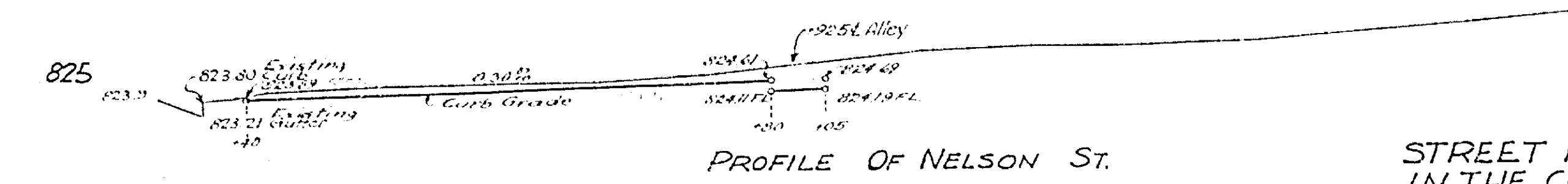
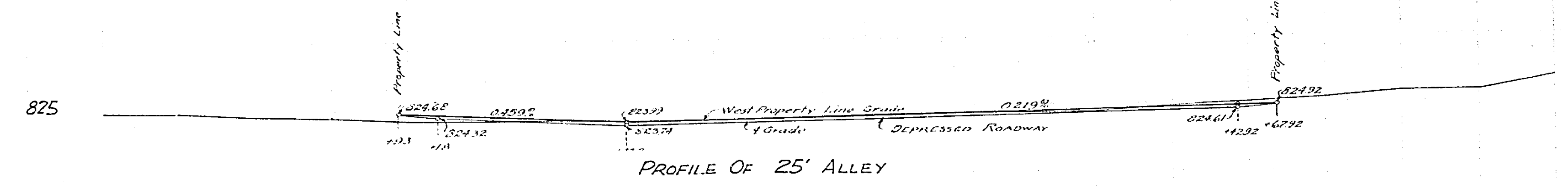
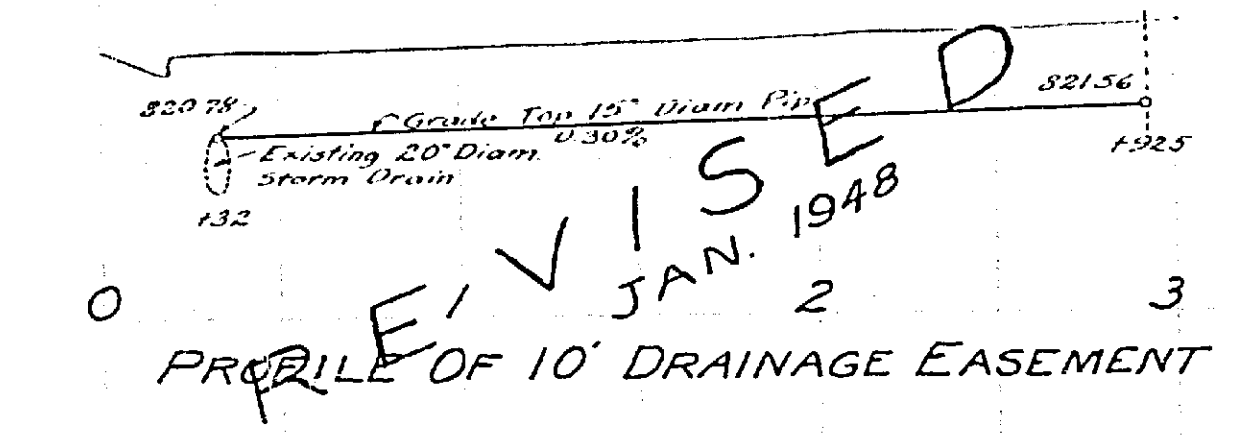
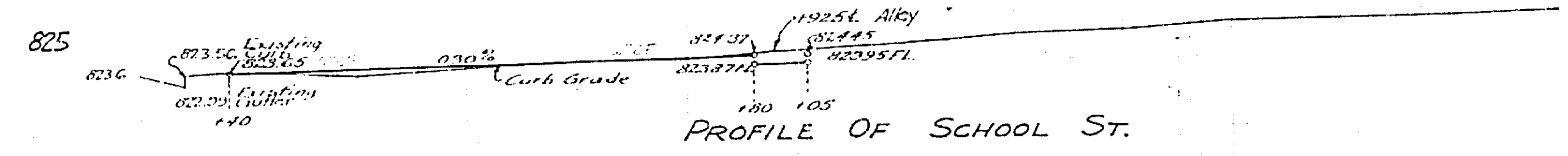
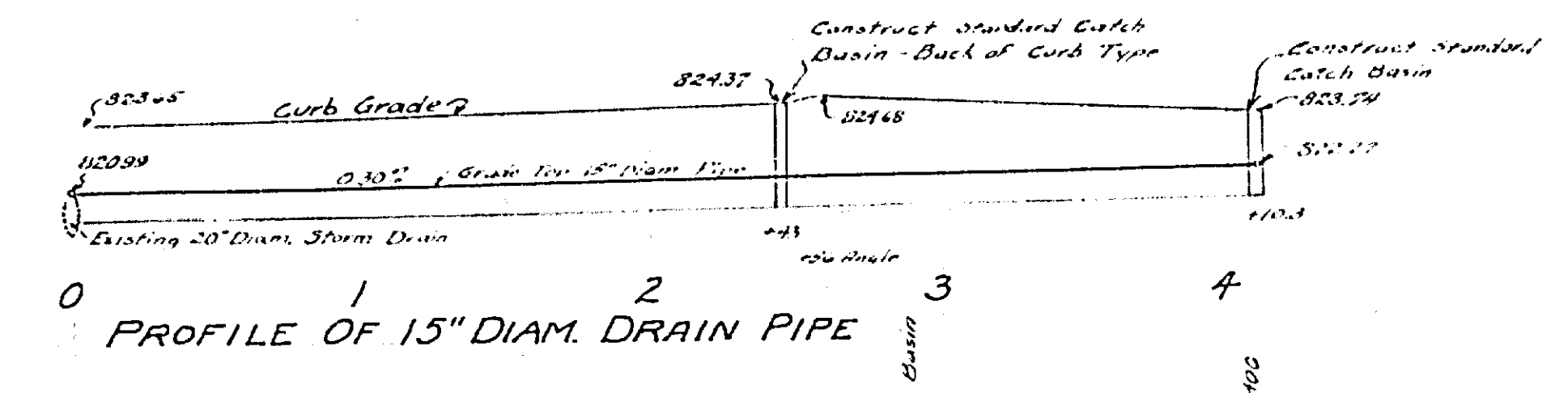

STREET PROFILES OF 'H.C. PETERS TRACT'
 IN THE CITY OF RIVERSIDE. JULY, 1947.

SCALES: 1" = 50' HOR.; 1" = 5' VERT.
 ELEVATIONS - CITY DATUM
 F.B. 353-55.

J.F. DAVIDSON, C.E.

Approved *[Signature]*
 City Engineer.

814

0 1 2 3 4 5 6 7 8 9 10