

PLANS AND PROFILES
HUTCHINGS TRACT
Dec. 1928 Scale 1/4" = 40 ft.
Donald J. McKee - Licensed Surveyor

PROPERTY OF
CITY OF RIVERSIDE
CITY ENGINEERING DEPT.

PROPERTY OF
CITY OF RIVERSIDE
CITY ENGINEERING DEPT.

PROPERTY OF
CITY OF RIVERSIDE
CITY ENGINEERING DEPT.

Approved *M. H. Quinn* - Feb-21-19
City Engineer

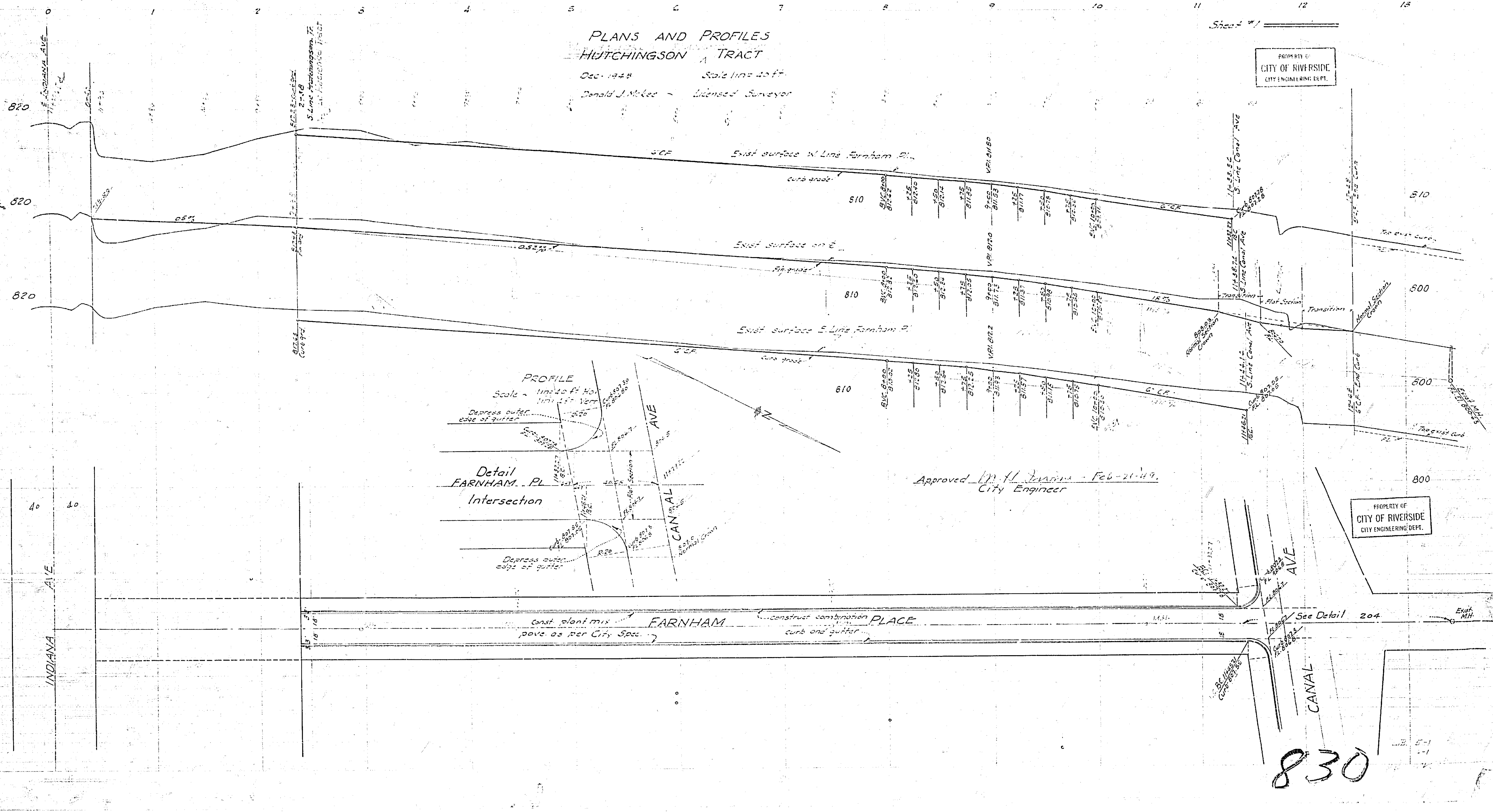

830

35.0
11.0
82.0
2.8
11
17.1
35.0

34.

22

Sheet #2

HUTCHINGSON TRACT
PROFILES

PROPERTY OF
CITY OF RIVERSIDE
CITY ENGINEERING DEPT.

PROPERTY OF
CITY OF RIVERSIDE
CITY ENGINEERING DEPT.

East Line Van Buren St.

Place extended
E. Farnham

E. Farnham

E. Farnham Place

E. Sumner Canal Ave.

Exist. Surface N. Line

Exist. surface of Indiana Ave

Exist. surface on E. Con. Ave

Exist. surface on E. 7

Fin. pipe grade

Const. 6" dia. sewer

Proposed Sewer in Farnham Pl.
thru Hutchinson Tract

Scale 1" = 2' Vert.
1" = 40' Hor.

Scale 1/4" = 10' Hor.
1/4" = 4' Vert.

33.5

11.5

11

8.2

8.8

11

11

35

820

820

810

810

800

800

800

11

11

8.5

8.5

11

17

22

830'

810
C.P.

PROPERTY OF
CITY OF RIVERSIDE
CITY ENGINEERING DEPT.

PROPERTY OF
CITY OF RIVERSIDE
CITY ENGINEERING DEPT.

810
C.P.

PROPERTY OF
CITY OF RIVERSIDE
CITY ENGINEERING DEPT.

810
C.P.

PROPERTY OF
CITY OF RIVERSIDE
CITY ENGINEERING DEPT.