

Approved May 31, 1929 M. H. Swinn City Engineer.

833

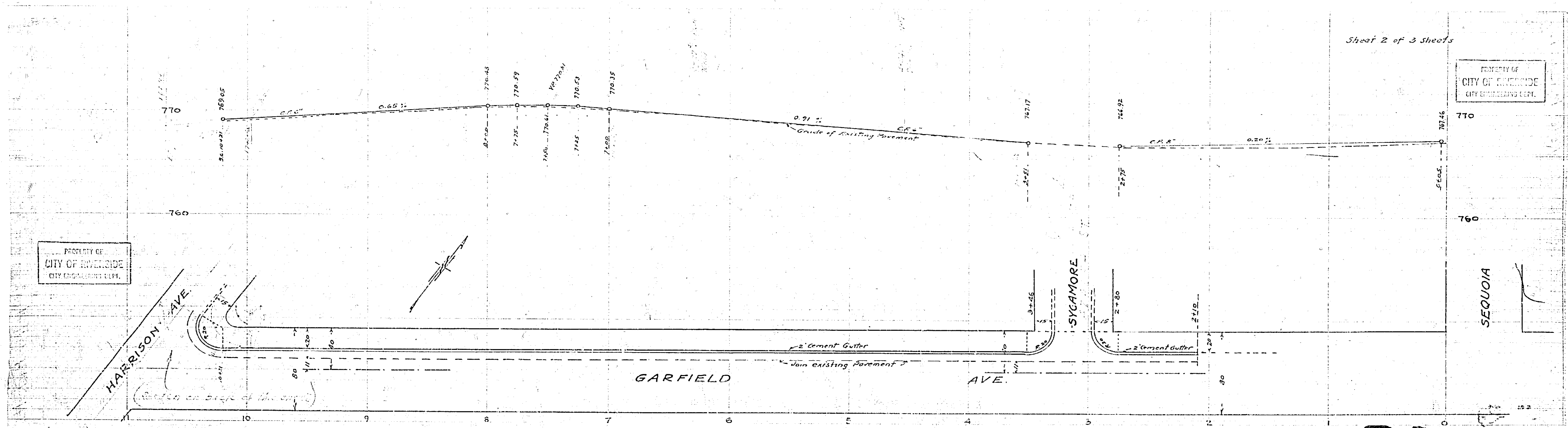

833

34"  
22"  
17"  
11"  
8"  
8.5"  
11"  
17"  
22"



PROPERTY OF  
CITY OF RIVERSIDE  
CITY ENGINEERING DEPT.

PROFILE OF SHARON AVE.

April 24 1927

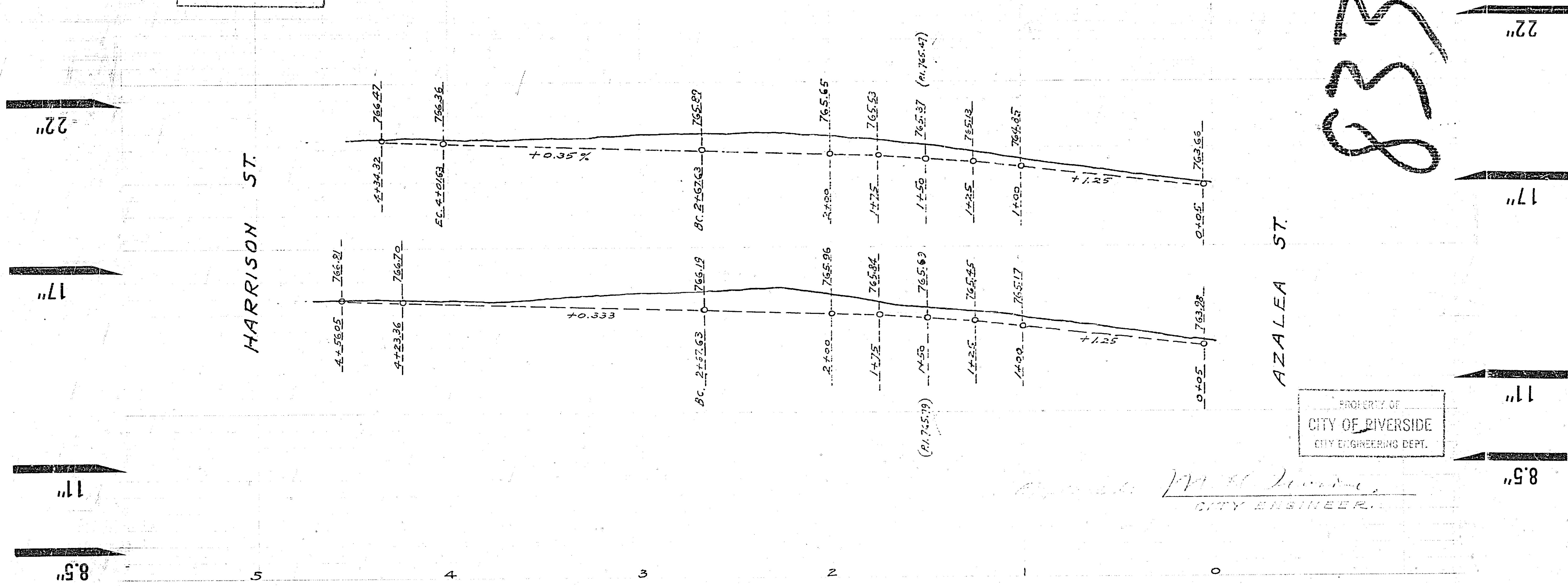

833

PROPERTY OF  
CITY OF RIVERSIDE  
CITY ENGINEERING DEPT.

*W. H. Linn*  
CITY ENGINEER.

22"

17"

11"

8.5"

8.5"

22"  
11"  
8.5"  
11"  
17"  
22"

34"  
22"  
11"  
8.5"  
11"  
8.5"  
11"  
17"  
22"

PROPERTY OF  
CITY OF RIVERSIDE  
CITY ENGINEERING DEPT.

# SEQUOIA ST.

EAST SIDE

WEST SIDE

ESTRELLITA

PROPERTY OF  
CITY OF RIVERSIDE  
CITY ENGINEERING DEPT.

PROPERTY OF  
CITY OF RIVERSIDE  
CITY ENGINEERING DEPT.

833

PROPERTY OF  
CITY OF RIVERSIDE  
CITY ENGINEERING DEPT.

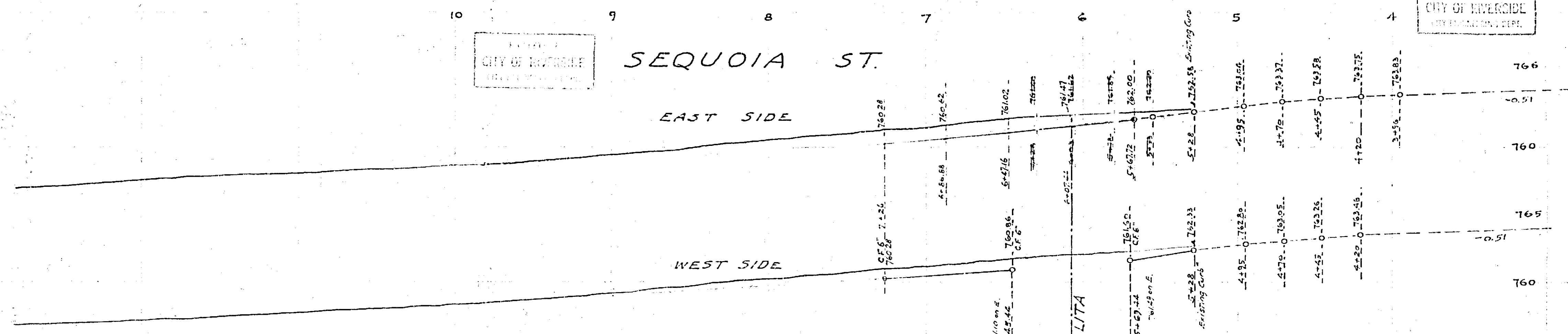

DATE: 11/11/11  
BY: [Signature]  
CITY ENGINEER

22"  
17"  
11"  
8.5"  
8.5"  
11"  
17"  
22"

22"  
17"  
11"  
8.5"  
8.5"  
11"  
17"  
22"

PROPERTY OF  
CITY OF RIVERSIDE  
CITY ENGINEERING DEPT.

PROPERTY OF  
CITY OF RIVERSIDE  
CITY ENGINEERING DEPT.

PROPERTY OF  
CITY OF RIVERSIDE  
CITY ENGINEERING DEPT.

PROPERTY OF  
CITY OF RIVERSIDE  
CITY ENGINEERING DEPT.

833

