

PROPERTY OF
CITY OF RIVERSIDE
CITY ENGINEERING DEPT.

PROPERTY OF
CITY OF RIVERSIDE
CITY ENGINEERING DEPT.

PLAN AND PROFILE OF SEWERS CLARKE'S SUBDIVISION

ARLINGTON AVENUE

EXISTING M.H.

D.M.H.

M.H. 412223

ADEN WAY

ARLINGTON AVE

B.M. 811-13 (Top of M.H. Cover)

Sec. R.P. 503-40

10' limit from
to explanation
distance of 150' to
from Arlington

334
RIVERSIDE ENGINEERING CO.
RIVERSIDE, CALIFORNIA
FOR Aden Clarke
Riverside, California
DRAWN BY EM CHECKED BY AF SCALE 1" = 20'
DATE July 16, 1951 REVISED
George R. ... CIVIL & STRUCTURAL ENGINEER #1126
SHEET 1 OF 2

Approved M. H. Irvine
City Engineer

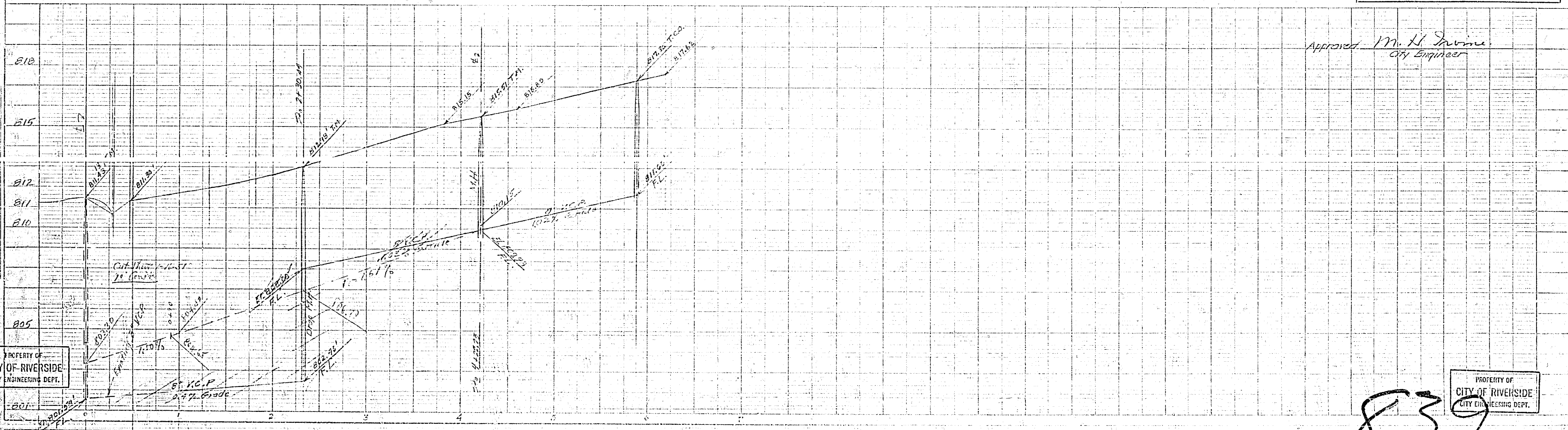

PROPERTY OF
CITY OF RIVERSIDE
CITY ENGINEERING DEPT.

PROPERTY OF
CITY OF RIVERSIDE
CITY ENGINEERING DEPT.

839

PROPERTY OF
CITY OF RIVERSIDE
CITY ENGINEERING DEPT.

PROPERTY OF
CITY OF RIVERSIDE
CITY ENGINEERING DEPT.

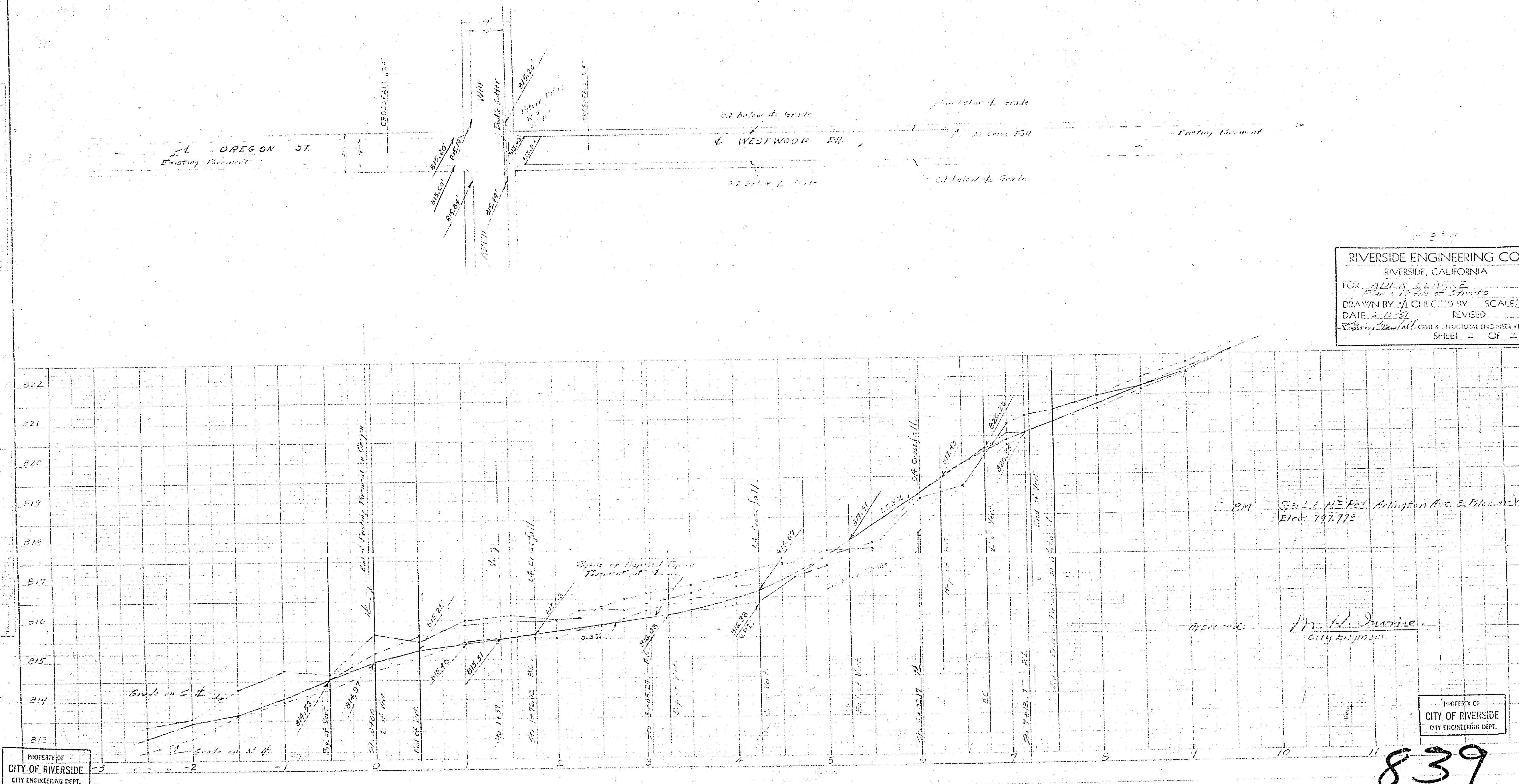

RIVERSIDE ENGINEERING CO.
RIVERSIDE, CALIFORNIA
FOR ALLEN CLARKE
DRAWN BY M. J. DURINE CHECKED BY SCALE 1"=20'
DATE 3-12-52 REVISED
M. J. Durine CIVIL & STRUCTURAL ENGINEER #125
SHEET 2 OF 2

PROPERTY OF
CITY OF RIVERSIDE
CITY ENGINEERING DEPT.

PROPERTY OF
CITY OF RIVERSIDE
CITY ENGINEERING DEPT.

839

22"

17"

11"

8.5"

11"

8.5"

17"

22"

22"

17"

11"

8.5"

8.5"

11"

17"

22"