

PROPERTY OF
CITY OF RIVERSIDE
CITY ENGINEERING DEPT.

PLAN AND PROFILE OF STREETS CLARKE'S SUBDIVISION

PROPERTY OF
CITY OF RIVERSIDE
CITY ENGINEERING DEPT.

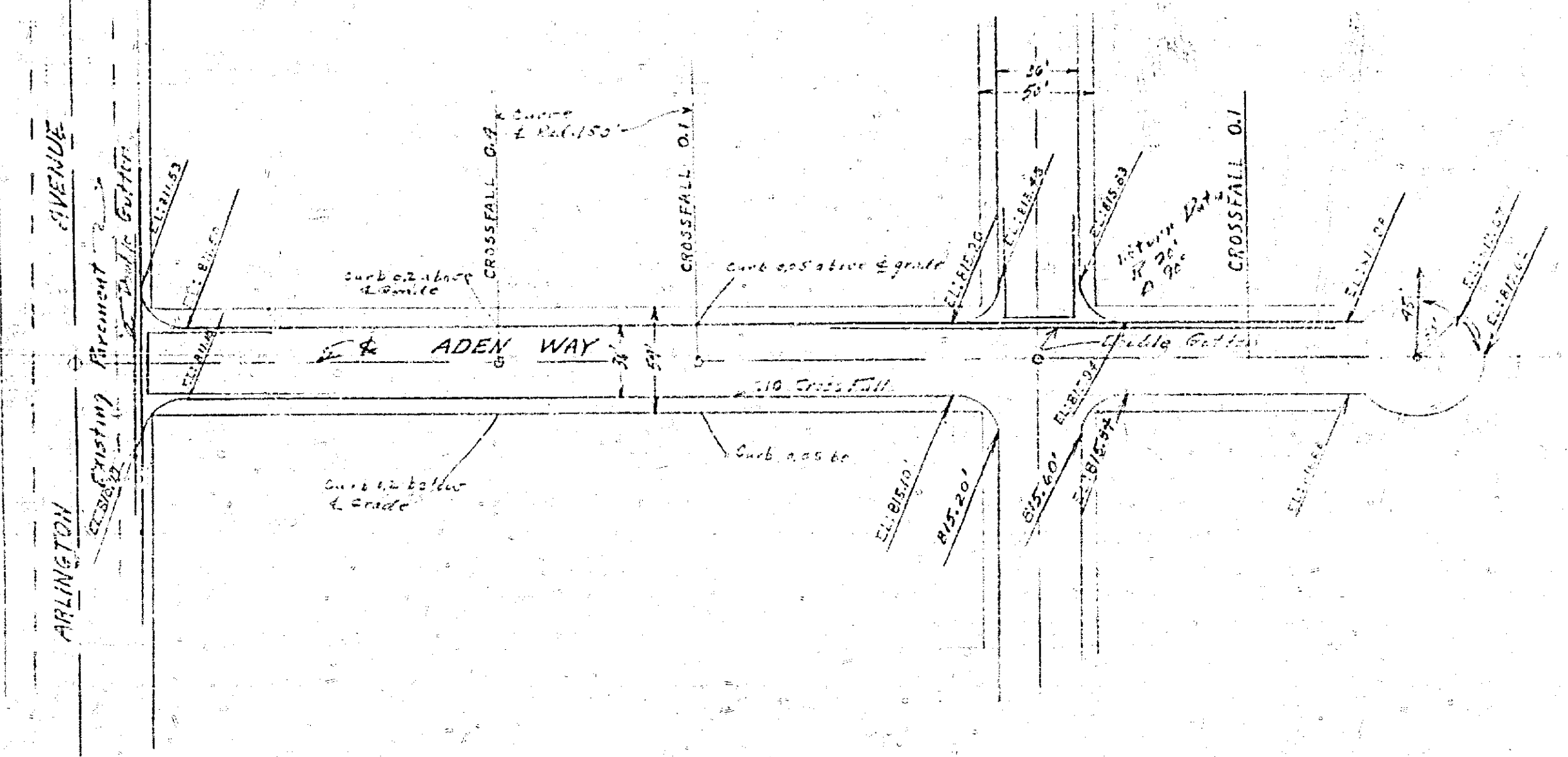

BM = 61.13 (Top of M.H. Cover)
ARLINGTON AVENUE

Note:
True Datum 4839

RIVERSIDE ENGINEERING CO.
RIVERSIDE, CALIFORNIA
FOR ADEN CLARKE

DRAWN BY *AK* CHECKED BY *AK* SCALE $1/8" = 1'$
DATE 5-10-57 REVISED 7-11-56
W. J. Spang CIVIL & STRUCTURAL ENGINEER #1124
SHEET 1 OF 2

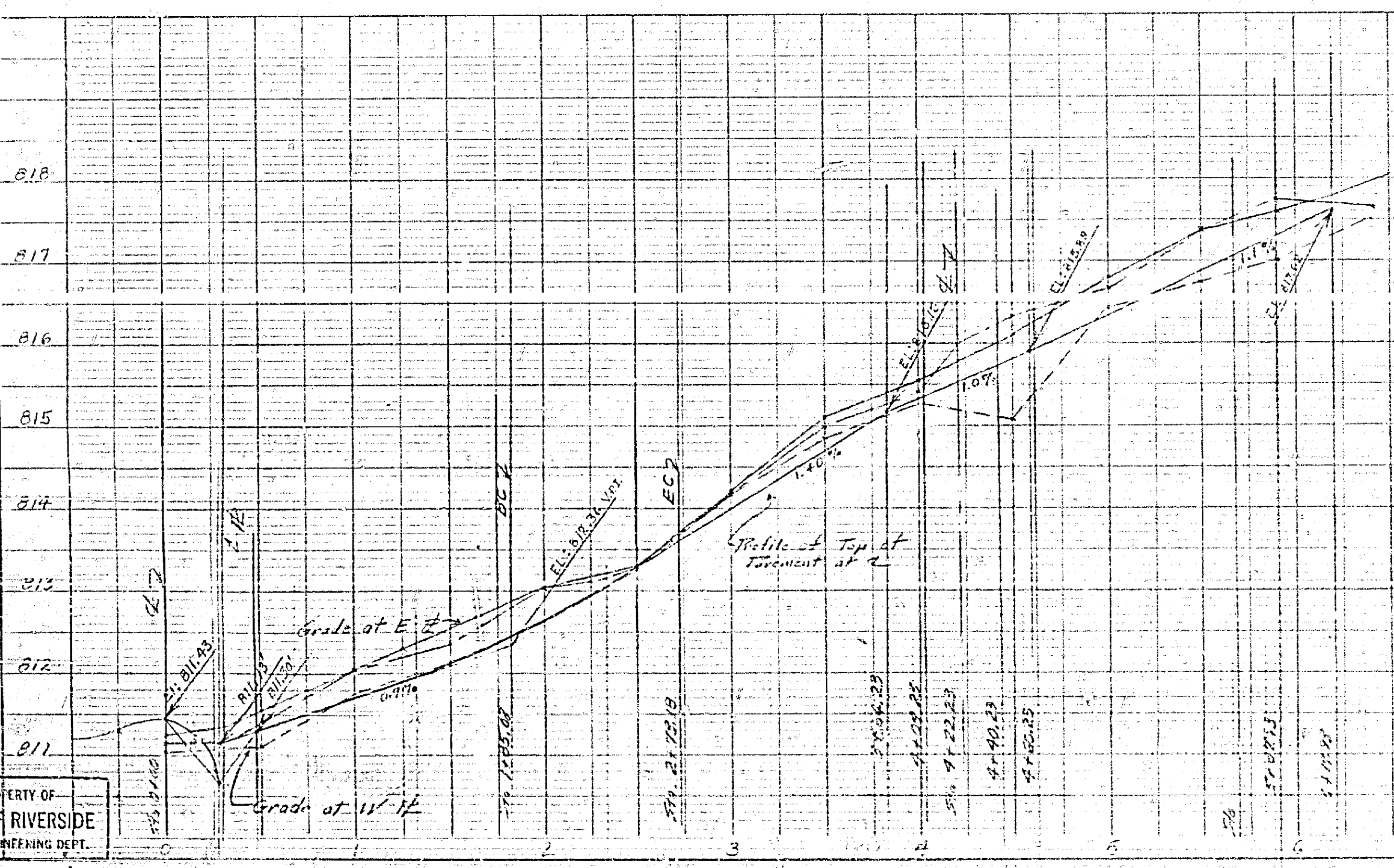

Approved *M. H. Irvine*
City Engineer

PROPERTY OF
CITY OF RIVERSIDE
CITY ENGINEERING DEPT.

839

PLASTIC...
RIVERSIDE ENGINEERING CO.

34"
22"
17"
11"
8.5"
11"
17"
22"

22"
17"
11"
8.5"
11"
17"
22"

PROPERTY OF
CITY OF RIVERSIDE
CITY ENGINEERING DEPT.

PROPERTY OF
CITY OF RIVERSIDE
CITY ENGINEERING DEPT.

OREGON STREET

WESTWOOD DRIVE

RIVERSIDE ENGINEERING CO.
RIVERSIDE, CALIFORNIA
FOR *Allen Clarke*
Plumber, Pacific of Sanors
DRAWN BY *...* CHECKED BY *...* SCALE *1" = 10'*
DATE *July 11, 1951* REVISED *...*
Robert Paul Roma CIVIL & STRUCTURAL ENGINEER #1128
SHEET 2 OF 2

Approved: *M. H. ...*
City Engineer

PROPERTY OF
CITY OF RIVERSIDE
CITY ENGINEERING DEPT.

PROPERTY OF
CITY OF RIVERSIDE
CITY ENGINEERING DEPT.

839

